

SUBSURFACE WASTEWATER DISPOSAL SYSTEM APPLICATION

Maine Department of Human Services
 Division of Health Engineering, Station 10 SHS
 (207) 287-5672 FAX (207) 287-4172

Town, City, Plantation PORTLAND, PEAKS ISLAND	Street, Road, Subdivision 20 SANDPIPER ROAD	Owner's Name STEVEN & BETH PRUSKY
---	---	---

SUBSURFACE WASTEWATER DISPOSAL PLAN

SCALE 1" = 20 FT.

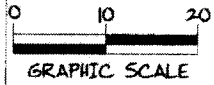
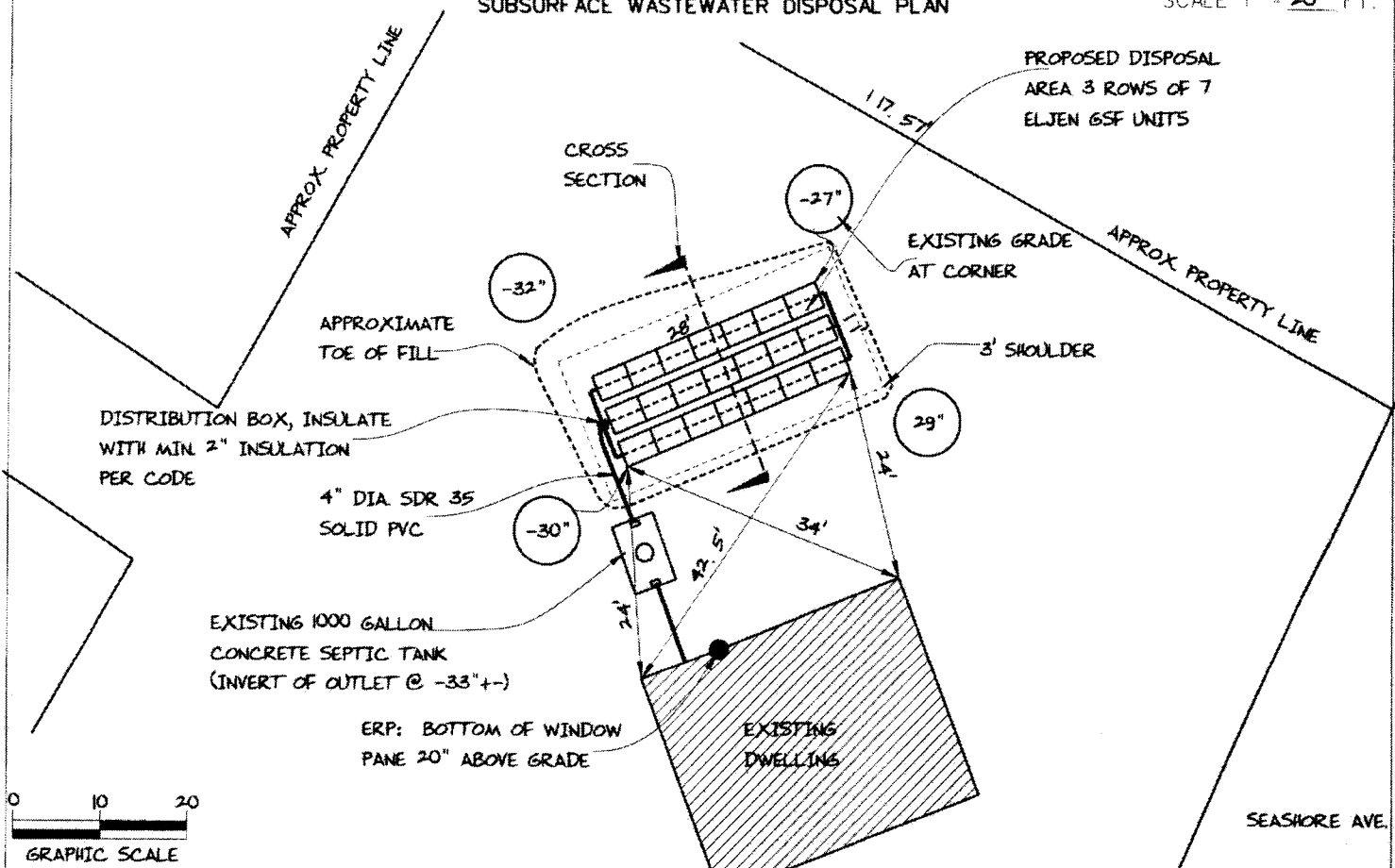

FILL REQUIREMENTS	CONSTRUCTION ELEVATIONS	ELEVATION REFERENCE POINT
Depth of Fill (Upslope) : 4" - 5"	Finished Grade Elevation	SEE DETAIL BELOW
Depth of Fill (Downslope) : 2" - 7"	Top of Distribution Pipe or Proprietary Device	Location & Description
DEPTHS AT CROSS-SECTION (shown below)	Bottom of Disposal Area	BOTTOM OF WINDOW PANE 20" ABOVE GRADE
		Reference Elevation is: 0.0' or GRADE

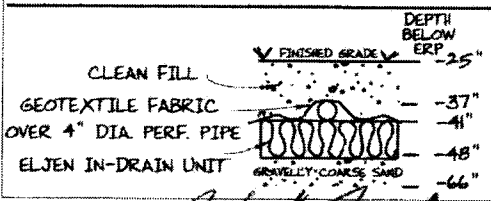
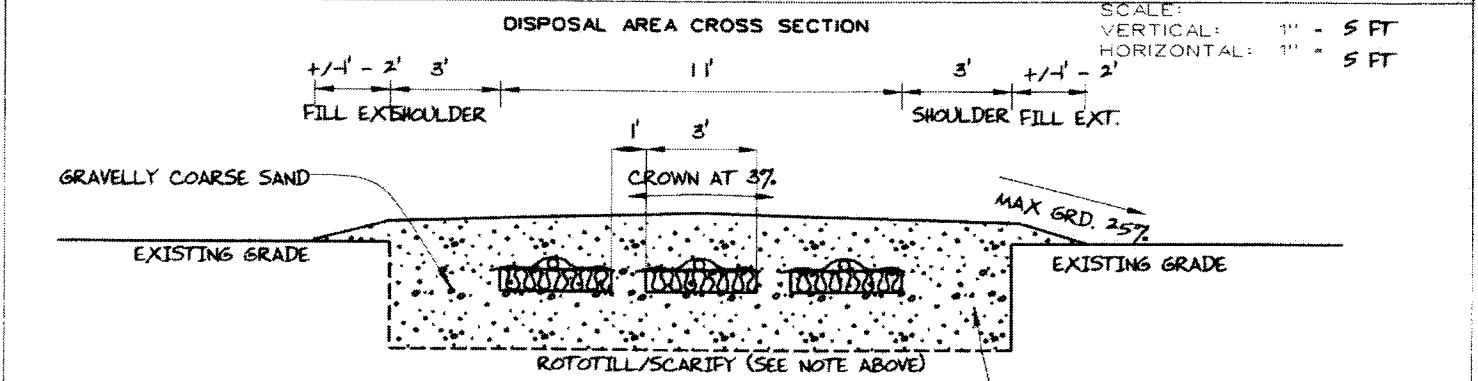

REMOVE ALL PORTIONS OF EXISTING DISPOSAL AREA ENCOUNTERED TO A MINIMUM DEPTH OF 18" UNDERNEATH AND 3' ALONGSIDE DISPOSAL AREA AND REPLACE WITH CLEAN GRAVELLY COARSE SAND FILL

 Site Evaluator signature	163 SE *	9/10/14 Date	Page 3 of 3 HHE-200 Rev. 10/02
------------------------------	-------------	-----------------	-----------------------------------