

SUBSURFACE WASTEWATER DISPOSAL SYSTEM APPLICATION

Maine Department of Human Services
 Division of Health Engineering, 10 SHS
 (207) 287-5872 Fax: (207) 287-3165

PROPERTY LOCATION		>> CAUTION: PERMIT REQUIRED - ATTACH IN SPACE BELOW <<	
City, Town, or Plantation	PORTLAND - PEAKS IS.	8002-6015 PORTLAND Date Permit Issued: 10/15/03 Local Plumbing Inspector Signature: <i>[Signature]</i> 8642 TOWN COPY \$ [] Double Fee L.P.I. # 0640	
Street or Road	252 SEASHORE AVE		
Subdivision, Lot #			
OWNER/APPLICANT INFORMATION			
Name (last, first, MI)	SULLIVAN PAT		
	<input checked="" type="checkbox"/> Owner <input type="checkbox"/> Applicant		
Mailing Address of Owner/Applicant	252 SEASHORE AVE. PORTLAND, ME 04108		
Daytime Tel. #	766-2480	Municipal Tax Map # 085 Lot # 1003	
OWNER OR APPLICANT STATEMENT		CAUTION: INSPECTION REQUIRED	
I state and acknowledge that the information submitted is correct to the best of my knowledge and understand that any falsification is reason for the Department and/or Local Plumbing Inspector to deny a Permit.		I have inspected the installation authorized above and found it to be in compliance with the Subsurface Wastewater Disposal Rules Application.	
Signature of Owner or Applicant _____ Date _____		Local Plumbing Inspector Signature _____ (1st) date approved _____	

PERMIT INFORMATION		
TYPE OF APPLICATION	THIS APPLICATION REQUIRES	DISPOSAL SYSTEM COMPONENTS
<input type="checkbox"/> 1. First Time System <input checked="" type="checkbox"/> 2. Replacement System Type replaced: <u>CESSPOOL</u> Year installed: <u>1940's</u> <input type="checkbox"/> 3. Expanded System <input type="checkbox"/> a. Minor Expansion <input type="checkbox"/> b. Major Expansion <input type="checkbox"/> 4. Experimental System <input type="checkbox"/> 5. Seasonal Conversion	<input type="checkbox"/> 1. No Rule Variance <input type="checkbox"/> 2. First Time System Variance <input type="checkbox"/> a. Local Plumbing Inspector Approval <input type="checkbox"/> b. State & Local Plumbing Inspector Approval <input checked="" type="checkbox"/> 3. Replacement System Variance <input type="checkbox"/> a. Local Plumbing Inspector Approval <input checked="" type="checkbox"/> b. State & Local Plumbing Inspector Approval <input type="checkbox"/> 4. Minimum Lot Size Variance <input type="checkbox"/> 5. Seasonal Conversion Permit	<input checked="" type="checkbox"/> 1. Complete Non-engineered System <input type="checkbox"/> 2. Primitive System (graywater & alt. toilet) <input type="checkbox"/> 3. Alternative Toilet, specify: _____ <input type="checkbox"/> 4. Non-engineered Treatment Tank (only) <input type="checkbox"/> 5. Holding Tank, _____ gallons <input type="checkbox"/> 6. Non-engineered Disposal Field (only) <input type="checkbox"/> 7. Separated Laundry System <input type="checkbox"/> 8. Complete Engineered System (2000 gpd or more) <input type="checkbox"/> 9. Engineered Treatment Tank (only) <input type="checkbox"/> 10. Engineered Disposal Field (only) <input type="checkbox"/> 11. Pre-treatment, specify: _____ <input type="checkbox"/> 12. Miscellaneous Components
SIZE OF PROPERTY	DISPOSAL SYSTEM TO SERVE	TYPE OF WATER SUPPLY
1/2 <input type="checkbox"/> SQ. FT. <input checked="" type="checkbox"/> ACRES	<input checked="" type="checkbox"/> 1. Single Family Dwelling Unit, No. of Bedrooms: <u>3</u> <input type="checkbox"/> 2. Multiple Family Dwelling, No. of Units: _____ <input type="checkbox"/> 3. Other: _____ (specify) Current Use <input type="checkbox"/> Seasonal <input checked="" type="checkbox"/> Year Round <input type="checkbox"/> Undeveloped	<input checked="" type="checkbox"/> 1. Drilled Well <input type="checkbox"/> 2. Dug Well <input type="checkbox"/> 3. Private <input type="checkbox"/> 4. Public <input type="checkbox"/> 5. Other
SHORELAND ZONING		
<input checked="" type="checkbox"/> Yes <input type="checkbox"/> No		

DESIGN DETAILS (SYSTEM LAYOUT SHOWN ON PAGE 3)			
TREATMENT TANK	DISPOSAL FIELD TYPE & SIZE	GARBAGE DISPOSAL UNIT	DESIGN FLOW
<input checked="" type="checkbox"/> 1. Concrete 1. Regular <i>CONTRACTOR'S CHOICE</i> <input type="checkbox"/> b. Low Profile <input type="checkbox"/> 2. Plastic <input type="checkbox"/> 3. Other: _____ CAPACITY: <u>1000</u> GAL.	<input type="checkbox"/> 1. Stone Bed <input type="checkbox"/> 2. Stone Trench <input checked="" type="checkbox"/> 3. Proprietary Device <input checked="" type="checkbox"/> a. cluster array <input type="checkbox"/> c. Linear <input checked="" type="checkbox"/> b. regular load <input type="checkbox"/> d. H-20 load <input type="checkbox"/> 4. Other: _____ SIZE: <u>936</u> sq. ft. <input type="checkbox"/> lin. ft.	<input checked="" type="checkbox"/> 1. No <input type="checkbox"/> 2. Yes <input type="checkbox"/> 3. Maybe If Yes or Maybe, specify one below: <input type="checkbox"/> a. multi-compartment tank <input type="checkbox"/> b. _____ tanks in series <input type="checkbox"/> c. increase in tank capacity <input type="checkbox"/> d. Filter on Tank Outlet	<u>283</u> gallons per day BASED ON: <input checked="" type="checkbox"/> 1. Table 501.0 (dwelling units) <input type="checkbox"/> 2. Table 501.0 (dwelling units) SHOW CALCULATIONS -- for other facilities -- JAN 21 2004 CITY OF PORTLAND
SOIL DATA & DESIGN CLASS	DISPOSAL FIELD SIZING	EFFLUENT/EJECTOR PUMP	
PROFILE CONDITION DESIGN <u>2, ATTL</u> at Observation Hole # <u>TP-1</u> Depth <u>10</u> " of Most Limiting Soil Factor	<input type="checkbox"/> 1. Small--2.0 sq. ft. / gpd <input type="checkbox"/> 2. Medium--2.6 sq. ft. / gpd <input checked="" type="checkbox"/> 3. Medium--Large 3.3 sq. ft. / gpd <input type="checkbox"/> 4. Large--4.1 sq. ft. / gpd <input type="checkbox"/> 5. Extra Large--5.0 sq. ft. / gpd	<input type="checkbox"/> 1. Not Required <input type="checkbox"/> 2. May Be Required <input checked="" type="checkbox"/> 3. Required Specify only for engineered systems: DOSE: _____ gallons	<input type="checkbox"/> 3. Section 503.0 (meter readings) ATTACH WATER METER DATA

SITE EVALUATOR STATEMENT			
I certify that on <u>9-19-00</u> (date) I completed a site evaluation on this property and state that the data reported are accurate and that the proposed system is in compliance with the State of Maine Subsurface Wastewater Disposal Rules (10-144A CMR 241).			
Site Evaluator Signature <u>Mark Cenci</u>	SE # <u>262</u>	Date <u>10-31-02</u>	REVISED <u>6.25.03</u>
Site Evaluator Name Printed <u>MARK CENCI</u>	Telephone Number <u>797-2110</u>	E-mail Address	
Note: Changes to or deviations from the design should be confirmed with the Site Evaluator.			

SUBSURFACE WASTEWATER DISPOSAL SYSTEM APPLICATION

Department of Human Services
Division of Health Engineering
(207) 287-5672 FAX (207) 287-4172

Town, City, Plantation
PORTLAND

Street, Road, Subdivision
PEAKS K. SEASHORE AVE.

Owner's Name
PAT SULLIVAN

SITE PLAN

Scale 1" = 50 Ft.
or as shown

SITE LOCATION PLAN
(Map from Maine Atlas recommended)

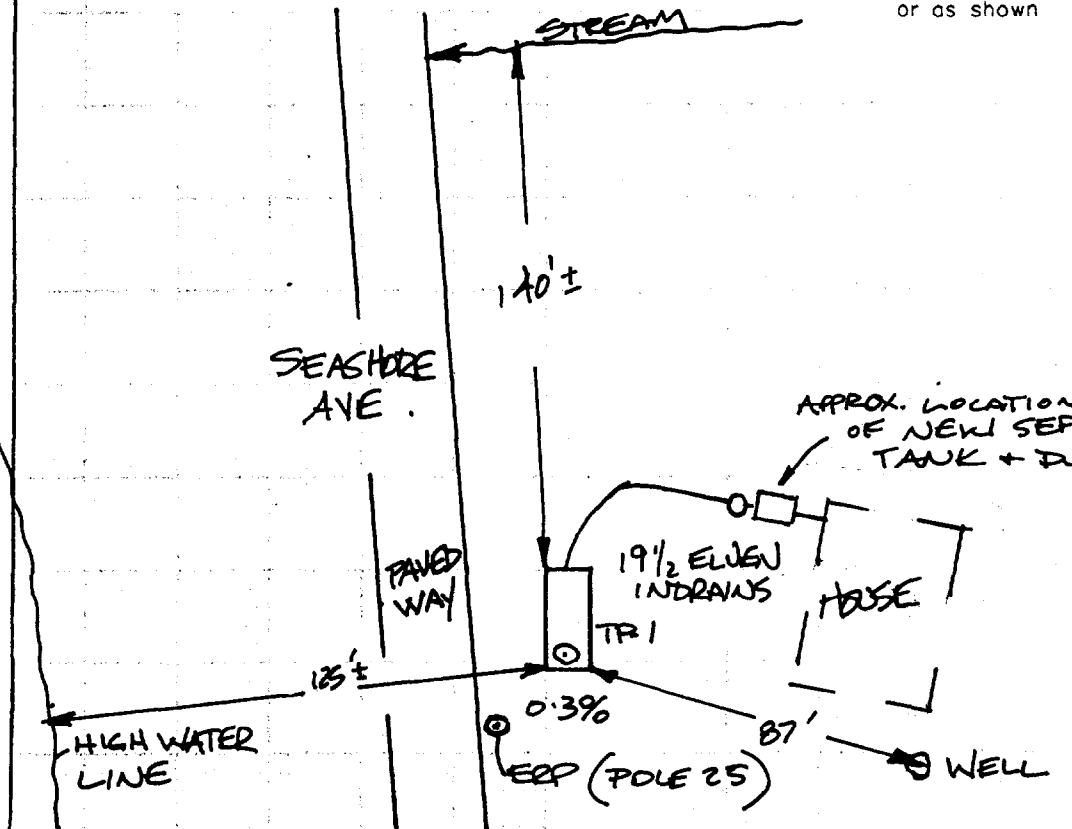
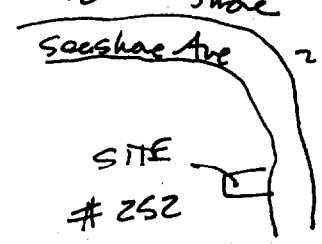

SOIL DESCRIPTION AND CLASSIFICATION (Location of Observation Holes Shown Above)

Observation Hole _____ Test Pit Boring
" Depth of Organic Horizon Above Mineral Soil

DEPTH BELOW MINERAL SOIL SURFACE (inches)	Texture	Consistency	Color	Mottling
0	FINE		DK. BRN.	
10	SANDY LOAM	FRIABLE	DK. RED BRN.	FEW
20				
30	BEDROCK			
40				
50				

Soil Classification 2 AIII/D	Slope 0.3%	Limiting Factor 10"	<input checked="" type="checkbox"/> Ground Water <input type="checkbox"/> Restrictive Layer <input type="checkbox"/> Bedrock <input type="checkbox"/> Pit Depth
Profile	Condition		

Observation Hole _____ Test Pit Boring
" Depth of Organic Horizon Above Mineral Soil

DEPTH BELOW MINERAL SOIL SURFACE (inches)	Texture	Consistency	Color	Mottling
0				
10				
20				
30				
40				
50				

Soil Classification	Slope	Limiting Factor	<input type="checkbox"/> Ground Water <input type="checkbox"/> Restrictive Layer <input type="checkbox"/> Bedrock <input type="checkbox"/> Pit Depth
Profile	Condition		

Mark Quinn
Site Evaluator Signature

262
SE *

9-27-00
Date

OK 10/31/02 MC
Page 2 of 3
HHE-200 Rev. 7/97
OK 4-18-03 MC

SUBSURFACE WASTEWATER DISPOSAL SYSTEM APPLICATION

Department of Human Services
Division of Health Engineering
(207) 287-5672 FAX (207) 287-4172

Town, City, Plantation: **PORTLAND** Street, Road, Subdivision: **PEAKS IS. SEASHORE AVE** Owner's Name: **PAT SULLIVAN**

SUBSURFACE WASTEWATER DISPOSAL PLAN

SCALE 1" = 20 FT.

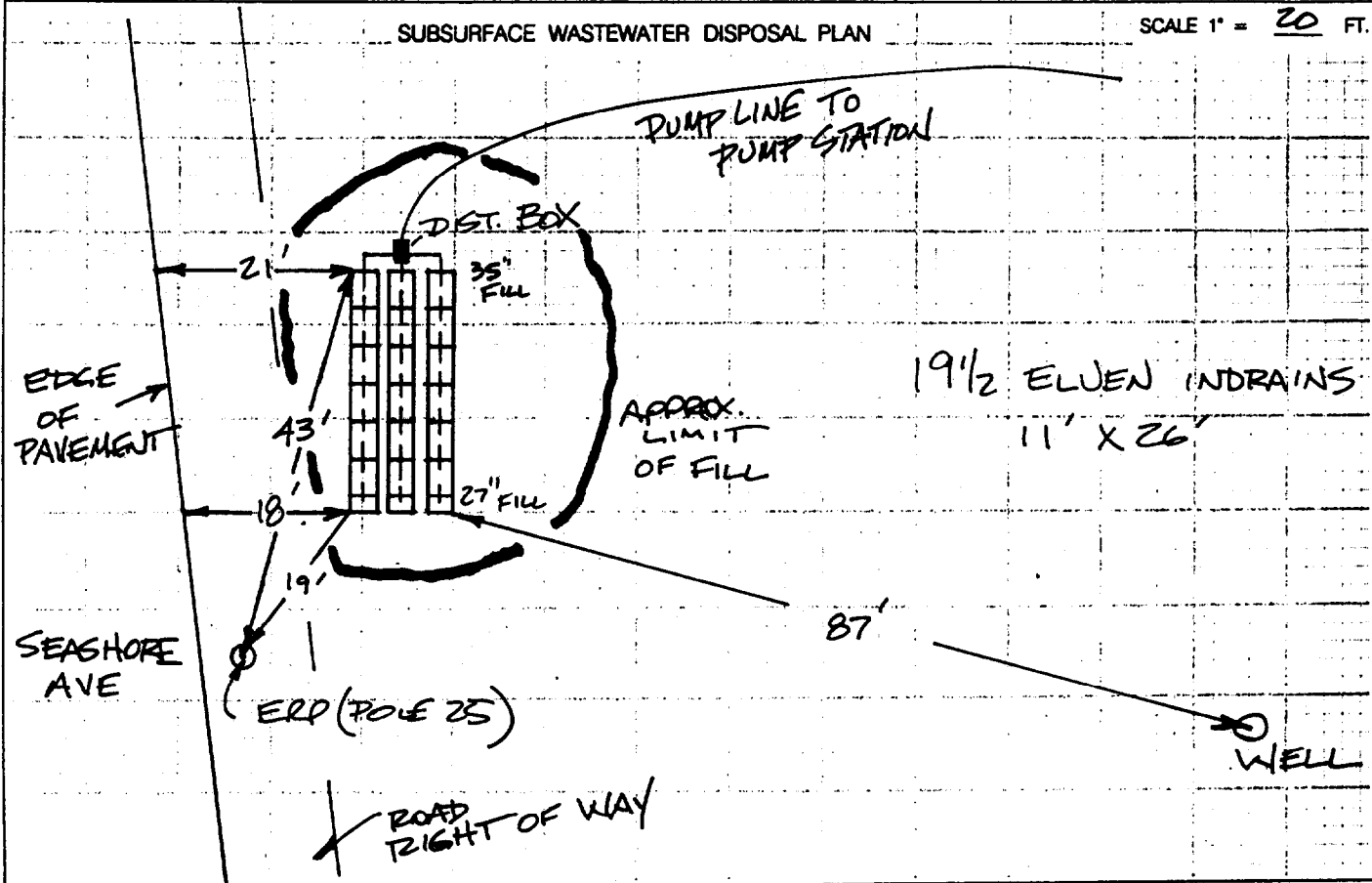

FILL REQUIREMENTS

Depth of Fill (Upslope) 27"
Depth of Fill (Downslope) 30-35"

CONSTRUCTION ELEVATIONS

Finished Grade Elevation -21"
Top of Distribution Pipe -29"
Bottom of Disposal Area (INDRAINS) -40"

ELEVATION REFERENCE POINT

Location & Description **NAIL IN PINK TAG ON POLE 25**
Reference Elevation 0"

NOTE: SCARIFY ALL GROUND TO BE FILLED.

USE GRAVELLY COARSE SAND WITHIN 3' OF INDRAINS. REMAINING FILL: SAND - NO CLAY

DISPOSAL AREA CROSS SECTION

SCALE:
VERTICAL: 1" = 4'
HORIZONTAL: 1" = 4'

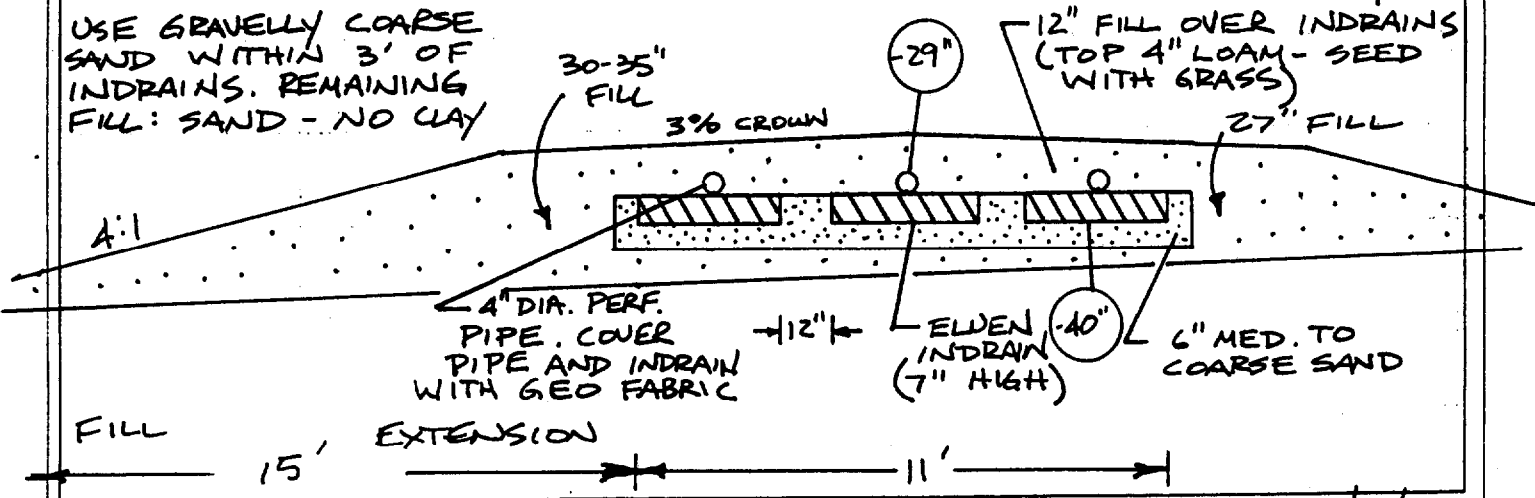

Mark Quinn
Site Evaluator Signature

262
SE

9-27-00
Date

OK 10/31/02
MC

REPLACEMENT SYSTEM VARIANCE REQUEST

THE LIMITATIONS OF THE REPLACEMENT SYSTEM VARIANCE REQUEST

This form shall be attached to an application (HHE-200) for the proposed replacement system which requires a variance to the Rules. The LPI shall review the Replacement System Variance Request an HHE-200 and may approve the Request if all of the following requirements can be met, and the variance(s) requested fall within the limits of LPI's authority.

1. The proposed design meets the definition of a Replacement System as defined in the Rules (Sec. 2006)
2. There will be no change in use of the structure except as authorized for one-time exempted expansions outside the shoreland zone of major waterbodies/courses.
3. The replacement system is determined by the Site Evaluator and LPI to be the most practical method to treat and dispose of the wastewater.
4. The BOD5 plus S.S. content of the wastewater is no greater than that of normal domestic effluent.

GENERAL INFORMATION	Town of <u>PORTLAND</u>
Permit No. _____	Date Permit Issued _____
Property Owner's Name: <u>PAT SULLIVAN</u>	Tel. No.: _____
System's Location: <u>252 SEASHORE AVE., PEAKS ISLAND, PORTLAND</u>	
Property Owner's Address: _____	
(if different from above) _____	

SPECIFIC INSTRUCTIONS TO THE:

LOCAL PLUMBING INSPECTOR (LPI):
 If any of the variances exceed your approval authority and/or do not meet all of the requirements listed under the Limitations Section above, then you are to send this Replacement System Variance Request, along with the Application, to the Department for review and approval consideration before issuing a Permit. (See reverse side for Comments Section and your signature.)

SITE EVALUATOR:
 If after completing the Application, you find that a variance for the proposed replacement system is needed, complete the Replacement Variance Request with your signature on reverse side of form.

PROPERTY OWNER:
 If has been determined by the Site Evaluator that a variance to the Rules is required for the proposed replacement system. This variance request is due to physical limitations of the site and/or soil conditions. Both the Site Evaluator and the LPI have considered the site/soil restrictions and have concluded that a replacement system in total compliance with the Rules is not possible.

PROPERTY OWNER

I understand that the proposed system requires a variance to the Rules. Should the proposed system malfunction, I release all concerned provided they have performed their duties in a reasonable and proper manner, and I will promptly notify the Local Plumbing Inspector and make any corrections required by the Rules. By signing the variance request form, I acknowledge permission for representatives of the Department to enter onto the property to perform such duties as may be necessary to evaluate the variance request.

 SIGNATURE OF OWNER

7/23/03
 DATE

LOCAL PLUMBING INSPECTOR

I, _____, the undersigned, have visited the above property and have determined to the best of my knowledge that it cannot be installed in compliance with the Rules. As a result of my review of the Replacement Variance Request, the Application, and my on-site investigation, I (check and complete either a or b):

a. (approve, disapprove) the variance request based on my authority to grant this variance. Note: If the LPI does not give his approval, he shall list his reasons for denial in Comments Section below and return to the applicant. —OR—

b. find that one or more of the requested Variances exceeds my approval authority as LPI. I (recommend, do not recommend) the Department's approval of the variances. Note: If the LPI does not recommend the Department's approval, the reasons shall be stated in Comments Section below as to why the proposed replacement system is not being recommended.

Comments: _____

LPI SIGNATURE

DATE

HHE-204 Rev 10/02

FORMS

Replacement System Variance Request

VARIANCE CATEGORY	LIMIT OF LPI'S APPROVAL AUTHORITY						VARIANCE REQUESTED TO:	
	SOILS							
Soil Profile	Ground Water Table			to 7"			10 inches	
Soil Condition	Restrictive Layer			to 7"			inches	
from HHE-200	Bedrock			to 12"			inches	
SETBACK DISTANCES (In feet)	Disposal Fields			Septic Tanks			Disposal Fields	Septic Tanks
From	Less than 1000 gpd	1000 to 2000 gpd	Over 2000 gpd	Less than 1000 gpd	1000 to 2000 gpd	Over 2000 gpd	To	To
Wells with water usage of 2000 or more gpd or public water supply wells	300 ft [a]	300 ft [a]	300 ft [a]	100 ft [a]	100 ft [a]	100 ft [a]		
Owner's wells	100 down to 60 ft	200 down to 100 ft	300 down to 150 ft	100 down to 50 ft [b]	100 down to 50 ft	100 down to 50 ft	87'	65'
Neighbor's wells	100 down to 60 ft [b]	200 down to 120 ft [b]	300 down to 180 ft [b]	100 down to 50 ft [b]	100 down to 75 ft [b]	100 down to 75 ft [b]		
Water supply line	10 ft [a]	20 ft [a]	25 ft [a]	10 ft [a]	10 ft [a]	10 ft [a]		
Water course, major - for replacements only, see Table 400.4 for major expansions	100 down to 60 ft	200 down to 120 ft	300 down to 180 ft	100 down to 50 ft	100 down to 50 ft	100 down to 50 ft	0'	
Water course, minor	50 down to 25 ft	100 down to 30 ft	150 down to 75 ft	50 down to 25 ft	50 down to 25 ft	50 down to 25 ft		
Drainage ditches	25 down to 12 ft	50 down to 25 ft	75 down to 35 ft	25 down to 12 ft	25 down to 12 ft	25 down to 12 ft		
Edge of fill extension - Coastal wetlands, special freshwater wetlands, great ponds, rivers, streams	25 ft [d]	25 ft [d]	25 ft [d]	25 ft [d]	25 ft [d]	25 ft [d]		
Slopes greater than 3:1	10 ft	18 ft	25 ft	N/A	N/A	N/A		
No full basement [e.g. slab, frost wall, columns]	15 down to 7 ft	30 down to 15 ft	40 down to 20 ft	8 down to 5 ft	14 down to 7 ft	20 down to 10 ft		
Full basement [below grade foundation]	20 down to 10 ft	30 down to 15 ft	40 down to 20 ft	8 down to 5 ft	14 down to 7 ft	20 down to 10 ft		
Property lines	10 down to 5 ft [c]	18 down to 9 ft [c]	20 down to 10 ft [c]	10 down to 4 ft [c]	15 down to 7 ft [c]	20 down to 10 ft [c]	5'	
Burial sites or graveyards, measured from the down toe of the fill extension	25 ft	25 ft	25 ft	25 ft	25 ft	25 ft		

OTHER

1. Fill extension Grade - to 3:1

2. Minor filling of cattail bog which appears on USGS 7 1/2'

3. Portland East Quad - no alternative available.

Footnotes: [a.] Single-family well setbacks may be reduced as prescribed in Section 701.2.

[b.] This distance may be reduced to 25 feet, if the septic or holding tank is tested in the plumbing inspector's presence and shown to be watertight or of monolithic construction.

[c.] Additional setbacks may be needed to prevent fill material extensions from encroaching onto abutting property.

[d.] Additional setbacks may be required by local Shoreland zoning.

[e.] Natural Resource Protection Act requires a 25 feet setback, on slopes of less than 20%, from the edge of soil disturbance and 100 feet on slopes greater than 20%. See Chapter 15.

[f.] May not be any closer to neighbors well than the existing disposal field or septic tank unless written permission is granted by the neighbor.

This setback may be reduced for single family houses with Department approval. See Section 702.3.

[g.] The fill extension shall reach the existing ground before the 3:1 slope or within 100 feet of the disposal field.

[h.] See Section 1402.10 for special procedures when these minimum setbacks cannot be achieved.

Mark Quinn

 SITE EVALUATOR'S SIGNATURE

Revised
 4-18-03
 10-31-02

 DATE 6-25-03

FOR USE BY THE DEPARTMENT ONLY

The Department has reviewed the variance(s) and (does does not) give its approval. Any additional requirements, recommendations, or reasons for the Variance denial, are given in the attached letter.

 SIGNATURE OF THE DEPARTMENT

 DATE