

# SUBSURFACE WASTEWATER DISPOSAL SYSTEM APPLICATION

Maine Department of Human Services  
 Division of Health Engineering, Station 10 SIS  
 (207) 207-6672 FAX (207) 287-4179

Town, City, Plantation: PEAKS ISLAND, PORTLAND  
 Street, Road, Subdivision: 68 WINDING WAY  
 Owner's Name: RAI PH ASHMORE

NOTE: THOROUGHLY SCARIFY (WITH ROTOTILLERS) SUBSURFACE WASTEWATER DISPOSAL PLAN OR EXCAVATOR TEETH) UNDER ENTIRE DISPOSAL FIELD, SHOULDER AREA, & FILL EXTENSION AREA EXISTING PRIOR TO FILL PLACEMENT, THEN MIX FIRST 4" THICK LAYERS OF FILL INTO EXISTING SOIL SURFACE TO PROMOTE MIXING

SCALE 1" = 20' F.I.

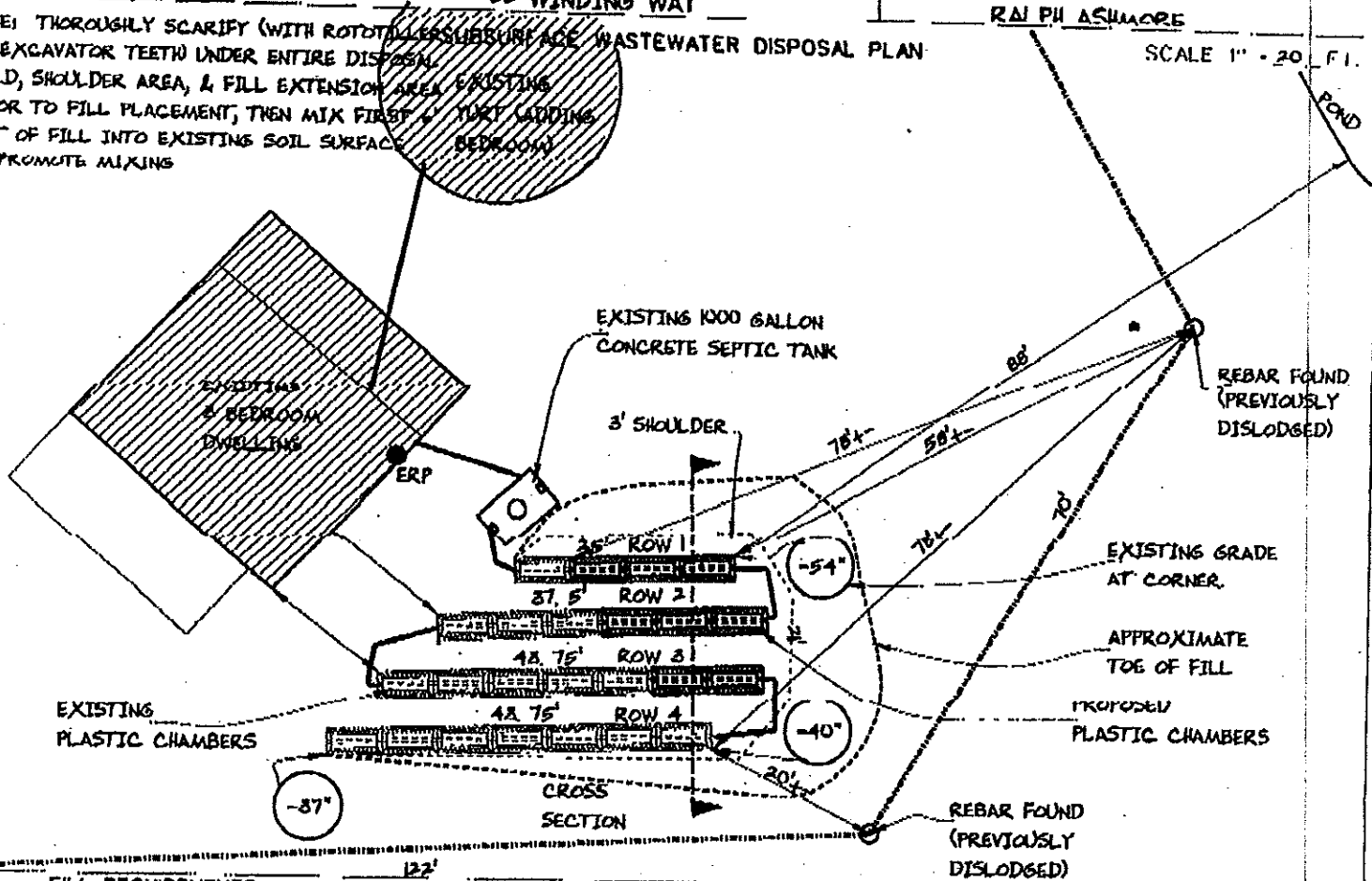

**FILL REQUIREMENTS**

Depth of Fill (Upslope)	= 22"
Depth of Fill (Downslope)	= 28"
DEPTHS AT CROSS-SECTION (shown below)	

**CONSTRUCTION ELEVATIONS**

Finished Grade Elevation	
Top of Distribution Pipe or Proprietary Device	
Bottom of Disposal Area	

**ELEVATION REFERENCE POINT**  
 Location & Description: TOP OF DRYER VENT  
 15" ABOVE BOTTOM OF SIDING  
 Reference Elevation is: 0.0" or \_\_\_\_\_

SCALE:  
 VERTICAL: 1" = 5 FT  
 HORIZONTAL: 1" = 10 FT

**DISPOSAL AREA CROSS SECTION**

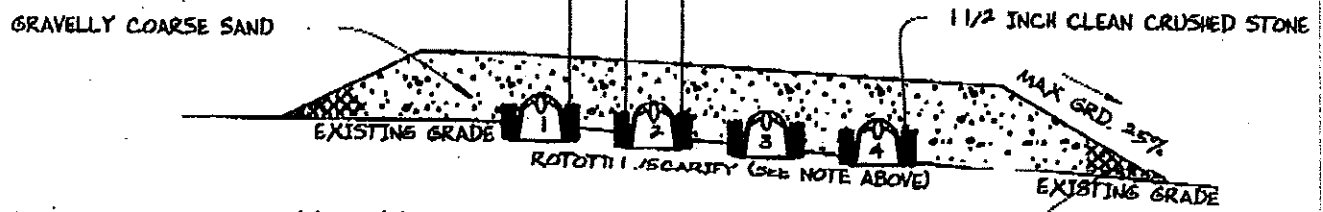
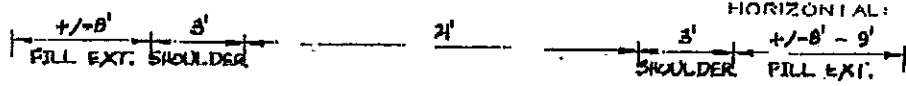

DEPTH BELOW ERP

	ROW 1 (2)	(3)	(4)
CLEAN BACKFILL	-32"	-34"	-36"
CLEAN BACKFILL	-41"	-43"	-45"
CLEAN BACKFILL	-57"	-59"	-61"
CLEAN BACKFILL	-47"	-49"	-51"

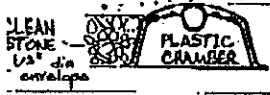

Received Time Jun. 7. 7:54AM