

F. S.F. DEVL. NO. RECORD OF OWNERSHIP

ELLSWORTH CHARLES W JR
 8600 SIXTEENTH ST
 APT 804
 SILVER SPRINGS MD 20910

85-N-3 SEASHORE AVE
 PEAKS ISLAND
 3280 SF

IR-2
 2/2

NEW ACCOUNT FTG. DEPTH ZOR UNIT PRICE DEPTH ADJ. LAND LAND REVISED EXEMPT DATE TYPE SALE PRICE SOURCE VALIDITY

3280 150 117 152 4990 16270 21260 19630 4990 15310 670

GENERAL PROPERTY FACTORS NEIGHBORHOOD ID. LAND COMPUTATIONS

TOPOGRAPHY RATING	GOOD	POOR	VERY POOR
PAVED UNPAVED PROPOSED	YES	NO	NO
SIDEWALK	YES	NO	NO
UTILITIES	YES	NO	NO
ALLEY	YES	NO	NO
WATER	2	1	0
SEWER	2	1	0
ELECTRICITY	2	1	0
GAS	2	1	0

LAND ADJUSTMENT %	
TOPO	MISIMP.
VACANT	CORNER
SIZE	RESTRICTION
SHAPE	
EXC. FTG.	

DATE	PERMIT NO.	AMOUNT	DESCRIPTION	8	NOTES:	LAND BUILDING	TOTAL
11/82	989	950	7' x 11' Addition - Rear	✓		1,340	6,760
							8,100

BUILDING PERMIT RECORD	8	NOTES:	LAND BUILDING	TOTAL
			1,340	6,760
				8,100

ASSESSMENT RECORD	ASSESSMENT	INCREASE	DECREASE
LAND	4990		
BLDG.	14640		
TOTAL	19630		
BLDG.	4990		
TOTAL	15310	670	
LAND	20300		
BLDG.			
TOTAL			

Map

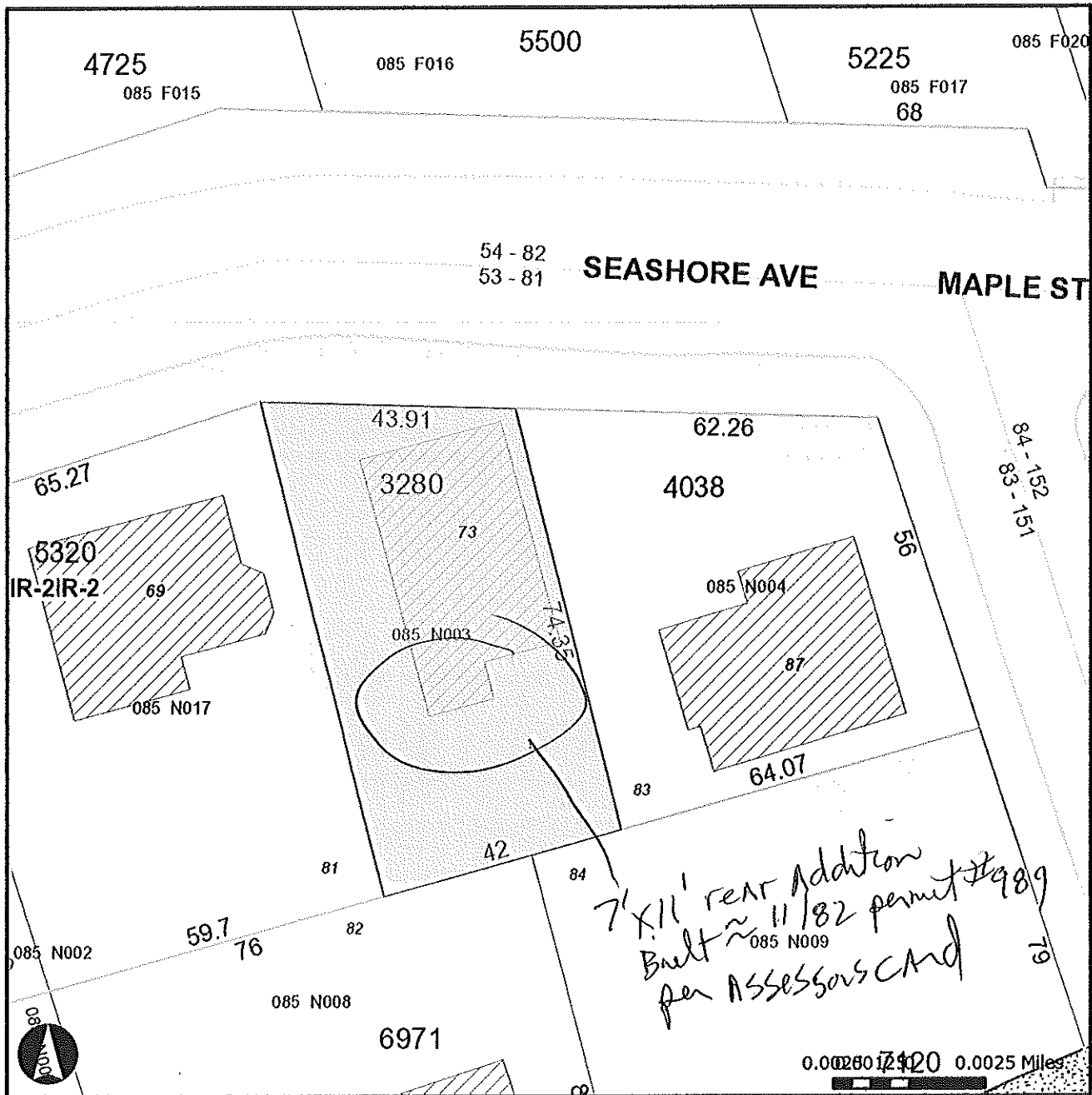

Address Candidates

- Address Candidates
- Parcels
- Interstate
- Streets
- Buildings

Shoreland Overlay Zone

- Stream Overlay Zone
- Stream_protection
- Island Zoning**
- C43
- I-B
- I-TS

Zoning (continued)

- OP Office Park
- R1 Residential
- R2 Residential
- R3 Residential
- R4 Residential
- R5 Residential
- R6 Residential

Zoning (continued)

- C23
- C24
- C25
- C26
- C27
- C28
- C29