

SPRUCE AVE.

MERRIAM ST.

OCEAN VIEW TERRACE

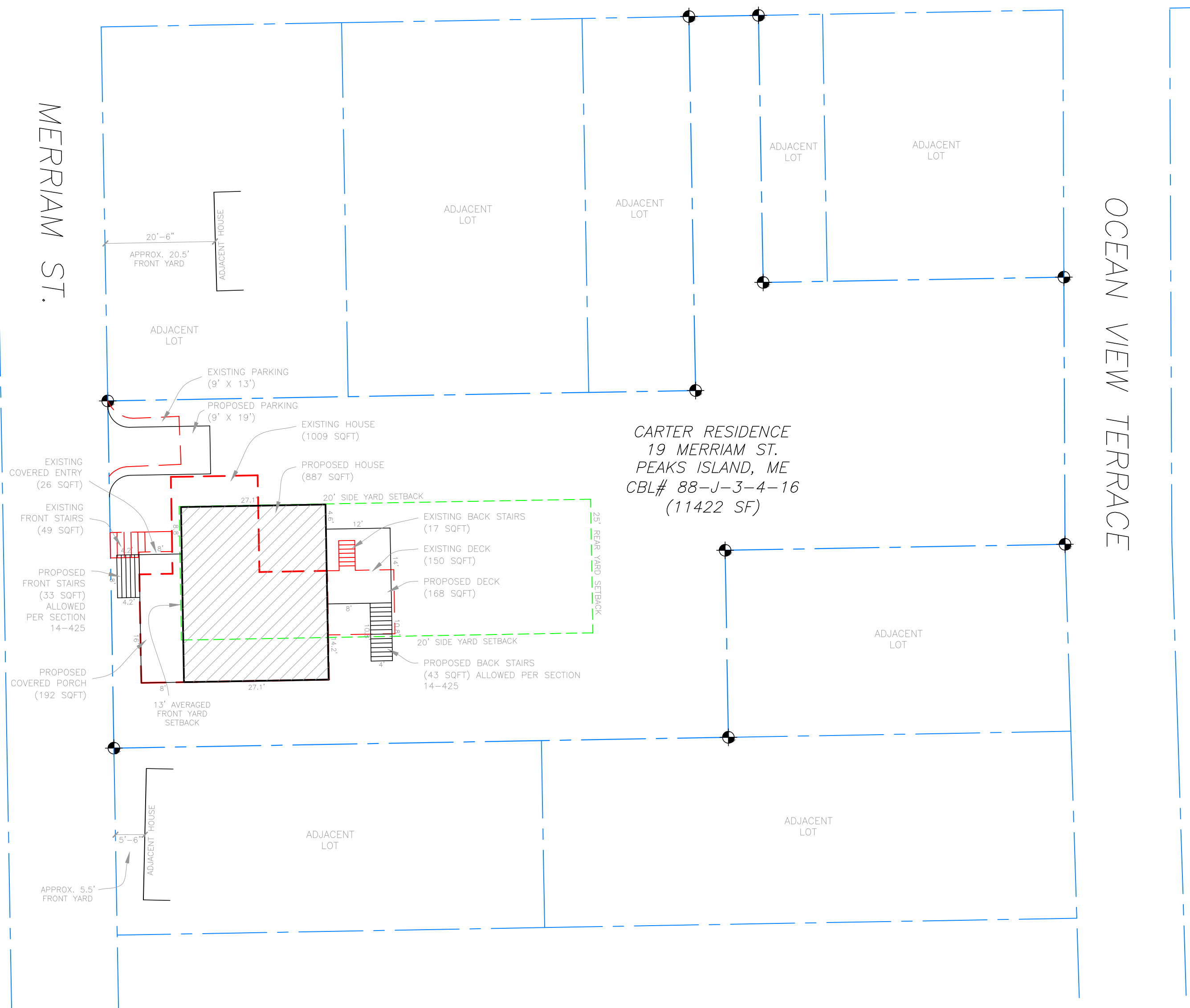

CARTER RESIDENCE
19 MERRIAM ST.
PEAKS ISLAND, ME
CBL# 88-J-3-4-16
(11422 SF)

LOT COVERAGE CALCULATIONS:
CALCULATIONS ASSUME TOTAL DEMOLITION
OF ALL EXISTING STRUCTURE

EXISTING LOT 11422 SF X (.20)	=2284 SF ALLOWABLE
EXISTING HOUSE	1009 SF
EXISTING FRONT STAIRS	49 SF
EXISTING COVERED ENTRY	26 SF
EXISTING DECK	150 SF
EXISTING BACK STAIRS	17 SF
TOTAL EXISTING FOOTPRINT	=1251 SF
PROPOSED HOUSE	887 SF
PROPOSED FRONT STAIRS	33 SF
PROPOSED COVERED PORCH	192 SF
PROPOSED DECK	168 SF
PROPOSED BACK STAIRS	43 SF
TOTAL PROPOSED FOOTPRINT	=1323 SF
ALLOWABLE FOOTPRINT REMAINING (2284-1323)	= 961 SF

Rachel Conly
Architectural Design

26 Sterling Street
Peaks Island, Maine 04108
207.766.5625

Proposed
Site Plan

PROJECT

Carter Residence
19 Merriam St.
Peaks Island, ME
04106

DATE
12.20.14

REVISED

SCALE
1/16" = 1'-0"

DRAWN BY
Rachel &
Harvey

NOTES

A Proposed Site Plan
1/16" = 1'-0"

Magnetic

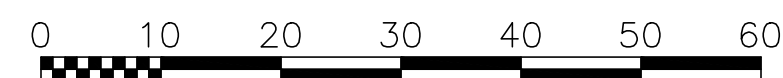
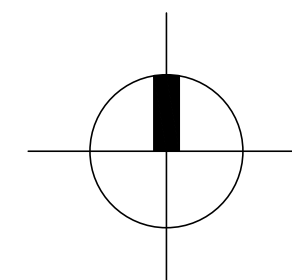

A2