

City of Portland, Maine - Building or Use Permit Application

389 Congress Street, 04101 Tel: (207) 874-8703, Fax: (207) 874-8716

Permit No: 04-0200	PERMIT ISSUED Issue Date: MAR 05 2004	CBL: 085 G016001
-----------------------	---	---------------------

Location of Construction: 48 Spruce Ave	Owner Name: Weiskamp Keith Trustees	Owner Address: 48 Spruce Ave	Phone:
Business Name:	Contractor Name: Thompson & Johnson Woodworkers	Contractor Address: 344 Seashore Ave Peaks Island	Phone: 2077665219
Lessee/Buyer's Name	Phone:	Permit Type: Alterations - Dwellings	Zone: I.R.-2

Past Use: single family	Proposed Use: single family - interior alterations	Permit Fee: \$1,011.00	Cost of Work: \$110,000.00	CEO District: 1
----------------------------	---	---------------------------	-------------------------------	--------------------

FIRE DEPT: <input type="checkbox"/> Approved <input type="checkbox"/> Denied <i>N/A</i>	INSPECTION: Use Group: <i>R-3</i> Type: <i>SB</i> <i>BOCA 1999</i>
Signature:	Signature:

Proposed Project Description:
interior renovations

PEDESTRIAN ACTIVITIES DISTRICT (P.A.D.)

Action: Approved Approved w/Conditions Denied

Signature: _____ Date: _____

Permit Taken By: tmm	Date Applied For: 03/05/2004	Zoning Approval
-------------------------	---------------------------------	------------------------

<p>1. This permit application does not preclude the Applicant(s) from meeting applicable State and Federal Rules.</p> <p>2. Building permits do not include plumbing, septic or electrical work.</p> <p>3. Building permits are void if work is not started within six (6) months of the date of issuance. False information may invalidate a building permit and stop all work..</p>	<p>Special Zone or Reviews</p> <p><input type="checkbox"/> Shoreland</p> <p><input type="checkbox"/> Wetland</p> <p><input type="checkbox"/> Flood Zone</p> <p><input type="checkbox"/> Subdivision</p> <p><input type="checkbox"/> Site Plan</p> <p>Maj <input type="checkbox"/> Minor <input type="checkbox"/> MM <input type="checkbox"/></p> <p>Date: _____</p>	<p>Zoning Appeal</p> <p><input type="checkbox"/> Variance</p> <p><input type="checkbox"/> Miscellaneous</p> <p><input type="checkbox"/> Conditional Use</p> <p><input type="checkbox"/> Interpretation</p> <p><input type="checkbox"/> Approved</p> <p><input type="checkbox"/> Denied</p> <p>Date: _____</p>	<p>Historic Preservation</p> <p><input type="checkbox"/> Not in District or Landmark</p> <p><input type="checkbox"/> Does Not Require Review</p> <p><input type="checkbox"/> Requires Review</p> <p><input type="checkbox"/> Approved</p> <p><input type="checkbox"/> Approved w/Conditions</p> <p><input type="checkbox"/> Denied</p> <p>Date: _____</p>
---	--	--	--



CERTIFICATION

I hereby certify that I am the owner of record of the named property, or that the proposed work is authorized by the owner of record and that I have been authorized by the owner to make this application as his authorized agent and I agree to conform to all applicable laws of this jurisdiction. In addition, if a permit for work described in the application is issued, I certify that the code official's authorized representative shall have the authority to enter all areas covered by such permit at any reasonable hour to enforce the provision of the code(s) applicable to such permit.

SIGNATURE OF APPLICANT	ADDRESS	DATE	PHONE
RESPONSIBLE PERSON IN CHARGE OF WORK, TITLE		DATE	PHONE

DISPLAY THIS CARD ON PRINCIPAL FRONTAGE OF WORK CITY OF PORTLAND

BUILDING INSPECTION

PERMIT

Permit Number: 040200

Please Read
Application And
Notes, If Any,
Attached

This is to certify that Weiskamp Keith Trustees/Tompson & Johnson Woodwork

has permission to interior renovations

AT 48 Spruce Ave 085 G016001

provided that the person or persons who accept this permit shall comply with all of the provisions of the Statutes of the State and of the Ordinances of the City of Portland regulating the construction, maintenance and use of buildings and structures, and of the application on file in this department.

Apply to Public Works for street line and grade if nature of work requires such information.

Notification of inspection must be given and when permission procedure before this building or part thereof is started or otherwise closed-in. 4 HOUR NOTICE REQUIRED.

A certificate of occupancy must be procured by owner before this building or part thereof is occupied.

OTHER REQUIRED APPROVALS
Fire Dept. _____
Health Dept. _____
Appeal Board _____
Other _____

PERMIT ISSUED
MAR 05 2004
Department Name
CITY OF PORTLAND

[Signature]
Director - Building & Inspection Services

PENALTY FOR REMOVING THIS CARD

BUILDING PERMIT INSPECTION PROCEDURES

Please call 874-8703 or 874-8693 to schedule your inspections as agreed upon

Permits expire in 6 months, if the project is not started or ceases for 6 months.

The Owner or their designee is required to notify the inspections office for the following inspections and provide adequate notice. Notice must be called in 48-72 hours in advance in order to schedule an inspection:

By initializing at each inspection time, you are agreeing that you understand the inspection procedure and additional fees from a "Stop Work Order" and "Stop Work Order Release" will be incurred if the procedure is not followed as stated below.

 Pre-construction Meeting: Must be scheduled with your inspection team upon receipt of this permit. Jay Reynolds, Development Review Coordinator at 874-8632 must also be contacted at this time, before **any** site work begins on any project other than single family additions or alterations.

Footing/Building Location Inspection: Prior to pouring concrete

 Re-Bar Schedule Inspection: Prior to pouring concrete

 Foundation Inspection: Prior to placing ANY backfill

Framing/Rough Plumbing/Electrical: Prior to any insulating or drywalling

Final/Certificate of Occupancy: Prior to any occupancy of the structure or use. NOTE: There is a \$75.00 fee per inspection at this point.

Certificate of Occupancy is not required for certain projects. Your inspector can advise you if your project requires a Certificate of Occupancy. All projects DO require a final inspection

 If any of the inspections do not occur, the project cannot go on to the next phase, REGARDLESS OF THE NOTICE OR CIRCUMSTANCES.

 CERIFICATE OF OCCUPANICES MUST BE ISSUED AND PAID FOR, BEFORE THE SPACE MAY BE OCCUPIED

Deborah Thompson 3/5/04
Signature of Applicant/Designee Date
[Signature] 3/5/04
Signature of Inspections Official Date

CBL: 85-G-16 Building Permit #: 04-0200

All Purpose Building Permit Application

If you or the property owner owes real estate or personal property taxes or user charges on any property within the City, payment arrangements must be made before permits of any kind are accepted.

Location/Address of Construction: <u>48 Spruce Ave Peaks Island</u>		
Total Square Footage of Proposed Structure <u>1364</u>	Square Footage of Lot <u>.056 acres</u>	
Tax Assessor's Chart, Block & Lot Chart# <u>85</u> Block# <u>6</u> Lot# <u>16</u>	Owner: <u>Kerth Weiskamp</u>	Telephone: <u>766-5919</u>
Lessee/Buyer's Name (If Applicable)	Applicant name, address & telephone: <u>Thompson Johnson Woodworks</u> <u>115 Island Ave Peaks</u>	Cost Of Work: \$ <u>87,500</u> Fee: \$
Current use: <u>Single family Residence</u> <u>04108</u>		
If the location is currently vacant, what was prior use: _____		
Approximately how long has it been vacant: _____		
Proposed use: _____		
Project description: <u>Renovation</u>		
Contractor's name, address & telephone: <u>Thompson Johnson Woodworks 766-5919</u>		
Who should we contact when the permit is ready: <u>Harvey Johnson</u>		
Mailing address: <u>115 Island Ave Peaks Island ME 04108</u>		
We will contact you by phone when the permit is ready. You must come in and pick up the permit and review the requirements before starting any work, with a Plan Reviewer. A stop work order will be issued and a \$100.00 fee if any work starts before the permit is picked up. PHONE: 766-5919		

IF THE REQUIRED INFORMATION IS NOT INCLUDED IN THE SUBMISSIONS THE PERMIT WILL BE AUTOMATICALLY DENIED AT THE DISCRETION OF THE BUILDING/PLANNING DEPARTMENT, WE MAY REQUIRE ADDITIONAL INFORMATION IN ORDER TO APPROVE THIS PERMIT.

I hereby certify that I am the Owner of record of the named property, or that the owner of record authorizes the proposed work and that I have been authorized by the owner to make this application as his/her authorized agent. I agree to conform to all applicable laws of this jurisdiction. In addition, if a permit for work described in this application is issued, I certify that the Code Official's authorized representative shall have the authority to enter all areas covered by this permit at any reasonable hour to enforce the provisions of the codes applicable to this permit.

Signature of applicant: 	Date: <u>3/1/04</u>
---	---------------------

This is NOT a permit, you may not commence ANY work until the permit is issued.
If you are in a Historic District you may be subject to additional permitting and fees with the Planning Department on the 4th floor of City Hall

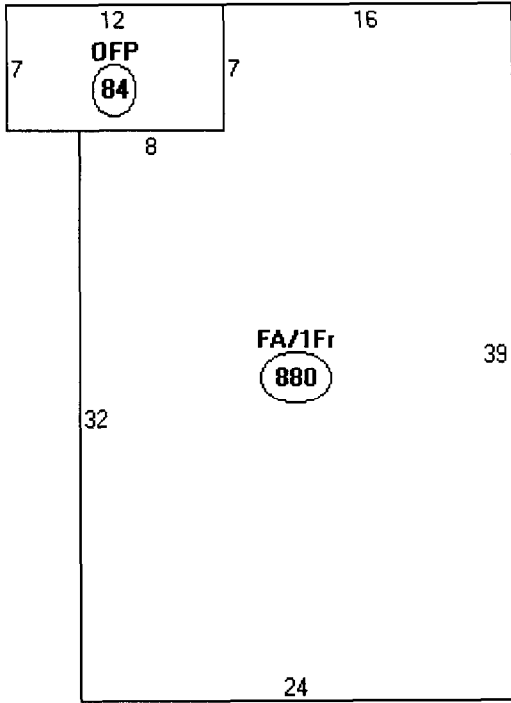

Descriptor/Area

A: FA/1Fr
880 sqft

B: OFF
84 sqft

IR-2
lot size - 2420 SF
20%

This page contains a detailed description of the Parcel ID you selected. Press the **New Search** button at the bottom of the screen to submit a new query.

Current Owner Information

Card Number 1 of 1
Parcel ID 085 G016001
Location 48 SPRUCE AVE
Land Use SINGLE FAMILY

Owner Address WEISKAMP KEITH TRUSTEES RUTH ETTA GREIF QUALIFIED
 48 SPRUCE AVE
 PEAKS ISLAND ME 04108

Book/Page 19755/126
Legal 85-G-16
 SPRUCE AVE
 PEAKS ISLAND
 2420 SF

Valuation Information

Land	Building	Total
\$19,430	\$64,260	\$83,690

Property Information

Year Built 1900	Style Old Style	Story Height 1	Sq. Ft. 1364	Total Acres 0.056		
Bedrooms 3	Full Baths 1	Half Baths	Total Rooms 5	Attic Full Fin./wh	Basement Pier/slab	

Outbuildings

Type	Quantity	Year Built	Size	Grade	Condition
-------------	-----------------	-------------------	-------------	--------------	------------------

Sales Information

Date	Type	Price	Book/Page
07/01/2003	LAND + BLDING	\$248,000	19755-126
04/01/2002	LAND + BLDING	\$167,500	17494-95
06/04/2001	LAND + BLDING		16374-330
12/06/2000	LAND + BLDING		15888-120
10/15/1999	LAND + BLDING	\$127,500	15110-094

Picture and Sketch

Picture Sketch

[Click here](#) to view Tax Roll Information.

Any information concerning tax payments should be directed to the Treasury office at 874-8490 or e-mailed.





IMG_6775.JPG



IMG_6776.JPG



IMG_6777.JPG



IMG_6791.JPG



IMG_6784.JPG



IMG_6782.JPG



IMG_6787.JPG



IMG_6785.JPG