

**PROPERTY ADDRESS**

Town Or Plantation: PORTLAND PEAKS ISLAND

Street: SPRUCE AVENUE

Subdivision Lot #: MAP 85 BLOCK G LOTS 15, 17

**PROPERTY OWNERS NAME**

Last: FEENEY First: JOHN

Applicant Name: JOHN FEENEY

Mailing Address of Owner/Applicant (If Different): HUSSEY ROAD PEAKS ISLAND, ME 04108

085-G-015/017

PORTLAND Date Permit Issued: 11/22/98

6361 TOWN COPY \$140.00 FEE # Double Fee Charged

L.P.I. # 0,1,2,4

Local Plumbing Inspector Signature: *[Signature]*

**Owner/Applicant Statement**

I certify that the information submitted is correct to the best of my knowledge and understand that any falsification is reason for the Local Plumbing Inspector to deny a Permit.

Signature of Owner/Applicant: *John Feeney* Date: \_\_\_\_\_

**Caution: Inspection Required**

I have inspected the installation authorized above and found it to be in compliance with the Subsurface Wastewater Disposal Rules.

Local Plumbing Inspector Signature: *Merle Leary* Date Approved: 2/3/98

**PERMIT INFORMATION**

**THIS APPLICATION IS FOR:**

- NEW SYSTEM
- REPLACEMENT SYSTEM
- EXPANDED SYSTEM
- SEASONAL CONVERSION
- EXPERIMENTAL SYSTEM

**IF REPLACEMENT SYSTEM:**  
YEAR FAILING SYSTEM INSTALLED: 1930<sup>+</sup>  
THE FAILING SYSTEM IS:  
1.  BED 3.  TRENCH  
2.  CHAMBER 4.  OTHER: CESS POOL

**THIS APPLICATION REQUIRES:**

- NO RULE VARIANCE REQUIRED
- NEW SYSTEM VARIANCE Attach New System Variance Form
- REPLACEMENT SYSTEM VARIANCE Attach Replacement System Variance Form
- Requires only Local Plumbing Inspector Approval
- Requires both State and Local Plumbing Inspector Approval

**DISPOSAL SYSTEM TO SERVE:**

- SINGLE FAMILY DWELLING
- MODULAR OR MOBILE HOME
- MULTIPLE FAMILY DWELLING
- OTHER \_\_\_\_\_ SPECIFY

**INSTALLATION IS COMPLETE SYSTEM**

- NON-ENGINEERED SYSTEM
- PRIMITIVE SYSTEM (Includes Alternative Toilet)
- ENGINEERED (+ 2000 gpd)

**INDIVIDUALLY INSTALLED COMPONENTS:**

- TREATMENT TANK (ONLY)
- HOLDING TANK
- ALTERNATIVE TOILET (ONLY)
- NON-ENGINEERED DISPOSAL AREA (ONLY)
- ENGINEERED DISPOSAL AREA (ONLY)
- SEPARATED LAUNDRY SYSTEM

SIZE OF PROPERTY: 9751 SF ZONING: IR2

TYPE OF WATER SUPPLY: PUBLIC WATER

**DESIGN DETAILS (SYSTEM LAYOUT SHOWN ON PAGE 3)**

**TREATMENT TANK**

- SEPTIC:  Regular  Low Profile
- AEROBIC

SIZE: 1000 GALS.

**WATER CONSERVATION**

- NONE
- LOW VOLUME TOILET
- SEPARATED LAUNDRY SYSTEM
- ALTERNATIVE TOILET

SPECIFY: \_\_\_\_\_

**PUMPING**

- NOT REQUIRED
- MAY BE REQUIRED (DEPENDING ON TREATMENT TANK LOCATION AND ELEVATION)
- REQUIRED

DOSE: \_\_\_\_\_ GALS.

**CRITERIA USED FOR DESIGN FLOW (BEDROOMS, SEATING, EMPLOYEES, WATER RECORDS, ETC.)**

2 BEDROOM

**SOIL CONDITIONS USED FOR DESIGN PURPOSES**

PROFILE: 4 CONDITION: AIII

DEPTH TO LIMITING FACTOR: 21

**SIZE RATINGS USED FOR DESIGN PURPOSES**

- SMALL
- MEDIUM
- MEDIUM-LARGE
- LARGE
- EXTRA LARGE

**DISPOSAL AREA TYPE/SIZE**

- BED \_\_\_\_\_ Sq. Ft.
- CHAMBER 484\* Sq. Ft.  REGULAR  H-20
- TRENCH \_\_\_\_\_ Linear Ft.
- OTHER: \_\_\_\_\_

DESIGN FLOW: 180 (GALLONS/DAY)

**SITE EVALUATOR STATEMENT \* USED 11 INFILTRATOR POLYETHELENE CHAMBERS IN TRENCH CONFIGURATION (SITE EVALUATION WAIVED BY LOCAL OPTION)**

On SEPTEMBER 26, 1986 (date) I conducted a site evaluation for this project and certify that the data reported is accurate. The system I propose is in accordance with the Subsurface Wastewater Disposal Rules.

Site Evaluator or Professional Engineer's Signature: *William B. Goodwin* SE# / PE#: 0003/4814 Date: 11/24/97

\* Local Plumbing Inspector Signature if a Local Site Evaluation Waiver under a Local Option OF THE ORIGINAL SITE EVALUATION CONDUCTED IN 1986 AND WERE PREPARED AND DESIGNED BY NORMAN V. TWADDEL Norman V Twaddel 11/12/97

NOTE: THESE NEW HHE-200 FORMS ARE A MODIFICATION OF THE ORIGINAL HHE-200 FORMS PREPARED AND DESIGNED BY NORMAN V. TWADDEL

Page 1 of 3 HHE-200 Rev. 4/83

# SUBSURFACE WASTEWATER DISPOSAL SYSTEM APPLICATION

Department of Human Services  
Division of Health Engineering

Town, City, Plantation

Street, Road, Subdivision

Owners Name

PORTLAND PEAKS ISLAND NEW ISLAND AVE 85-6-13, 14, 15, 17

JOHN FEENEY

SITE PLAN

Scale 1" = 40 Ft.

SITE LOCATION PLAN (Attach

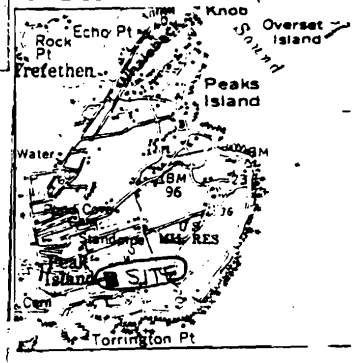

NEW ISLAND AVE

ERP TOP OF  
1200 PIPE

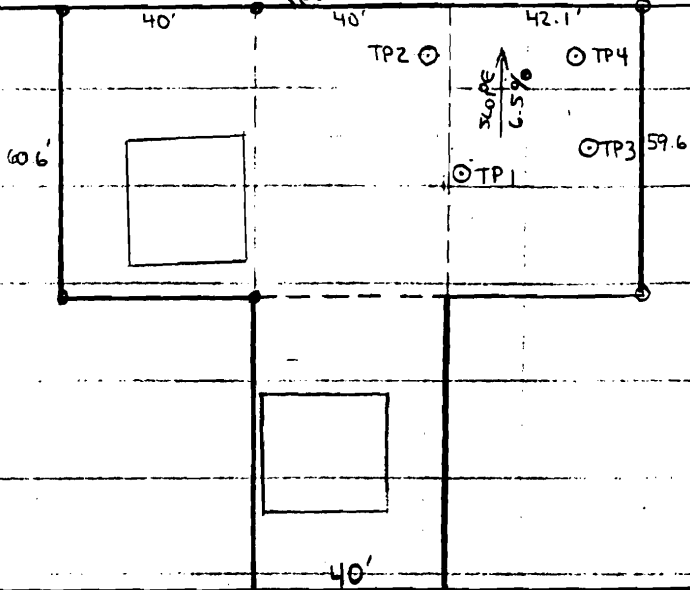

SPRUCE AVE

## SOIL DESCRIPTION AND CLASSIFICATION

(Location of Observation Holes Shown Above)

Observation Hole 1  Test Pit  Boring  
3" FOREST PEAT \* Depth of Organic Horizon Above Mineral Soil

DEPTH BELOW MINERAL SOIL SURFACE (Inches)	Texture	Consistency	Color	Mottling
0	SILTY LOAM	LOOSE	DARK BROWN	
6				
10	CLAYEY LOAM	FRIABLE	YELLOW BROWN	NONE
15				
20				
25	VERY STONY SILTY GRAVEL	SLIGHTLY FRIABLE	RED BROWN	FEW
30				
35				
40	VERY STONY SILTY GRAVEL	LOOSE	YELLOW BROWN	
45				
50				

Soil Profile <u>4</u>	Classification Condition <u>C</u>	Slope <u>6 1/2 %</u>	Limiting Factor <u>26</u>	<input checked="" type="checkbox"/> Ground Water <input type="checkbox"/> Restrictive Layer <input type="checkbox"/> Bedrock
-----------------------	-----------------------------------	----------------------	---------------------------	--

Observation Hole 3  Test Pit  Boring  
2" FOREST PEAT \* Depth of Organic Horizon Above Mineral Soil

DEPTH BELOW MINERAL SOIL SURFACE (Inches)	Texture	Consistency	Color	Mottling
0				
6	SILTY LOAM	FRIABLE	GRAY BROWN	NONE
10				
15				
20	VERY STONY SILTY GRAVEL	LOOSE	RED BROWN	FEW
25				
30	BEDROCK			
35				
40				
45				
50				

Soil Profile <u>4</u>	Classification Condition <u>AIII</u>	Slope <u>6 1/2 %</u>	Limiting Factor <u>21</u>	<input checked="" type="checkbox"/> Ground Water <input type="checkbox"/> Restrictive Layer <input type="checkbox"/> Bedrock
-----------------------	--------------------------------------	----------------------	---------------------------	--

*William B. Goodwin*  
Site Evaluator or Professional Engineer's Signature

0003/4814  
SE# / PE#

11/24/97  
Date

# SUBSURFACE WASTEWATER DISPOSAL SYSTEM APPLICATION

Department of Human Services  
Division of Health Engineering

2

Town, City, Plantation

Street, Road, Subdivision

Owners Name

PORTLAND PEAKS ISLAND

SPRUCE AVE 85-G-13, 14, 15, 17

JOHN FEENEY

## SUBSURFACE WASTEWATER DISPOSAL PLAN

Scale 1" = 20' PL.

### NEW ISLAND AVENUE

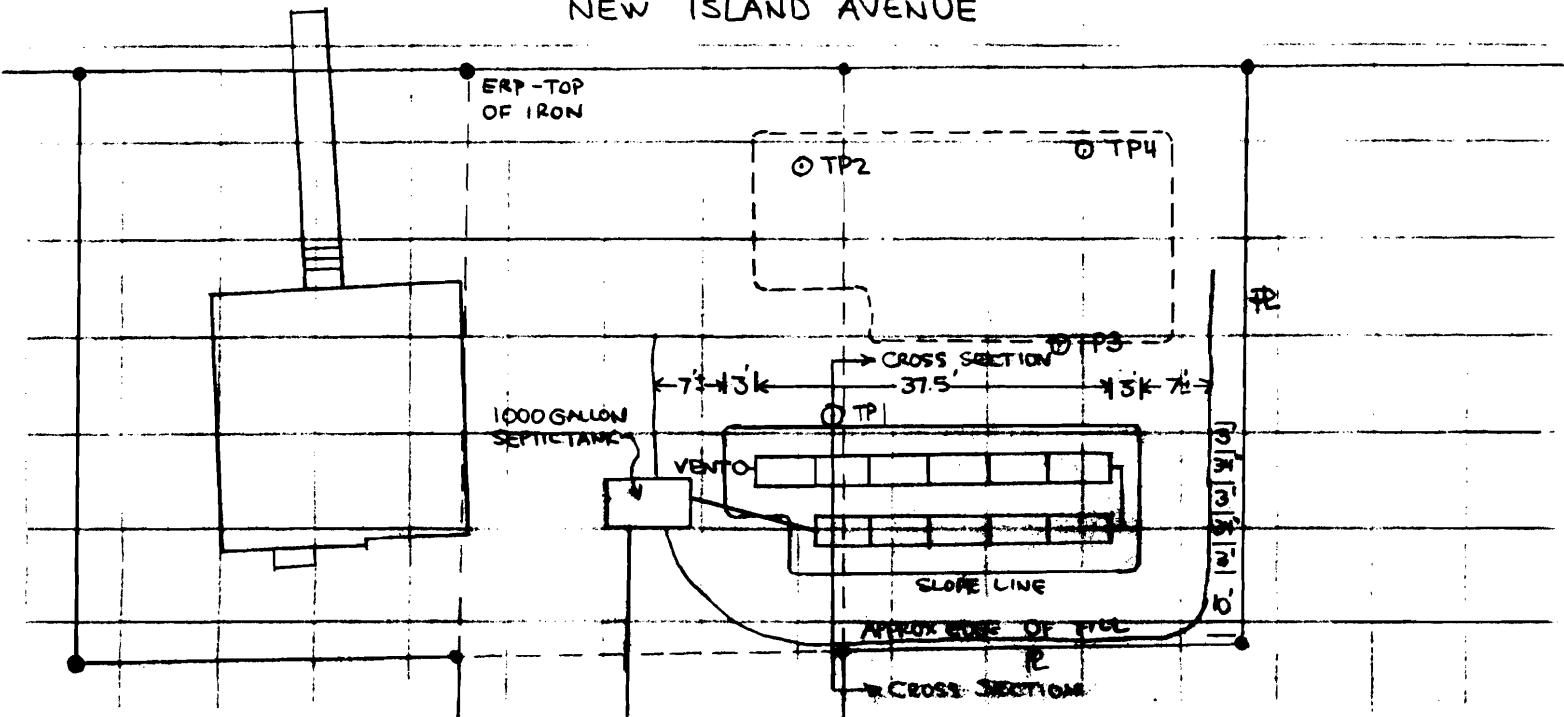

FILL REQUIREMENTS		CONSTRUCTION ELEVATIONS		ELEVATION REFERENCE POINT LOCATION & DESCRIPTION	
Depth of Fill (Upslope)	50'	Reference Elevation is	100.00	TOP OF IRON PIPE AT NORTH WEST CORNER OF LOT 85-G-14	
Depth of Fill (Downslope)	57'	Bottom of Disposal Area	SEE CROSS SECTION		
		Top of Distribution Lines or Chambers	" " "		

### DISPOSAL AREA CROSS SECTION

Scale:

Vertical: 1 inch = 5' PL.  
Horizontal: 1 inch = 10' PL.

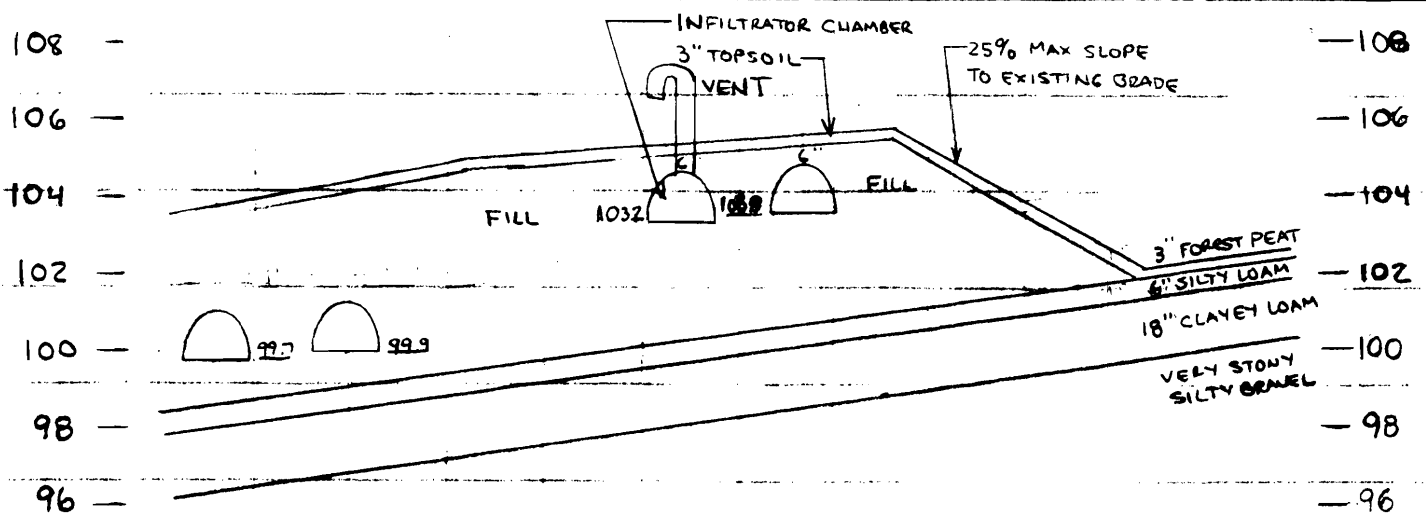

*William B. Goodwin*  
Site Evaluator or Professional Engineer's Signature

0003/4814  
SE # / PE #

11/24/97  
Date