

DISPLAY THIS CARD ON PRINCIPAL FRONTAGE OF WORK CITY OF PORTLAND

Please Read Application And Notes, if Any, Attached

BUILDING INSPECTION

PERMIT

Permit Number: 060589

PERMIT ISSUED

JUL 19 2006

CITY OF PORTLAND

This is to certify that Carlisle Justine C /John Kiel

has permission to Demolition of storage shed.

AT 14 Spruce Ave, P.I.

085 G005001

provided that the person or persons, firm or corporation accepting this permit shall comply with all of the provisions of the Statutes of the State and of the Ordinances of the City of Portland regulating the construction, maintenance and use of buildings and structures, and of the application on file in this department.

Apply to Public Works for street line and grade if nature of work requires such information.

Notification of inspection must be given and when permission procedure before this building or part thereof is loaded or closed-in. 24 HOUR NOTICE IS REQUIRED.

A certificate of occupancy must be procured by owner before this building or part thereof is occupied.

OTHER REQUIRED APPROVALS

Fire Dept. _____

Health Dept. _____

Appeal Board _____

Other _____

Department Name

Jeannie Bouke 6/21/06
Director - Building & Inspection Services

PENALTY FOR REMOVING THIS CARD

City of Portland, Maine - Building or Use Permit Application

389 Congress Street, 04101 Tel: (207) 874-8703, Fax: (207) 874-8716

PERMIT ISSUED

Permit No: 06-0573	Issue Date: JUL 19 2006	CBL: 085 G005001
-----------------------	----------------------------	---------------------

Location of Construction: 14 Spruce Ave, <i>PT</i>	Owner Name: Carlisle Justine C	Owner Address: 30 Adelbert St	Phone: 767-8183
---	-----------------------------------	----------------------------------	--------------------

Business Name:	Contractor Name: John Kiely	Contractor Address: 591 Island Ave Peaks Island	Phone: 2077662026
----------------	--------------------------------	--	----------------------

Lessee/Buyer's Name	Phone:	Permit Type: Demolitions	Zone: <i>TR-2</i>
---------------------	--------	-----------------------------	----------------------

Past Use: Single Family	Proposed Use: Single Family	Permit Fee: \$48.00	Cost of Work: \$3,000.00	CEO District: 2
----------------------------	--------------------------------	------------------------	-----------------------------	--------------------

FIRE DEPT: <input type="checkbox"/> Approved <input type="checkbox"/> Denied	INSPECTION: Use Group <i>R3</i> Type: <i>Demol</i>
--	--

Proposed Project Description:
Demolition of storage shed. *is sleeping quarters only (this outbuilding is not a separate dwelling unit).*

Signature:	Signature: <i>JMB 6/21/06</i>
------------	-------------------------------

PEDESTRIAN ACTIVITIES DISTRICT (P.A.D.)

Action: Approved Approved w/Conditions Denied

Signature: _____ Date: _____

Permit Taken By: gad	Date Applied For: 04/26/2006	Zoning Approval	
-------------------------	---------------------------------	------------------------	--

<p>1. This permit application does not preclude the Applicant(s) from meeting applicable State and Federal Rules.</p> <p>2. Building permits do not include plumbing, septic or electrical work.</p> <p>3. Building permits are void if work is not started within six (6) months of the date of issuance. False information may invalidate a building permit and stop all work..</p>	<p>Special Zone or Reviews</p> <p><input type="checkbox"/> Shoreland</p> <p><input type="checkbox"/> Wetland</p> <p><input type="checkbox"/> Flood Zone</p> <p><input type="checkbox"/> Subdivision</p> <p><input type="checkbox"/> Site Plan</p> <p>Maj <input type="checkbox"/> Minor <input type="checkbox"/> MM <input type="checkbox"/></p> <p>Date: <i>8/5/06</i></p>	<p>Zoning Appeal</p> <p><input type="checkbox"/> Variance</p> <p><input type="checkbox"/> Miscellaneous</p> <p><input type="checkbox"/> Conditional Use</p> <p><input type="checkbox"/> Interpretation</p> <p><input type="checkbox"/> Approved</p> <p><input type="checkbox"/> Denied</p> <p>Date: _____</p>	<p>Historic Preservation</p> <p><input checked="" type="checkbox"/> Not in District or Landmark</p> <p><input type="checkbox"/> Does Not Require Review</p> <p><input type="checkbox"/> Requires Review</p> <p><input type="checkbox"/> Approved</p> <p><input type="checkbox"/> Approved w/Conditions</p> <p><input type="checkbox"/> Denied</p> <p>Date: <i>9</i></p>
---	---	---	---

CERTIFICATION

I hereby certify that I am the owner of record of the named property, or that the proposed work is authorized by the owner of record and that I have been authorized by the owner to make this application as his authorized agent and I agree to conform to all applicable laws of this jurisdiction. In addition, if a permit for work described in the application is issued, I certify that the code official's authorized representative shall have the authority to enter all areas covered by such permit at any reasonable hour to enforce the provision of the code(s) applicable to such permit.

SIGNATURE OF APPLICANT _____ ADDRESS _____ DATE _____ PHONE _____

RESPONSIBLE PERSON IN CHARGE OF WORK, TITLE _____ DATE _____ PHONE _____

6/15/06 Pre Demo Insp on site. Verified
measurements are as on the Plot Plan.

6/21/06 John Kiley called to verify distance of left
front corner of shed to right rear corner of house 35'
OK to Demo JMB

City of Portland, Maine - Building or Use Permit

389 Congress Street, 04101 Tel: (207) 874-8703, Fax: (207) 874-8716

Permit No: 06-0573	Date Applied For: 04/19/2006	CBU: 085 G005001
-----------------------	---------------------------------	---------------------

Location of Construction: 14 Spruce Ave, PI	Owner Name: Carlisle Justine C	Owner Address: 30 Adelbert St	Phone: () 767-8183
Business Name:	Contractor Name: John Kiely	Contractor Address: 591 Island Ave Peaks Island	Phone: (207) 766-2026
Lessee/Buyer's Name	Phone:	Permit Type: Demolitions	

Proposed Use: Single Family	Proposed Project Description: Demolition of storage shed and sleeping quarters.(out bldg is NOT a separate dwelling unit on the property)
--------------------------------	--

Dept: Zoning	Status: Approved with Conditions	Reviewer: Marge Schmuckal	Approval Date: 06/05/2006
Note: 5/11/06 no plot plan with permit - called J. Kiely ,left 2 messages - in M's hold 6/5/06 - see permit #06-0624 for the rebuilding of this structure			Ok to Issue: <input checked="" type="checkbox"/>
<p>1) Your present structure is legally nonconforming as to setbacks. If you are to demolish this structure on your own volition, you will only have one (1) year to replace it in the same footprint (no expansions), with the same height, and same use. Any changes to any of the above shall require that this structure meet the current zoning standards. The one (1) year starts at the time of removal. It shall be the owner's responsibility to contact the Code Enforcement Officer and notify them of that specific date.</p> <p>2) BEFORE demolition, It is the responsibility of the owner to call the Code Enforcement Officer to inspect and locate the structure on the ground.</p>			
Dept: Building	Status: Pending	Reviewer: Jeanine Bourke	Approval Date: 06/21/2006
Note:			Ok to Issue: <input checked="" type="checkbox"/>
1) Permit approved based on the plans submitted and reviewed w/owner/contractor, with additional information as agreed on and as noted on plans.			

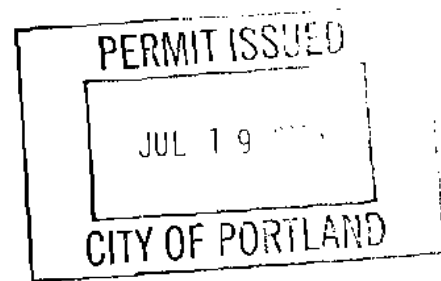

All Purpose Building Permit Application for Demolition of A Structure

If you or the property owner owes real estate or personal property taxes or user charges on any property within the City, payment arrangements must be made before permits of any kind are accepted.

Location/Address of Construction: <u>14 Spruce Ave., Peaks Island, ME</u>		
Total Square Footage of Proposed Structure	Square Footage of Lot <u>1007 sq/Ft</u>	
Tax Assessor's Chart, Block & Lot Chart# Block# Lot# <u>085 6-6005 001</u>	Owner: <u>Justine C. Carlisle</u>	Telephone: <u>767-8183</u>
Lessee/Buyer's Name (If Applicable) <u>N/A</u>	Applicant name, address & telephone: <u>Peter Carlisle</u> <u>30 Adelbert St, So Po</u> <u>207-767-8183 04106</u>	Cost Of Work: <u>\$3,000.00</u> Fee: <u>\$48.00</u>
Current use: <u>Storage</u> <u>Single Family</u>		
If the location is currently vacant, what was prior use: _____		
Approximately how long has it been vacant: _____		
Project description: <u>Demo storage shed only, (will rebuild)</u>		
DEMOLITION CALL LIST MUST BE SUBMITTED WITH THIS APPLICATION		
Contractor's name, address & telephone: <u>John Kiely 591 Island Ave. Peaks Island</u> <u>Maine 04108</u> <u>207-766-2026</u>		
Whom should we contact when the permit is ready: <u>Peter Carlisle</u>		
Mailing address: <u>30 Adelbert St. South Portland, Maine 04106</u>		
Phone: <u>767-8183</u>		

IF THE REQUIRED INFORMATION IS NOT INCLUDED IN THE SUBMISSIONS THE PERMIT WILL BE AUTOMATICALLY DENIED AT THE DISCRETION OF THE BUILDING/PLANNING DEPARTMENT, WE MAY REQUIRE ADDITIONAL INFORMATION IN ORDER TO APPROVE THIS PERMIT.

I hereby certify that I am the Owner of record of the named property, or that the owner of record authorizes the proposed work and that I have been authorized by the owner to make this application as his/her authorized agent. I agree to conform to all applicable laws of this jurisdiction. In addition, if a permit for work described in this application is issued, I certify that the Code Official's authorized representative shall have the authority to enter all areas covered by this permit at any reasonable hour to enforce the provisions of the codes applicable to this permit.

Signature of applicant: 	Date: <u>4/17/06</u>
--	----------------------

This is not a permit, you may not commence ANY work until the permit is issued. This is for residential demolition. Commercial demolition will require other types of permitting along with this permit. please inquire with support staff.

DEPT. OF BUILDING INSPECTION
CITY OF PORTLAND, ME
APR 19 2006
RECEIVED

City of Portland Inspection Services Division Demolition Call List and Requirements

Site Address: 14 Spruce Ave Parks Island Owner: Justine Carlisle

Structure Type: Coolest Cottage Contractor: John Kiely

service drop?
line already?
meter?
→ 2006-1-26

<u>UTILITY APPROVALS</u>	<u>NUMBER</u>	<u>CONTACT NAME/DATE CONTACTED</u>
Central Maine Power	1-800-750-4000	# Provided
Verizon	1-800-941-9900 203-293-1265	Tim Layton / April 19th, 2006
Northern Utilities	797-8002 ext 6241	Mark Allen / April 19, 2006
Portland Water District	761-8310 ext 3073	Gordon / April 19, 2006
Time Warner Cable Co.	253-2222 2262	Deb Paieiment - construction manager / April 19, 2006
Dig Safe ***	1-888-344-7233	Suse / April 17, 2006
*** (After Call, There is a wait of 72 Business Hours before digging can begin)		
		Do see # 2006-160-1451

made to
permanently
Friday April 21st

<u>CITY APPROVALS</u>	<u>NUMBER</u>	<u>CONTACT NAME/DATE CONTACTED</u>
DPW/ Traffic Division	874-8891 ^{Ann Hickey}	(L. Cote) Lucy Cote / April 19th, 2006 ✓
DPW/ Forestry Division	874-8389 ^{not in service}	(J. Tarling)
DPW/ Sealed Drain Permit	874-8822	(C. Merritt) Carol Merritt / April 19th, 2006
Building Inspections (Insp. Req'd.)	874-8703	
Historic Preservation	874-8726 ^{734-8023 - Scott Hansen}	Scott Hansen / April 19th, 2006
Fire Dispatcher	874-8576 ⁸⁰⁹⁶	Ben Diez / April 19th, 2006
DEP - Environmental (Augusta)	287-2651	Sandy Moody / April 19th, 2006

Be in application
when a permit
has been issued

U.S. EPA Region I - No Phone call required. Just mail copy of State notification to:

Demo / Reno Clerk
US EPA Region I (SEA)
JFK Federal Building
Boston, MA 02203

ADDITIONAL REQUIREMENTS:

- 1) Written Notice to Adjoining Owners: Only when written notice has been given by the Applicant to the owners of adjoining lots will a demolition permit be issued. Provide a list of those notified and a copy of the notification sent with your completed application.
- 2) A Photo of the Structure(s) to be demolished must be submitted with your application.
- 3) Certification From an Asbestos Abatement Company that the building is asbestos-free may be required as per state law notification form attached.

I have contacted all of the necessary companies / departments as indicated above and attached all required documentation.

Signed: _____ Date: _____



STATE OF MAINE
DEPARTMENT OF ENVIRONMENTAL PROTECTION

ANGUS S. KING, JR.
GOVERNOR

MARTHA KIRKPATRICK
COMMISSIONER

Demolitions and Asbestos

To: Code Enforcement Officers and Municipal Officials
From: Ed Antz, Asbestos/Lead Hazard Prevention Program
Subject: Asbestos Issues During Building Demolitions
Date: September 2000

1) Overview

In Maine, building demolitions happen on a regular basis. Many of the demolitions occur in older buildings that are likely to contain some asbestos products, particularly in or on heating (HVAC), wall, floor, and ceiling systems. These demolition projects may be happening without the proper protection of employees, the general public, and the environment. It is important to remember that state and federal laws require that owners have buildings inspected and have any asbestos products properly removed prior to demolition. The Maine DEP is forwarding this information to municipal officials in an effort to increase awareness of and compliance with applicable rules, resulting in less asbestos exposure to the general public, demolition site personnel, and the environment.

2) What Can Municipalities Do To Help?

Municipalities can greatly assist the people of Maine and the Department by joining with the DEP and the US EPA to ensure that asbestos is properly managed during demolitions. *Specifically, municipalities can hand out appropriate information, issue demolition permits only to persons who can demonstrate that they will properly handle the asbestos, and mail or fax the building demolition (BDF) report form to the Department.* The following check-off list can be used:

- A) Provided "Asbestos Fact Sheet" to Applicant
- B) Had applicant fill out "Building Demolition Form" (BDF)
- C) Did not issue Demolition Permit to Applicant not answering "Yes" to three questions on BDF Form (OPTIONAL BUT SUGGESTED)
- D) Municipality faxed (or mailed) BDF Form to DEP at 287-7826.

3) What Are The Rules?

Simply stated, state and federal asbestos rules and regulations require that buildings be inspected for asbestos products and have them removed prior to demolition. The inspection and removal operations must be performed by DEP-licensed companies under regulated and controlled conditions.

4) Using The Building Demolition Report Form

The purpose of this form is to ensure that an applicant has the correct information to properly remove asbestos from a building prior to demolition. The form asks three questions and records some basic information that the DEP may need during follow-up inquiries. The Form has two parts which need to be filled out by the applicant. The first section on the Form, Pre-Demolition Building Inspection and

AUGUSTA
11 STATE HOUSE STATION
AUGUSTA, MAINE 04333-0017
(207) 287-7688
RAY BLDG., HOSPITAL ST.

BANGOR
106 HOGAN ROAD
BANGOR, MAINE 04401
(207) 941-4970 FAX: (207) 941-4584

PORTLAND
312 CANCO ROAD
PORTLAND, MAINE 04103
(207) 822-6300 FAX: (207) 822-6300

PRESQUE ISLE
1235 CENTRAL DRIVE, SKYWAY
PRESQUE ISLE, MAINE 04769-2000
(207) 764-0477 FAX: (207) 764-1500



Maine Department of Environmental Protection

Demolition Fact Sheet

Contact: phone (207)-287-2651

This Fact Sheet provides a brief overview of the regulatory requirements pertaining to asbestos demolition activities in Maine. This document addresses the basic requirements. Should you require detailed information or have a specific question, please call (207) 287-2651.

What is Asbestos?

Asbestos is naturally occurring mineral, very strong and heat resistant, which has been made into nearly three thousand products. It is found on heating and domestic water systems (pipes, boilers, gaskets, tanks, elbows and tees), spray-on insulation (fireproofing and acoustical purposes), flooring components (vinyl tiles and linoleum) and drop-in ceiling systems (ceiling tiles). Asbestos-containing materials (ACM) are also found in building materials, such as siding (shingles or sheets) and roofing, used on the outside of buildings.

When do Maine's Asbestos Regulations apply?

Any (single) demolition activity that involves the removal of ACM in quantities greater than 3 square or 3 linear feet is subject to the requirements of 38 M.R.S.A. Title 38 Sections 1271 to 1284 (Maine statute) and Chapter 425, Asbestos Management Regulations (DEP regulation). Demolition means the tearing down or intentional burning of a building or part of a building. This includes any institutional, commercial, public, industrial or residential building. **Be advised that Maine and federal regulations require that all ACM be removed from a building (or affected portions thereof) before it is completely or partially torn down.**

What are Maine's requirements?

Maine regulations require that notification of the demolition activity be sent to the Department 10 days prior to the activity; that companies performing the removal be licensed with the Department; that individuals working for the licensed companies be certified with the Department; that the work be performed under controlled conditions (specific work practices consisting of reduced pressure enclosures and wet methods) by properly protected employees; and that inspection, project design and clearance standards (air testing) be met. Finally Maine regulations require that asbestos be properly stored in fiber-tight containers, be transported by DEP-permitted vehicles, and be disposed in a landfill licensed to accept the type of waste generated (friable or non-friable).

What are the Federal Asbestos requirements?

The federal government under the National Emissions Standards for Hazardous Air Pollutants (NESHAPs) also regulates asbestos demolitions. Specifically, the NESHAPs requires that facilities be inspected thoroughly for asbestos products, that the owner/operator notify the federal government 10 days prior to the project, and that friable asbestos (any loose, crumbly material) be removed prior to demolition. The federal government and the Department have worked out an agreement that allows notification to the Department to constitute notification to the federal government as well. All demolitions, asbestos-containing or not, must be reported, excluding residential units (<5).

Simply, What Can I Do To Be In Compliance?

As soon as possible before demolition, building owners need to hire an asbestos consultant or asbestos contractor (with consulting experience) to inspect and make recommendations about demolition options. An up to date list of asbestos companies is available from the Department as is technical assistance following inspection.



**Maine Department of Environmental Protection
Lead & Asbestos Hazard Prevention Program**
17 State House Station, Augusta, Me 04333-0017
Tel: (207) 287-2651 Fax: (207) 287-7826



Building Demolition Notification Form (BDNF)

Important Notice: Maine law requires the filing of this Building Demolition Notification Form prior to demolition of any building except a single-family home

1) Building owners are required to provide this notification of the demolition of a building to the DEP at least 5 working days prior to the demolition. This notification is not required before the demolition of a single-family residence or related structure (e.g., garage, shed, barn). It is also not required if previous notification of the demolition has been provided to the DEP as part of an asbestos abatement project notification. *Demolition* means the tearing down or intentional burning of a building or part of a building.

2) Prior to demolition, building owners must determine if there is any asbestos-containing material(s) (ACM) in the building. An "asbestos inspection" by a DEP-licensed Asbestos Consultant is required for all buildings except single-family homes and residential buildings with 2-4 units built after 1980. In lieu of an asbestos inspection, pre-1981 residential buildings with 2-4 units can be surveyed to identify possible ACM by someone knowledgeable about ACM, such as a code enforcement officer or building inspector. If materials that may contain asbestos are found, then you can either assume they are ACM or hire a DEP-licensed Asbestos Consultant to test the materials.

3) Whenever more than 3 square feet or 3 linear feet of ACM is identified, the ACM must be abated in accordance with the Maine Asbestos Management Regulations by a DEP-licensed Asbestos Abatement Contractor. This includes materials presumed to be ACM. Check www.state.me.us/dep/rwm/asbestos/index.htm for a listing of asbestos contractors.

Prior to issuing a local demolition permit, the DEP requests that municipalities have applicants for municipal demolition permits complete this form and fax it to the DEP at 207-287-7826. Municipalities should not issue local demolition permits if the required asbestos inspection or survey has not been performed and identified ACM removed.

Were asbestos-containing materials found? yes no no inspection or survey required (post-1980 2-4 unit)

property address: 14 Spruce Ave Peaks Island, Maine	building description: <input checked="" type="checkbox"/> pre-1981 residential with 2-4 units <input type="checkbox"/> post-1980 residential with 2-4 units <input type="checkbox"/> other:
asbestos survey performed by: (name & address) telephone:	asbestos inspection performed by: (name of licensed Asbestos Consultant) telephone:
property owner: (name & address) Justine Carlisle 30 Adelbert St. South Portland 04106 telephone: 767-8183	demolition contractor: (name & address) John Kieley 591 Island Ave Peaks Island, ME 04108 telephone:
demolition start date:	demolition end date:

Notification Submitted by: (please print)

Date Submitted

Help save Maine fisheries – Remove and recycle mercury thermostats and fluorescent lamps from your building prior to demolition!

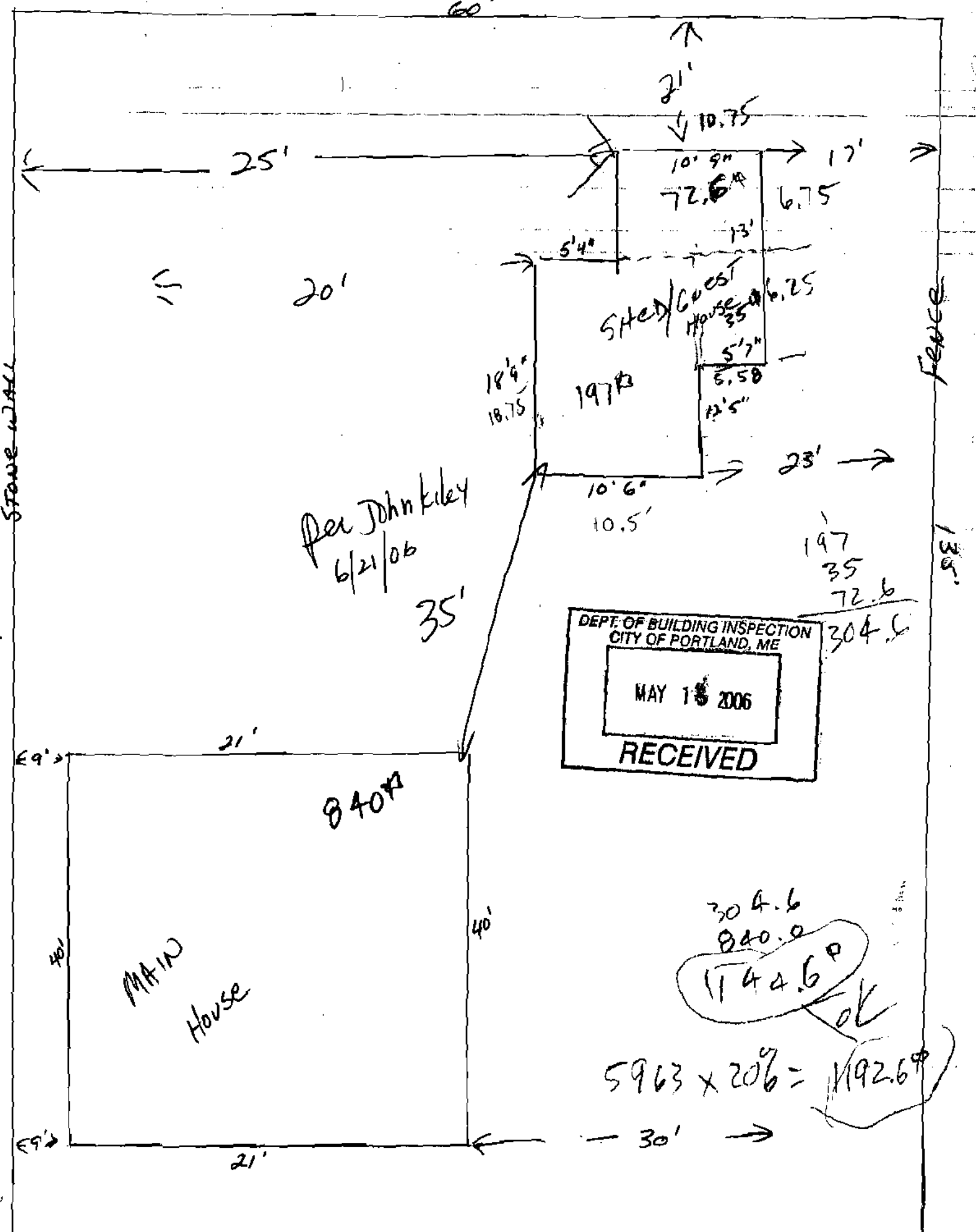

Per John Kiley
6/21/06

DEPT. OF BUILDING INSPECTION
CITY OF PORTLAND, ME
MAY 15 2006
RECEIVED

304.6
840.0
1144.6

5963 x 20% = 1192.6

OK

PLUMBING

Town or Plantation: Peaks Island

Street Subdivision Lot #: 14 Spruce Ave

Last: Carlisle First: Jurine

Applicant Name: Craig Hansen

Mailing Address of Owner/Applicant (if different): 279 Narragansett St. Gorham, ME 04038

Caution: Permit Required

PORTLAND PERMIT # 10059 TOWN COPY

Date: 10/23/06 FEE: 110.30

L.P.I. # 0744

Local Plumbing Inspector Signature

Owner/Applicant Statement

I certify that the information submitted is correct to the best of my knowledge and understand that any falsification is reason for the Local Plumbing Inspectors to deny a Permit.

Craig A. Hansen 10/23/06
Signature of Owner/Applicant Date

Caution: Inspection Required

I have inspected the installation authorized above and found it to be in compliance with the Maine Plumbing Rules.

Local Plumbing Inspector Signature Date Approved

<p>This Application is for</p> <p>1. <input checked="" type="checkbox"/> NEW PLUMBING</p> <p>2. <input type="checkbox"/> RELOCATED PLUMBING</p>	<p>Type of Structure To Be Served:</p> <p>1. <input checked="" type="checkbox"/> SINGLE FAMILY DWELLING</p> <p>2. <input type="checkbox"/> MODULAR OR MOBILE HOME</p> <p>3. <input type="checkbox"/> MULTIPLE FAMILY DWELLING</p> <p>4. <input type="checkbox"/> OTHER - SPECIFY _____</p>	<p>Plumbing To Be Installed By:</p> <p>1. <input checked="" type="checkbox"/> MASTER PLUMBER</p> <p>2. <input type="checkbox"/> OIL BURNERMAN</p> <p>3. <input type="checkbox"/> MFG'D. HOUSING DEALER/MECHANIC</p> <p>4. <input type="checkbox"/> PUBLIC UTILITY EMPLOYEE</p> <p>5. <input type="checkbox"/> PROPERTY OWNER</p> <p>LICENSE # <u>115,9,ad 10738</u></p>
--	---	--

Hook-Up & Piping Relocation Maximum of 1 Hook-Up	Column 2 Type of Fixture		Column 1 Type of Fixture	
	Number	Type of Fixture	Number	Type of Fixture
<p>HOOK-UP: to public sewer in those cases where the connection is not regulated and inspected by the local Sanitary District.</p> <p>OR</p> <p>HOOK-UP: to an existing subsurface wastewater disposal system.</p>		Hosebibb / Silcock		Bathtub (and Shower)
		Floor Drain	0, 1	Shower (Separate)
<p>PIPING RELOCATION: of sanitary lines, drains, and piping without new fixtures.</p> <p>OR</p> <p>TRANSFER FEE (\$8.00)</p>		Urinal	0, 0	Sink
		Drinking Fountain	0, 1	Wash Basin
		Indirect Waste	0, 1	Water Closet (Toilet)
		Water Treatment Softener, Filter, etc.		Clothes Washer
		Grease / Oil Separator		Dish Washer
		Roof Drain		Garbage Disposal
		Other	0, 1	Laundry Tub
		Subtotal Column 2	0, 4	Water Heater
			0, 0	
<p>SEE PERMIT FEE SCHEDULE FOR CALCULATING FEE</p> <p>825 30 40</p>				

RECEIVED

OCT 23 2006

DEPT. OF BUILDING INSPECTION
CITY OF PORTLAND, ME

30

BUILDING PERMIT INSPECTION PROCEDURES

Please call 874-8703 or 874-8693 to schedule your inspections as agreed upon

Permits expire in 6 months, if the project is not started or ceases for 6 months.

The Owner or their designee is required to notify the inspections office for the following inspections and provide adequate notice. Notice must be called in 48-72 hours in advance in order to schedule an inspection:

By initializing at each inspection time, you are agreeing that you understand the inspection procedure and additional fees from a "Stop Work Order" and "Stop Work Order Release" will be incurred if the procedure is not followed as stated below.

A Pre-construction Meeting will take place upon receipt of your building permit.

- Footing/Building Location Inspection: Prior to pouring concrete
- Re-Bar Schedule Inspection: Prior to pouring concrete
- Foundation Inspection: Prior to placing ANY backfill
- Framing/Rough Plumbing/Electrical: Prior to any insulating or drywalling
- Final/Certificate of Occupancy: Prior to any occupancy of the structure or use. NOTE: There is a \$75.00 fee per inspection at this point.

Certificate of Occupancy is not required for certain projects. Your inspector can advise you if your project requires a Certificate of Occupancy. All projects DO require a final inspection

If any of the inspections do not occur, the project cannot go on to the next phase, REGARDLESS OF THE NOTICE OR CIRCUMSTANCES.

~~CERTIFICATE OF OCCUPANCIES MUST BE ISSUED AND PAID FOR, BEFORE THE SPACE MAY BE OCCUPIED~~

[Signature]
Signature of Applicant/Designee

7/31/06
Date

[Signature]
Signature of Inspections Official

7.31.06
Date

CBL: 85-G-5 Building Permit #: 06573



Demo
Squad



CITY OF PORTLAND, MAINE
Department of Building Inspections

April 19 2006

Received from Peter Carls

Location of Work 14 Spruce St

Cost of Construction \$ _____ Demo

Permit Fee \$ _____

Building (I1) Plumbing (I5) Electrical (I2) Site Plan (U2)

Other _____

CBL: 085-6005

Check #: 2392 Total Collected \$ 48.00

THIS IS NOT A PERMIT

No work is to be started until PERMIT CARD is actually posted upon the premises. Acceptance of fee is no guarantee that permit will be granted. PRESERVE THIS RECEIPT. In case permit cannot be granted the amount of the fee will be refunded upon return of the receipt less \$10.00 or 10% whichever is greater.

WHITE - Applicant's Copy
YELLOW - Office Copy
PINK - Permit Copy

Handwritten signature

City of Portland, Maine - Building or Use Permit

389 Congress Street, 04101 Tel: (207) 874-8703, Fax: (207) 874-8716

Permit No: 06-0573	Date Applied For: 04/19/2006	CBL: 085 G005001
-----------------------	---------------------------------	---------------------

Location of Construction: 14 Spruce Ave, PI	Owner Name: Carlisle Justine C	Owner Address: 30 Adelbert St	Phone: () 767-8183
Business Name:	Contractor Name: John Kiely	Contractor Address: 591 Island Ave Peaks Island	Phone: (207) 766-2026
Lessee/Buyer's Name	Phone:	Permit Type: Demolitions	

Proposed Use:

Single Family

Proposed Project Description:

Demolition of storage shed.

Dept: Zoning**Status:** Pending**Reviewer:** Marge Schmuckal**Approval Date:****Note:** 5/11/06 no plot plan with permit - called J. Kiely ,left 2 messages - in M's hold**Ok to Issue:** **Dept:** Building**Status:** Pending**Reviewer:****Approval Date:****Note:****Ok to Issue:**

City of Portland, Maine - Building or Use Permit Application
 389 Congress Street, 04101 Tel: (207) 874-8703, Fax: (207) 874-8716

Permit No: 06-0573	Issue Date:	CBL: 085 G005001
-----------------------	-------------	---------------------

Location of Construction: 14 Spruce Ave, PI	Owner Name: Carlisle Justine C	Owner Address: 30 Adelbert St	Phone: 767-8183
Business Name:	Contractor Name: John Kiely	Contractor Address: 591 Island Ave Peaks Island	Phone: 2077662026
Lessee/Buyer's Name	Phone:	Permit Type: Demolitions	Zone:

Past Use: Single Family	Proposed Use: Single Family	Permit Fee: \$48.00	Cost of Work: \$3,000.00	CEO District: 2
Proposed Project Description: Demolition of storage shed.		FIRE DEPT: <input type="checkbox"/> Approved <input type="checkbox"/> Denied	INSPECTION: Use Group: Type:	
		Signature:	Signature:	
PEDESTRIAN ACTIVITIES DISTRICT (P.A.D.)				
Action: <input type="checkbox"/> Approved <input type="checkbox"/> Approved w/Conditions <input type="checkbox"/> Denied				
Signature: Date:				

Permit Taken By: gad	Date Applied For: 04/19/2006	Zoning Approval		
-------------------------	---------------------------------	------------------------	--	--

1. This permit application does not preclude the Applicant(s) from meeting applicable State and Federal Rules. 2. Building permits do not include plumbing, septic or electrical work. 3. Building permits are void if work is not started within six (6) months of the date of issuance. False information may invalidate a building permit and stop all work..	Special Zone or Reviews <input type="checkbox"/> Shoreland <input type="checkbox"/> Wetland <input type="checkbox"/> Flood Zone <input type="checkbox"/> Subdivision <input type="checkbox"/> Site Plan Maj <input type="checkbox"/> Minor <input type="checkbox"/> MM <input type="checkbox"/> Date:	Zoning Appeal <input type="checkbox"/> Variance <input type="checkbox"/> Miscellaneous <input type="checkbox"/> Conditional Use <input type="checkbox"/> Interpretation <input type="checkbox"/> Approved <input type="checkbox"/> Denied Date:	Historic Preservation <input type="checkbox"/> Not in District or Landmark <input type="checkbox"/> Does Not Require Review <input type="checkbox"/> Requires Review <input type="checkbox"/> Approved <input type="checkbox"/> Approved w/Conditions <input type="checkbox"/> Denied Date:
--	--	--	--

CERTIFICATION

I hereby certify that I am the owner of record of the named property, or that the proposed work is authorized by the owner of record and that I have been authorized by the owner to make this application as his authorized agent and I agree to conform to all applicable laws of this jurisdiction. In addition, if a permit for work described in the application is issued, I certify that the code official's authorized representative shall have the authority to enter all areas covered by such permit at any reasonable hour to enforce the provision of the code(s) applicable to such permit.

SIGNATURE OF APPLICANT	ADDRESS	DATE	PHONE
RESPONSIBLE PERSON IN CHARGE OF WORK, TITLE		DATE	PHONE