

DISPLAY THIS CARD ON PRINCIPAL FRONTAGE OF WORK  
**CITY OF PORTLAND**

Please Read  
Application And  
Notes, if Any,  
Attached

BUILDING PERMIT

Permit Number: 100659  
**PERMIT ISSUED**

This is to certify that BARBARO HENRY L & MARIONNE E. BARBARO, ITS/Mace  
has permission to replace existing porch, add supports within existing meters  
AT 114 NEW ISLAND AVE PEAKS ISLAND CE 085 D008001 JUN 24 2010

provided that the person or persons, firm or corporation accepting this permit shall comply with all of the provisions of the Statutes of Maine and of the Ordinances of the City of Portland regulating the construction, maintenance and use of buildings and structures, and of the application on file in this department.

Apply to Public Works for street line and grade if nature of work requires such information.

Notification of inspection must be given and written permission procured before this building or part thereof is lathed or otherwise finished-in. 24 HOURS NOTICE IS REQUIRED.

A certificate of occupancy must be procured by owner before this building or part thereof is occupied.

**OTHER REQUIRED APPROVALS**

Fire Dept. \_\_\_\_\_  
Health Dept. \_\_\_\_\_  
Appeal Board \_\_\_\_\_  
Other \_\_\_\_\_  
Department Name

*[Handwritten Signature]*  
Director, Building & Inspection Services

**PENALTY FOR REMOVING THIS CARD**

**City of Portland, Maine - Building or Use Permit Application**

389 Congress Street, 04101 Tel: (207) 874-8703, Fax: (207) 874-8716

Permit No: 10-0652	Issue Date:	CBL: 085 D008001
-----------------------	-------------	---------------------

Location of Construction: 114 NEW ISLAND AVE PEAKS IS	Owner Name: BARBARO HENRY L & MARIAN	Owner Address: 23 WOODMAN ST # 2	Phone:
Business Name:	Contractor Name: Macey Orme	Contractor Address: P O Box 143 Peaks Island	Phone: 2074087100
Lessee/Buyer's Name	Phone:	Permit Type: Alterations - Dwellings	Zone: IR-2

Past Use: Single Family Home	Proposed Use: Single Family Home - replace existing porch, add supports within existing perimeters	Permit Fee: \$170.00	Cost of Work: \$5,000.00	CEO District: 1
Proposed Project Description: replace existing porch, add supports within existing perimeters		FIRE DEPT: <input type="checkbox"/> Approved <input checked="" type="checkbox"/> Denied <i>N/A</i>	INSPECTION: Use Group: <i>R.3</i> Type: <i>SB</i> <i>IRG 2003</i>	
		Signature:	Signature:	

Proposed Project Description: replace existing porch, add supports within existing perimeters		PEDESTRIAN ACTIVITIES DISTRICT (P.A.D.)	
		Action: <input type="checkbox"/> Approved <input type="checkbox"/> Approved w/Conditions <input checked="" type="checkbox"/> Denied	
		Signature:	Date:

Permit Taken By: ldobson	Date Applied For: 06/08/2010	<b>Zoning Approval</b>	
-----------------------------	---------------------------------	------------------------	--

<ol style="list-style-type: none"> <li>This permit application does not preclude the Applicant(s) from meeting applicable State and Federal Rules.</li> <li>Building permits do not include plumbing, septic or electrical work.</li> <li>Building permits are void if work is not started within six (6) months of the date of issuance. False information may invalidate a building permit and stop all work..</li> </ol>	<b>Special Zone or Reviews</b> <input type="checkbox"/> Shoreland <i>N/A</i> <input type="checkbox"/> Wetland <input type="checkbox"/> Flood Zone <input type="checkbox"/> Subdivision <input type="checkbox"/> Site Plan Maj <input type="checkbox"/> Minor <input type="checkbox"/> MM <input type="checkbox"/> <i>Orw/land. hars</i> Date: <i>6/9/10</i> <i>JEM</i>	<b>Zoning Appeal</b> <input type="checkbox"/> Variance <input type="checkbox"/> Miscellaneous <input type="checkbox"/> Conditional Use <input type="checkbox"/> Interpretation <input type="checkbox"/> Approved <input type="checkbox"/> Denied Date:	<b>Historic Preservation</b> <input checked="" type="checkbox"/> Not in District or Landmark <input type="checkbox"/> Does Not Require Review <input type="checkbox"/> Requires Review <input type="checkbox"/> Approved <input type="checkbox"/> Approved w/Conditions <input type="checkbox"/> Denied Date: <i>JEM</i>
	<p><b>PERMIT ISSUED</b></p> <p>JUN 24 2010</p> <p>City of Portland</p>		

**CERTIFICATION**

I hereby certify that I am the owner of record of the named property, or that the proposed work is authorized by the owner of record and that I have been authorized by the owner to make this application as his authorized agent and I agree to conform to all applicable laws of this jurisdiction. In addition, if a permit for work described in the application is issued, I certify that the code official's authorized representative shall have the authority to enter all areas covered by such permit at any reasonable hour to enforce the provision of the code(s) applicable to such permit.

SIGNATURE OF APPLICANT	ADDRESS	DATE	PHONE
RESPONSIBLE PERSON IN CHARGE OF WORK, TITLE		DATE	PHONE



# CITY OF PORTLAND, MAINE

Department of Building Inspections

## Original Receipt

6-8 2010

Received from Henry Barbosa

Location of Work (100) 114 New Island

Cost of Construction \$ \_\_\_\_\_ Building Fee: 70

Permit Fee \$ \_\_\_\_\_ After fact  
Site Fee: 100

Certificate of Occupancy Fee: \_\_\_\_\_

Total: 170

Building (12) \_\_\_\_\_ Plumbing (15) \_\_\_\_\_ Electrical (12) \_\_\_\_\_ Site Plan (U2) \_\_\_\_\_

Other \_\_\_\_\_

CBL: 85-D-8

Check #: 1239 Total Collected \$ 170

**No work is to be started until permit issued.  
Please keep original receipt for your records.**

Taken by: [Signature]

WHITE - Applicant's Copy  
YELLOW - Office Copy  
PINK - Permit Copy

**City of Portland, Maine - Building or Use Permit**

389 Congress Street, 04101 Tel: (207) 874-8703, Fax: (207) 874-8716

<b>Permit No:</b> 10-0652	<b>Date Applied For:</b> 06/08/2010	<b>CBL:</b> 085 D008001
------------------------------	--	----------------------------

<b>Location of Construction:</b> 114 NEW ISLAND AVE PEAKS I	<b>Owner Name:</b> BARBARO HENRY L & MARIAN	<b>Owner Address:</b> 23 WOODMAN ST # 2	<b>Phone:</b>
<b>Business Name:</b>	<b>Contractor Name:</b> Macey Orme	<b>Contractor Address:</b> P O Box 143 Peaks Island	<b>Phone</b> (207) 408-7100
<b>Lessee/Buyer's Name</b>	<b>Phone:</b>	<b>Permit Type:</b> Alterations - Dwellings	

<b>Proposed Use:</b> Single Family Home - replace existing porch, add supports within existing perimeters	<b>Proposed Project Description:</b> replace existing porch, add supports within existing perimeters
--	---

<b>Dept:</b> Zoning	<b>Status:</b> Approved with Conditions	<b>Reviewer:</b> Ann Machado	<b>Approval Date:</b> 06/09/2010
<b>Note:</b>	<b>Ok to Issue:</b> ✓		
<ol style="list-style-type: none"> <li>1) This permit is being issued with the condition that the work will take place within the existing footprint.</li> <li>2) This property shall remain a single family dwelling. Any change of use shall require a separate permit application for review and approval.</li> <li>3) This permit is being approved on the basis of plans submitted. Any deviations shall require a separate approval before starting that work.</li> </ol>			
<b>Dept:</b> Building	<b>Status:</b> Approved with Conditions	<b>Reviewer:</b> Tammy Munson	<b>Approval Date:</b> 06/24/2010
<b>Note:</b>	<b>Ok to Issue:</b> ✓		
<ol style="list-style-type: none"> <li>1) Application approval based upon information provided by applicant. Any deviation from approved plans requires separate review and approval prior to work.</li> <li>2) The minimum stair tread is 10" measured nosing to nosing. The maximum riser height is 7-3/4".</li> <li>3) The carying girders must be 2 - 2" x 10"-s not 2 - 2" x 6"-s.</li> </ol>			

**PERMIT ISSUED**

JUN 24 2010

City of Portland

## **BUILDING PERMIT INSPECTION PROCEDURES**

**Please call 874-8703 or 874-8693 (ONLY )**

**or email: [buildinginspections@portlandmaine.gov](mailto:buildinginspections@portlandmaine.gov)**

With the issuance of this permit, the owner, builder or their designee is required to provide adequate notice to the City of Portland Inspection Services for the following inspections. Appointments must be requested 48 to 72 hours in advance of the required inspection. The inspection date will need to be confirmed by this office.

- **Please read the conditions of approval that is attached to this permit!! Contact this office if you have any questions.**
- **Permits expire in 6 months, if the project is not started or ceases for 6 months.**
- **If the inspection requirements are not followed as stated below additional fees may be incurred due to the issuance of a "Stop Work Order" and subsequent release to continue with construction.**

  X   **Footing/Building Location Inspection: Prior to pouring concrete or setting precast piers**

  X   **Framing inspection required. This can be done at the final inspection if the framing is left visible.**

  X   **Final inspection required at completion of work.**

**The project cannot move to the next phase prior to the required inspection and approval to continue, REGARDLESS OF THE NOTICE OR CIRCUMSTANCES.**

**IF THE PERMIT REQUIRES A CERTIFICATE OF OCCUPANCY, IT MUST BE PAID FOR AND ISSUED TO THE OWNER OR DESIGNEE BEFORE THE SPACE MAY BE OCCUPIED.**

**PERMIT ISSUED**

JUN 24 2010

City of Portland

City



# General Building Permit Application

If you or the property owner owes real estate or personal property taxes or user charges on any property within the City, payment arrangements must be made before permits of any kind are accepted.

Location/Address of Construction: <u>114 New Island Ave., Peaks Island, ME 04108</u>		
Total Square Footage of Proposed Structure/Area <u>249 s.f.</u>		Square Footage of Lot <u>5,000 s.f.</u>
Tax Assessor's Chart, Block & Lot Chart#      Block#      Lot# <u>85            D            8</u> Map	Applicant * <b>must be owner, Lessee or Buyer</b> * Name <u>Henry L. Barbaro</u> Address <u>23 Woodman St., #2</u> City, State & Zip <u>Boston, MA 02130</u>	Telephone: <u>(617) 524-7510 (h)</u> <u>(617) 973-7419 (w)</u>
Lessee/DBA (If Applicable)	Owner (if different from Applicant) Name Address City, State & Zip	Cost Of Work: \$ <u>5,000</u> <u>After Fact</u> <del>Cost Of Fee</del> \$ <u>100</u> Total Fee: \$ <u>170</u>
Current legal use (i.e. single family) <u>single family</u>		
If vacant, what was the previous use? <u>-</u>		
Proposed Specific use: <u>single family</u>		
Is property part of a subdivision? <u>No</u> If yes, please name _____		
Project description: <u>Replace existing porch, Add supports, within existing parameters</u>		
Contractor's name: <u>Macey Orme</u>		
Address: <u>PO Box 143</u>		
City, State & Zip: <u>Peaks Island ME 04108</u>		Telephone: <u>408-7100</u>
Who should we contact when the permit is ready: <u>Macey</u>		Telephone: <u>766-2878</u>
Mailing address: <u>same</u>		

**Please submit all of the information outlined on the applicable Checklist. Failure to do so will result in the automatic denial of your permit.**

In order to be sure the City fully understands the full scope of the project, the Planning and Development Department may request additional information prior to the issuance of a permit. For further information or to download copies of this form and other applications visit the Inspections Division on-line at [www.portlandmaine.gov](http://www.portlandmaine.gov), or stop by the Inspections Division office, room 315 City Hall or call 874-8703.

I hereby certify that I am the Owner of record of the named property, or that the owner of record authorizes the proposed work and that I have been authorized by the owner to make this application as his/her authorized agent. I agree to conform to all applicable laws of this jurisdiction. In addition, if a permit for work described in this application is issued, I certify that the Code Official's authorized representative shall have the authority to enter all areas covered by this permit at any time to enforce the provisions of the codes applicable to this permit.

**RECEIVED**

JUN 18 2010

Signature: <u>Henry L. Barbaro</u>	Date: <u>6/5/10</u>	Dept. of Building Inspections City of Portland Maine
------------------------------------	---------------------	---

**This is not a permit; you may not commence ANY work until the permit is issue**

~~Att~~ Bill Honan

846-0576



41 Hutchins Drive  
Portland, Maine 04102  
Tel.: 207-774-2112

### SERVICE LATERAL INSTALLATION

House No. & Street: 114 NEW ISLAND AVE

Tax Map # 85 Block # D Lot # 8

Date Installed: MAR 2001

Size of Service: 4"

Depth at End: 5.0'

Distance From MH #: \_\_\_\_\_

Length of Pipe Installed: 23.0'

85-D-8

114 New Island Ave.

2 Letters

① Mr.(s) Joseph H. & Edward P.

Quinn

② Ms. ~~Sharon Miller~~

~~42 Highland St~~

~~East Portland, ME, 06108~~

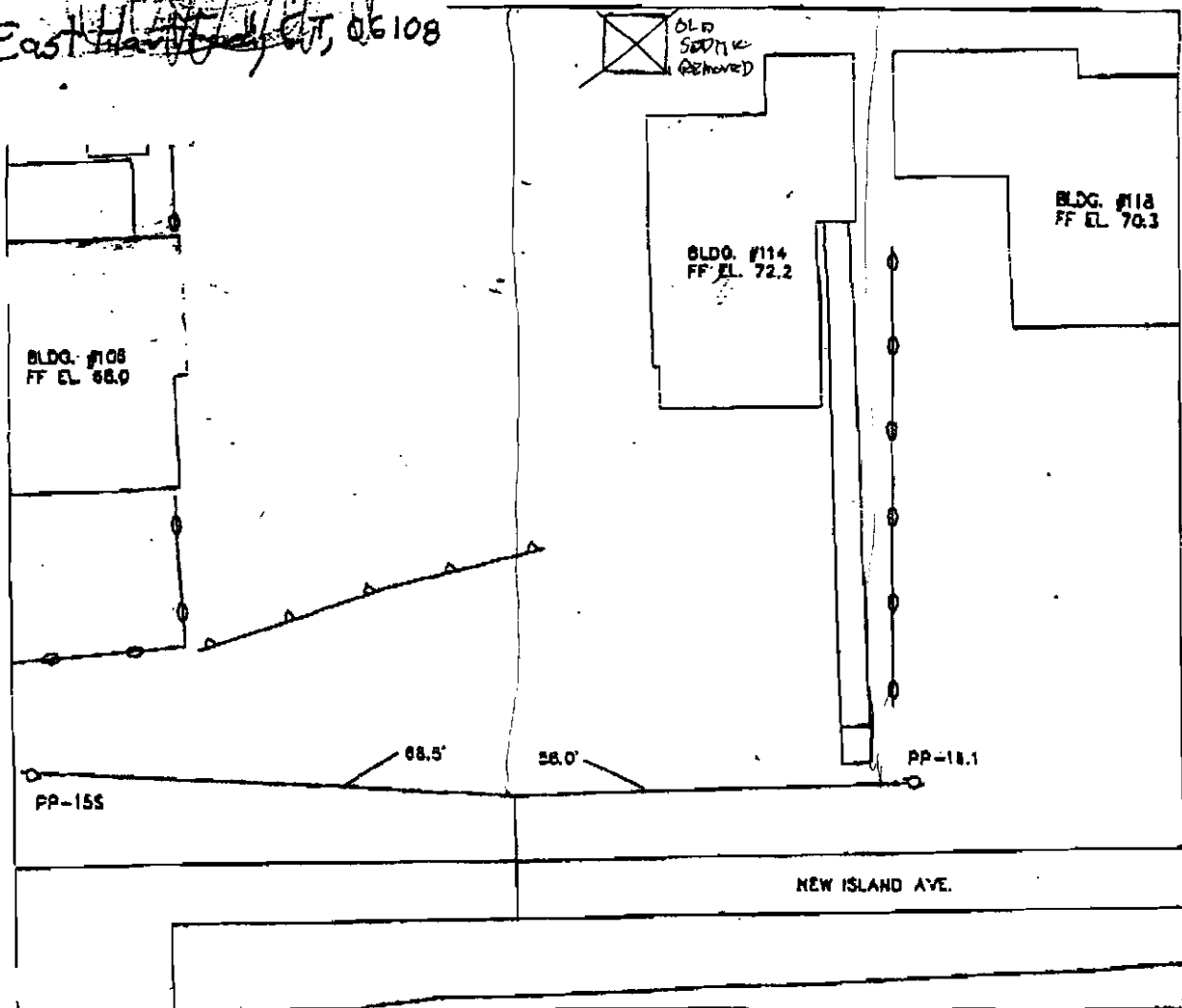

Field Engineer:

ALL LUMBER PRESSURE

□ = EXISTING FOOTING & POST TO REMAIN  
 ○ = NEW FOOTING & POST REPLACED

- ✓ ALL NEW POSTING TO BE 4x6 PT OR 4x4 PT
- ✓ IF LEAVE EXISTING POSTS TO REMAIN USE 4x4 PT
- ✓ 10" SQUARE POSTS TO BE 4x4 PT
- ✓ 1/2" ANGLE OF POST SET IN CEMENT FOR USE WITH SIMPSON POST BASE HARDWARE

- ✓ INTERIOR POSTS ARE 4x6 PT
- ✓ EXTERIOR POSTS ARE 4x4 PT ONLY (4x4 PT ONLY)
- ✓ DOUBLE 2x6 PT KING BOLTS PT
- 4x6 GIRDERS 4x6 PT 2x6 PT
- ✓ 5/8x6 DECK BRACKETS PT

Need 2x10s for 7' span  
 INTERIOR

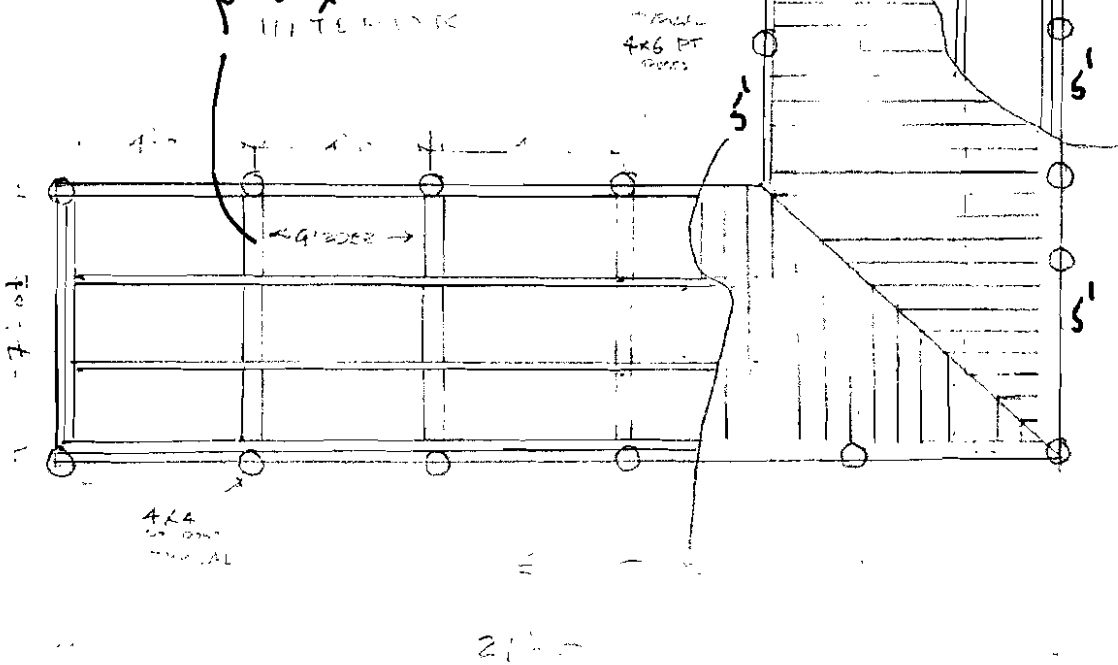

- PORCH ROOF AND UPPER PARTS REMAINING
- NEW RAILS TO EXISTING POST
- ✓ 36" RAIL
- NO LESS THAN 4" BETWEEN BALUSTERS

M. Taylor - H. Barbard  
 114 New Island Ave  
 Peaks Island 04106

EXTERIOR PORCH  
 FRAMING & DECK  
 REPLACEMENT  
 AND STAIRS  
 AS EXIST

SCALE 1/4" = 1'-0"  
 06/06/10



Portland Association, Inc. - Capital Building  
938 s.f.

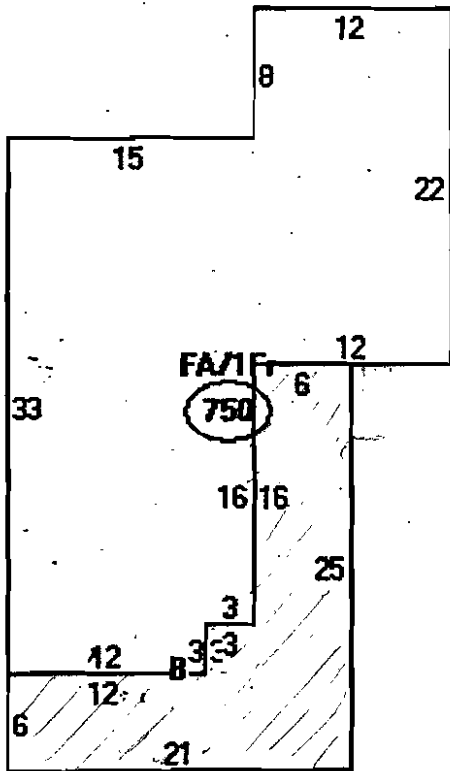

Descriptor/Area

A:FA/IF  
750 sqft

B:OFF  
249 sqft

existing to be  
replaced -

