

SECOND FLOOR-LOFT FLOOR PLAN

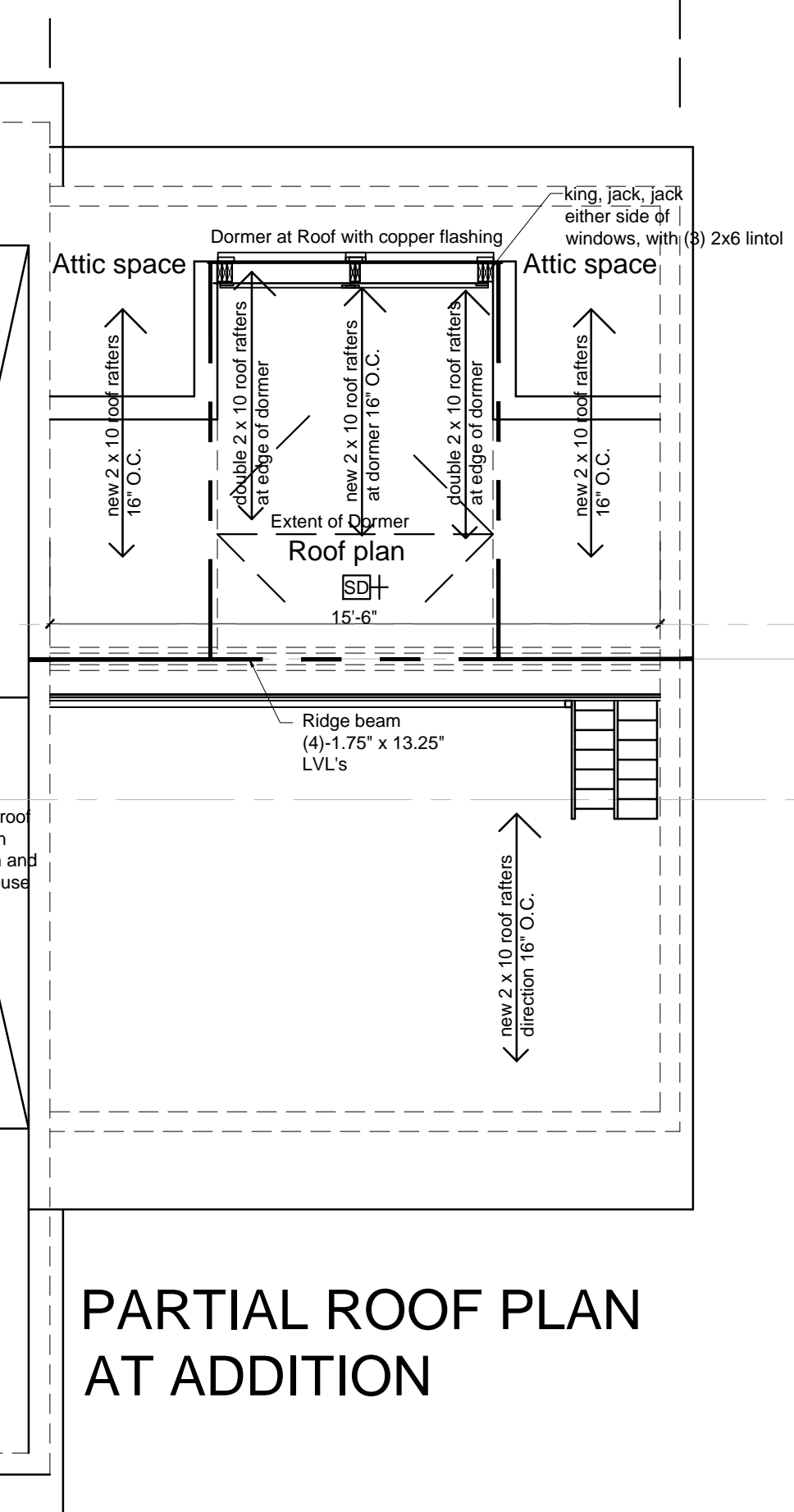

PARTIAL ROOF PLAN AT ADDITION

Work on Second Floor consist of Loft Area above New Bedroom Addition, heating system, scuttle to attic, smoke detectors, new windows and trim, new chimney, new wall at old chimney, millwork in closets, new vanity in exist. bath, painting of trim,walls and ceilings where needed and removal of existing chimney.

- WALL TYPES**
- - - Existing walls to be removed
 - Existing walls to remain 2x4 or 2x6
 - ▬ New walls of 2x4 or 2x6 wood frame construction
 - ▨ New 8" conc. foundation walls-see Structural Plans
- SMOKE DETECTOR HARD WIRED TO PANEL WITH BATTERY BACK-UP INTERCONNECTED
 EXHAUST FAN
 CO2 DETECTOR
- GENERAL ARCHITECTURAL NOTES**
-

SECOND FLOOR-LOFT FLOOR PLAN

scale : 1/4" = 1'-0"

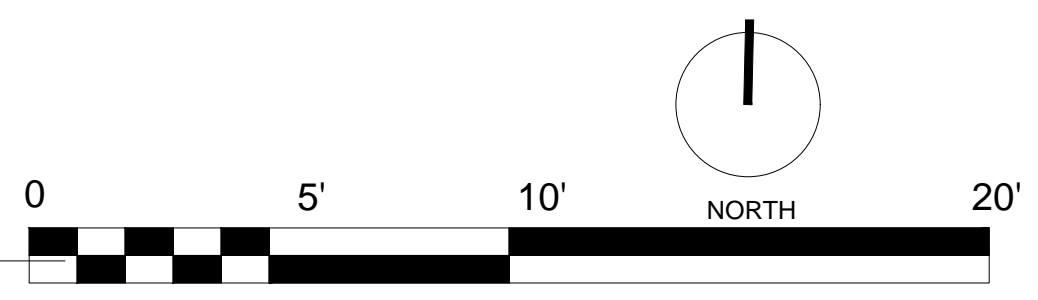

BELDEN COTTAGE
Owners
Anne B. Belden and John R. Belden
Trustees of the Anne B. Belden Living Trust

13 OAK AVENUE
PEAKS ISLAND, MAINE 04108

JAMES W. GREENWELL, AIA, PLLC
ARCHITECT

130 ISLAND AVENUE
PEAKS ISLAND, ME 04108

VOICE 207-766-2509
CELL 202-607-8976

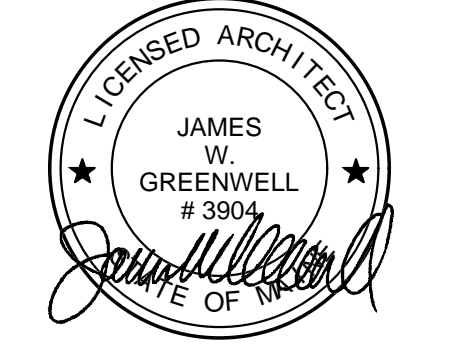

professional seal

consultants

ISSUE	DATE
PERMITS	7-21-2017
PERMIT REVISION	8-25-2017

SCALE: 1/4" = 1'-0"
second floor plan and roof plan with Demo

A .3