

17 Torrington Pt Rd P.I

2013-01492

084-4-003

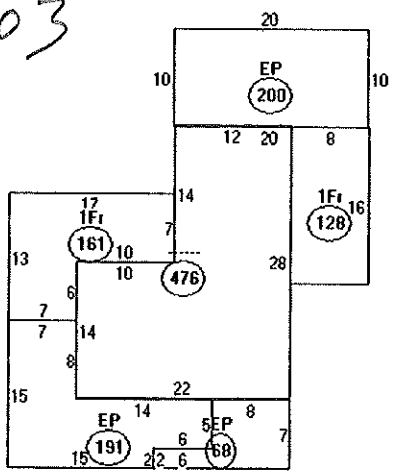

Descriptor/Area	Area
A:.....	476
476 sqft	
B: 1Fr	161
161 sqft	
C: 1Fr	128
128 sqft	
D: EP	68
68 sqft	
E: EP	191
191 sqft	
F: EP	200
200 sqft	
	<u>200</u>
	1224 #
	footprint

new floor area for bath

$$7.5' \times 7.5' = 56.25$$

$$56.25 \div 1224 = 4.6\%$$

of the 80%
Allowed under

14-436

OK