

OAK AVE

34'-0"

43'-0"

43'-0"

BACK
POARCH

13'-6"

8'-0"

22'-0"

7'-6"

4'-6"

180'-0"

PLOT PLAN

1/8" = 1'-0"

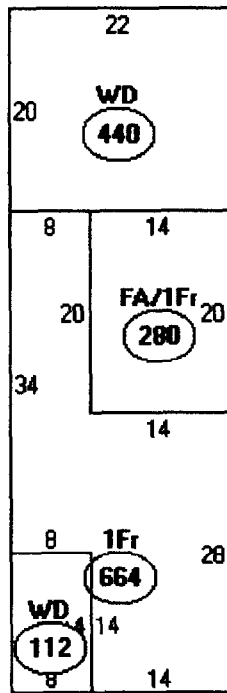

Descriptor/Area

- A: 1Fr
664 sqft
- B: WD
440 sqft
- C: FA/1Fr
280 sqft
- D: WD
112 sqft

26
(M)

30
(R)
31
64534

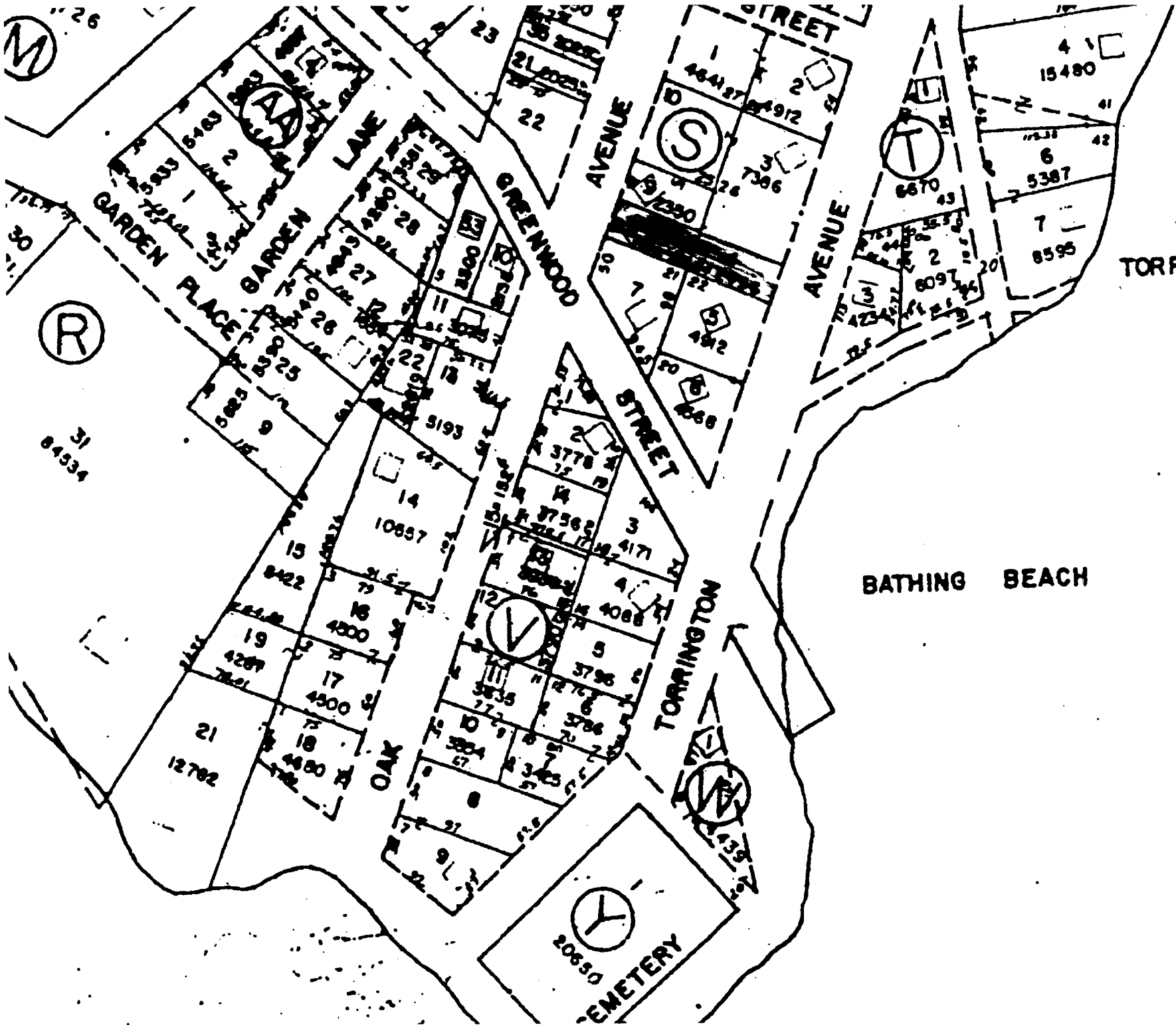

TORRINGTON F

BATHING BEACH

(Y)
20550
CEMETERY

Jim Martell <HOME IMPROVEMENTS>
62 Atlantic st.
Portland, Me. 04101
Tel: 831-4669

ESTIMATE # 026-02
Date: 4-30-2002

CUSTOMER:

Kathleen Montanese
50 Oak st.
Peaks Island, Maine 04108
207-766-2089

(TWO STORIE ADDITION & REHAB OF EXSISTING HOUSE)

This estimate is for the necessary labor and materials needed to complete referenced work.

SCOPE OF WORK:

- Remove old deck and save
- Construct a 10'-0 x 20'-0 deck on 12" sonotubes to ledge, supported by a carrying beam on 6"x6" post with diagonal bracing
- Construct first floor walls and second floor deck to existing house
- Construct 2nd floor walls and roof system to house and rework old roof system
- Side exterior of addition
- Trim and roof all new construction into existing house
- Install windows and doors
- Construct interior walls
- Build interior stair case, rough frame
- Install insulation in affected areas
- Install vapor barrier on exterior walls
- Hang 1/2" drywall in pre determined areas
- 3 coats of tape, sand to make paint ready
- Install pine to cathedral ceiling to match existing
- Install misc. trims through out interior
- Install siding under addition
- Modify and attach deck to house
- Construct a 10'-0x 10'-0 deck off the 2nd floor bedroom door as per print

Estimated Cost of Project ⇒ \$ 58,000.00