

SUBSURFACE WASTEWATER DISPOSAL SYSTEM APPLICATION

Department of Human Services
Division of Health Engineering
(207)289-3826

PROPERTY ADDRESS	
Town Or Plantation	PORTLAND (PEAKS ISLAND)
Street	MAP 84, R 31
Subdivision Lot #	OFF GARDEN PLACE
PROPERTY OWNERS NAME	
PEAKS ISLAND LIONS CLUB AT GREENWOOD GARDENS	
Last:	First:
Applicant Name: JIM BROWN, TREASURER	
Mailing Address of Owner/Applicant (If Different): NEW ISLAND AVENUE PEAKS ISLAND, ME. 04108	

PERMIT # 4522 STATE COPY or Double Fee Charged
 \$160.00 FEE
 L.P.I.# 01241
 Chief Plumbing Inspector

Owner/Applicant Statement
I certify that the information submitted is correct to the best of my knowledge and understand that any falsification is reason for the Local Plumbing Inspector to deny a Permit.

J. Brown 7/8/92
Signature of Owner/Applicant Date

Caution: Inspection Required

I have inspected the installation authorized above and found it to be in compliance with the Subsurface Wastewater Disposal Rules.

Local Plumbing Inspector Signature Date Approved

PERMIT INFORMATION

THIS APPLICATION IS FOR:

- NEW SYSTEM
- REPLACEMENT SYSTEM
- EXPANDED SYSTEM
- EXPERIMENTAL SYSTEM

SEASONAL CONVERSION
to be completed by the LPI

- SYSTEM COMPLIES WITH RULES
- CONNECTED TO SANITARY SEWER
- SYSTEM INSTALLED - P# _____
- SYSTEM DESIGN RECORDED AND ATTACHED

IF REPLACEMENT SYSTEM:
YEAR FAILING SYSTEM INSTALLED 1974

THE FAILING SYSTEM IS:

- BED
- CHAMBER
- TRENCH
- OTHER: _____

SIZE OF PROPERTY: 84,534 ± ZONING: _____

THIS APPLICATION REQUIRES:

- NO RULE VARIANCE
- NEW SYSTEM VARIANCE
Attach New System Variance Form
- REPLACEMENT SYSTEM VARIANCE
Attach Replacement System Variance Form
 - Requiring Local Plumbing Inspector Approval
 - Requires State and Local Plumbing Inspector Approval
- MINIMUM LOT SIZE VARIANCE

Requires DHS approval for design flow see 2/7/92 flow

DISPOSAL SYSTEM TO SERVE:

- SINGLE FAMILY DWELLING
- MODULAR OR MOBILE HOME
- MULTIPLE FAMILY DWELLING
- OTHER LIONS CLUB
SPECIFY _____

INSTALLATION IS:
COMPLETE SYSTEM

- NON-ENGINEERED SYSTEM
- PRIMITIVE SYSTEM
(Includes Alternative Toilet)
- ENGINEERED (+2000 gpd)

INDIVIDUALLY INSTALLED COMPONENTS:

- TREATMENT TANK (ONLY)
- HOLDING TANK _____ GAL
- ALTERNATIVE TOILET (ONLY)
- NON-ENGINEERED DISPOSAL AREA (ONLY)
- ENGINEERED DISPOSAL AREA (ONLY)
- SEPARATED LAUNDRY SYSTEM

TYPE OF WATER SUPPLY
PUBLIC WATER

DESIGN DETAILS (SYSTEM LAYOUT SHOWN ON PAGE 3)

TREATMENT TANK

- SEPTIC: Regular Low Profile
- AEROBIC (IF NECESSARY)

SIZE: (2) - 1000 GALS.
OR 1 - 1500 GALLON

SOIL CONDITIONS USED FOR DESIGN PURPOSES

PROFILE	CONDITION
4	C

DEPTH TO LIMITING FACTOR: 26

WATER CONSERVATION

- NONE
- LOW VOLUME TOILET
- SEPARATED LAUNDRY SYSTEM
- ALTERNATIVE TOILET

SPECIFY: _____

SIZE RATINGS USED FOR DESIGN PURPOSES

- SMALL
- MEDIUM
- MEDIUM-LARGE
- LARGE
- EXTRA LARGE

PUMPING

- NOT REQUIRED
- MAY BE REQUIRED
(DEPENDING ON TREATMENT TANK LOCATION AND ELEVATION)
- REQUIRED
DOSE: 150 GALS.

DISPOSAL AREA TYPE/SIZE

- BED _____ Sq. Ft.
- CHAMBER 200 Sq. Ft.
 REGULAR H-20
- TRENCH _____ Linear Ft.
- OTHER: _____

CRITERIA USED FOR DESIGN FLOW (BEDROOMS, SEATING, EMPLOYEES, WATER RECORDS, ETC.)

ASSEMBLY HALL (LIONS CLUB)

1.65 X WATER USAGE RECORDS

DESIGN FLOW: 900
(GALLONS/DAY)

48 PLASTIC CHAMBERS

SITE EVALUATOR STATEMENT

On JANUARY 29, 1992 (date) I conducted a site evaluation for this project and certify that the data reported is accurate. The system I propose is in accordance with the Subsurface Wastewater Disposal Rules.

Albert Frick 163 2/10/92
Site Evaluator Signature SE# Date

Page 1 of 3
HHE-200 Rev. 11/86

(Local Plumbing Inspector's Signature if permit is for Seasonal Conversion.)

SUBSURFACE WASTEWATER DISPOSAL SYSTEM APPLICATION

Department of Human Services
Division of Health Engineering

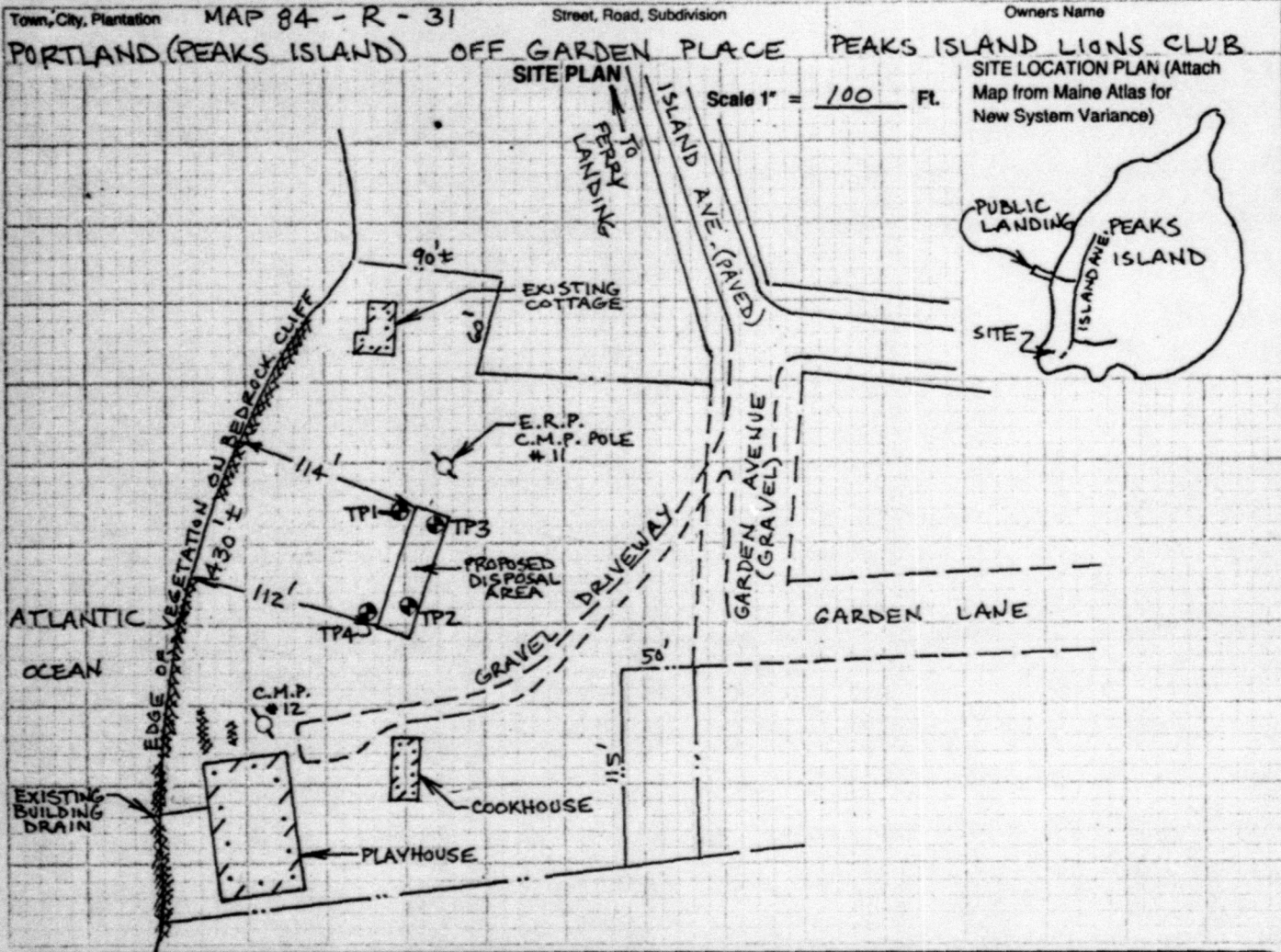

SOIL DESCRIPTION AND CLASSIFICATION (Location of Observation Holes Shown Above)

Observation Hole TP1 Test Pit Boring

* Depth of Organic Horizon Above Mineral Soil

Texture	Consistency	Color	Mottling
SANDY	FROZEN	DARK	
LOAM		BROWN	
LOAMY		DARK	
SAND		YELLOWISH BROWN	
COARSE SAND & GRAVEL	FRIABLE	MIXED OLIVE BROWN	FEW, FAINT
LOAMY SAND & SAND		OLIVE	COMMON, DISTINCT
(LIMIT OF EXCAVATION AT 50")			

Soil Profile <u>4</u>	Classification <u>C</u>	Slope <u> </u> %	Limiting Factor <u>Z8</u>	<input checked="" type="checkbox"/> Ground Water
	Condition			<input type="checkbox"/> Restrictive Layer
				<input type="checkbox"/> Bedrock

Observation Hole TP2 Test Pit Boring

* Depth of Organic Horizon Above Mineral Soil

Texture	Consistency	Color	Mottling
SANDY	FROZEN	DARK	
LOAM		BROWN	
LOAMY SAND & SAND	FRIABLE	DARK YELLOWISH BROWN	
COARSE SAND & GRAVEL		LIGHT OLIVE BROWN	FEW, FAINT
(LIMIT OF EXCAVATION AT 52")			

Soil Profile <u>4</u>	Classification <u>C</u>	Slope <u> </u> %	Limiting Factor <u>Z8</u>	<input checked="" type="checkbox"/> Ground Water
	Condition			<input type="checkbox"/> Restrictive Layer
				<input type="checkbox"/> Bedrock

Albert Frick

Site Evaluator Signature

163

SE#

2/10/92

Date

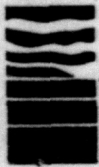

Albert Frick Associates, Inc.

Soil Scientists & Site Evaluators

95A County Road Gorham, Maine 04038

(207) 839-5563

Town, City, Plantation MAP 84-R-31 Street, Road, Subdivision _____ Owners Name _____
PORTLAND (PEAKS ISLAND) OFF GARDEN PLACE PEAKS ISLAND LIONS CLUB

SOIL DESCRIPTION AND CLASSIFICATION

Observation Hole TP 3 Test Pit Boring

_____" Depth of Organic Horizon Above Mineral Soil

Texture	Consistency	Color	Mottling
0			
3			
6			
9			
12			
15			
18			
21			
24			
27			
30			
33			
36			
39			
42			
45			
48			
51			
54			
57			
60			
63			
66			
69			
72			
75			
78			
81			
84			
87			
90			
93			
96			
99			
102			
105			
108			
111			
114			
117			
120			
123			
126			
129			
132			
135			
138			
141			
144			
147			
150			
153			
156			
159			
162			
165			
168			
171			
174			
177			
180			
183			
186			
189			
192			
195			
198			
201			
204			
207			
210			
213			
216			
219			
222			
225			
228			
231			
234			
237			
240			
243			
246			
249			
252			
255			
258			
261			
264			
267			
270			
273			
276			
279			
282			
285			
288			
291			
294			
297			
300			
303			
306			
309			
312			
315			
318			
321			
324			
327			
330			
333			
336			
339			
342			
345			
348			
351			
354			
357			
360			
363			
366			
369			
372			
375			
378			
381			
384			
387			
390			
393			
396			
399			
402			
405			
408			
411			
414			
417			
420			
423			
426			
429			
432			
435			
438			
441			
444			
447			
450			
453			
456			
459			
462			
465			
468			
471			
474			
477			
480			
483			
486			
489			
492			
495			
498			
501			
504			
507			
510			
513			
516			
519			
522			
525			
528			
531			
534			
537			
540			
543			
546			
549			
552			
555			
558			
561			
564			
567			
570			
573			
576			
579			
582			
585			
588			
591			
594			
597			
600			
603			
606			
609			
612			
615			
618			
621			
624			
627			
630			
633			
636			
639			
642			
645			
648			
651			
654			
657			
660			
663			
666			
669			
672			
675			
678			
681			
684			
687			
690			
693			
696			
699			
702			
705			
708			
711			
714			
717			
720			
723			
726			
729			
732			
735			
738			
741			
744			
747			
750			
753			
756			
759			
762			
765			
768			
771			
774			
777			
780			
783			
786			
789			
792			
795			
798			
801			
804			
807			
810			
813			
816			
819			
822			
825			
828			
831			
834			
837			
840			
843			
846			
849			
852			
855			
858			
861			
864			
867			
870			
873			
876			
879			
882			
885			
888			
891			
894			
897			
900			
903			
906			
909			
912			
915			
918			
921			
924			
927			
930			
933			
936			
939			
942			
945			
948			
951			
954			
957			
960			
963			
966			
969			
972			
975			
978			
981			
984			
987			
990			
993			
996			
999			
1002			
1005			
1008			
1011			
1014			
1017			
1020			
1023			
1026			
1029			
1032			
1035			
1038			
1041			
1044			
1047			
1050			
1053			
1056			
1059			
1062			
1065			
1068			
1071			
1074			
1077			
1080			
1083			
1086			
1089			
1092			
1095			
1098			
1101			
1104			
1107			
1110			
1113			
1116			
1119			
1122			
1125			
1128			
1131			
1134			
1137			
1140			
1143			
1146			
1149			
1152			
1155			
1158			
1161			
1164			
1167			
1170			
1173			
1176			
1179			
1182			
1185			
1188			
1191			
1194			
1197			
1200			
1203			
1206			
1209			
1212			
1215			
1218			
1221			
1224			
1227			
1230			
1233			
1236			
1239			
1242			
1245			
1248			
1251			
1254			
1257			
1260			
1263			
1266			
1269			
1272			
1275			
1278			
1281			
1284			
1287			
1290			
1293			
1296			
1299			
1302			
1305			
1308			
1311			
1314			
1317			
1320			
1323			
1326			
1329			
1332			
1335			
1338			
1341			
1344			
1347			
1350			
1353			
1356			
1359			
1362			
1365			
1368			
1371			
1374			
1377			
1380			
1383			
1386			
1389			
1392			
1395			
1398			
1401			
1404			
1407			

SUBSURFACE WASTEWATER DISPOSAL SYSTEM APPLICATION

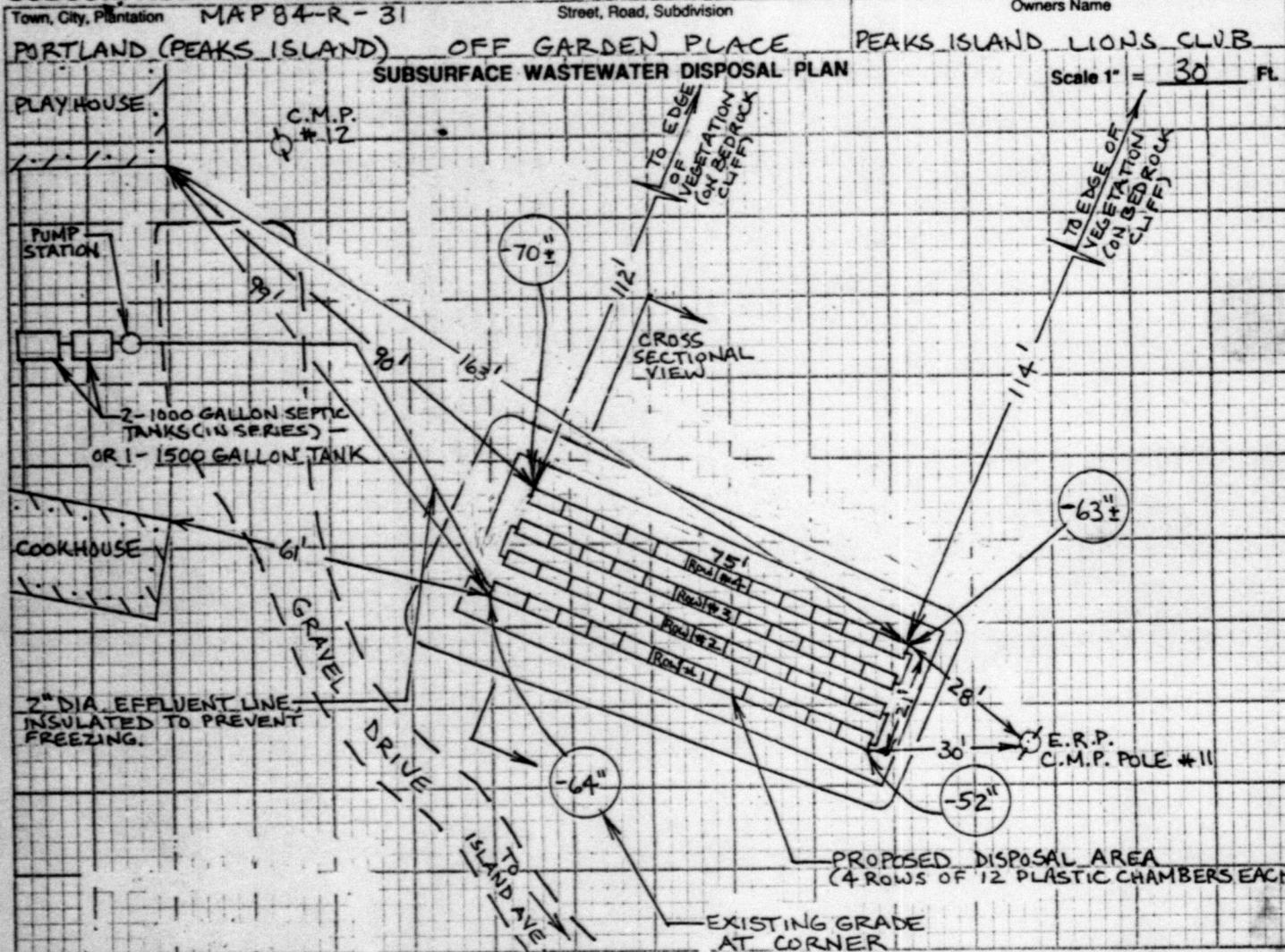

FILL REQUIREMENTS	CONSTRUCTION ELEVATIONS	ELEVATION REFERENCE POINT LOCATION & DESCRIPTION
Depth of Fill (Upslope) 11"-23"	Reference Elevation is	00 SEE DETAIL BELOW NAIL IN C.M.P. POLE # 11, 47" ABOVE BASE OF POLE.
Depth of Fill (Downslope) 13"-20"	Bottom of Disposal Area	
	Top of Distribution Lines or Chambers	

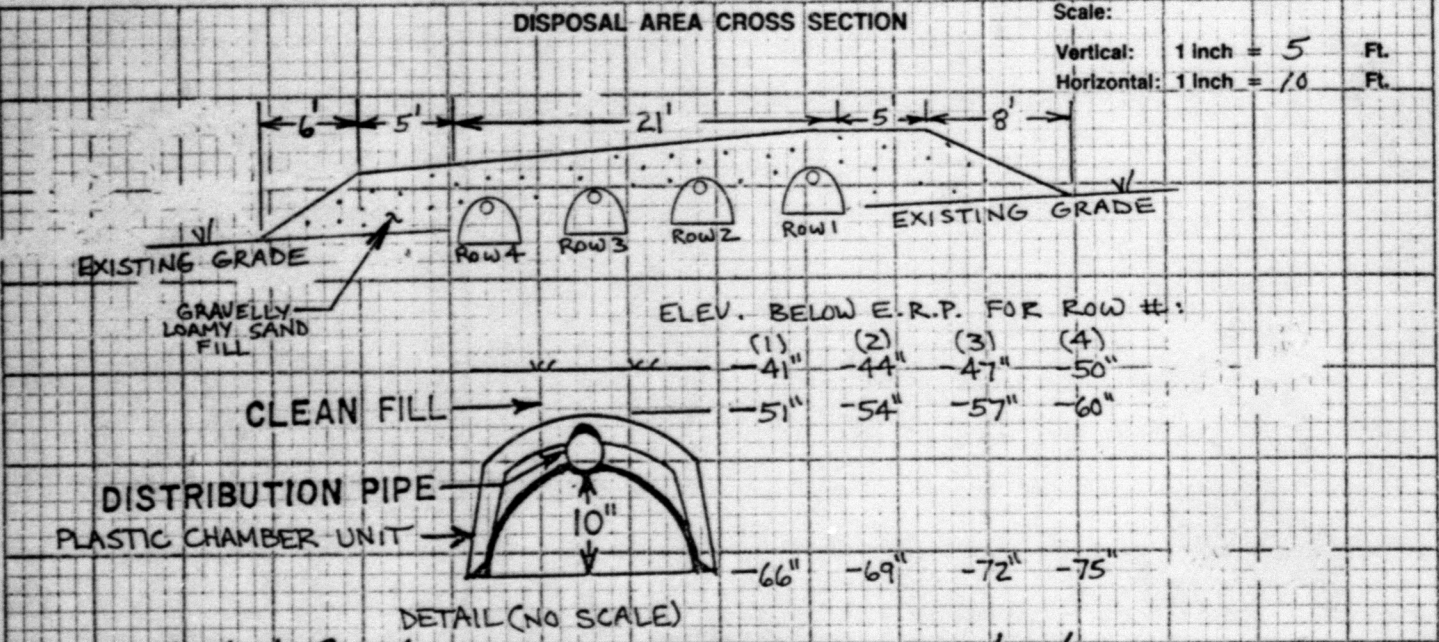

Albert Frick
 Site Evaluator Signature

163
 SE#

2/10/92
 Date



Albert Frick Associates, Inc.
Soil Scientists & Site Evaluators
95A County Road Gorham, Maine 04038

Albert Frick SS, SE
James Loggn SS, SE

PORTLAND (PEAKS ISLAND)
TOWN

MAP 84 R-31
OFF GARDEN PLACE
LOCATION

PEAKS ISLAND LIONS CLUB
APPLICANT'S NAME

1) The most recent revision of the State of Maine, Subsurface Wastewater Disposal Rules, is hereby made a part of this application and shall be consulted by the owner/applicant and the system installer for further construction details and material specifications. The contractor or subcontractor should contact Albert Frick Associates, 839-5563, if there are any questions concerning materials, procedures or designs. The contractor installing the system is responsible for knowledge of the State of Maine, Subsurface Wastewater Disposal Rules as it pertains to permits, inspection requirements, building drains and sewers, treatment tanks, wastewater application details and construction details sections (3,4,8,9,10 and 11D).

2) This application is intended to represent facts pertinent to the State of Maine, Subsurface Disposal Rules only. It shall be the responsibility of the owner or applicant to determine compliance with and obtain permits under all local, state and federal land-use regulations (i.e., DEP Natural Resources Protection Act, wetland regulations, zoning ordinances, subdivision regulations, etc.) before installing this system or considering this a buildable lot. A wetland scientist may be consulted regarding wetland regulations or you may contact the Army Corp of Engineering at 623-8367 or DEP at 289-2111.

The LPI shall inform the owner and designer of any local ordinances exceeding the State of Maine, Subsurface Wastewater Disposal Rules in order that the design may be amended. All designs are subject to review by local, State or federal authority. Designer's liability shall be limited to revisions required by regulatory agencies.

3) All information shown on this form relating to property lines, well locations, and subsurface structures (utility lines, drains, septic systems, water lines, etc.) are shown or left off as not affecting the proposed system based on information provided by the owner or applicant. The owner shall review this application prior to the start of construction and confirm this information.

4) Installation of a garbage grinder is not recommended. If one is installed, an additional 1000 gallon septic tank shall be connected in series to the proposed septic tank.

5) The system user shall avoid introducing kitchen grease or fats into this system. Chemicals such as septic tank cleaners and chlorine (i.e. from water treatment, and controlled or hazardous substances) shall not be disposed of in this system.

6) The septic tank should be pumped within two years of installation and subsequently as recommended by the pump service but not to exceed one pump per three year period.