

DISPLAY THIS CARD ON PRINCIPAL FRONTAGE OF WORK



CITY OF PORTLAND

BUILDING PERMIT

This is to certify that JUDITH K CLANCY

Located At 30 WHITEHEAD ST

Job ID: 2011-12-2907-ALTR

CBL: 084- N-037-001

has permission to Replace windows and doors on front porch

provided that the person or persons, firm or corporation accepting this permit shall comply with all of the provisions of the Statues of Maine and of the Ordinances of the City of Portland regulating the construction, maintenance and use of the buildings and structures, and of the application on file in the department.

Notification of inspection and written permission procured before this building or part thereof is lathed or otherwise closed-in. 48 HOUR NOTICE IS REQUIRED.

A final inspection must be completed by owner before this building or part thereof is occupied. If a certificate of occupancy is required, it must be

Fire Prevention Officer

Code Enforcement Officer / Plan Reviewer

THIS CARD MUST BE POSTED ON THE STREET SIDE OF THE PROPERTY
PENALTY FOR REMOVING THIS CARD

BUILDING PERMIT INSPECTION PROCEDURES

Please call 874-8703 or 874-8693 (ONLY)

or email: buildinginspections@portlandmaine.gov

With the issuance of this permit, the owner, builder or their designee is required to provide adequate notice to the city of Portland Inspections Services for the following inspections. Appointments must be requested 48 to 72 hours in advance of the required inspection. The inspection date will need to be confirmed by this office.

- **Please read the conditions of approval that is attached to this permit!! Contact this office if you have any questions.**
- **Permits expire in 6 months. If the project is not started or ceases for 6 months.**
- **If the inspection requirements are not followed as stated below additional fees may be incurred due to the issuance of a "Stop Work Order" and subsequent release to continue.**

Required Inspections:

Close In Elec/Plmb/Frame prior to insulate or gyp

Final Inspection

The project cannot move to the next phase prior to the required inspection and approval to continue, REGARDLESS OF THE NOTICE OF CIRCUMSTANCES.

IF THE PERMIT REQUIRES A CERTIFICATE OF OCCUPANCY, IT MUST BE PAID FOR AND ISSUED TO THE OWNER OR DESIGNEE BEFORE THE SPACE MAY BE OCCUPIED.



PORTLAND MAINE

Strengthening a Remarkable City, Building a Community for Life • www.portlandmaine.gov

Director of Planning and Urban Development
Penny St. Louis

Job ID: 2011-12-2907-ALTR

Located At: 30 WHITEHEAD ST

CBL: 084- N-037-001

Conditions of Approval:

Building

1. Separate permits are required for any electrical, plumbing, sprinkler, fire alarm HVAC systems, heating appliances, commercial hood exhaust systems and fuel tanks. Separate plans may need to be submitted for approval as a part of this process.
2. Application approval based upon information provided by applicant. Any deviation from approved plans requires separate review and approval prior to work.
3. If any structural changes are made to the openings, additional header information shall be submitted to this office.

City of Portland, Maine - Building or Use Permit Application

389 Congress Street, 04101 Tel: (207) 874-8703, FAX: (207) 8716

Job No: 2011-12-2907-ALTR	Date Applied: 12/12/2011	CBL: 084- N-037-001	
Location of Construction: 30 WHITEHEAD ST, PEAKS ISLAND	Owner Name: JUDITH K CLANCY	Owner Address: 12 JUSTAMERE RD FALMOUTH, ME 04105	Phone: 207-838-2859
Business Name:	Contractor Name: Wintergreen Solariums	Contractor Address: 470 Riverside St., Portland, ME 04103	Phone: 207-797-3778
Lessee/Buyer's Name:	Phone:	Permit Type: BLDG - Building	Zone: IR-2
Past Use: Single family	Proposed Use: Same - Single family - replace windows and door on front enclosed porch	Cost of Work: 10000.00	CEO District:
		Fire Dept: <input checked="" type="checkbox"/> Approved <input type="checkbox"/> Denied <input type="checkbox"/> N/A	Inspection: Use Group: <i>2-3</i> Type: <i>SB</i>
		Signature: <i>Capt. Pelone 12-18-11</i>	Signature: <i>[Signature]</i>
Proposed Project Description: remove & replace windows & doors on porch		Pedestrian Activities District (P.A.D.)	
Permit Taken By:		Zoning Approval	

<p>1. This permit application does not preclude the Applicant(s) from meeting applicable State and Federal Rules.</p> <p>2. Building Permits do not include plumbing, septic or electrical work.</p> <p>3. Building permits are void if work is not started within six (6) months of the date of issuance. False informatin may invalidate a building permit and stop all work.</p>	<p>Special Zone or Reviews</p> <p><input type="checkbox"/> Shoreland</p> <p><input type="checkbox"/> Wetlands</p> <p><input type="checkbox"/> Flood Zone</p> <p><input type="checkbox"/> Subdivision</p> <p><input type="checkbox"/> Site Plan</p> <p><input type="checkbox"/> Maj <input type="checkbox"/> Min <input type="checkbox"/> MM</p> <p>Date: <i>OK 12/14/11 ABU.</i></p>	<p>Zoning Appeal</p> <p><input type="checkbox"/> Variance</p> <p><input type="checkbox"/> Miscellaneous</p> <p><input type="checkbox"/> Conditional Use</p> <p><input type="checkbox"/> Interpretation</p> <p><input type="checkbox"/> Approved</p> <p><input type="checkbox"/> Denied</p> <p>Date:</p>	<p>Historic Preservation</p> <p><input checked="" type="checkbox"/> Not in Dist or Landmark</p> <p><input type="checkbox"/> Does not Require Review</p> <p><input type="checkbox"/> Requires Review</p> <p><input type="checkbox"/> Approved</p> <p><input type="checkbox"/> Approved w/Conditions</p> <p><input type="checkbox"/> Denied</p> <p>Date: <i>ABU</i></p>
	CERTIFICATION		

I hereby certify that I am the owner of record of the named property, or that the proposed work is authorized by the owner of record and that I have been authorized by the owner to make this application as his authorized agent and I agree to conform to all applicable laws of this jurisdiction. In addition, if a permit for work described in the application is issued, I certify that the code official's authorized representative shall have the authority to enter all areas covered by such permit at any reasonable hour to enforce the provision of the code(s) applicable to such permit.

SIGNATURE OF APPLICANT	ADDRESS	DATE	PHONE
RESPONSIBLE PERSON IN CHARGE OF WORK, TITLE		DATE	PHONE

IR-2

2011 12 2907

68



General Building Permit Application

If you or the property owner owes real estate or personal property taxes or user charges on any property within the City, payment arrangements must be made before permits of any kind are accepted.

Location/Address of Construction: <u>30 Whitehead St Peaks</u>		
Total Square Footage of Proposed Structure/Area	Square Footage of Lot	Number of Stories <u>1 1/2</u>
Tax Assessor's Chart, Block & Lot Chart# <u>084</u> Block# <u>N</u> Lot# <u>037</u>	Applicant: (must be owner, lessee or buyer) Name <u>JUDITH CLANCY</u> Address <u>30 WHITEHEAD ST.</u> City, State & Zip <u>PEAKS ISLAND ME</u>	Telephone: <u>207-835-2859</u>
Lessee/DBA RECEIVED DEC 12 2011 Dept. of Building Inspections City of Portland Maine	Owner: (if different from applicant) Name <u>SAME</u> Address City, State & Zip	Cost of Work: <u>\$10,000.00</u> C of O Fee: \$ Historic Review: \$ Planning Amin.: \$ Total Fee: \$ <u>120.00</u>
Current legal use (i.e. <u>single family</u>) <u>SINGLE FAMILY</u> Number of Residential Units <u>1</u>		
If vacant, what was the previous use? _____		
Proposed Specific use: _____		
Is property part of a subdivision? _____ If yes, please name _____		
Project description: <u>Remove Existing Windows & Door on Porch Install New Windows & Door</u>		
Contractor's name: <u>Winter Green Solariums</u>		Email: _____
Address: <u>470 RIVERSIDE ST</u>		
City, State & Zip <u>PORTLAND, ME 04103</u>		Telephone: <u>797-3778</u>
Who should we contact when the permit is ready: <u>DON GRUDEN</u>		Telephone: _____
Mailing address: <u>SAME</u>		

Please submit all of the information outlined on the applicable checklist. Failure to do so will result in the automatic denial of your permit.

WinterGreen SOLARIUMS
536 Riverside Street, Portland, Maine 04103
Don Gruden
Production Manager
Glass Room Additions • Conservatories • Basement Finishing • Specialty Remodeling
Phone: 207-797-3778 Cell: 207-415-5369
Email: don@wintergreensolariums.com
www.wintergreensolariums.com

scope of the project, the Planning and Development Department may request... For further information or to download copies of this form and other www.portlandmaine.gov, or stop by the Inspections Division office, room 315

named property, or that the owner of record authorizes the proposed work and application as his/her authorized agent. I agree to conform to all applicable work described in this application is issued, I certify that the Code Official's enter all areas covered by this permit at any reasonable hour to enforce the

Signature: Judith K. Clancy Date: 12.9.2011

This is not a permit; you may not commence ANY work until the permit is issued

Production_WinterGreen Solariums

From: Mark Griffeth [markg@biosenv.com]
Sent: Friday, December 09, 2011 9:11 AM
To: Production_WinterGreen Solariums
Subject: Fwd:

Sent from mark's iPhone

Begin forwarded message:

From: "Mark Griffeth" <markg@biosenv.com>
To: "production@wintergreensolaums.com"
<production@wintergreensolaums.com>



Sent from mark's iPhone

12/12/2011

MEASURE PLAN

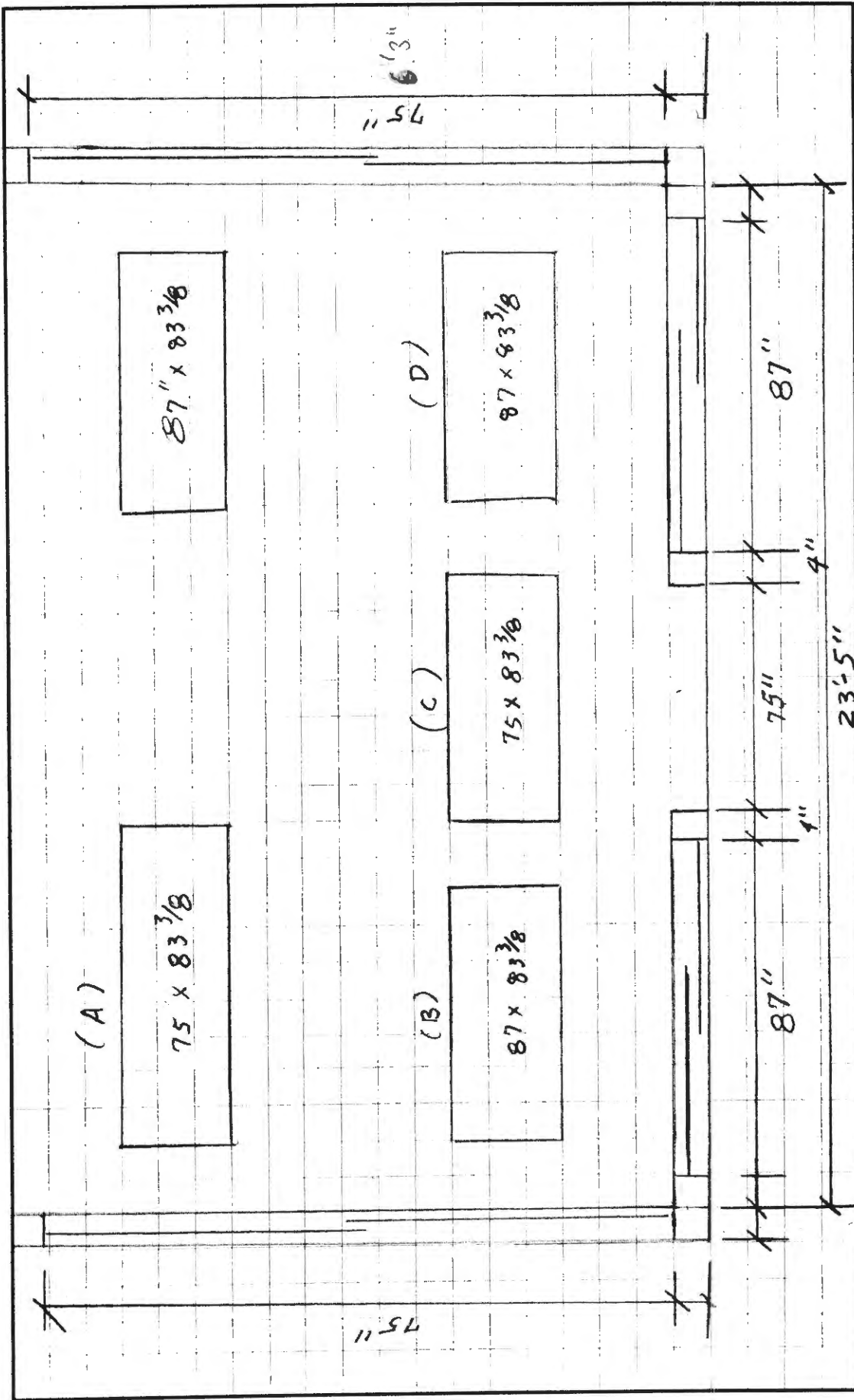

NOTES CLANCY ENCLOSED PORCH

GLASS SPECIFICATIONS*

		<i>Pane Thickness</i>	<i>Spacer Type</i>	<i>Spacer Size</i>	<i>Low-E Coated</i>	<i>Airspace Fill</i>	<i>Overall Unit Thickness</i>	<i>U-Value (Center of Glass)</i>	<i>R-Value (Center of Glass)</i>	<i>Solar Heat Gain Coefficient (SHGC)</i>	<i>Visible Transmittance %</i>	<i>U.V. Transmittance %</i>
Aluminum	Single Glaze - Clear 33" - 69" Windows	1/8"	N/A	N/A	N/A	N/A	1/8"	1.11	0.90	0.87	0.91	0.72
	Single Glaze - Clear 75" - 87" Windows All Doors	5/32"	N/A	N/A	N/A	N/A	5/32"	1.11	0.90	0.85	0.90	0.68
Aluminum	Single Glaze - Bronze 33" - 69" Windows	1/8"	N/A	N/A	N/A	N/A	1/8"	1.11	0.90	0.74	0.69	0.37
	Single Glaze - Bronze 75" - 87" Windows All Doors	5/32"	N/A	N/A	N/A	N/A	5/32"	1.11	0.90	0.71	0.68	0.33
Aluminum	Insulated - Clear 33" - 87" Windows 57" - 75" Doors	1/8"	Intercept Seal®	3/8"	Yes	Argon	5/8"	0.34	2.94	0.66	0.76	0.44
	Insulated - Clear 81" - 87" Doors	5/32"	Intercept Seal®	5/16"	Yes	Argon	5/8"	0.36	2.78	0.65	0.75	0.42
Vinyl	Insulated - Clear All Units	1/8"	Intercept Seal®	1/2"	Yes	Argon	3/4"	.22-.24	4.35	0.47	0.71	0.30
Skylight	Insulated - Clear Rough Opening 18 1/4" x 34 1/4"	1/8"	Intercept Seal®	3/4"	Yes	Argon	1"	3.00	0.31	0.81	0.75	0.48

*NOTE: All values given are for GLASS ONLY. Values based on manufacturers published data.
All glass listed above is tempered glass.