

PERMIT ISSUED

City of Portland, Maine - Building or Use Permit Application
389 Congress Street, 04101 Tel: (207) 874-8703, Fax: (207) 874-8716

Permit No: 02-161 Issue Date: OCT 18 2002 CBL: 084 L001001

Location of Construction: 61 Welch St Peaks Is Owner Name: Lausier James R & Robert F & Owner Address: 16 Adams St CITY OF PORTLAND Phone: 763 5157

Business Name: Contractor Name: Burkholder, Brad Contractor Address: Island Avenue Peaks Island Phone: 2077662428

Lessee/Buyer's Name: Phone: Permit Type: Additions - Dwellings Zone: IR-2

Past Use: Single Family Proposed Use: Single Family Permit Fee: \$37.00 Cost of Work: \$2,000.00 CEO District: 3

FIRE DEPT: N/A INSPECTION: Use Group: R-3 Type: SB BOCA 99 w/conditions

Proposed Project Description: Constrcut a 10' x 12' Deck Signature: Signature:

PEDESTRIAN ACTIVITIES DISTRICT (P.A.D.) Action: [] Approved [] Approved w/Conditions [] Denied Signature: Date:

Permit Taken By: gad Date Applied For: 10/11/2002 Zoning Approval

1. This permit application does not preclude the Applicant(s) from meeting applicable State and Federal Rules. 2. Building permits do not include plumbing, septic or electrical work. 3. Building permits are void if work is not started within six (6) months of the date of issuance. False information may invalidate a building permit and stop all work.. Special Zone or Reviews: [] Shoreland [] Wetland [] Flood Zone [] Subdivision [] Site Plan Zoning Appeal: [] Variance [] Miscellaneous [] Conditional Use [] Interpretation [] Approved [] Denied Historic Preservation: [x] Not in District or Landmark [] Does Not Require Review [] Requires Review [] Approved [] Approved w/Conditions [] Denied Date: 10/16/02

CERTIFICATION

I hereby certify that I am the owner of record of the named property, or that the proposed work is authorized by the owner of record and that I have been authorized by the owner to make this application as his authorized agent and I agree to conform to all applicable laws of this jurisdiction. In addition, if a permit for work described in the application is issued, I certify that the code official's authorized representative shall have the authority to enter all areas covered by such permit at any reasonable hour to enforce the provision of the code(s) applicable to such permit.

SIGNATURE OF APPLICANT ADDRESS DATE PHONE

RESPONSIBLE PERSON IN CHARGE OF WORK, TITLE DATE PHONE

DISPLAY THIS CARD ON PRINCIPAL FRONTAGE OF WORK CITY OF PORTLAND

Please Read Application And Notes, If Any, Attached

BUILDING DEPARTMENT

PERMIT

Permit Number: 021161

This is to certify that Lausier James R & Robert F Burkholder, Reed
has permission to Construct a 10' x 12' Deck
AT 61 Welch St Perks IS 084 L001001

provided that the person or persons, firm or corporation accepting this permit shall comply with all of the provisions of the Statutes of Maine and of the ordinances of the City of Portland regulating the construction, maintenance and use of buildings and structures, and of the application on file in this department.

Apply to Public Works for street line and grade if nature of work requires such information.

Notification of inspection must be given and when permission is procured before this building or part thereof is occupied or closed-in. 24 HOUR NOTICE IS REQUIRED.

A certificate of occupancy must be procured by owner before this building or part thereof is occupied.

OTHER REQUIRED APPROVALS

Fire Dept. _____
Health Dept. _____
Appeal Board _____
Other _____

PERMIT ISSUED
OCT 18 2002
CITY OF PORTLAND

10/17/02

Director - Building & Inspection Services

PERMIT IS VOID FOR REMOVING THIS CARD

Application ID Number: 2-1161

[Redacted]

Department: Building Status: Approved with Conditions Reviewer: Tommy Munson

Approval Date: 10/17/2002

Comments:

Given On Date: 10/17/2002

OK to Issue Permit Name: Tommy Munson Date: 10/17/2002 Date 2: [Redacted]

Conditions Section:

The treads of the stairs are required to be a minimum net of 10" measured nosing to nosing. They must have a nosing between 3/4" and 1-1/4". The risers may not exceed 7-3/4".

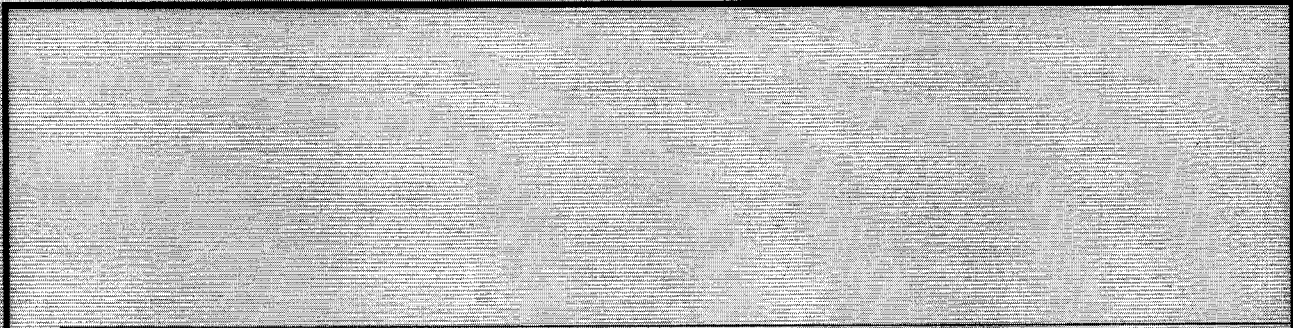

Create Date: 10/11/2002 By: god Update Date: 10/17/2002 By: tmm

Front - 25' Req.
Side - 20' Req.
Rear - 25' Req.

Lot cov - 20%

02-1161

All Purpose Building Permit Application

If you or the property owner owes real estate or personal property taxes or user charges on any property within the City, payment arrangements must be made before permits of any kind are accepted.

Location/Address of Construction: 102 Adams St ^{lot Welch} ST - PEAKS ISLAND		
Total Square Footage of Proposed Structure 120 SQ FT	Square Footage of Lot 36,000 sq ft	
Tax Assessor's Chart, Block & Lot Chart# 84 Block# L Lot# 001	Owner: James ROBERT LAUSIER	Telephone: 766-5157
Lessee/Buyer's Name (If Applicable) N/A	Applicant name, address & telephone: James Robert Lausier 40 ADAMS ST 766-5157 Peaks Island, Me.	Cost Of Work: \$ 2,000 ⁰⁰ ^{Labor} ^{material} Fee: \$ 37.00
Current use: <u>S/P</u>		
If the location is currently vacant, what was prior use: <u>N/A</u>		
Approximately how long has it been vacant: <u>N/A</u>		
Proposed use: <u>DECK attached to house</u>		
Project description: <u>10' x 10'</u>		
Contractor's name, address & telephone: <u>Brad Burkholder Island Ave, Peaks Island 766-2428</u>		
Who should we contact when the permit is ready: <u>James LAUSIER</u>		
Mailing address: <u>40 Adams ST Peaks Island Me 04108</u>		
We will contact you by phone when the permit is ready. You must come in and pick up the permit and review the requirements before starting any work, with a Plan Reviewer. A stop work order will be issued and a \$100.00 fee if any work starts before the permit is picked up. PHONE: <u>766-5157 or 233-5383</u>		

IF THE REQUIRED INFORMATION IS NOT INCLUDED IN THE SUBMISSIONS THE PERMIT WILL BE AUTOMATICALLY DENIED AT THE DISCRETION OF THE BUILDING/PLANNING DEPARTMENT, WE MAY REQUIRE ADDITIONAL INFORMATION IN ORDER TO APPROVE THIS PERMIT.

I hereby certify that I am the Owner of record of the named property, or that the owner of record authorizes the proposed work and that I have been authorized by the owner to make this application as his/her authorized agent. I agree to conform to all applicable laws of this jurisdiction. In addition, if a permit for work described in this application is issued, I certify that the Code Official's authorized representative shall have the authority to enter all areas covered by this permit at any reasonable hour to enforce the provisions of the codes applicable to this permit.

Signature of applicant: <u>James Robert Lausier</u>	Date: <u>9-27-02</u>
---	----------------------

This is NOT a permit, you may not commence ANY work until the permit is issued. If you are in a Historic District you may be subject to additional permitting and fees with the Planning Department on the 4th floor of City Hall

1R-2

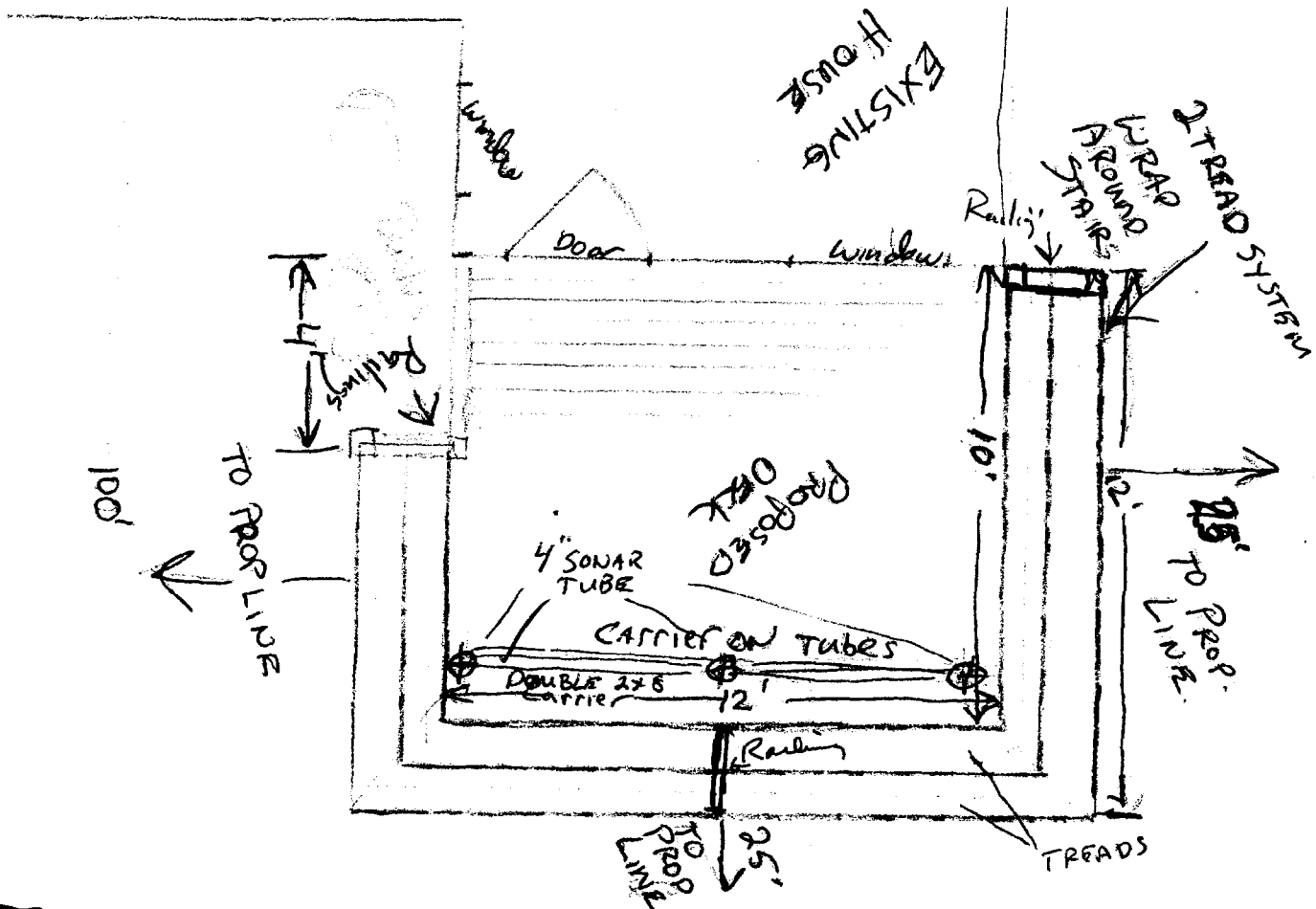

Jim Laugier
Adams St
Peaks Island

DECK PROPOSAL

- ✓ 10' x 2" x 8" PT JOISTS 16" OC
- ✓ ANCHORED TO LEOGER AT HOUSE
- ✓ Carried at 9' FROM HOUSE
- ✓ w/ Double 2' x 8" ON ~~1"~~ 4" SONAR
- ✓ Tubes 6' space outside & 4' deep.
- ✓ Cedar top & treads

- ✓ Guard rail 36"
- ✓ Height of railing: 34"
- ✓ Span of railing: 44"
- ✓ Ballusters spacing: 3 1/2"

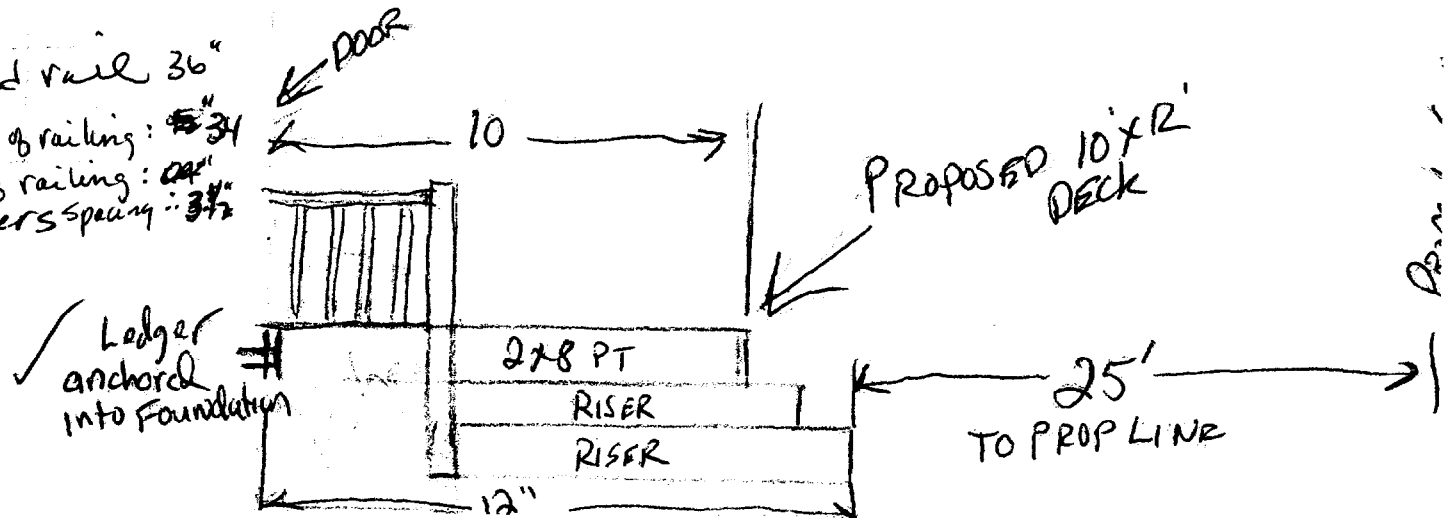

✓ Ledger anchored into Foundation

ADAMS STREET 100' Side

WELCH STREET 200'

Back

PAPER ROAD 250'

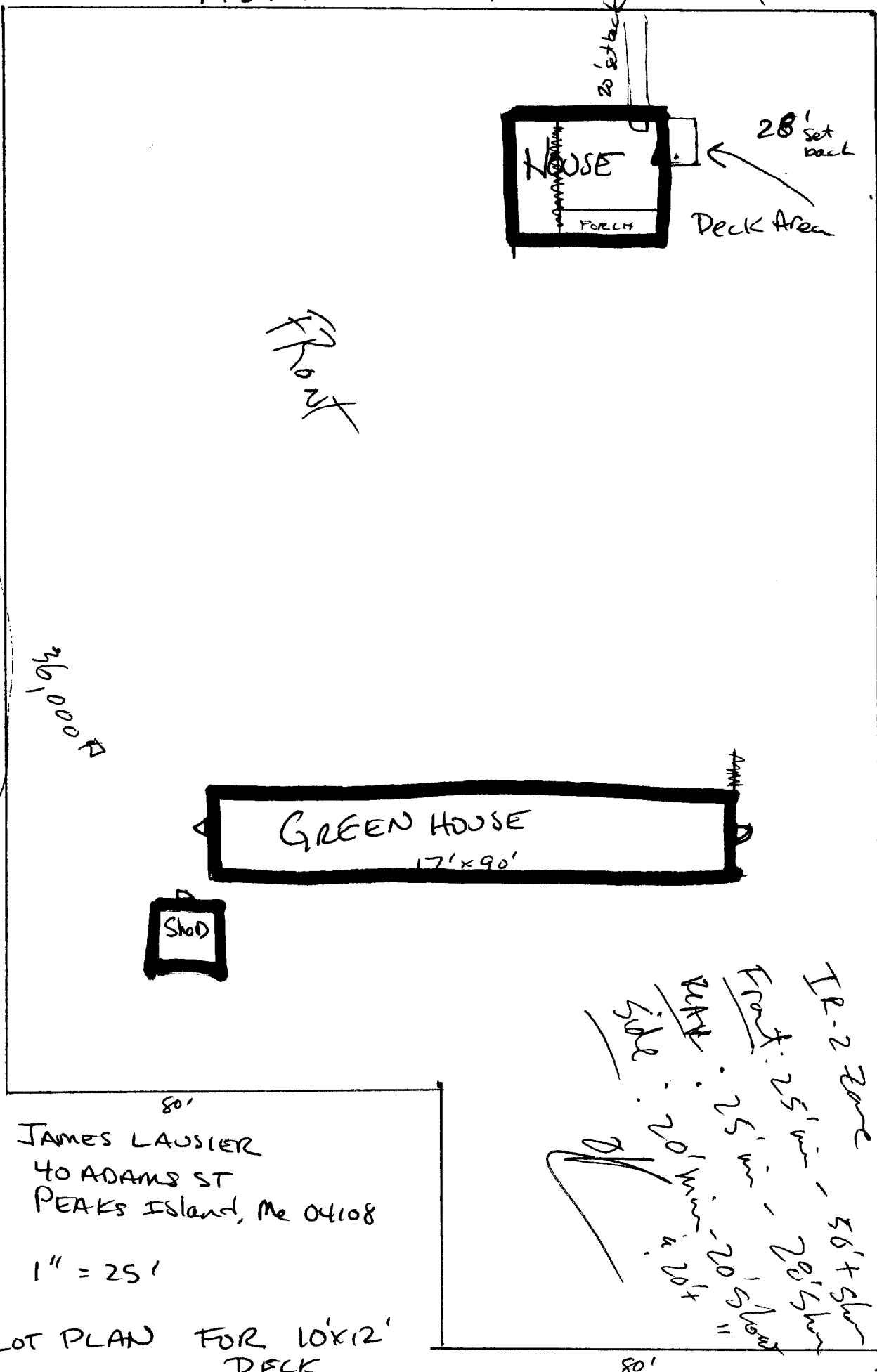

26,000 sq ft

GREEN HOUSE 17' x 90'

Shed

IR-2 zone 56' x 56'

FRONT: 25' min - 20' 1/2 min

BACK: 25' min - 20' 1/2 min

SIDE: 20' min - 20' 1/2 min

80'

JAMES LAUSIER
40 ADAMS ST
PEAKS ISLAND, ME 04108

1" = 25'

PLOT PLAN FOR 10' x 12' DECK

BIG FISH GRILL AREA