

- COVER - FAX - COVER -

DATE:
02/17/12

TO: MARGE SCHMUCKAL

FAX #: (207) 874-8716

FROM: MARY JO CASHMAN

FAX #: (207) 829-9144

PGS.(INCLU. COVER): 4

MESSAGE:

MARGE - HERE IS THE PLANTING PLAN REQUIRED BY YOU FOR THE FINAL APPROVAL/PERMISSION TO REMOVE TWO (2) TREES AT OUR HOME ON PEAKS ISLAND. I AM ENCLOSEING TWO COPIES: ONE FOR YOU AND ONE FOR JEFF TARLING. HOPE TO HEAR FROM YOU SOON!

Mary Jo Cashman

Chadwick Oliver
30 Bancroft Street
Portland, ME 04102
(207) 831-1645
e-mail: ChadwickOliver@hotmail.com

February 12, 2012

Mary Jo Cashman
8 Farms Edge Way
Cumberland, ME 04021

23 Seashore, PI
84-E-010
IR-2 Zone

Re: Peaks Cottage Replanting Schedule

Dear Mary Jo,

Per your request, I have prepared a replanting schedule for submission to Marge Schmuckal, Zoning Administrator, and Jeff Tarling, City Arborist. This should satisfy the condition of planting of bayberry shrubs for removal of spruce and silver maple at the side of your cottage.

Enclosed are copies for Marge, Jeff and you. Also is an invoice for my services as a licensed landscape architect.

Let me know if you need further help with coordinating with Marge and Jeff and if I can help with coordinating the removal of the two trees and planting the bayberrys.

Sincerely,



J. Chadwick Oliver, Jr.
Landscape Architect

Enclosures

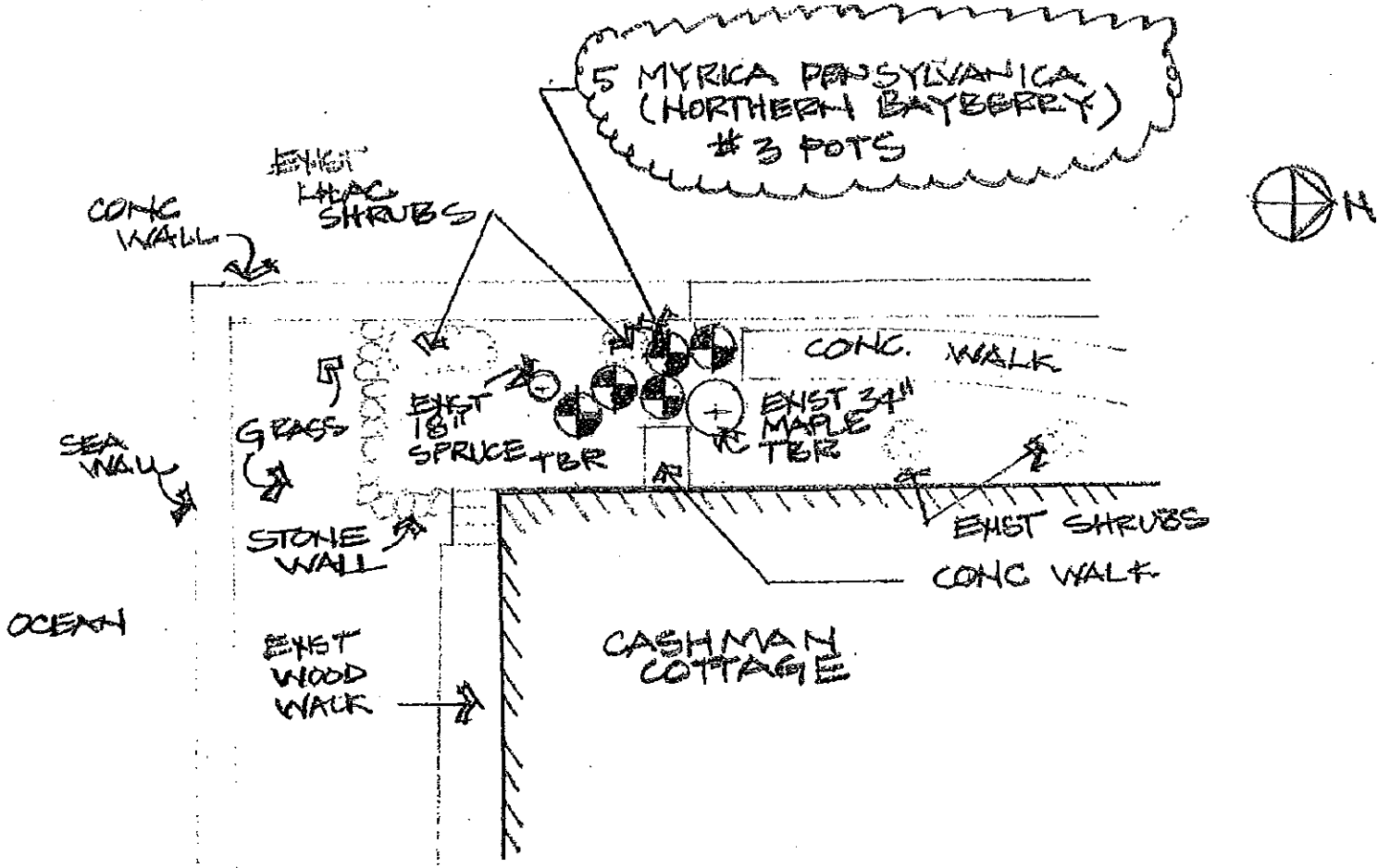

REPLANTING SCHEDULE
SCALE 1" = 10'-0"

JOHN & MARY JO CASHMAN
23 SEASHORE AVENUE
PEAKS ISLAND, MAINE

DESIGN by CHADWICK OLIVER, L.A.
DATE 2.13.12

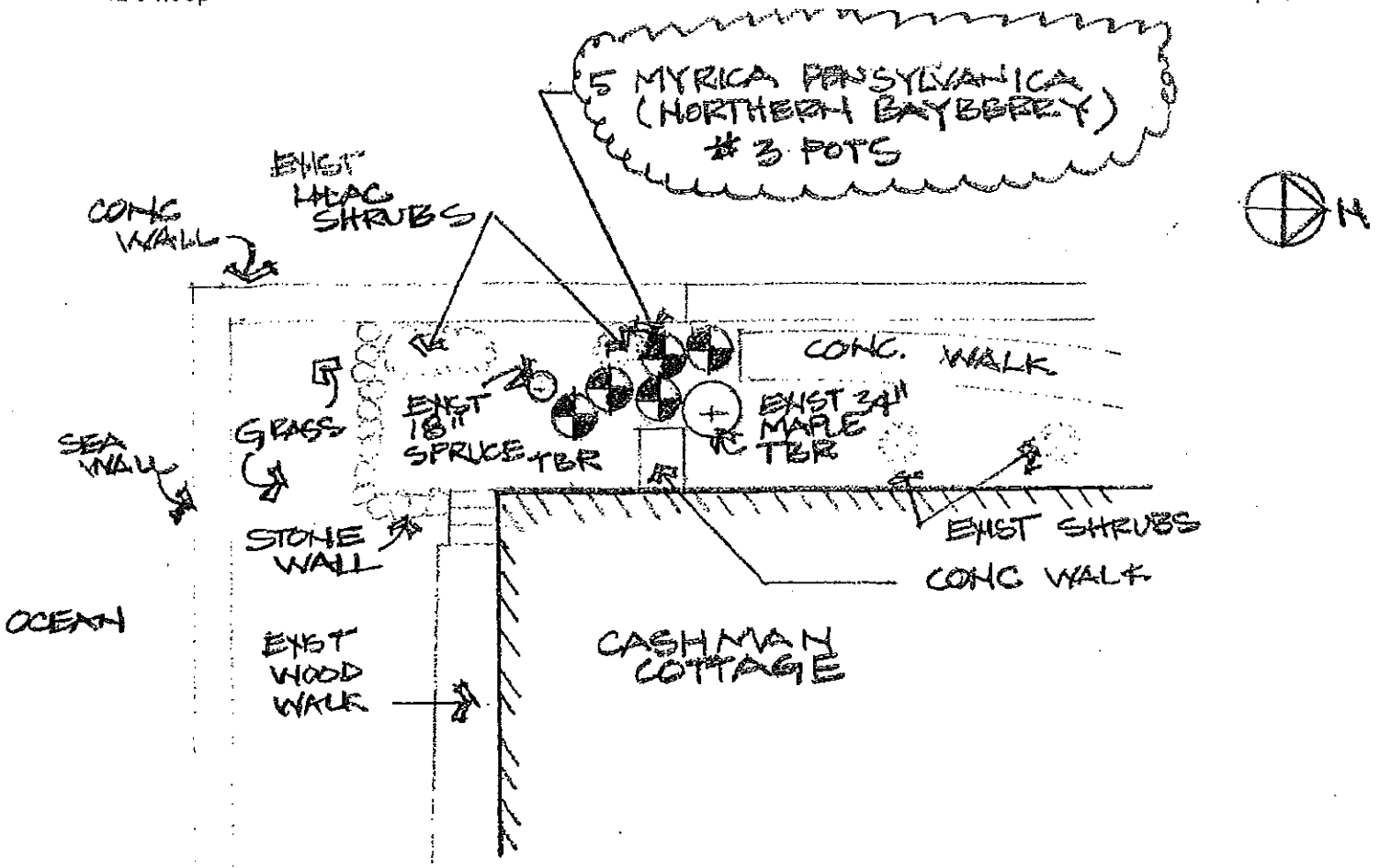

REPLANTING SCHEDULE

SCALE 1/2" = 10' 0"

JOHN & MARY JO CASHMAN
23 SEASHORE AVENUE
PEAKS ISLAND, MAINE

DESIGN by CHADWICK OLIVER, L.A.
DATE 2.13.12