

FIRE & CARBON MONOXIDE SYSTEMS (IRC 2009)
 RS13.2.1 AUTOMATIC RESIDENTIAL FIRE SPRINKLER SYSTEMS SHALL BE DESIGNED AND INSTALLED IN ACCORDANCE WITH SECTION P2404 OR NFPA 13D
 RS14 SMOKE ALARMS ALL SMOKE ALARMS SHALL BE LISTED IN ACCORDANCE WITH UL217 & INSTALLED IN ACCORDANCE WITH IRC 2009 & NFPA 72
 RS15 CARBON MONOXIDE ALARMS SHALL BE INSTALLED OUTSIDE OF EACH SEPARATE SLEEPING AREA IN THE IMMEDIATE VICINITY OF THE BEDROOMS, INSTALLED & LISTED AS COMPLYING W/ UL 2084
HVAC SYSTEMS
 TO BE BUILT IN ACCORDANCE WITH IECC 2009 SECTION 403
ELECTRICAL POWER AND LIGHTING SYSTEMS
 TO BE BUILT IN ACCORDANCE WITH IECC 2009 SECTION 404

KB A
kevin browne ARCHITECTURE
 207 - 847 - 3499
 kevin@kevinbrowne.com
 architecture.com
 7 breezy hill lane
 falmouth, me 04105

REVISIONS:
 4-15-14 ISSUE FOR PERMIT
 6-16-14 ISSUE PER REVISION CLOUDS

CONSULTANTS:

BEAULIEU RESIDENCE
 ADDRESS: LOT #61
 GREAT DIAMOND ISLAND, ME
 CLIENT: RON & LORI BEAULIEU

BASEMENT FLOOR PLAN
 DATE: 6/19/2014
 DRAWN: KWIS
 PROJECT NO.: 2013-14
 SCALE:

A1.1

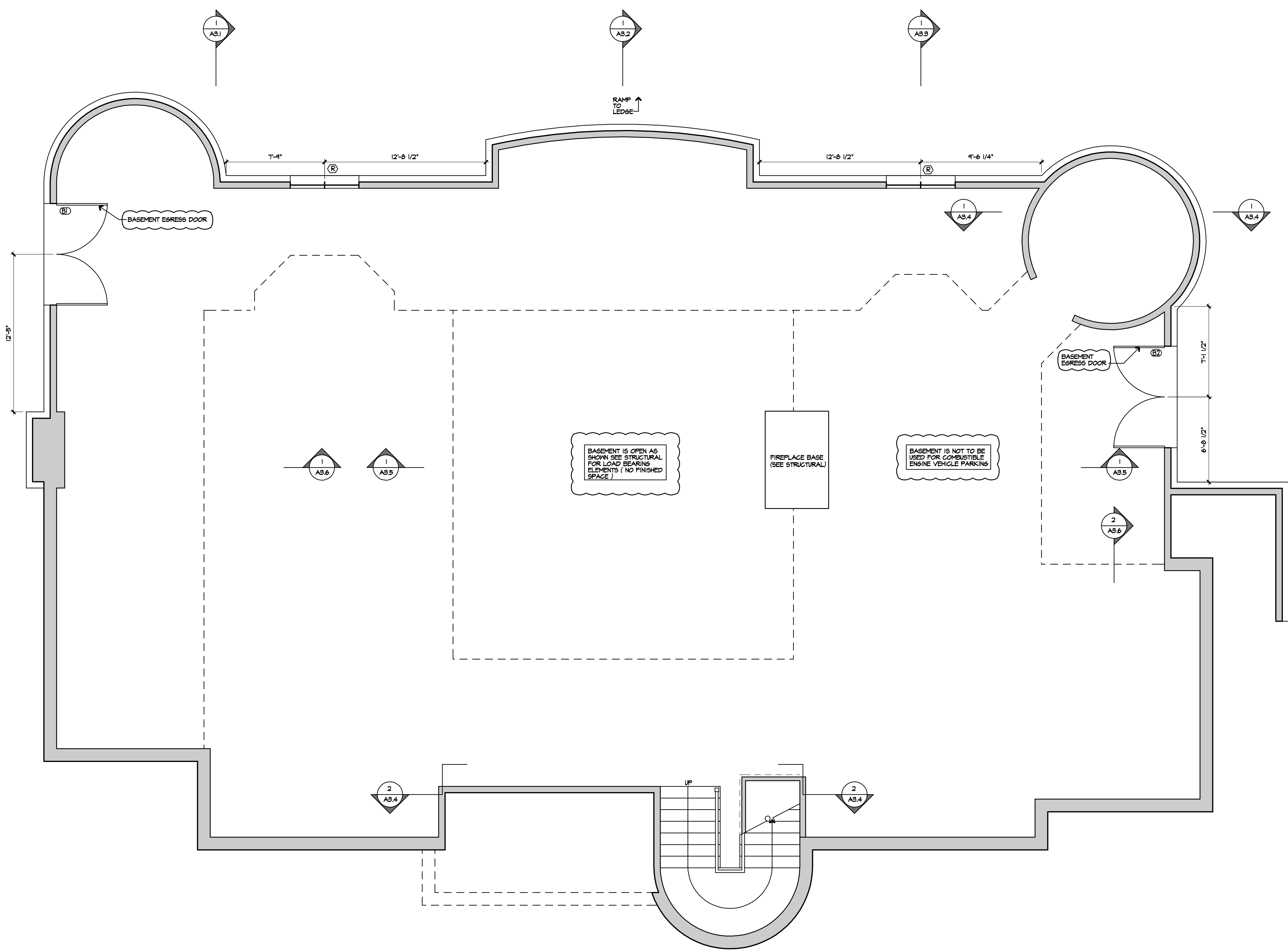

CONTRACTOR SHALL MEASURE AND VERIFY ALL DIMENSIONS AT THE WORK.
 THIS DRAWING IS A PART OF A FULL SET OF DRAWINGS COMPRISING THE CONTRACT DOCUMENTS FOR THE WORK OF THIS PROJECT. THE ARCHITECTURE ACCEPTS NO RESPONSIBILITY FOR THE CONTRACTOR'S ERRORS OR OMISSIONS IF EACH TRADE DOES NOT HAVE THE FULL SET OF DRAWINGS AND SPECIFICATIONS.

COPYRIGHT 2014 ©
 THE MATERIAL CONTAINED IN THESE DRAWINGS AND THE DESIGN THEY ARE INTENDED TO CONVEY ARE THE EXCLUSIVE PROPERTY OF KEVIN BROWNE ARCHITECTURE LLC. POSSESSION AND USE HEREOF IS GRANTED ONLY CONFIDENTIALLY IN CONNECTION WITH CONSTRUCTION OF THE BUILDING SPECIFIC HEREIN AS AUTHORIZED BY KEVIN BROWNE ARCHITECTURE LLC. THE RECIPIENT AGREES TO ABIDE BY THESE RESTRICTIONS. ANY USE, REPRODUCTION OR DISCLOSURE OF ANY INFORMATION IN WHOLE OR IN PART, CONTAINED HEREIN, WITHOUT WRITTEN PERMISSION OF KEVIN BROWNE ARCHITECTURE LLC, IS EXPRESSLY PROHIBITED.

1 BASEMENT FLOOR PLAN
 A1.1 1/4" = 1'-0"