

T.O. BLD
EL. 132'-1 3/4"
T.O. DORMER
EL. 131'-4 3/4"

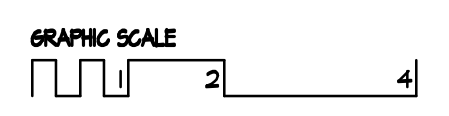

CONTRACTOR SHALL MEASURE AND VERIFY ALL DIMENSIONS AT THE WORK. THIS DRAWING IS A PART OF A FULL SET OF DRAWINGS COMPRISING THE CONTRACT DOCUMENTS FOR THE WORK OF THIS PROJECT. THE ARCHITECT/OWNER ACCEPTS NO RESPONSIBILITY FOR THE CONTRACTOR'S ERRORS OR OMISSIONS IF EACH TRADE DOES NOT HAVE THE FULL SET OF DRAWINGS AND SPECIFICATIONS.
COPYRIGHT 2014 ©
THE MATERIAL CONTAINED IN THESE DRAWINGS AND THE DESIGN THEY ARE INTENDED TO CONVEY ARE THE EXCLUSIVE PROPERTY OF KEVIN BROWNE ARCHITECTURE. CONFIDENTIALITY IN CONNECTION WITH CONSTRUCTION OF THE BUILDING DEPICTED HEREIN IS AUTHORIZED BY KEVIN BROWNE ARCHITECTURE. THE RECIPIENT AGREES TO ABIDE BY THESE RESTRICTIONS. ANY USE, REPRODUCTION OR DISCLOSURE OF ANY INFORMATION, IN WHOLE OR IN PART, CONTAINED HEREIN, WITHOUT WRITTEN PERMISSION OF KEVIN BROWNE ARCHITECTURE, IS EXPRESSLY PROHIBITED.

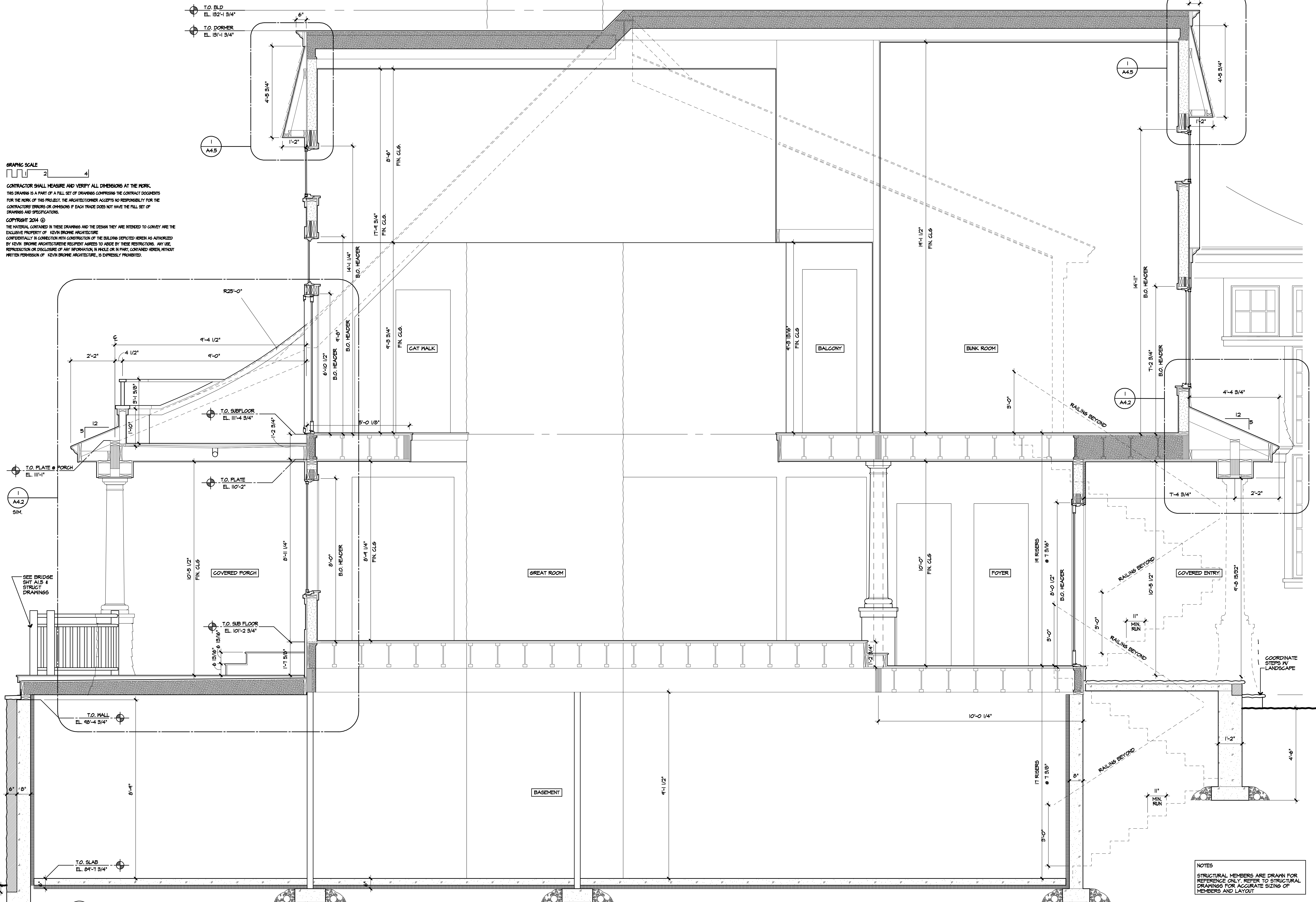

NOTES
STRUCTURAL MEMBERS ARE DRAWN FOR REFERENCE ONLY. REFER TO STRUCTURAL DRAWINGS FOR ACCURATE SIZING OF MEMBERS AND LAYOUT

1 CROSS-SECTION
A3.2 1/2" = 1'-0"

KBA kevin browne ARCHITECTURE
207.847.3499
7 breezy hill lane
kevin@kevinbrowne.com
fallmouth, me 04105 architecture.com

REVISIONS:
4-15-14: ISSUE FOR PERMIT

CONSULTANTS:

BEAULIEU RESIDENCE
CLIENT: RON & LORI BEAULIEU
ADDRESS: LOT #61
GREAT DIAMOND ISLAND, ME

SECTIONS
DATE: 4/15/2014 DRAWN: KWB SCALE: 1/2" = 1'-0"
PROJECT NO.: 2013-14

A3.2