

HYDRAULIC DATA:			
SECOND FLOOR PENDENTS			
BASIS OF DESIGN NFPA 13			
DENSITY	AREA OF COVERAGE		
1	840		
	TOTAL THREHEAD	TEMP	
	4	1/2"	155
	SPRINKLERS		
	SYSTEM DEMAND AT PUMP OUTLET:		
	PRESSURE	FLOW	HOSE
	69.082	187.630	100
	SAFETY MARGIN:	5.2766	
	OCCUPANCY:	RESIDENTIAL BALCONIES	

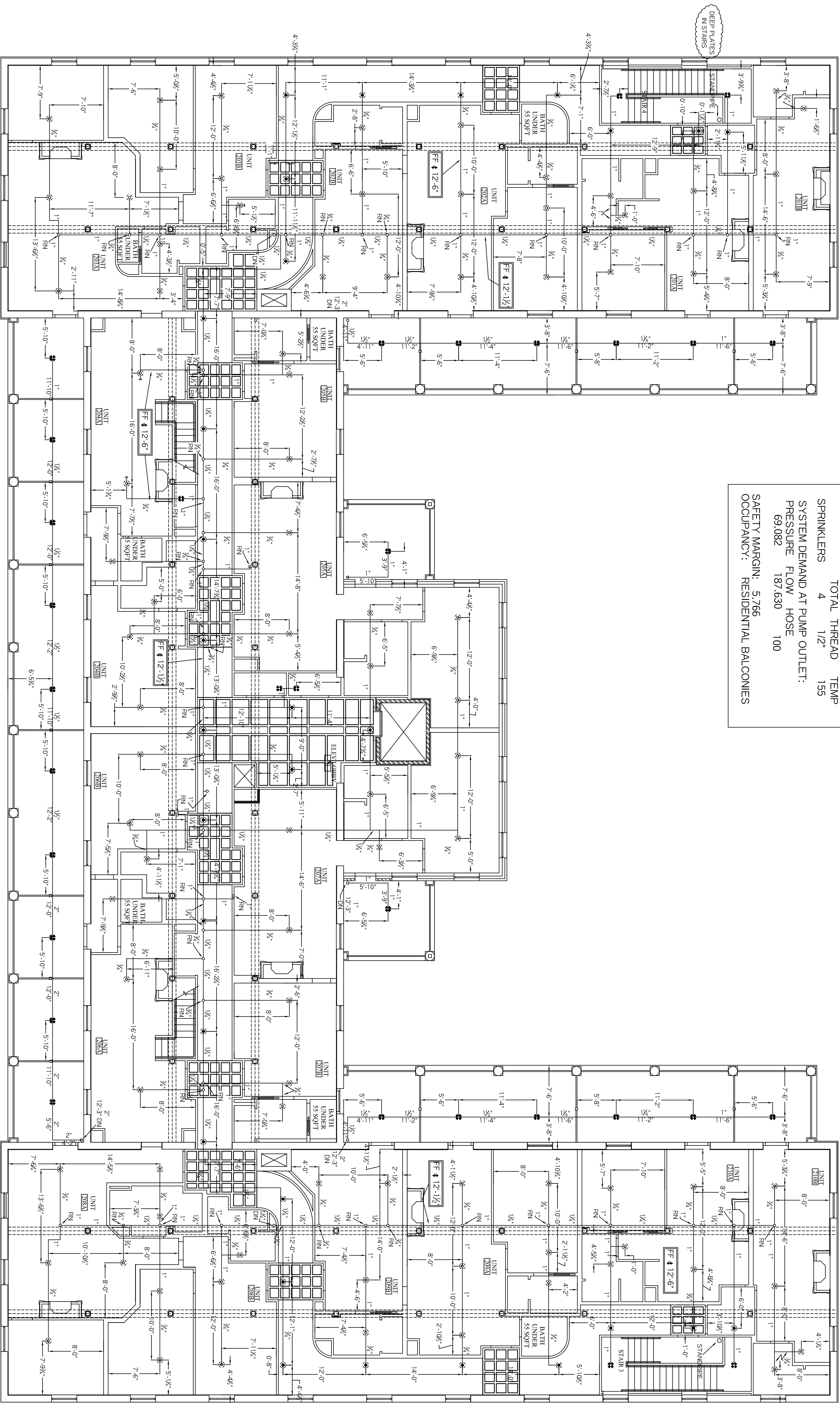

**LEGEND**

- HANGER
- RISE OR DROP NIPPLE
- VERTICAL COUPLING
- FF k=XX FIN FLR TO CENTERLINE OF PIPE
- C k=XX CEILING TO CENTERLINE OF PIPE
- TJ k=TOP OF JOIST TO CENTERLINE OF PIPE
- BJ k=BOTTOM OF JOIST TO CENTERLINE OF PIPE
- BB k=BOTTOM OF BEAM TO CENTERLINE OF PIPE
- ELEV k=CEILING ELEVATION OF CENTERLINE OF PIPE

**GENERAL NOTES**

- ALL DIMENSIONS ARE CENTER TO CENTER U/N
- ALL THREADED PIPE TO BE SCH. 40 BLACK STEEL
- ALL SCREWED FITTINGS TO BE STD. WT. C.I. BLACK U/N
- ALL GROOVED PIPE TO BE SCH. 10 BLACK STEEL
- ALL OTHER PIPING TO BE CPVC PLASTIC
- ALL OTHER FITTINGS TO BE CPVC PLASTIC

**SYSTEM DESIGN**

A WET PIPE SYSTEM OF AUTOMATIC SPRINKLERS TO BE DESIGNED AND INSTALLED PER NFPA 13R  
 ALL SPRINKLERS TO BE BASED ON LIGHT HAZARD  
 MANUAL WET CLASS I STANDPIPE DESIGNED AND INSTALLED PER NFPA 14

- 31 VIKING VK302  
 155F WHITE OR RECESSED PENDENTS  
 1/2"x1/2" K=5.6
- 32 VIKING VK468  
 155F RESIDENTIAL RECESSED PENDENTS  
 1/2"x1/2" K=4.9
- 90 VIKING VK456  
 155F RESIDENTIAL CONCEALED PENDENTS  
 1/2"x1/2" K=4.9

**RESIDENTIAL FIRE PROTECTION, LLC**

PHONE (607) 946-3473 FAX (607) 946-3474

64 DAGGETT HILL ROAD GREENE, MAINE 04236

REVISION NUMBER	DATE	SUBMITTED BY	TITLE
1	01-07-12-13	DR	INN AT DIAMOND COVE
2	02-16-13	DR	MCKINLEY COURT
3	07-17-13	DR	GREAT DIAMOND ISLAND
4		DR	PORTLAND, MAINE

STANLEY, J. CAMIC  
 NICET III - #78855

SCALE: 1/8" = 1'-0" U/N  
 SHEET NO. 3 OF 4  
 C13015