

HYDRAULIC DATA:  
 SECOND FLOOR BALCONIES  
 BASIS OF DESIGN NFPA 13  
 DENSITY AREA OF COVERAGE  
 .1 1020  
 TOTAL THREAD TEMP  
 SPRINKLERS 6 1/2" 155  
 SYSTEM DEMAND AT PUMP OUTLET:  
 PRESSURE FLOW HOSE  
 66.230 212.646 100  
 SAFETY MARGIN: 7.015  
 OCCUPANCY: RESIDENTIAL BALCONIES

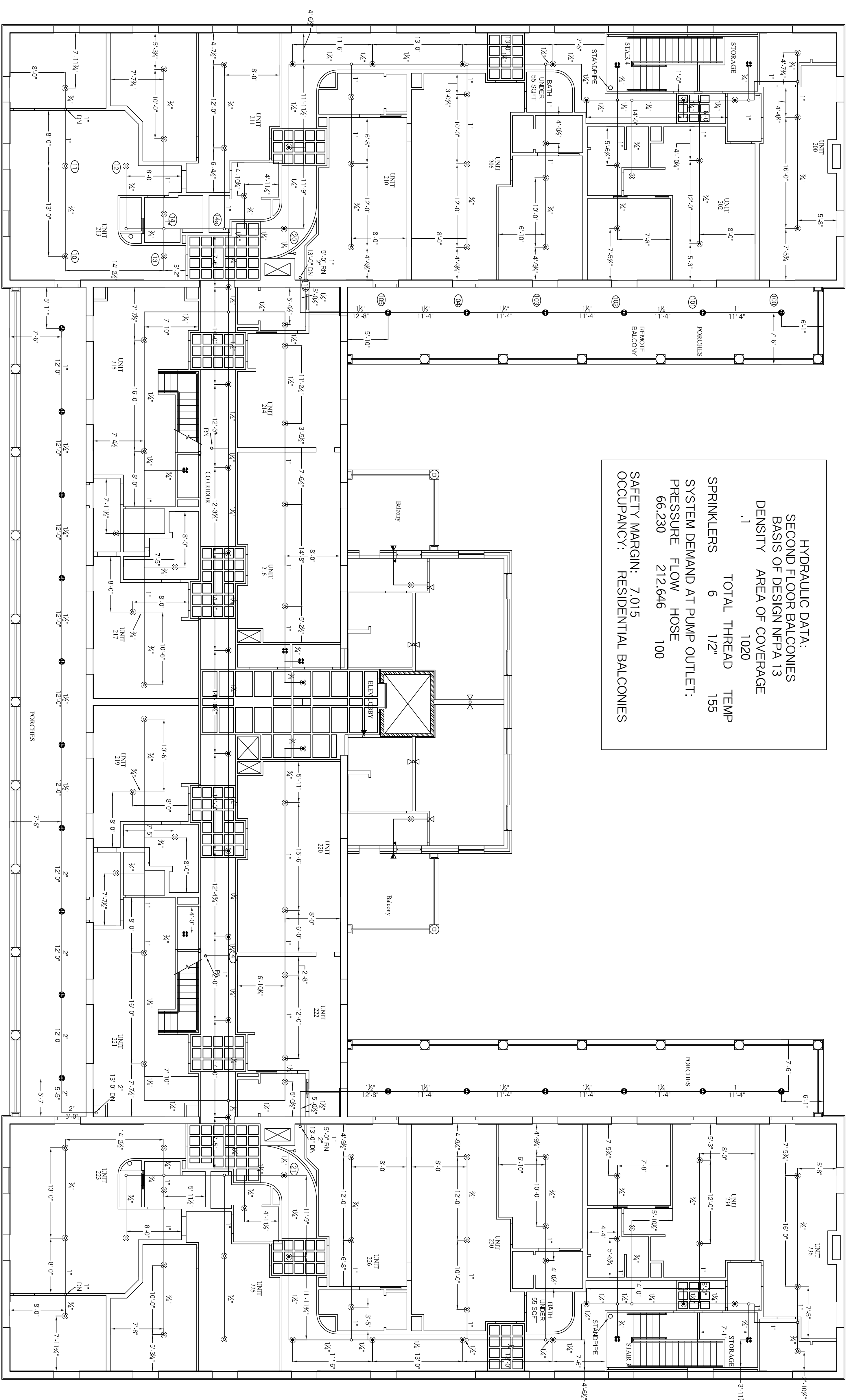

## SECOND FLOOR

- 8 WIKING VK386  
RESIDENTIAL RECESSED SIDEWALLS  
1/2" X 1/2" K=5.6
- 2 WIKING VK178  
OR DRY WHITE SIDEWALL  
1/2" X 1/2" K=5.6
- 22 WIKING VK176  
WHITE OR DRY PENDANTS  
1/2" X 1/2" K=5.6
- 8 WIKING VK302  
WHITE OR RECESSED PENDANTS  
1/2" X 1/2" K=5.6
- 30 WIKING VK448  
RESIDENTIAL RECESSED PENDANTS  
1/2" X 1/2" K=4.9
- 80 WIKING VK456  
RESIDENTIAL CONCEALED PENDANTS  
1/2" X 1/2" K=4.9

- LEGEND**
- ▷ 155T RES 1/2" WHITE SIDEWALL
  - 155T OR 1/2 BRASS PENDENT
  - 155T RES 1/2 WHITE RECESSED PENDENT
  - ⊗ 155T RES 1/2 WHITE RECESSED PENDENT
  - ⊕ 155T OR 1/2 WHITE RECESSED PENDENT
  - HANGER
  - RISE OR DROP NIPPLE
  - VICTAULIC COUPLING

- GENERAL NOTES**
- FF K=XX FIN FLR TO CENTERLINE OF PIPE
  - C K=XX CEILING TO CENTERLINE OF PIPE
  - TJ K=TOP OF JOIST TO CENTERLINE OF PIPE
  - BU K=BOTTOM OF JOIST TO CENTERLINE OF PIPE
  - BB K=BOTTOM OF BEAM TO CENTERLINE OF PIPE
  - ELEV K=OVL ELEVATION OF CENTERLINE OF PIPE

- GENERAL NOTES**
- ALL DIMENSIONS ARE CENTER TO CENTER U/N
  - ALL THREADED PIPE TO BE SCH. 40 BLACK STEEL
  - ALL GROOVED FITTINGS TO BE STD. WT. C.I. BLACK U/N
  - ALL GROOVED PIPE TO BE SCH. 10 BLACK STEEL
  - ALL OTHER PIPING TO BE CPVC PLASTIC
  - ALL OTHER FITTINGS TO BE CPVC PLASTIC
  - DRY SYSTEM CAPACITY IS 343 GALLONS

### SYSTEM DESIGN

A WET AND DRY PIPE SYSTEM OF AUTOMATIC SPRINKLERS TO BE  
 DESIGNED AND INSTALLED PER NFPA 13R  
 ALL SPRINKLERS TO BE BASED ON LIGHT HAZARD  
 MANUAL WET CLASS I STANDPIPE DESIGNED AND INSTALLED PER NFPA 14

REVISION NUMBER	DATE	SURVEYED BY	TITLE
	02-20-14	JAL	INN AT DIAMOND COVE
	07-21-14	DR	MCKINLEY COURT
	07-14-14	SD	GREAT DIAMOND ISLAND
			PORTLAND, MAINE

RESIDENTIAL FIRE PROTECTION, LLC  
 PHONE (607) 946-3473 FAX (607) 946-3474  
 64 DAGGETT HILL ROAD GREENE, MAINE 04236