

HYDRAULIC DATA:			
LOBBY ENTRANCE			
BASIS OF DESIGN NFPA 13			
DENSITY	AREA OF COVERAGE	950	
.1	TOTAL THREAD	TEMP	
	SPRINKLERS	10	1/2"
	SYSTEM DEMAND AT PUMP OUTLET:	155	
	PRESSURE FLOW HOSE		
	59.889	261.835	100
SAFETY MARGIN: 9.714			
OCCUPANCY: HOTEL LOBBY			

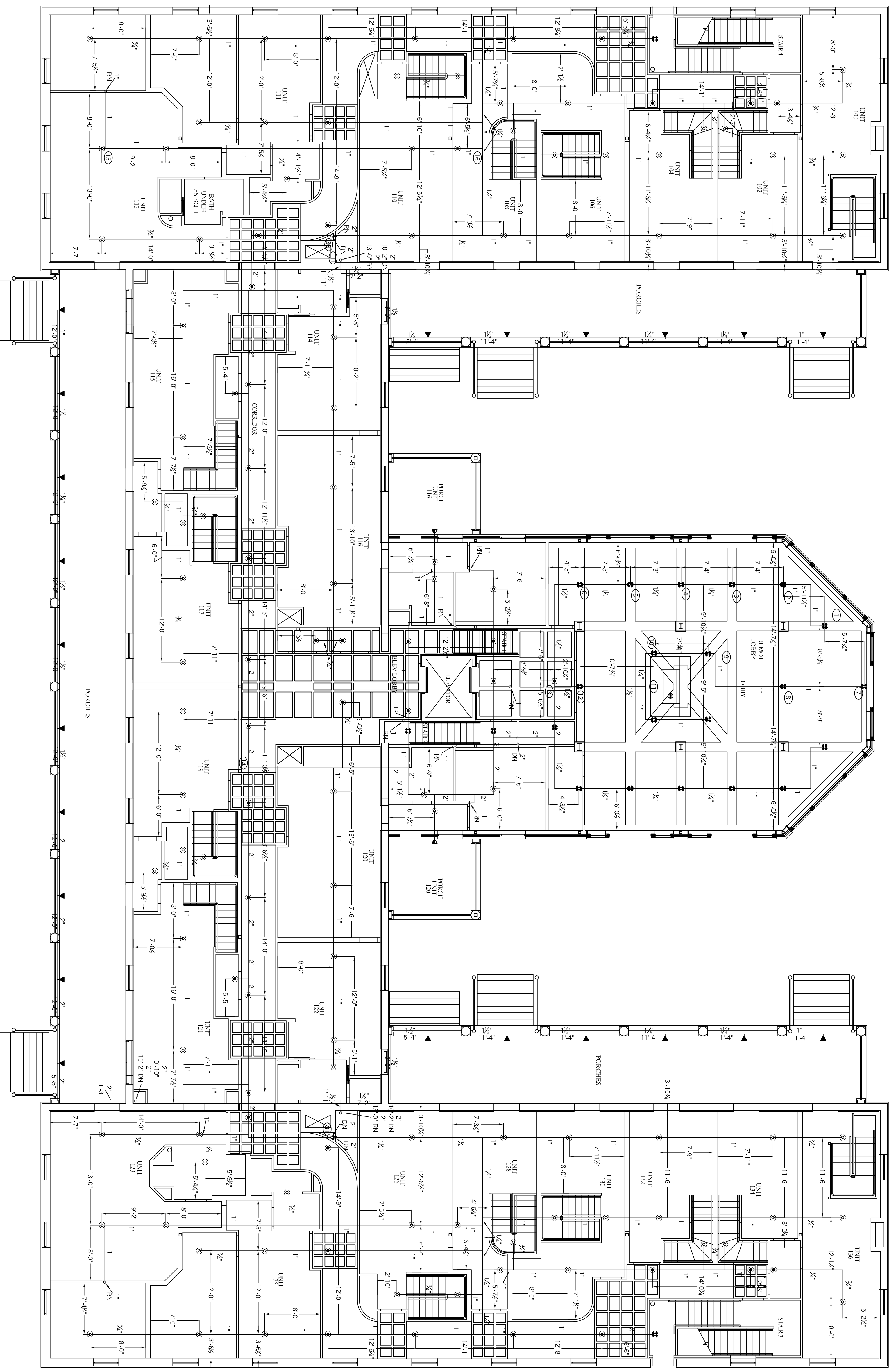

FIRST FLOOR

- LEGEND
- ▷ 155F RES 1/2" WHITE SIDEWALL
  - 155F OR 1/2 BRASS PENDENT
  - 155F RES 1/2 WHITE RECESSED PENDENT
  - ⊗ 155F OR 1/2 WHITE RECESSED PENDENT
  - / HANGER
  - RISE OR DROP NIPPLE
  - VCTAULIC COUPLING
  - FF k=XX FIN FLR TO CENTERLINE OF PIPE
  - C k=XX CEILING TO CENTERLINE OF PIPE
  - TU k=TOP OF JOIST TO CENTERLINE OF PIPE
  - BU k=BOTTOM OF JOIST TO CENTERLINE OF PIPE
  - BB k=BOTTOM OF BEAM TO CENTERLINE OF PIPE
  - ELEV k=OVL ELEVATION OF CENTERLINE OF PIPE

- GENERAL NOTES
- ALL DIMENSIONS ARE CENTER TO CENTER U/N
  - ALL THREADED PIPE TO BE SCH. 40 BLACK STEEL
  - ALL SCREWED FITTINGS TO BE STD. WT. C.I. BLACK U/N
  - ALL GROOVED PIPE TO BE SCH. 10 BLACK STEEL
  - ALL OTHER PIPING TO BE CPVC PLASTIC
  - ALL OTHER FITTINGS TO BE CPVC PLASTIC
  - DRY SYSTEM CAPACITY IS 343 GALLONS

- SYSTEM DESIGN
- 2 VIKING WK178
  - 135F OR DRY WHITE SIDEWALL
  - 1/2 X 1/2 K=5.6
  - 22 VIKING WK305
  - OR WHITE SIDEWALL
  - 1/2 X 1/2 K=5.6
  - 24 VIKING WK302
  - WHITE OR RECESSED PENDENTS
  - 1/2 X 1/2 K=5.6
  - 38 VIKING WK468
  - RESIDENTIAL RECESSED PENDENTS
  - 1/2 X 1/2 K=4.9
  - 94 VIKING WK456
  - RESIDENTIAL CONCEALED PENDENTS
  - 1/2 X 1/2 K=4.9

REVISION NUMBER	DATE	SUBMITTED BY	DATE	TITLE

RESIDENTIAL FIRE PROTECTION, LLC  
 PHONE (607) 946-3473 FAX (607) 946-3474  
 GREENE, MAINE 04236  
 64 DAGGETT HILL ROAD

A WET AND DRY PIPE SYSTEM OF AUTOMATIC SPRINKLERS TO BE DESIGNED AND INSTALLED PER NFPA 13R  
 ALL SPRINKLERS TO BE BASED ON LIGHT HAZARD MANUAL WET CLASS I STANDPIPE DESIGNED AND INSTALLED PER NFPA 14  
 INN AT DIAMOND COVE  
 MCKINLEY COURT  
 GREAT DIAMOND ISLAND  
 PORTLAND, MAINE  
 C14017