

PER IBC 2009

1208.2 MINIMUM CEILING HEIGHTS

EXCEPTION 2. IF ANY ROOM IN A BUILDING HAS A SLOPED CEILING, THE PRESCRIBED CEILING HEIGHT FOR THE ROOM IS REQUIRED IN ONE-HALF THE AREA THEREOF. ANY PORTION OF THE ROOM MEASURING LESS THAN 5 FEET FROM THE FINISHED FLOOR TO THE CEILING SHALL NOT BE INCLUDED IN ANY COMPUTATION OF THE MINIMUM AREA THEREOF.

PRESCRIBED CEILING HEIGHT FOR ROOM - 7'-6"

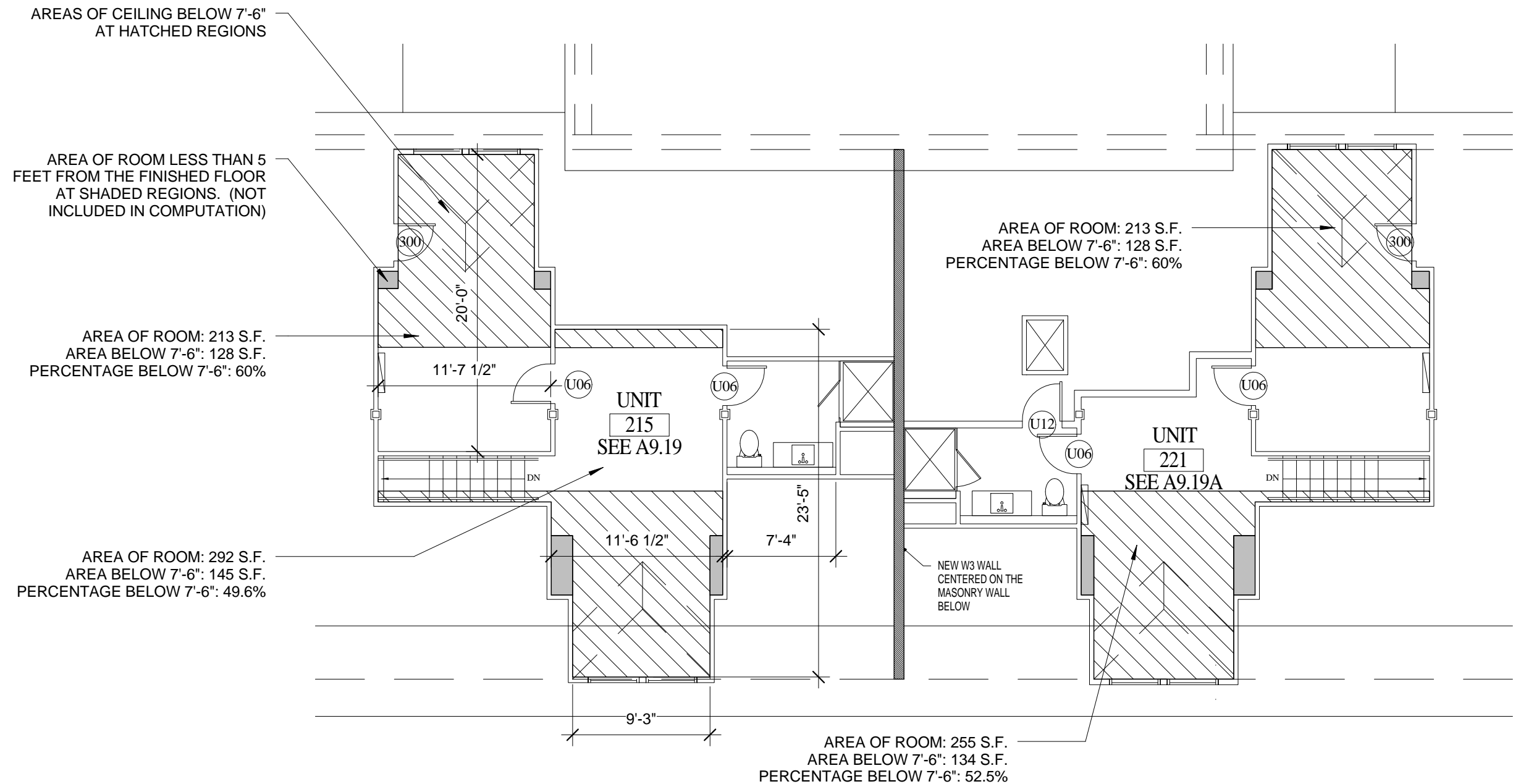

AREAS OF CEILING BELOW 7'-6" AT HATCHED REGIONS

AREA OF ROOM LESS THAN 5 FEET FROM THE FINISHED FLOOR AT SHADED REGIONS. (NOT INCLUDED IN COMPUTATION)

AREA OF ROOM: 213 S.F. AREA BELOW 7'-6": 128 S.F. PERCENTAGE BELOW 7'-6": 60%

AREA OF ROOM: 292 S.F. AREA BELOW 7'-6": 145 S.F. PERCENTAGE BELOW 7'-6": 49.6%

AREA OF ROOM: 213 S.F. AREA BELOW 7'-6": 128 S.F. PERCENTAGE BELOW 7'-6": 60%

AREA OF ROOM: 255 S.F. AREA BELOW 7'-6": 134 S.F. PERCENTAGE BELOW 7'-6": 52.5%

1 | ATTIC PLAN

1/8" = 1'-0"

Architect: **ARCHETYPE** Architects
48 Union Wharf Portland, Maine 04101
(207) 772-6022 Fax (207) 772-4056

Date: 06 MAY 2015 Scale: 1/8" = 1'-0"
MINIMUM CEILING HEIGHT AT ATTIC

Project: **INN AT DIAMOND COVE**
MCKINLEY COURT
GREAT DIAMOND ISLAND, MAINE

SK-38