

LEGEND:

	GYP CEILING DIRECTLY ATTACHED TO ACOUSTIC ISOLATION CLIPS ON STRUCTURE
	SUSP. GYP CEILING ON AT 9'-6" A.F.F. (EXCEPT WHERE NOTED) (FIRE RATED GYP. CLNG. CONT. ABOVE AT STRUCTURE ON RESILIENT CHANNEL)
	SUSP. GYP CEILING AT 8'-0" A.F.F. (FIRE RATED GYP. CLNG. CONT. ABOVE AT STRUCTURE ON RESILIENT CHANNEL)
	SUSP. GYP CEILING AT 9'-10" A.F.F. (EXCEPT WHERE NOTED) WITH APPLIED 1x4 TRIM (FIRE RATED GYP. CLNG. CONT. ABOVE AT STRUCTURE)
	BEAD BOARD CEILING DIRECTLY ATTACHED TO STRUCTURE

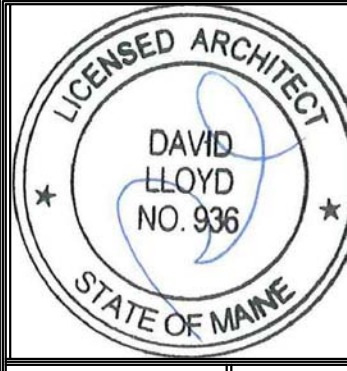

Prepared For:
The Inn at Diamond Cove, LLC.
 PO BOX 3572
 PORTLAND, ME 04101

Interior Designer:
truexcollins
 INTERIORS
 298 BATTERY STREET BURLINGTON, VERMONT 05401 USA
 Phone 802.658.2775 800.227.1076
 ARCHITECTURE | INTERIOR DESIGN | truexcollins.com

Architect:
ARCHETYPE
 architects
 48 Union Wharf Portland, Maine 04101
 (207) 772-6022 Fax (207) 772-4056

Project:
THE INN AT DIAMOND COVE, LLC
 MCKINLEY COURT
 GREAT DIAMOND ISLAND, MAINE

Revisions:
 Issued for Construction 03 Feb 14

Date: 03 Feb 2014
 Scale: 1/8" = 1'-0"
FIRST FLOOR REFLECTED CEILING PLAN

A6.01

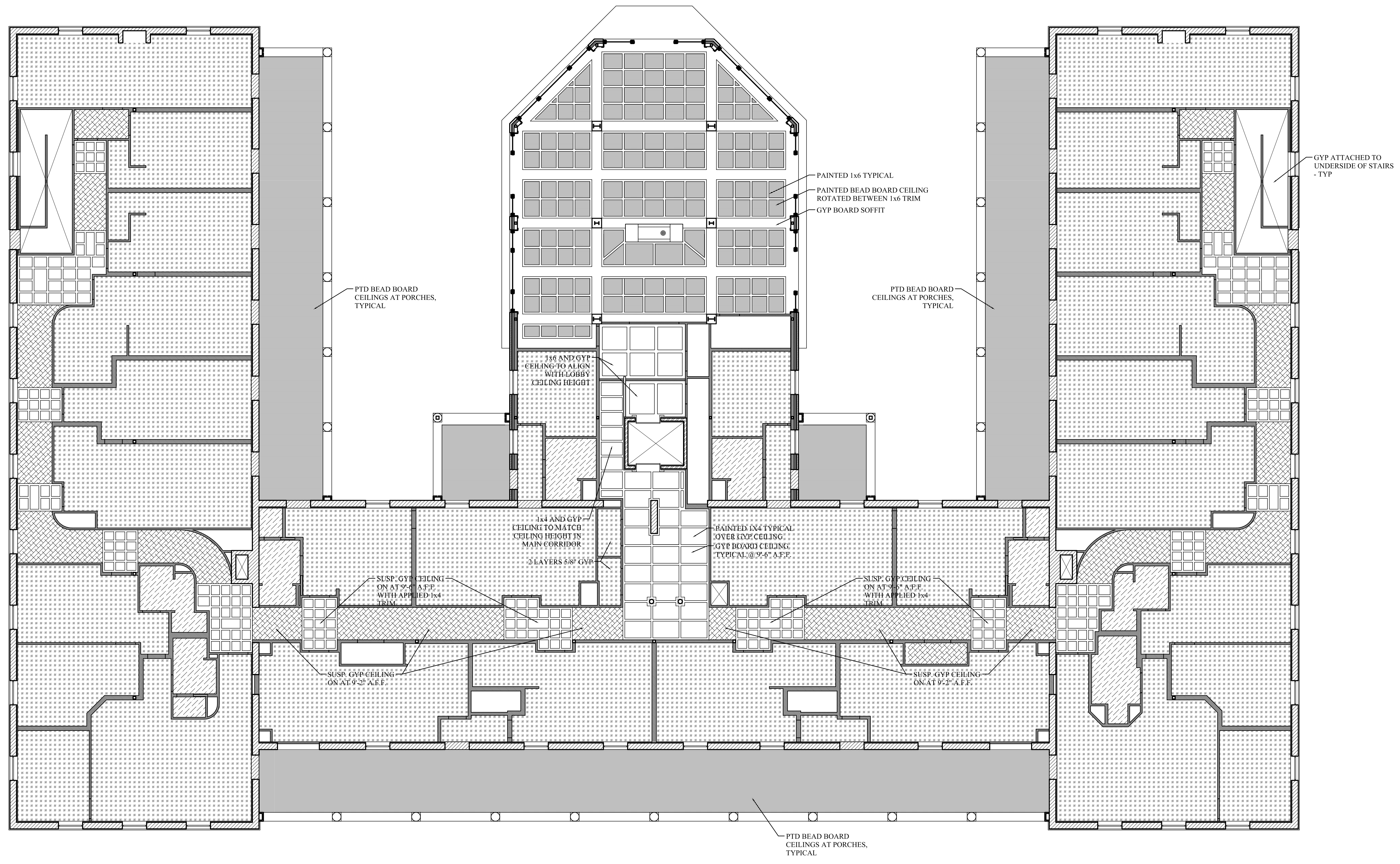

1 | FIRST FLOOR REFLECTED CEILING PLAN
 SCALE: 1/8"=1'-0"

