

STORM DRAIN STRUCTURE SCHEDULE				
STRUCTURE I.D.	RIM	SIZE	INV. IN / SIZE / FROM	INV. OUT / SIZE / TO
CB 1	99.5	15" NYLOPLAST	95.00 / 4"UD / BLDG. 96.50 / 4"UD / W.Q. FILTER 1	94.80 / 12" / CB 2
CB 2	98.9	15" NYLOPLAST	94.27 / 12" / CB 3 94.27 / 12" / CB 1 95.90 / 4"UD / BIO. RET. 2	94.17 / 12" / CB 6
CB 3	98.5	15" NYLOPLAST	95.00 / 4"UD / BIO. RET. 3	94.51 / 12" / CB 2
CB 4	98.5	15" NYLOPLAST	95.00 / 4"UD / BIO. RET. 4	94.60 / 12" / CB 3
CB 5	99.5	15" NYLOPLAST	95.00 / 4"UD / BLDG. 96.50 / 4"UD / W.Q. FILTER 2	94.80 / 12" / CB 6
CB 6	99.5	15" NYLOPLAST	93.58 / 12" / CB 2 94.40 / 12" / CB 4 94.27 / 12" / CB 5 96.50 / 4"UD / BIO. RET. 1	93.48 / 12" / OUTLET

STORM DRAIN PIPE SCHEDULE				
PIPE I.D.	PIPE MATERIAL	DIAMETER	LENGTH	SLOPE
SD 1	HDPE / PVC	12"	53'	0.0100
SD 2	HDPE / PVC	12"	24'	0.0100
SD 3	HDPE / PVC	12"	59'	0.0100
SD 4	HDPE / PVC	12"	20'	0.0100
SD 5	HDPE / PVC	12"	53'	0.0100
SD 6	HDPE / PVC	12"	108'	0.0137

**NOTES:**

- SEE SHEET C-6 FOR DETAILED GRADING NEAR THE BUILDING ADDITION.
- THE LOCATION OF THE EXISTING WATER MAIN DEPICTED NEAR THE PROPOSED BUILDING ADDITION IS APPROXIMATE. IT IS THE RESPONSIBILITY OF THE CONTRACTOR TO PROTECT THE WATER MAIN DURING CONSTRUCTION.

**LEGEND**

- CATCH BASIN SEDIMENT BARRIER
- RIPRAP
- SILTATION FENCE OR EROSION CONTROL MIX BERM SEDIMENT BARRIER
- SOIL FILTER

**GRAPHIC SCALE**

( IN FEET )  
1 inch = 20 ft.

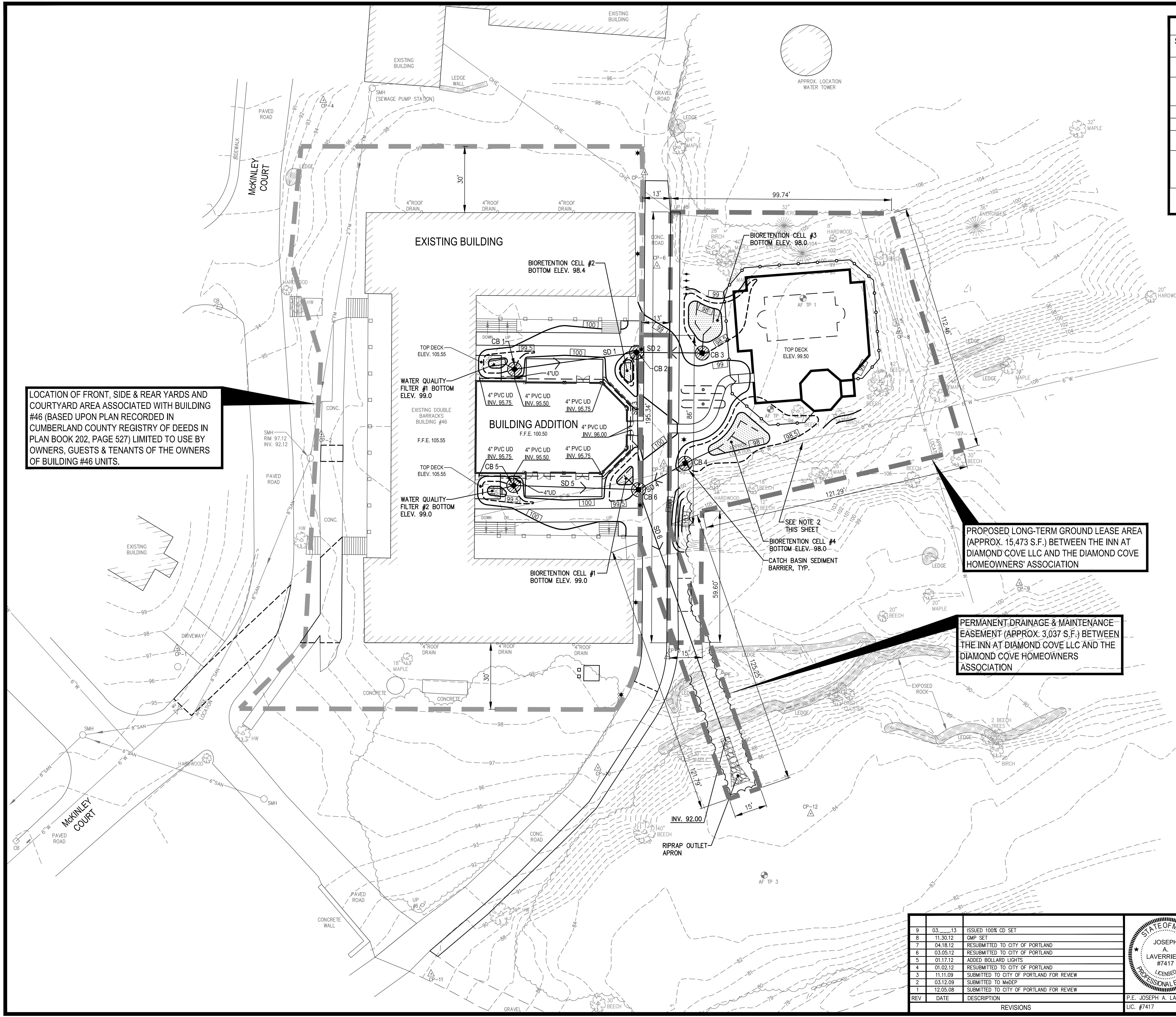

LOCATION OF FRONT, SIDE & REAR YARDS AND COURTYARD AREA ASSOCIATED WITH BUILDING #46 (BASED UPON PLAN RECORDED IN CUMBERLAND COUNTY REGISTRY OF DEEDS IN PLAN BOOK 202, PAGE 527) LIMITED TO USE BY OWNERS, GUESTS & TENANTS OF THE OWNERS OF BUILDING #46 UNITS.

PROPOSED LONG-TERM GROUND LEASE AREA (APPROX. 15,473 S.F.) BETWEEN THE INN AT DIAMOND COVE LLC AND THE DIAMOND COVE HOMEOWNERS' ASSOCIATION

PERMANENT DRAINAGE & MAINTENANCE EASEMENT (APPROX. 3,037 S.F.) BETWEEN THE INN AT DIAMOND COVE LLC AND THE DIAMOND COVE HOMEOWNERS' ASSOCIATION

REV	DATE	DESCRIPTION
9	03.13	ISSUED 100% CD SET
8	11.30.12	GMP SET
7	04.18.12	RESUBMITTED TO CITY OF PORTLAND
6	03.05.12	RESUBMITTED TO CITY OF PORTLAND
5	01.17.12	ADDED BOLLARD LIGHTS
4	01.02.12	RESUBMITTED TO CITY OF PORTLAND
3	11.11.09	SUBMITTED TO CITY OF PORTLAND FOR REVIEW
2	03.12.09	SUBMITTED TO MADP
1	12.05.08	SUBMITTED TO CITY OF PORTLAND FOR REVIEW

STATE OF MAINE  
**JOSEPH A. LAVERRIERE**  
 #7417  
 LICENSED PROFESSIONAL ENGINEER

PROJECT  
**THE INN AT DIAMOND COVE**

SHEET TITLE  
**OVERALL GRADING, DRAINAGE & EROSION CONTROL PLAN**

CLIENT  
**THE INN AT DIAMOND COVE LLC**

**DeLUCA-HOFFMAN ASSOCIATES, INC.**  
 778 MAIN STREET, SUITE 8  
 SOUTH PORTLAND, ME 04106  
 207.775.1121  
 WWW.DELUCAHOFFMAN.COM

DRAWN: CDD DATE: DEC. 2008  
 DESIGNED: JAL SCALE: 1" = 20'  
 CHECKED: JAL JOB NO. 2769  
 FILE NAME: 2769-SP  
 SHEET: **C-5**