

LEGEND:

□ ALL THIRD FLOOR CEILINGS - INCLUDING UNFINISHED ATTIC SPACE - GYP CEILING DIRECTLY ATTACHED TO STRUCTURE APPROXIMATELY 10'-2" A.F.F.

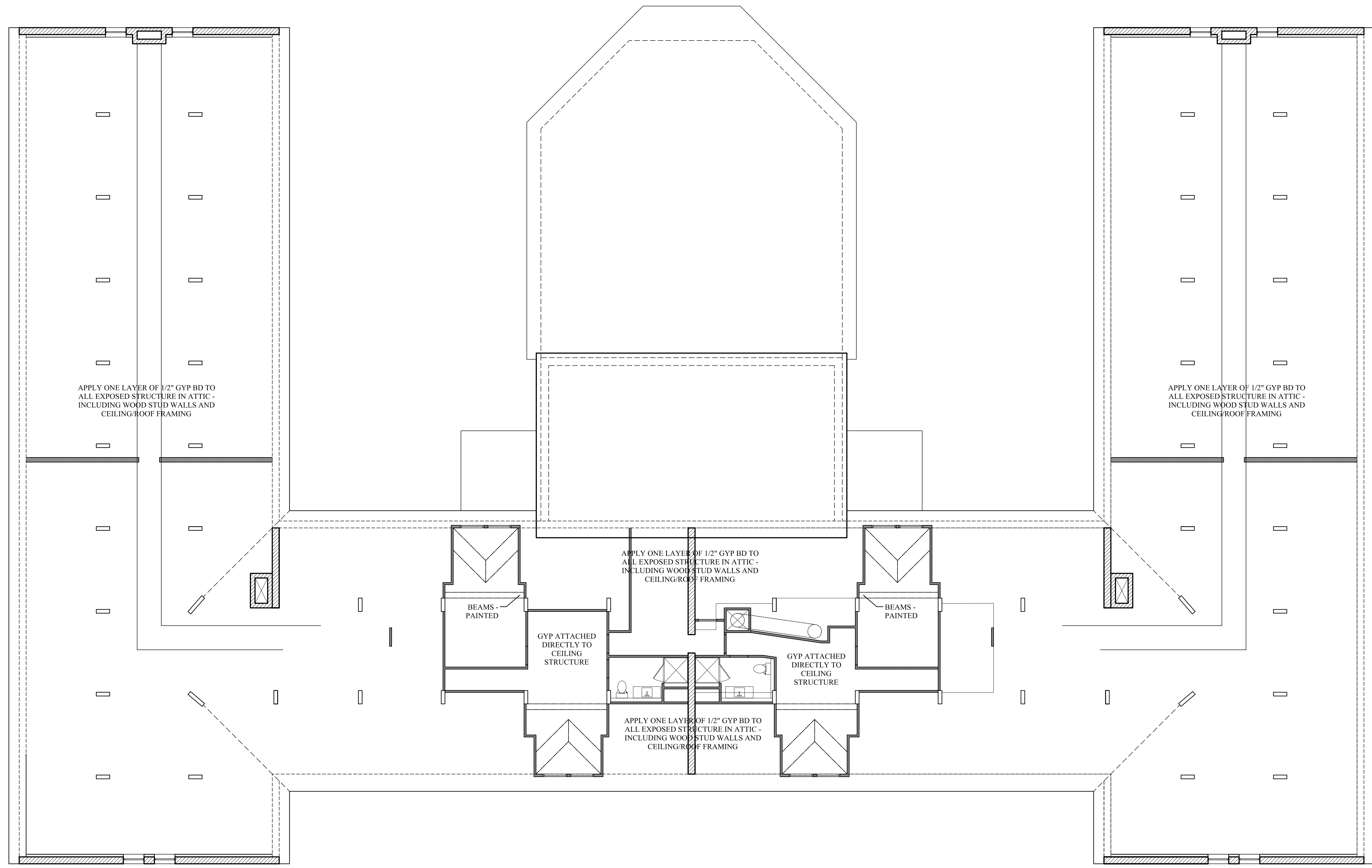

1 | ATTIC REFLECTED CEILING PLAN
SCALE: 1/8"=1'-0"

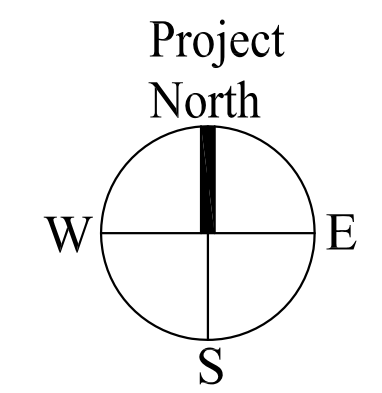

Prepared For: The Inn at Diamond Cove, LLC. PO BOX 3572 PORTLAND, ME 04101	
Interior Designer: truexcollins INTERIORS 298 BATTERY STREET BURLINGTON, VERMONT 05401 USA Phone 802.656.2775 • 800.227.1076 ARCHITECTURE INTERIOR DESIGN truexcollins.com	
Architect: ARCHETYPE architects 48 Union Wharf Portland, Maine 04101 (207) 772-6022 Fax (207) 772-4056	
Project: THE INN AT DIAMOND COVE, LLC MCKINLEY COURT GREAT DIAMOND ISLAND, MAINE	
Revisions:	
Date: 04 March 2013	Scale: 1/8" = 1'-0"
THIRD FLOOR REFLECTED CEILING PLAN	
A6.03	