

LEGEND:

BUILDING SECTION	
WALL SECTION	
SECTION DETAIL	
PLAN DETAIL	
WALL TYPE (SEE SHEET A4.01)	
FLOOR/CEILING TYPE (SEE SHEET A4.02)	
FLOOR AREA DEMOLITION	
NEW CMU WALL	
NEW MASONRY INFILL	
NEW CONCRETE FOUNDATION/RET. WALL	
EXISTING STUD WALL	
EXISTING MASONRY WALL	
DEMO AND REMOVE	

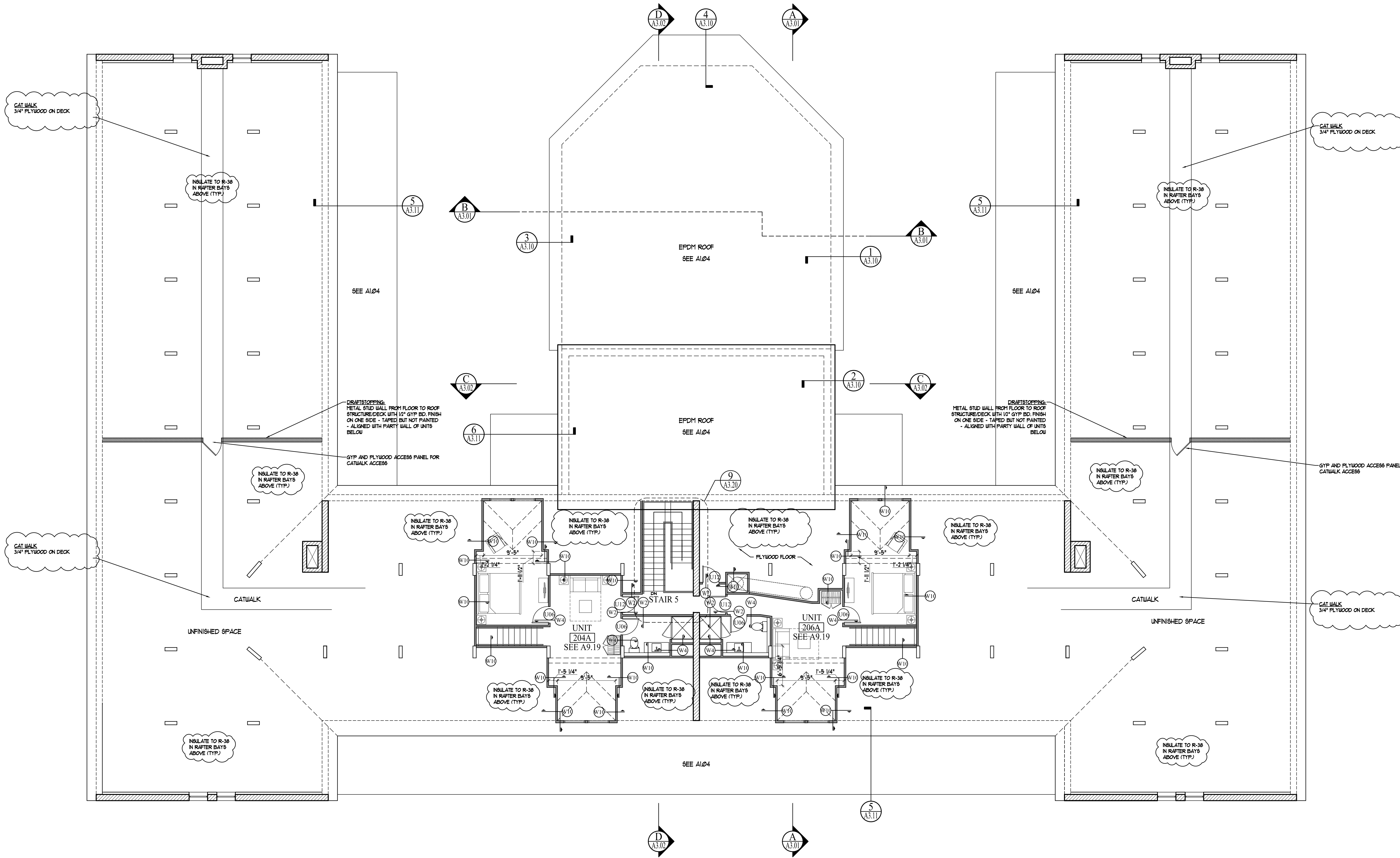

Prepared For: **The Inn at Diamond Cove, LLC.** PO BOX 3572 PORTLAND, ME 04101

Interior Designer: **truexcollins INTERIORS** 209 BATTERY STREET BURLINGTON, VERMONT 05401 USA Phone 802.658.2775 Fax 802.227.1076 ARCHITECTURE INTERIOR DESIGN XC@TRUEXCOLLINS.COM

Architect: **ARCHETYPE architects** 48 Union Wharf Portland, Maine 04101 (207) 772-6022 Fax (207) 772-4056

Project: **THE INN AT DIAMOND COVE, LLC** MCKINLEY COURT GREAT DIAMOND ISLAND, MAINE

Revisions:

Date: 04 March 2013 Scale: 1/8" = 1'-0"

THIRD FLOOR PLAN

A1.03

1 | THIRD FLOOR PLAN / ATTIC PLAN
SCALE: 1/8"=1'-0"

