



ASSOCIATED DESIGN PARTNERS INC.
 Office: (707) 878-1751
 80 Leighton Road, Fremont, MA 01903
 E-Mail: adp@engdesign.com

THE DRAWING, DESIGN AND SPECIFICATIONS ARE THE PROPERTY OF ASSOCIATED DESIGN PARTNERS INC. AND SHALL REMAIN THE PROPERTY OF ASSOCIATED DESIGN PARTNERS INC. UNLESS OTHERWISE SPECIFIED.

PROJECT: **16F MCKINLEY CT**
 GREAT DIAMOND ISL, PORTLAND, ME
 SHEET TITLE: **STRUCTURAL DETAILS**
 ISSUED FOR PERMITTING

DATE	BY	REVISION

DATE: 12-13-18
 SCALE: AS NOTED
 DESIGN BY: ADP
 DRAWN BY: BSC
 FILE #:
 SHEET NO: **16133**
 SHEET OF: **S2**

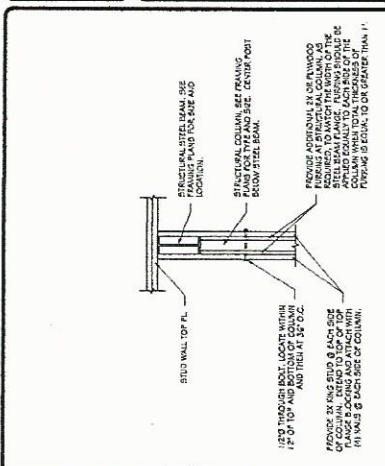

C1 STEEL BEAM AT WOOD POST
 SCALE: INTS

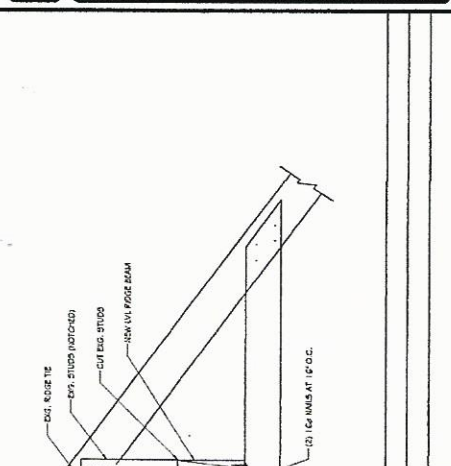

B2 NEW RIDGE BEAM DETAIL
 SCALE: 1/4\"/>

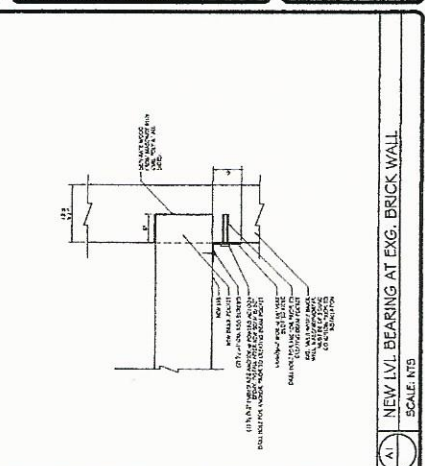

A1 NEW LVL BEARING AT EXG. BRICK WALL
 SCALE: INTS

WOOD FRAMING NOTES

- STRUCTURAL LAMINATE LVL, 2x14, SHALL BE PERMITTED TO BE USED AS A BEARING MEMBER FOR THE EXISTING BRICK WALL.
- REPAIR EXISTING.
- INSTALL BRICK WALL ON EXISTING FOUNDATION.
- CONTRACTOR VERIFY ALL DIMENSIONS PRIOR TO CONSTRUCTION.
- ALL WOOD SHALL BE DRY (MOISTURE CONTENT NOT TO EXCEED 19%) AT THE TIME OF INSTALLATION.
- ALL WOOD SHALL BE PROTECTED AGAINST TERMITES AND OTHER INSECT PESTS.
- ALL WOOD SHALL BE PROTECTED AGAINST ROT AND DECAY.
- ALL WOOD SHALL BE PROTECTED AGAINST FIRE.
- ALL WOOD SHALL BE PROTECTED AGAINST COLLAPSE.
- ALL WOOD SHALL BE PROTECTED AGAINST SWELLING AND SHRINKAGE.
- ALL WOOD SHALL BE PROTECTED AGAINST DISCOLORATION.
- ALL WOOD SHALL BE PROTECTED AGAINST STAINING.
- ALL WOOD SHALL BE PROTECTED AGAINST WEATHERING.
- ALL WOOD SHALL BE PROTECTED AGAINST UV RADIATION.
- ALL WOOD SHALL BE PROTECTED AGAINST AIR POLLUTION.
- ALL WOOD SHALL BE PROTECTED AGAINST OZONE.
- ALL WOOD SHALL BE PROTECTED AGAINST ACID RAIN.
- ALL WOOD SHALL BE PROTECTED AGAINST SALT CRYSTALLIZATION.
- ALL WOOD SHALL BE PROTECTED AGAINST MICROBIAL GROWTH.
- ALL WOOD SHALL BE PROTECTED AGAINST MOLD AND FUNGI.
- ALL WOOD SHALL BE PROTECTED AGAINST BACTERIA.
- ALL WOOD SHALL BE PROTECTED AGAINST VIRUSES.
- ALL WOOD SHALL BE PROTECTED AGAINST PARASITES.
- ALL WOOD SHALL BE PROTECTED AGAINST INVERTEBRATES.
- ALL WOOD SHALL BE PROTECTED AGAINST PLANTS.
- ALL WOOD SHALL BE PROTECTED AGAINST ANIMALS.
- ALL WOOD SHALL BE PROTECTED AGAINST HUMANS.
- ALL WOOD SHALL BE PROTECTED AGAINST OTHER ORGANISMS.

A2 NOTES