

These drawings convey design intent only and should not be relied upon for construction. See cover sheet for legal disclaimer and additional info. The design is the property of Fine Lines Construction, Inc. without written permission from Fine Lines Construction, Inc.  
 © COPYRIGHT 2013 FINE LINES CONSTRUCTION, INC.

**Renovations to the COOPER RESIDENCE**

44 McKinley Court - Diamond Cove,  
 Great Diamond Island, ME 04109

**BASEMENT FLOOR PLAN**

Issue Status:  
**PERMIT SET**  
 JULY 30, 2013

**A1-02**

Sheet 3 of 12

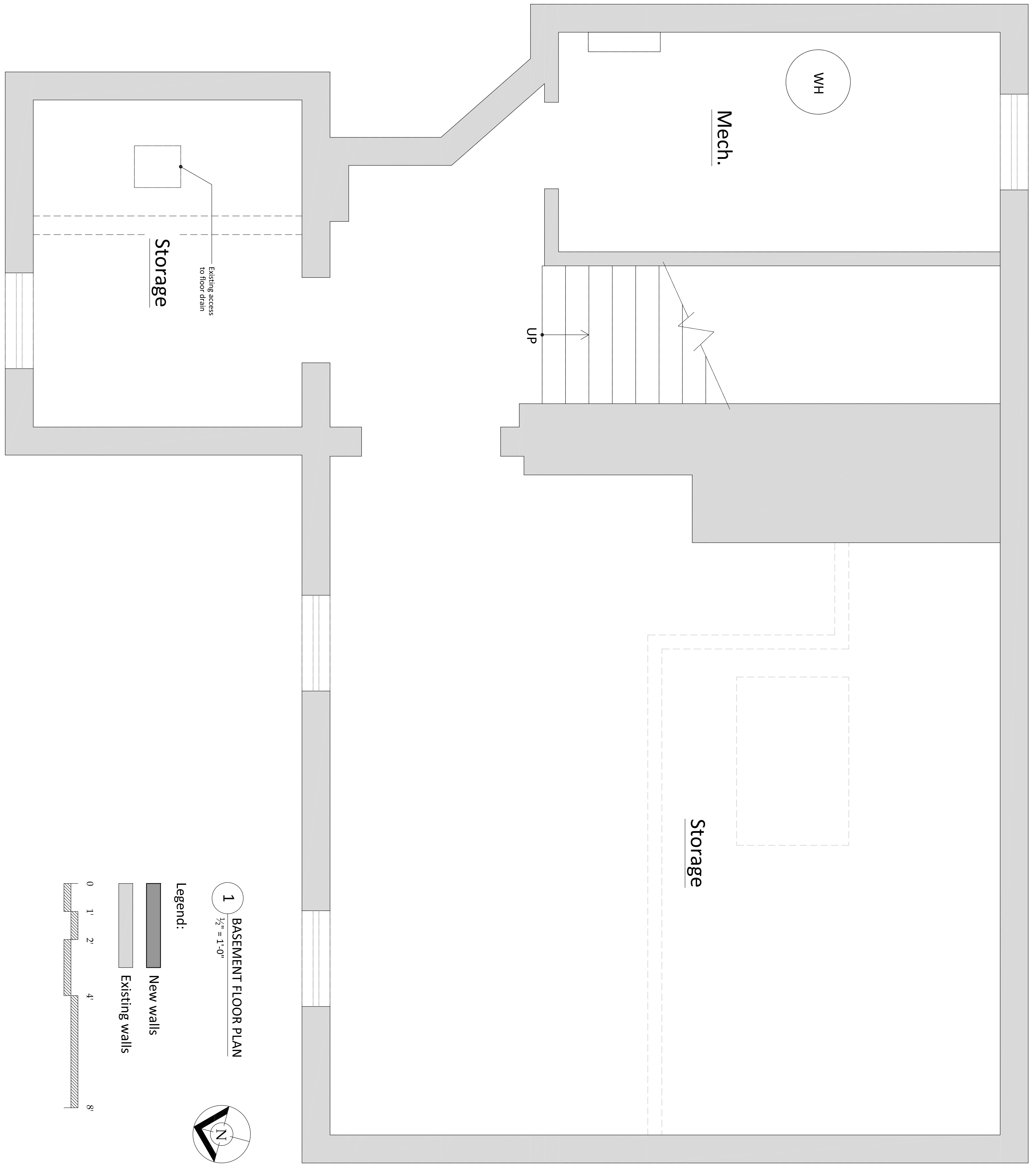

**1** BASEMENT FLOOR PLAN  
 1/4" = 1'-0"

Legend:

- New walls
- Existing walls

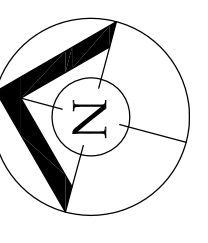
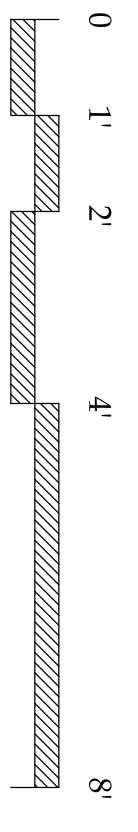

**Storage**

Existing access to floor drain

**Mech.**

WH

Up

**Storage**