

CASCO BAY

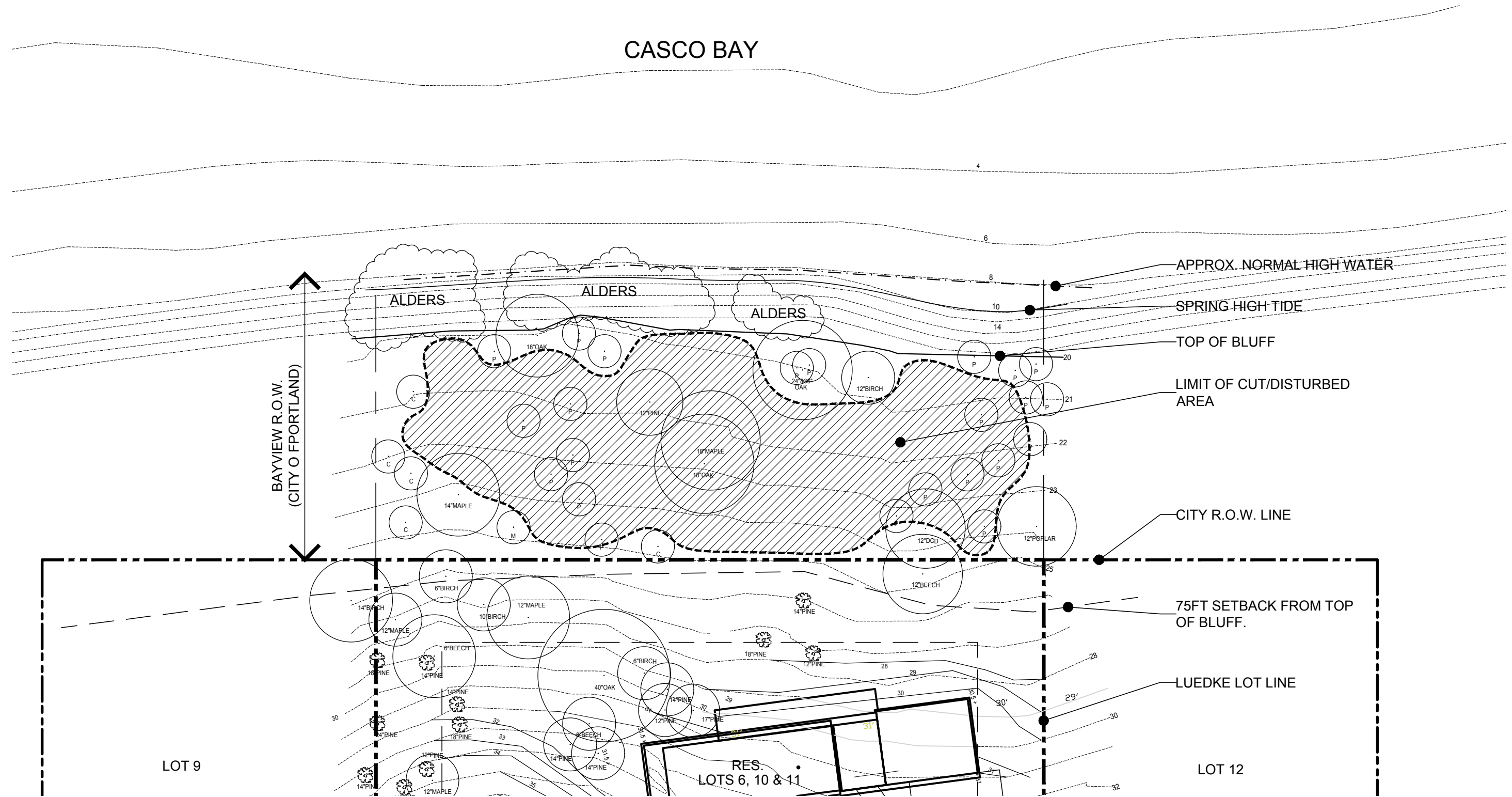

Luedke Residence - Existing Conditions Plan

Crescent Ave, Great Diamond Island, Maine

June 28, 2016



GRAPHIC SCALE

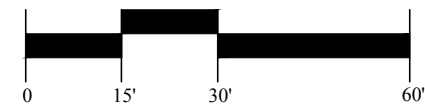

MOHR & SEREDIN
Landscape Architects, Inc.

18 Pleasant Street, Portland, Maine 041
ph: 1.207.871.0003
fax: 1.207.871.1419