

1 SECTION THRU STAIR  
SCALE: 1/2" = 1'-0"

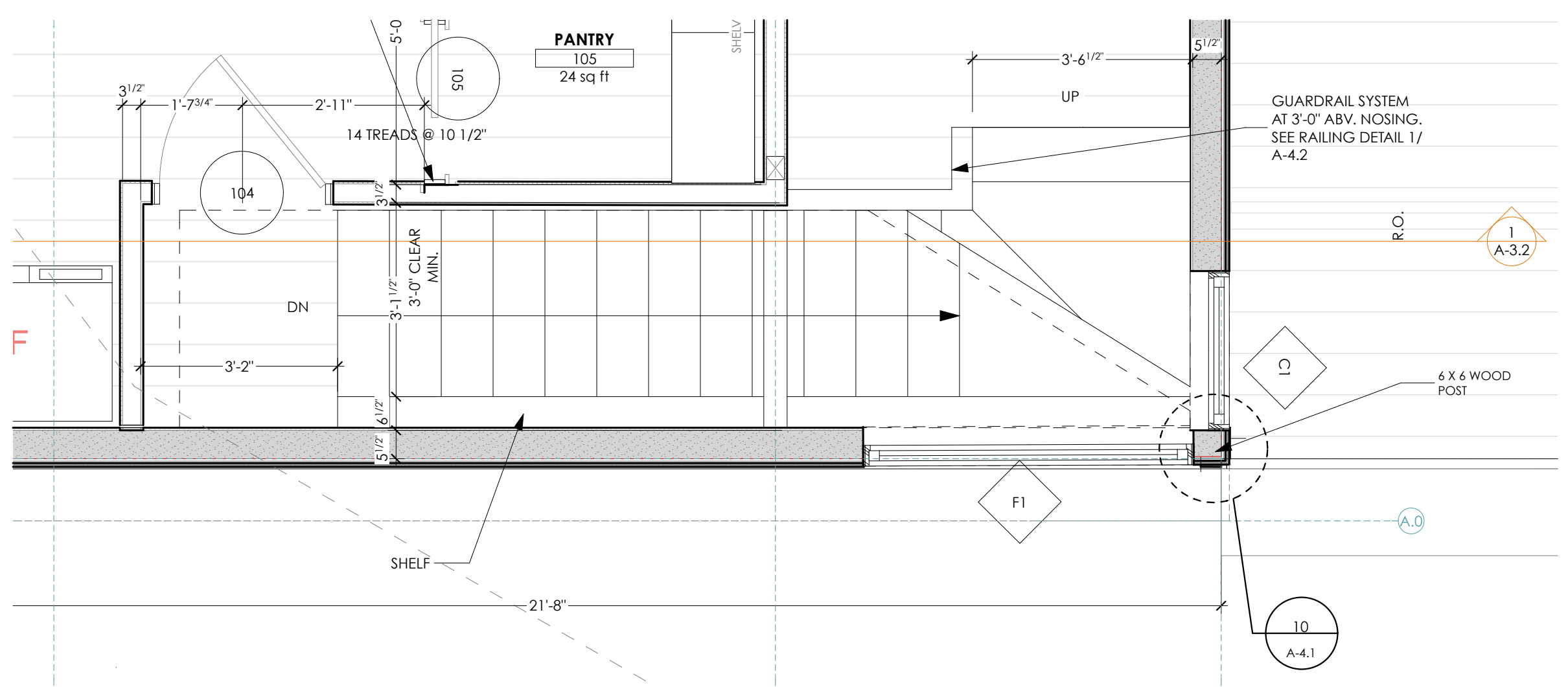

2 1/2" FIRST FLOOR STAIR PLAN  
SCALE: 1/2" = 1'-0"

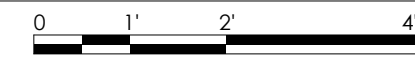
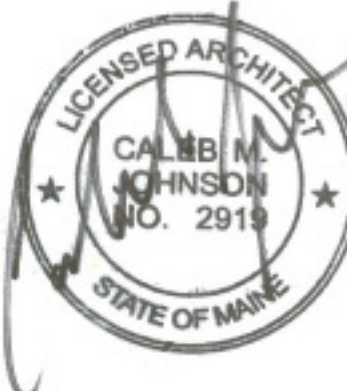
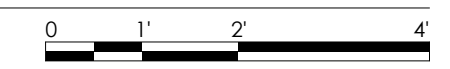

STUDIO MANAGER:  
PROJECT ARCHITECT:

CHANGES THIS ISSUE:

ID	DESCRIPTION

ISSUE NUMBER:

ISSUE NUMBER	DATE	DESCRIPTION

SUBMISSIONS:

ISSUE	DATE

CONSULTANTS:  
Aron Jones, PE  
77 Oak Street, Portland ME 04101  
mat@lepre.ejt.com  
207.774.4616

DRAFTER/PERSON:  
Patrice Boehme, AIA  
DATE OF ISSUE:  
3/1/16  
PROJECT STATUS:  
Permit Set

**Luedke Residence**  
James & Katharine Luedke  
Crescent Ave Great Diamond Island ME  
04109

BUILDING SECTIONS  
**A-3.2**