

2003 6015

SUBSURFACE WASTEWATER DISPOSAL SYSTEM APPLICATION

Maine Department of Human Services
Division of Health Engineering, Station 10
(207) 287-6672 FAX (207) 287-4172

>> Caution: Permit Required - Attach in Space Below <<

City, Town, or Plantation: Great Diamond Island, Portland
Street or Road: 12 Crescent Avenue
Subdivision, Lot #:

PORTLAND Date Permit Issued: 10/12/03 8750 TOWN COPY \$ 1500 FEE Charged Double Fee Charged
Local Plumbing Inspector Signature: [Signature] L.P.I. # 01640

Name (last, first, MI): Chasson, Eric J. Owner Applicant
Mailing Address of: 77 Walden Street
 Owner Applicant
Concord Massachusetts 01742
Daytime Tel. #: 766-5673

Municipal Tax Map # _____ Lot # _____

Owner or Applicant Statement
I state that the information submitted is correct to the best of my knowledge and understand that any falsification is reason for the Department and/or Local Plumbing Inspector to deny a Permit.

Caution: Inspections Required
I have inspected the installation authorized above and found it to be in compliance with the Subsurface Wastewater Disposal Rules Application.
NOV 4 2003
Local Plumbing Inspector Signature: _____ (1st) Date Approved _____
_____ (2nd) Date Approved _____

TYPE OF APPLICATION
1. First Time System
2. Replacement System
Type Replaced: Trench
Year Installed: 1940's +/-
3. Expanded System
a. One-time exempted
b. Non-exempted
4. Experimental System
5. Seasonal Conversion

THIS APPLICATION REQUIRES
1. No Rule Variance
2. First Time System Variance
a. Local Plumbing Inspector Approval
b. State & Local Plumbing Inspector Approval
3. Replacement System Variance
a. Local Plumbing Inspector Approval
b. State & Local Plumbing Inspector Approval
4. Minimum Lot Size Variance
5. Seasonal Conversion Approval

DISPOSAL SYSTEM COMPONENT(S)
1. Complete Non-engineered System
2. Primitive System (graywater & all toilet)
3. Alternative Toilet, specify: _____
4. Non-Engineered Treatment Tank (only)
5. Holding Tank, _____ gallons
6. Non-engineered Disposal Field (only)
7. Separated Laundry System
8. Complete Engineered System (2000 gal or more)
9. Engineered Treatment Tank (only)
10. Engineered Disposal Field (only)
11. Pre-treatment, specify:
12. Miscellaneous components

TYPE OF WATER SUPPLY
1. Drilled Well 2. Dug Well 3. Private
4. Public 5. Other:

SIZE OF PROPERTY
0.77 sq. ft. acres

SHORELAND ZONING
 Yes No

DISPOSAL SYSTEM TO SERVE
1. Single Family Dwelling Unit, No. of Bedrooms: _____
2. Multiple Family Dwelling, No. of Units: _____
3. Other: Seasonal Camp Bedrooms
SPECIFY _____

TREATMENT TANK
1. Concrete EXISTING
a. Regular Repair buffer
b. Low Profile outlet - bldg
2. Plastic pipe - repair
3. Other: Septic Tank
CAPACITY: _____ gallons
Replace w/ 1000 gallon plastic

DISPOSAL FIELD TYPE & SIZE
1. Stone Bed 2. Stone Trench
3. Proprietary Device
a. Cluster entry c. Linear
b. Regular load d. H-20 load
Other: _____
SIZE: _____ sq. ft. lin. ft.

DISPOSAL FIELD SIZING
1. Small - 2.0 sq. ft./gpd
2. Medium - 2.6 sq. ft./gpd
3. Medium-Large - 3.3 sq. ft./gpd
4. Large - 4.1 sq. ft./gpd
5. Extra Large - 5.0 sq. ft./gpd

GARBAGE DISPOSAL UNIT
1. No 3. Maybe
2. Yes >> Specify one below:
a. Multi-compartment Tank
b. Tanks in Series
c. Increase in Tank Capacity
d. Filter on Tank Outlet

PUMPING
1. Not Required
2. May Be Required
3. Required >> Specify only for engineered or experimental systems
DOSE: _____ gallons

DESIGN FLOW
216 gallons per day
BASED ON:
1. Table 501.1 (dwelling unit(s))
2. Table 501.2 (other facilities)
SHOW CALCULATIONS - for other facilities -
270 less 54 gpd for laundry = 216 gpd

3. Section 503.0 (meter readings)
PERMANENT WATER METER DATA

I Certify that on Oct 3 2003 (date) I completed a site evaluation on this property and state that the data reported are accurate and that the proposed system is in compliance with the State of Maine Subsurface Wastewater Disposal Rules (10-144A CMR 241).

Signature: John Tomtake #347 Date: October 9 2003
Site Evaluator Signature: John Tomtake 239-55746
City of Portland

12 Crescent Avenue

SUBSURFACE WASTEWATER DISPOSAL SYSTEM APPLICATION

Department of Human Services
Division of Health Engineering
(207) 287-9872 FAX (207) 287-4172

Town, City, Plantation: Great Diamond Island, Portland, Maine Street, Road Subdivision: Portland, Maine Owner's Name: Eric J. Chaisson

SITE PLAN

Scale 1" = 100 Ft.
or as shown

SITE LOCATION PLAN

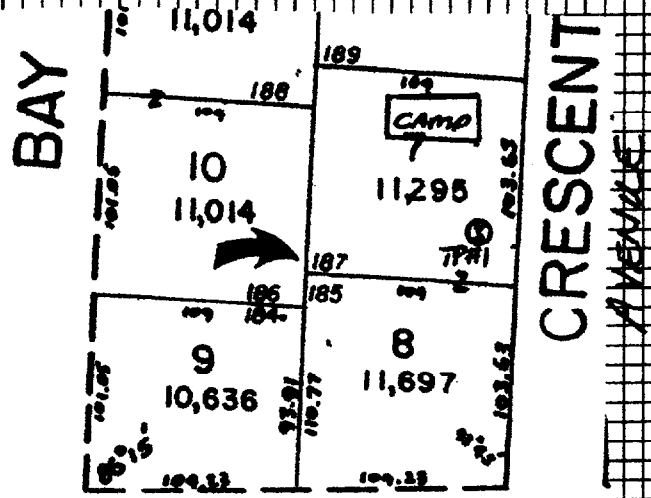
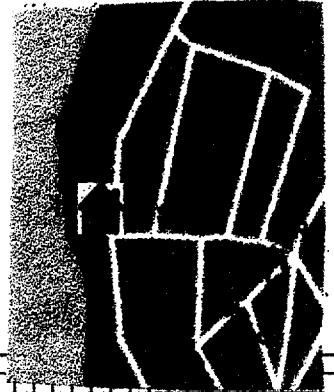

SOIL DESCRIPTION AND CLASSIFICATION (Location of Observation Holes Shown Above)

Observation Hole TP#1 Test Pit Boring
0 1" Depth of Organic Horizon Above Mineral Soil

DEPTH BELOW MINERAL SOIL SURFACE (inches)	Texture	Consistency	Color	Mottling
0	Loamy Sand	Friable	Brown	
10	Gravelly Coarse Sand	S. D. Loose	Reddish Brown	None
20				Recorded
30				
40				
50				

Soil Classification: 5 C Slope: 1-3% Limiting Factor: 48"
 Ground Water Restrictive Layer Bedrock Pit Depth

Observation Hole _____ Test Pit Boring
 " Depth of Organic Horizon Above Mineral Soil

DEPTH BELOW MINERAL SOIL SURFACE (inches)	Texture	Consistency	Color	Mottling
0				
10				
20				
30				
40				
50				

Soil Classification _____ Slope _____% Limiting Factor _____"
 Ground Water Restrictive Layer Bedrock Pit Depth

John M. Lovelace
Site Evaluator Signature

#347
SE

October 9, 2003
Date

12 Crescent Avenue

SUBSURFACE WASTEWATER DISPOSAL SYSTEM APPLICATION

Department of Human Services
Division of Health Engineering
(207) 287-5672 FAX (207) 287-4172

Town, City, Plantation

Street, Road, Subdivision

Owner's Name

Great Diamond Island, Portland Maine

Eric J. Chausson

SUBSURFACE WASTEWATER DISPOSAL PLAN

SCALE 1" = 20' FT.

LEGEND:

- MON - GRANITE MONUMENT
- IRF - IRON ROD FOUND
- IPF - IRON PIPE FOUND
- TP - TEST PIT

NOTES:

1. IF A GARBAGE DISPOSAL IS USED, THEN CHANGES TO THIS DESIGN ARE NECESSARY.
2. ALLOW FOR POSITIVE DRAINAGE AROUND THE LEACHFIELD.
3. ALL MATERIALS AND INSTALLATION SHALL BE IN ACCORDANCE WITH THE MAINE SUBSURFACE WASTEWATER DISPOSAL RULES DATED 6/02, AS AMENDED, AND SUPPLEMENTED BY THE ATTACHED GENERAL NOTES WHICH BECOME A PART OF THIS DESIGN.

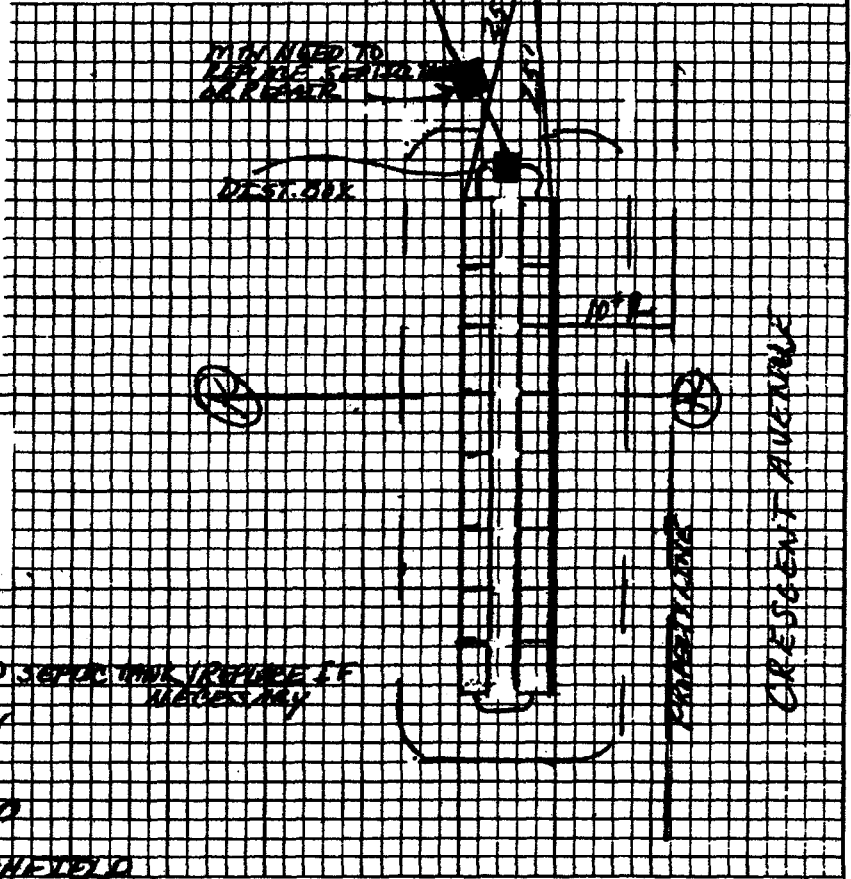

REMOVE OLD PVT SEPTIC DREN / AND SEPTIC TANK (REMOVE IF NECESSARY)
Proposed 2 Rows of (4) 14" STANDARD BLOCKS
AD 3" GRAVELLY COARSE SAND BETWEEN ROWS
KEEP LAUNDRY IN OLD LEACHFIELD

FILL REQUIREMENTS		CONSTRUCTION ELEVATIONS		ELEVATION REFERENCE POINT	
Depth of Fill (Upslope)	<i>0' - 19"</i>	Finished Grade Elevation	<i>-29"</i>	Location & Description	<i>CRN PATCH MARKED ELP 34" ABX GRM</i>
Depth of Fill (Downslope)	<i>0' - 19"</i>	Top of Distribution Pipe or Proprietary Device	<i>-41"</i>	Reference Elevation	<i>0"</i>
		Bottom of Disposal Area	<i>-55"</i>		

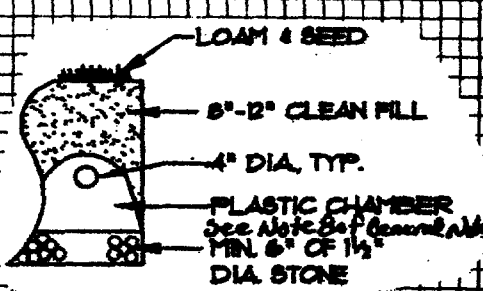

DISPOSAL AREA CROSS SECTION

SCALE:
VERTICAL: 1" = 3'
HORIZONTAL: 1" = 5'

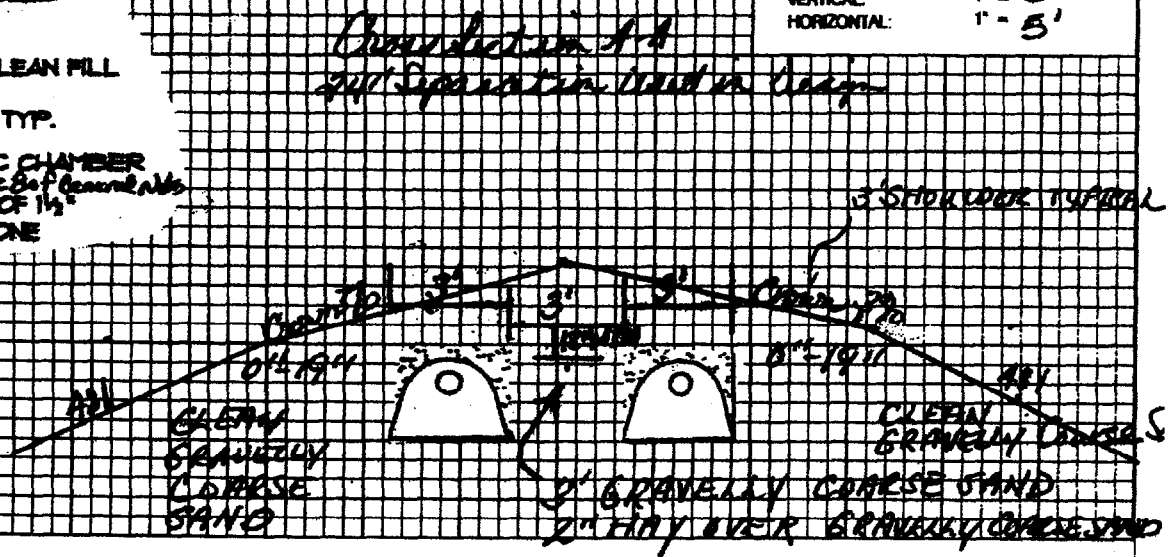

John M. Toothaku
Site Evaluator Signature

#347
SE

October 9, 2003
Date

General Notes
(attachment to form HHE-200)
< 1,000 gpd Septic System

1. It is your right to get a second opinion if you don't agree with the professional opinion of Tooth & Associates.
2. Property information is from the owner or applicant and shall be correct and verified prior to signing this HHE-200 application.
3. All work shall be done per the Maine Subsurface Wastewater Disposal Rules dated 6/02 as amended.
4. All work shall be done only in dry conditions for disposal area.
5. No vehicular or equipment traffic to be allowed on disposal area. Construct disposal area outside the corner flags located in the field. Protect down slope area as well.
6. Backfill, if required, is to be gravelly coarse sand to coarse sand texture and to be free of foreign debris. If backfill is coarser than original soil, then mix top 4" of backfill and original soil with rototiller.
7. No neighboring wells are apparent (unless so indicated) within 100' of disposal area. Owner or applicant shall verify this prior to signing the HHE-200 application.
8. The disposal field stone shall be clean, uniform in size and free of fines, dusts, ashes, or clay. It shall be no smaller than ¼ inch and no larger than 2½ inches in size (per Section 805.2.3 of the Maine Subsurface Wastewater Rules).
9. Use minimum separation distances required (unless reduced by variance or special circumstance).
 - a. Wells with water usage of 2,000 or more gpd or public water supply wells:

Disposal fields:	300'
Septic Tanks and Holding Tanks:	100'
 - b. any well to disposal area: 100'
 - c. any well to septic tank 100'
 - d. septic tank or disposal area to lake, river, stream or brook: 100' for major watercourse
50' for minor watercourse
 - e. house to treatment tank: 8'
 - f. house to disposal area: 20'
 - g. all other separation distances, for less than 1,000 gpd per Maine Subsurface Wastewater Disposal Rules use Table 700.2.
10. Location of septic near a wetland may require a separate permit. As such, the owner or applicant prior to construction of the septic system shall hire a professional wetland scientist to evaluate adjacent wetlands and prepare needed permits.
11. Garbage disposals are not recommended and, if installed, are done so at the owner's risk. Follow Maine State Plumbing Code if installed.
12. Pump Stations shall be water tight to prevent infiltration of ground and surface water.
13. Pressure lines and force mains shall be flushed of any foreign material and pumps shall be checked for proper on/off cycle before being put into service.
14. Force mains, pump stations, and /or gravity piping subject to freezing shall be adequately insulated or installed below the frost line.

Tooth & Associates 19 Davis Annex, Gorham, Maine 04038 (207)839-5746