

DISPLAY THIS CARD ON PRINCIPAL FRONTAGE OF WORK



CITY OF PORTLAND

BUILDING PERMIT

This is to certify that GARY L & JEANNE MJTS SMITH

Located At 100 WILLIS

Job ID: 2011-05-1124-SE

CBL: 083 - B - G - 001 - - - -

has permission to To erect 40' x1 00' Tent on 8-20-11 to 8-22-11

provided that the person or persons, firm or corporation accepting this permit shall comply with all of the provisions of the Statues of Maine and of the Ordinances of the City of Portland regulating the construction, maintenance and use of the buildings and structures, and of the application on file in the department.

Notification of inspection and written permission procured before this building or part thereof is lathed or otherwise closed-in. 48 HOUR NOTICE IS REQUIRED.

A final inspection must be completed by owner before this building or part thereof is occupied. If a ~~certificate~~ of occupancy is required, it must be

Fire Prevention Officer

Code Enforcement Officer / Plan Reviewer

5/24/11

**THIS CARD MUST BE POSTED ON THE STREET SIDE OF THE PROPERTY
PENALTY FOR REMOVING THIS CARD**

BUILDING PERMIT INSPECTION PROCEDURES

Please call 874-8703 or 874-8693 (ONLY)

or email: buildinginspections@portlandmaine.gov

With the issuance of this permit, the owner, builder or their designee is required to provide adequate notice to the city of Portland Inspections Services for the following inspections. Appointments must be requested 48 to 72 hours in advance of the required inspection. The inspection date will need to be confirmed by this office.

- **Please read the conditions of approval that is attached to this permit!! Contact this office if you have any questions.**
- **Permits expire in 6 months. If the project is not started or ceases for 6 months.**
- **If the inspection requirements are not followed as stated below additional fees may be incurred due to the issuance of a "Stop Work Order" and subsequent release to continue.**

The project cannot move to the next phase prior to the required inspection and approval to continue, REGARDLESS OF THE NOTICE OF CIRCUMSTANCES.

IF THE PERMIT REQUIRES A CERTIFICATE OF OCCUPANCY, IT MUST BE PAID FOR AND ISSUED TO THE OWNER OR DESIGNEE BEFORE THE SPACE MAY BE OCCUPIED.



PORTLAND MAINE

Strengthening a Remarkable City, Building a Community for Life • www.portlandmaine.gov

Director of Planning and Urban Development
Penny St. Louis

Job ID: 2011-05-1124-SE

Located At: 100 WILLIS

CBL: 083 - B - G - 001 - 001 - - - - -

Conditions of Approval:

Zoning

1. This permit is being approved on the basis of plans submitted. Any deviations shall require a separate approval before starting that work.
2. This property shall remain a single family dwelling. Any change of use shall require a separate permit application for review and approval.
3. It is understood that this tent will be straddling two single family properties and City land. The City thru Ted Musgrave has allowed the tent to be on City property thru a separate permitting process.
4. It is also noted that fragile, protected bluffs are near to the area that the tent will be located. It is necessary to not negatively impact these fragile bluffs. You should keep any tent users as far away from the protected bluffs as possible. If there is any damage to the protected bluffs, you will be responsible for any mitigation that is required.

City of Portland, Maine - Building or Use Permit Application

389 Congress Street, 04101 Tel: (207) 874-8703, FAX: (207) 8716

Job No: 2011-05-1124-SE	Date Applied: 5/12/2011	CBL: 083 - B - G - 001 - 001 - - - - -	
Location of Construction: 100 & 104 WILLIS ST- GDI	Owner Name: GARY L & JEANNE M SMITH JTS MARY T BOYLAN	Owner Address: PO BOX 225 CAPE ELIZABETH, ME - MAINE 04107	Phone: 671-2595- c
Business Name:	Contractor Name: Owner	Contractor Address:	Phone:
Lessee/Buyer's Name:	Phone:	Permit Type: TENTS - Tents	Zone: IR-2 - shoreland -protected bluffs
Past Use: Single Family Dwelling on each lot	Proposed Use: Same: Single Family Dwelling on each lot - to share a 40'x100' Tent to be erected on 8/20/11 thru 8/22/11	Cost of Work:	CEO District:
		Fire Dept: <input type="checkbox"/> Approved <input type="checkbox"/> Denied <input type="checkbox"/> N/A Signature: <i>[Signature]</i>	Inspection: Use Group: <i>SE</i> Type: <i>IRC 2009</i> Signature: <i>[Signature]</i>
Proposed Project Description: 100 & 104 Willis GDI - erect 40'x100' tent		Pedestrian Activities District (P.A.D.)	
Permit Taken By: Lannie		Zoning Approval	

<p>1. This permit application does not preclude the Applicant(s) from meeting applicable State and Federal Rules.</p> <p>2. Building Permits do not include plumbing, septic or electrical work.</p> <p>3. Building permits are void if work is not started within six (6) months of the date of issuance. False informatin may invalidate a building permit and stop all work.</p>	<p>Special Zone or Reviews</p> <p><input type="checkbox"/> Shoreland</p> <p><input type="checkbox"/> Wetlands</p> <p><input type="checkbox"/> Flood Zone</p> <p><input type="checkbox"/> Subdivision</p> <p><input type="checkbox"/> Site Plan</p> <p><input type="checkbox"/> Maj <input type="checkbox"/> Min <input type="checkbox"/> MM</p> <p>Date: <i>05/12/11</i></p>	<p>Zoning Appeal</p> <p><input type="checkbox"/> Variance</p> <p><input type="checkbox"/> Miscellaneous</p> <p><input type="checkbox"/> Conditional Use</p> <p><input type="checkbox"/> Interpretation</p> <p><input type="checkbox"/> Approved</p> <p><input type="checkbox"/> Denied</p> <p>Date: <i>05/12/11</i></p>	<p>Historic Preservation</p> <p><input checked="" type="checkbox"/> Not in Dist or Landmark</p> <p><input type="checkbox"/> Does not Require Review</p> <p><input type="checkbox"/> Requires Review</p> <p><input type="checkbox"/> Approved</p> <p><input type="checkbox"/> Approved w/Conditions</p> <p><input type="checkbox"/> Denied</p> <p>Date: <i>05/12/11</i></p>
	CERTIFICATION		

I hereby certify that I am the owner of record of the named property, or that the proposed work is authorized by the owner of record and that I have been authorized by the owner to make this application as his authorized agent and I agree to conform to all applicable laws of this jurisdiction. In addition, if a permit for work described in the appication is issued, I certify that the code official's authorized representative shall have the authority to enter all areas covered by such permit at any reasonable hour to enforce the provision of the code(s) applicable to such permit.

SIGNATURE OF APPLICANT	ADDRESS	DATE	PHONE
RESPONSIBLE PERSON IN CHARGE OF WORK, TITLE		DATE	PHON



mailing address

P.O. Box 6299
Cape Elizabeth, Me 04107

Tent/Canopy or Temporary Event Staging Permit Application

If you or the property owner owes real estate or personal property taxes or user charges on any property within the City, payment arrangements must be made before permits of any kind are accepted.

Location/Address/Park of Installation: 100 + 104 Willis St. Ft. Diamond Island 04109		
Date of Set up/Event: 8-20-11	Date of Breakdown/ End of Event: 8-22-11	
Tax Assessor's Chart, Block & Lot: Chart# 083B Block# 6001001 Lot# 101	Property Owner: Gary + Jeanne Smith Mary T. Baylan	Telephone: 207-766-3390 207-766-2086
Lessee/Buyer's Name (If Applicable): N/A	Applicant name, address & telephone: Gary L. Smith P.O. Box 6299 Cape Elizabeth, Me. 04107	Fee: \$30.00
<p>The permit fee and the following items must be completed and submitted along with this application in order to receive a permit.</p> <p>1. Certificate of Flammability</p> <p>2. Letter of approval from property owner. If the City is owner, attach a completed copy of Application to Use City Parks & Public Space from Parks & Recreation (756-8275).</p> <p>3. Company name of installer (contact info).</p> <p>4. Plot Plan showing the following: Tent/Canopy or temporary event staging locations, including dimensions, exits and entrances of proposed and existing, parking and existing building locations. If this is temporary staging, you will need to include product information. (Applicant may call Parks & Recreation for maps of Portland's Parks @ 756-8275).</p> <p>5. If the City is the property owner, Certificate of Insurance listing the City as additional insured. Minimum amount of coverage is \$400,000.00</p> <p>Who should we contact when permit is ready: Gary L. Smith Address: P.O. Box 6299 Cape Elizabeth 04107 Telephone: 766-3390</p>		
<p>Please submit all of the information outlined in the Tent/Canopy and Event Staging Permit Application as one package. Failure to do so will result in the automatic denial of your permit.</p>		

RECEIVED

MAY 12 2011

Dept. of Building Inspections
City of Portland, Maine

40' x 100'
RATER ST Bay ALLE
100 Willis owner
104 Willis mother in law

In order to be sure the City fully understands the full scope of the project, the Planning and Development Department may request additional information prior to the issuance of a permit. For further information visit us on-line at www.portlandmaine.gov, stop by the Building Inspections office, room 315 City Hall or call 874-8703.

I hereby certify that I am the Owner of record of the named property, or that the owner of record authorizes the proposed work and that I have been authorized by the owner to make this application as his/her authorized agent. I agree to conform to all applicable laws of this jurisdiction. In addition, if a permit for work described in this application is issued, I certify that the Code Official's authorized representative shall have the authority to enter all areas covered by this permit at any reasonable hour to enforce the provisions of the codes applicable to this permit.

Signature of applicant: Gary L. Smith Date: 4-25-11

This is not a permit; you may not commence ANY work until the permit is issued.

This is a general diagram. Every tent is staked differently depending on the circumstance of each site and what they find above & below ground. (ledge)

40 x 100 Frame tent requires 24 stakes. 1 per leg and 1 per each corner strap.

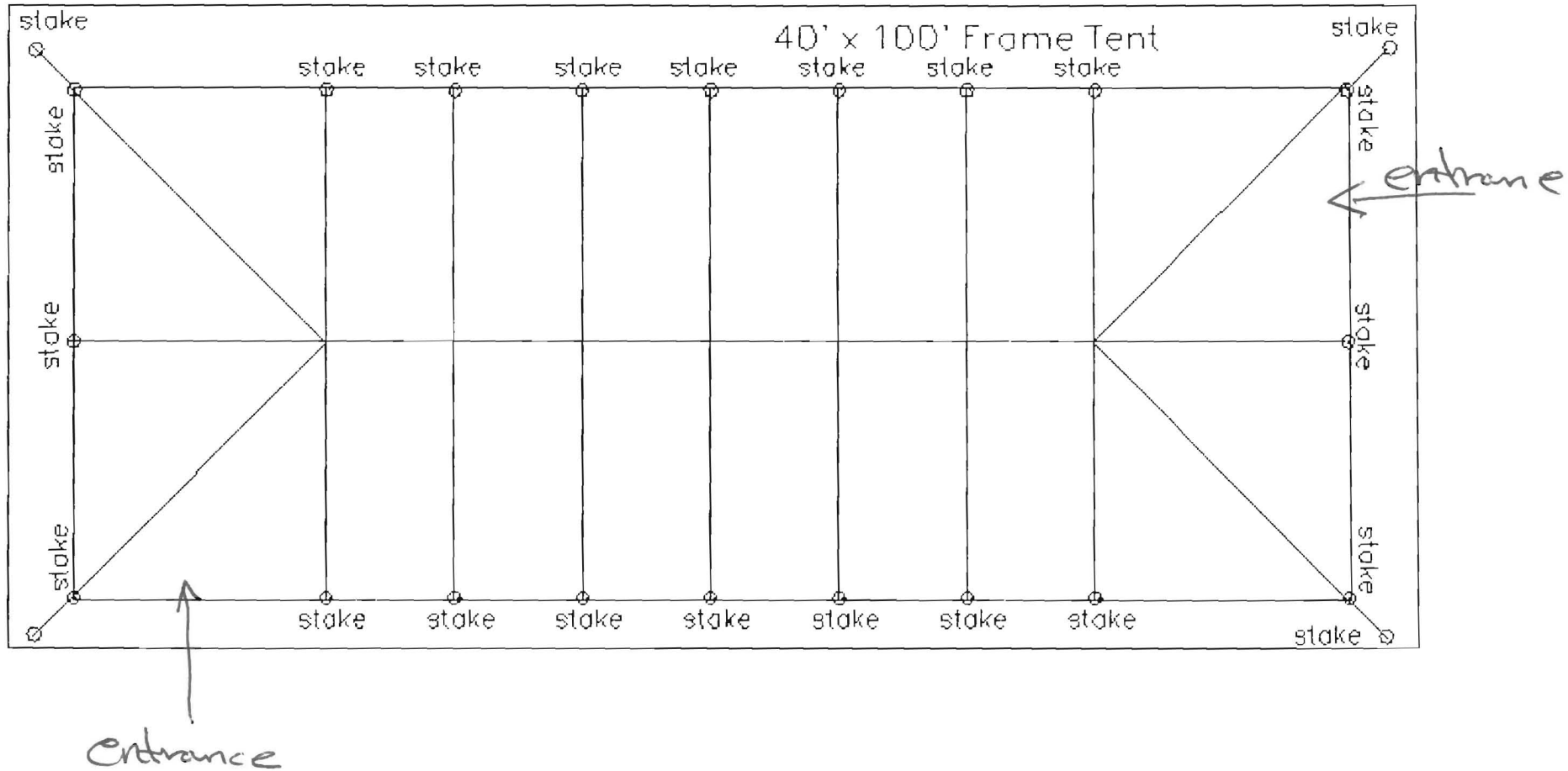

April 10, 2011

To Whom It May Concern:

I, Mary T. Boylan, do hereby give permission for a tent to be erected on my property located at 104 Willis Street, Great Diamond Island, Portland, Maine for an August 20, 2011 wedding.

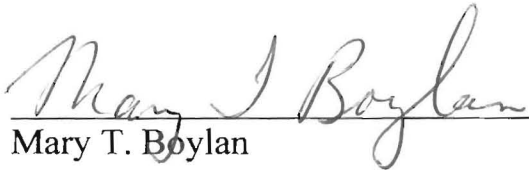
Mary T. Boylan



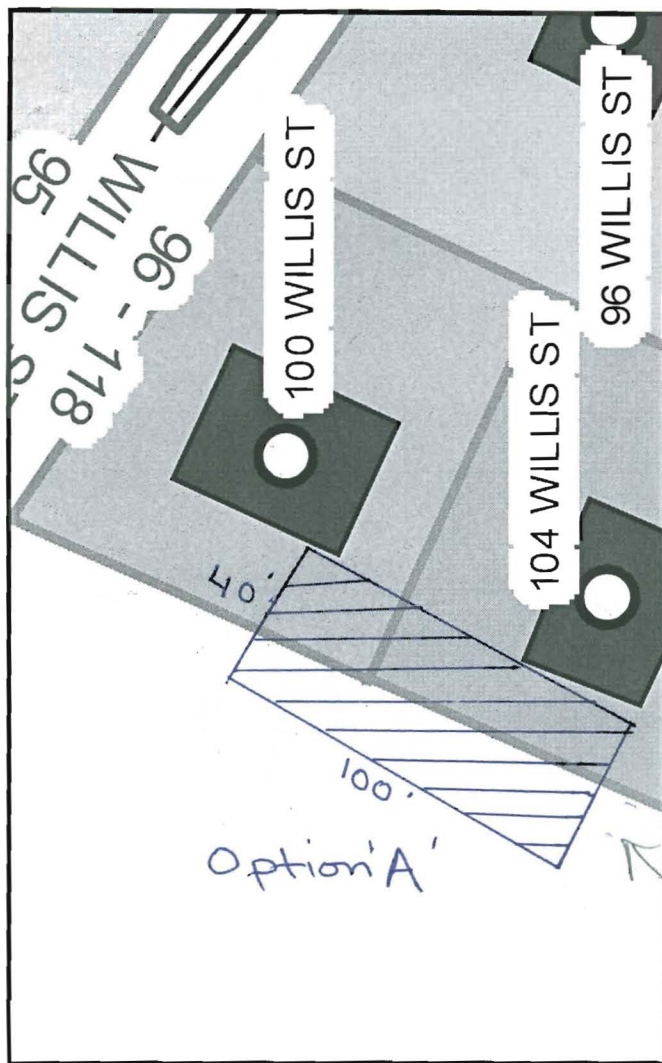

1" = 50'
per owner

Not on IC
either
property

Map

Protective
Bluffs

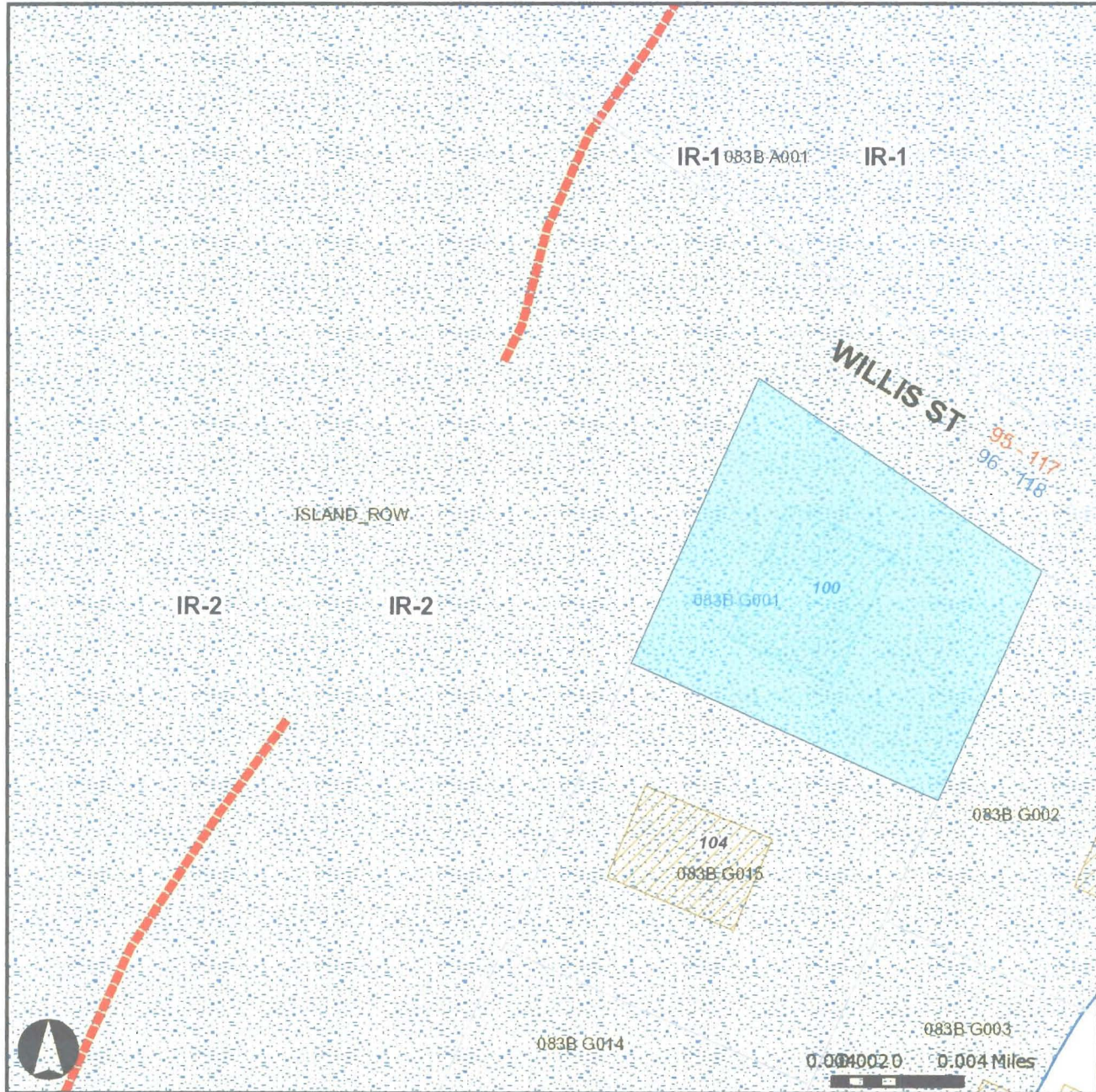

Parcels	Stream Overlay Zone	Zoning (continued)	Zoning (continued)
	Stream_protection	R4 Residential	C29
Parcels	Island Zoning	R5 Residential	C30
	C43	R6 Residential	C31
Interstate	I-B	ROS Recreation Open	none
	I-TS	Space	B2c
Streets	I-R1	RP Residential	C32
	I-R2	Professional	C33
Buildings			

Certificate of Flame Resistance



REGISTERED
FABRIC
NUMBER

F53501

Issued by

TOPTEC, INC.
1905 N.E. Main Street
Simpsonville, SC 29681

Date Manufactured

01/06/05

***This is to certify that the materials described
are inherently flame retardant.***

Name OEN STOP PARTY SHOP

Address 262 MAIN ST

City S PORTLAND

State ME

Zip 04106

Certification is hereby made that:

The articles described are flame-retardant, approved and registered by the State Fire Marshal and that the fabric is in conformance with the laws of the State of California and the Rules and Regulations of the State Fire Marshal. Fabric has been tested and passes NFPA701-96, CPAI84, ULC109, MVSS302.

Method of Application: The Flame Retardency of this Fabric is Inherent and Permanent.

Description of item certified: FRAME 20x20 BLACKOUT WHITE

The Flame Retardant Process Used WILL NOT Be Removed By Washing.

TOPTEC, INC.

Name of Production Superintendent

MODEL TTF202005

SERIAL # 251129B



CERTIFICATE OF LIABILITY INSURANCE

DATE (MM/DD/YYYY)
04/20/2011

THIS CERTIFICATE IS ISSUED AS A MATTER OF INFORMATION ONLY AND CONFERS NO RIGHTS UPON THE CERTIFICATE HOLDER. THIS CERTIFICATE DOES NOT AFFIRMATIVELY OR NEGATIVELY AMEND, EXTEND OR ALTER THE COVERAGE AFFORDED BY THE POLICIES BELOW. THIS CERTIFICATE OF INSURANCE DOES NOT CONSTITUTE A CONTRACT BETWEEN THE ISSUING INSURER(S), AUTHORIZED REPRESENTATIVE OR PRODUCER, AND THE CERTIFICATE HOLDER.

IMPORTANT: If the certificate holder is an ADDITIONAL INSURED, the policy(ies) must be endorsed. If SUBROGATION IS WAIVED, subject to the terms and conditions of the policy, certain policies may require an endorsement. A statement on this certificate does not confer rights to the certificate holder in lieu of such endorsement(s).

PRODUCER CUSTOMER SERVICE 1-800-423-0567	CONTACT NAME:		
	PHONE (A/C, No., Ext.)	FAX (A/C, No.)	
E-MAIL ADDRESS:			
PRODUCER CUSTOMER ID#:			
INSURED SMITH, GARY & JEANNE 100 WILLIS ST GREAT DIAMOND ISLAND ME 04109-	INSURER(S) AFFORDING COVERAGE		NAIC #
	INSURER A: HARTFORD UNDERWRITERS INSURANCE COMPANY		30104
	INSURER B:		
	INSURER C:		
	INSURER D:		
	INSURER E:		
INSURER F:			

COVERAGES CERTIFICATE NUMBER: REVISION NUMBER:

THIS IS TO CERTIFY THAT THE POLICIES OF INSURANCE LISTED BELOW HAVE BEEN ISSUED TO THE INSURED NAMED ABOVE FOR THE POLICY PERIOD INDICATED. NOTWITHSTANDING ANY REQUIREMENT TERM OR CONDITION OF ANY CONTRACT OR OTHER DOCUMENT WITH RESPECT TO WHICH THIS CERTIFICATE MAY BE ISSUED OR MAY PERTAIN. THE INSURANCE AFFORDED BY THE POLICIES DESCRIBED HEREIN IS SUBJECT TO ALL THE TERMS, EXCLUSIONS AND CONDITIONS OF SUCH POLICIES. LIMITS SHOWN MAY HAVE BEEN REDUCED BY PAID CLAIMS.

INSR LTR	TYPE OF INSURANCE	ADOL INSR	SUBR WVD	POLICY NUMBER	POLICY EFF (MM/DD/YYYY)	POLICY EXP (MM/DD/YYYY)	LIMITS
	GENERAL LIABILITY <input type="checkbox"/> COMMERCIAL GENERAL LIABILITY <input type="checkbox"/> CLAIMS-MADE <input type="checkbox"/> OCCUR GENL AGGREGATE LIMIT APPLIES PER: <input type="checkbox"/> POLICY <input type="checkbox"/> PRO-JECT <input type="checkbox"/> LOC						EACH OCCURRENCE \$ DAMAGE TO RENTED PREMISES (Ea occurrence) \$ MED EXP (Any one person) \$ PERSONAL & ADV INJURY \$ GENERAL AGGREGATE \$ PRODUCTS - COMP/OP ASG \$
	AUTOMOBILE LIABILITY <input type="checkbox"/> ANY AUTO <input type="checkbox"/> ALL OWNED AUTOS <input type="checkbox"/> SCHEDULED AUTOS <input type="checkbox"/> HIRED AUTOS <input type="checkbox"/> NON-OWNED AUTOS						COMBINED SINGLE LIMIT (Ea accident) \$ BODILY INJURY (Per person) \$ BODILY INJURY (Per accident) \$ PROPERTY DAMAGE (Per accident) \$ \$ \$
	UMBRELLA LIAB <input type="checkbox"/> OCCUR EXCESS LIAB <input type="checkbox"/> CLAIMS-MADE DEDUCTIBLE RETENTION \$						EACH OCCURRENCE \$ AGGREGATE \$ \$ \$
	WORKERS COMPENSATION AND EMPLOYERS LIABILITY ANY PROPRIETOR/PARTNER/EXECUTIVE OFFICER/MEMBER EXCLUDED? (Mandatory in NH) If yes, describe under DESCRIPTION OF OPERATIONS below	Y/N	N/A				WC STATUTORY LIMITS OTH-ER E.L EACH ACCIDENT \$ E.L DISEASE - EA EMPLOYEE \$ E.L DISEASE - POLICY LIMIT \$
X	COMPREHENSIVE PERSONAL LIABILITY			55RBD152228	09/05/2010	09/05/2011	PERSONAL LIABILITY \$400,000 MEDICAL PAYMENT \$ 2,000

DESCRIPTION OF OPERATIONS / LOCATIONS / VEHICLES (Attach ACORD 101, Additional Remarks Schedule, if more space is required)
PROOF OF LIABILITY

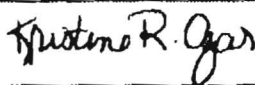
CERTIFICATE HOLDER CITY OF PORTLAND PO BOX 544 PORTLAND, ME 04112	CANCELLATION SHOULD ANY OF THE ABOVE DESCRIBED POLICIES BE CANCELLED BEFORE THE EXPIRATION DATE THEREOF, NOTICE WILL BE DELIVERED IN ACCORDANCE WITH THE POLICY PROVISIONS. AUTHORIZED REPRESENTATIVE 
---	---

Policy Summary »

MARY T BOYLAN
 TD INSURANCE INC
 POLICY NUMBER: 976935933 633 1

Homeowners Policy

Named Insured

MARY T BOYLAN
 140 CADMAN PLAZA W APT 25G
 BROOKLYN NY 11201

Your Agency's Name and Address

TD INSURANCE INC
 P O BOX 406
 PORTLAND, ME 04112

Your Policy Number: 976935933 633 1
 Your Account Number: 976935933

For Policy Service Call: 1-877-872-8737
 For Claim Service Call: 1-800-CLAIM33

Policy Period
 FROM: 07-01-10 To: 07-01-11 12:01 A.M.
 STANDARD TIME AT THE RESIDENCE PREMISES

Location of Residence Premises
 BAY AVENUE
 GREAT DIAMOND ISLAND ME 04109

Increase to Personal Liability

Section I - Property Coverages

- A - DWELLING
- B - OTHER STRUCTURES
- C - PERSONAL PROPERTY
- D - LOSS OF USE

Limits of Liability	Premium
\$ 164,000	\$ 388.00
16,400	INCL
90,200	8.00
32,800	INCL

Section II - Liability Coverages

- E - PERSONAL LIABILITY (BODILY INJURY AND PROPERTY DAMAGE) EACH OCCURRENCE
- F - MEDICAL PAYMENTS TO OTHERS-EACH PERSON

\$ 500,000	\$ 29.00
1,000	INCL

Policy Forms and Endorsements

- HO-3 (12-86) Homeowners 3 Special Form
- HA-300 ME (12-09) Special Provisions
- HO-208 (05-09) Water Backup Limited Coverage
- HO-827 (08-02) Limited Fungi, Other Microbes or Rot Remediation

\$ 5,000	\$ 50.00
----------	----------

\$	475.00
----	--------

Total Premium

Your Premium Reflects the Following Credits or State Surcharges

Security Credit

-11.00

Loss Free Credit

-90.00

Policy

Deductible: \$ 250.00 All perils insured against

In case of loss under section I, only that part of the loss over the stated deductible is covered.

First Mortgagee

COASTLINE CREDIT UNION ISAOA A
TIMA
333 COTTAGE ROAD
SOUTH PORTLAND ME 04106

Your Insurer: The Automobile Insurance Company of Hartford, Connecticut
One of The Travelers Property Casualty Companies
One Tower Square, Hartford, CT 06183

Online Policy Summary as of April 25, 2011

[Legal Notices](#)

©2010 The Travelers Indemnity Company. All rights reserved.

April 10, 2011

To Whom It May Concern:

We, Gary and Jeanne Smith, do hereby give permission for a tent to be erected on our property located at 100 Willis Street, Great Diamond Island, Portland, Maine for an August 20, 2011 wedding.

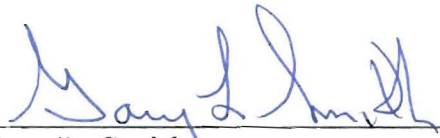

Gary L. Smith



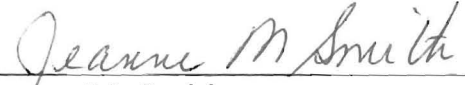

Jeanne M. Smith



Marge Schmuckal - Fw: tent permit for August wedding (Great Diamond Island)

From: "Gary L Smith" <gls101@myfairpoint.net>
To: <mes@portlandmaine.gov>
Date: 5/23/2011 11:57 AM
Subject: Fw: tent permit for August wedding (Great Diamond Island)

Marge,

I called Carol Merritt at PS's shortly after I received this email from Ted Musgrave. She told me at that time there would be no problem as far as she is concerned. I am sure you will verify that fact. The Digsafe folks have already been to the island and done their inspections. The Digsafe permit # is on the back of one the sheets I have provided you. I hope this helps. Thank you.

Gary

----- Original Message -----

From: Ted Musgrave
To: Gary L Smith
Cc: Carol Merritt ; Lannie Dobson ; Michael Bobinsky ; Marge Schmuckal ; Mike Murray ; Sally Deluca
Sent: Monday, April 04, 2011 5:33 PM
Subject: Re: tent permit for August wedding (Great Diamond Island)..?

hi gary -

for the proposed TENT...

1. you will need to contact Public Services (about use of the street and any charge thereof).. you can call Carol Merritt at PS's (874-8822)... she should be able to assist - or steer you in the right direction for review and approval

i have cc'ed carol on this email

2. For a TENT permit, you will need to contact Lannie Dobson at Inspections Services, 874-8693. you would also need to contact DIG SAFE (888-344-7233) to make sure there were no utilities underground (where the tent stakes will go)

i've cc'ed lannie on this as well

3. there would be no recreation permit fees required from the Rec Office

thanks... and i hope you have great weather for the wedding.....!!! best wishes.

>>> Ted Musgrave 4/4/2011 2:34 PM >>>

hi gary -

thanks for your email.

when i got your phone call, i put in a request to city staff.

i'm still waiting on advisement... but it shouldn't be long.

thanks for your patience. i'll be back to you shortly.

ted m. portland recreation

>>> "Gary L Smith" <gls101@myfairpoint.net> 4/4/2011 12:47 PM >>>

Ted,

My son is getting married on August 20th on Great Diamond Island. We will be putting up a tent for the reception. I live at 100 Willis St. and my mother-in-law lives at 104 Willis St. Our properties abut a paper street

called Bay Avenue. It is not an improved street and there is no vehicle traffic. It does not appear on the new 911 map for the island. We would like to put the tent partially on private property and partially on the paper street. Do you see any problem in doing so?

I got a permit application from Zoning and Inspections. I noticed there is a space for placing a tent on City owned property. At this point, we are not certain of the exact location of the tent. We have two possible scenarios, both would include putting the tent partially on Bay Ave. I will file the application if you don't see any red flags. Thank you.

Gary L Smith
766-3390



O
N
S
T
R
E
E
T

O
C
C
U
P
A
N
C
Y

P
E
R
M
I
T

ONE STOP PARTY SHO

PERMISSION IS GIVEN TO

1 Space **Tent**
NUMBER OF SPACE(S) TYPE OF VEHICLE

100-104 Willow St
LOCATION

GREAT DIAMOND ISLAND
COMMENTS

DATES
8/20/2011 to 8/20/2011

Michael J. Pollock
Director of Public Services

PERMIT NUMBER **27559**

REFER TO RULES ON REVERSE SIDE

P
E
R
M
I
T

M
U
S
T

B
E

H
U
N
G

F
R
O
M

R
E
A
R

V
I
E
W

M
I
R
R
O
R

RECEIVED

MAY 24 2011

Dept. of Building Inspections
City of Portland Maine



CITY OF PORTLAND, MAINE

Receipt

RECEIPT FOR PERMIT TO OCCUPY LEGAL PARKING SPACE(S)

NO REFUNDS

Permit #: 27559

Date: 05/24/2011

Permit Date(s): 8/20/2011 to 8/20/2011

Permission is hereby given to: ONE STOP PARTY SHOP

To occupy: 1 Space in front of 100-104 Willow St

Types of Vehicle(s): Tent

Special Instruction(s): GREAT DIAMOND ISLAND

**SAFE TO PEDESTRIANS WITH SPECIAL CARE BEING TAKEN TO KEEP
THE SIDEWALK AND GUTTER CLEAR OF OBSTRUCTIONS.**

**Persons violating the provisions of this permit or City ordinance may
be subject to a minimum fine of \$50.00**

Amount: \$10.00 Payment Type: Check #:

Tel. #: (207) 671-2595

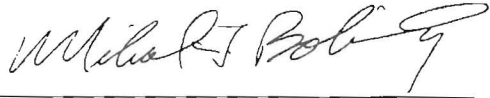
Approved: 

RECEIVED

MAY 24 2011

**Dept. of Building Inspections
City of Portland Maine**

Certificate of Flame Resistance



REGISTERED
FABRIC
NUMBER

F53501

Issued by

TOPTEC, INC.
1905 N.E. Main Street
Simpsonville, SC 29681

Date Manufactured

03/20/03

*This is to certify that the materials described
are inherently flame retardant.*

Name ONE-STOP PARTY SHOP

Address 262 MAIN ST

City S PORTLAND

State ME

Zip 04106

Certification is hereby made that:

The articles described are flame-retardant, approved and registered by the State Fire Marshal and that the fabric is in conformance with the laws of the State of California and the Rules and Regulations of the State Fire Marshal. Fabric has been tested and passes NFPA701-96, CPAI84, ULC109, MVSS302.

Method of Application: _____

Description of item certified: FUTURE MID 40x10 BLACKOUT WHITE

The Flame Retardant Process Used WILL NOT Be Removed By Washing.

TOPTEC, INC.



Name of Production Superintendent

MODEL TU401005C

SERIAL # 231768B

Certificate of Flame Resistance



REGISTERED
FABRIC
NUMBER

F53501

Issued by

TOPTEC, INC.
1905 N.E. Main Street
Simpsonville, SC 29681

Date Manufactured

04/01/05

*This is to certify that the materials described
are inherently flame retardant.*

Name ONE STOP PARTY SHOP

Address 262 MAIN ST

City S PORTLAND

State ME

Zip 04106

Certification is hereby made that:

The articles described are flame-retardant, approved and registered by the State Fire Marshal and that the fabric is in conformance with the laws of the State of California and the Rules and Regulations of the State Fire Marshal. Fabric has been tested and passes NFPA701-96, CPAI84, ULC109, MVSS302.

Method of Application: The Flame Retardency of this Fabric is Inherent and Permanent.

Description of item certified: FUTURE MID 40x10 BLACKOUT WHITE

The Flame Retardant Process Used WILL NOT Be Removed By Washing.

TOPTEC, INC.

Name of Production Superintendent

MODEL TU401005C

SERIAL # 252011B

Certificate of Flame Resistance



REGISTERED
FABRIC
NUMBER

F53501

Issued by

TOPTEC, INC.
1905 N.E. Main Street
Simpsonville, SC 29681

Date Manufactured

04/01/05

*This is to certify that the materials described
are inherently flame retardant.*

Name ONE STOP PARTY SHOP

Address 262 MAIN ST

City S PORTLAND

State ME

Zip 04106

Certification is hereby made that:

The articles described are flame-retardant, approved and registered by the State Fire Marshal and that the fabric is in conformance with the laws of the State of California and the Rules and Regulations of the State Fire Marshal. Fabric has been tested and passes NFPA701-96, CPAI84, ULC109, MVSS302.

Method of Application: The Flame Retardency of this Fabric is Inherent and Permanent.

Description of item certified: FUTURE MID 40x10 BLACKOUT WHITE

The Flame Retardant Process Used WILL NOT Be Removed By Washing.

TOPTEC, INC.

Name of Production Superintendent

MODEL TU401005C

SERIAL # 252012B

Certificate of Flame Resistance



REGISTERED
FABRIC
NUMBER

F53501

Issued by

TOPTEC, INC.
1905 N.E. Main Street
Simpsonville, SC 29681

Date Manufactured

04/01/05

*This is to certify that the materials described
are inherently flame retardant.*

Name ONE STOP PARTY SHOP

Address 262 MAIN ST

City S PORTLAND

State ME

Zip 04106

Certification is hereby made that:

The articles described are flame-retardant, approved and registered by the State Fire Marshal and that the fabric is in conformance with the laws of the State of California and the Rules and Regulations of the State Fire Marshal. Fabric has been tested and passes NFPA701-96, CPAI84, ULC109, MVSS302.

Method of Application: The Flame Retardency of this Fabric is Inherent and Permanent.

Description of item certified: FUTURE MID 40x10 BLACKOUT WHITE

The Flame Retardant Process Used WILL NOT Be Removed By Washing.

TOPTEC, INC.

Name of Production Superintendent

MODEL TU401005C

SERIAL # 252013B

Certificate of Flame Resistance



REGISTERED
FABRIC
NUMBER

F53501

Issued by

TOPTEC, INC.
1905 N.E. Main Street
Simpsonville, SC 29681

Date Manufactured

04/01/05

*This is to certify that the materials described
are inherently flame retardant.*

Name ONE STOP PARTY SHOP

Address 262 MAIN ST

City S PORTLAND

State ME

Zip 04106

Certification is hereby made that:

The articles described are flame-retardant, approved and registered by the State Fire Marshal and that the fabric is in conformance with the laws of the State of California and the Rules and Regulations of the State Fire Marshal. Fabric has been tested and passes NFPA701-96, CPAI84, ULC109, MVSS302.

Method of Application: The Flame Retardency of this Fabric is Inherent and Permanent.

Description of item certified: FUTURE MID 40x10 BLACKOUT WHITE

The Flame Retardant Process Used WILL NOT Be Removed By Washing.

TOPTEC, INC.

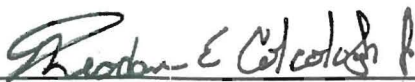
Name of Production Superintendent

MODEL TU401005C

SERIAL # 252010B