

SUBSURFACE WASTEWATER DISPOSAL SYSTEM APPLICATION

Maine Department of Human Services
 Division of Health Engineering, Station 10 SHS
 (207) 287-5672 FAX (207) 287-4172

Town, City, Plantation
PORTLAND, GREAT DIAMOND ISLAND

Street, Road, Subdivision
24 MEADOW ROAD

Owner's Name
N/F ROBERT JORDAN

SUBSURFACE WASTEWATER DISPOSAL PLAN

SCALE 1" = 20' FT.

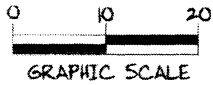

NOTE: THOROUGHLY SCARIFY UNDER ENTIRE DISPOSAL FIELD, SHOULDER AREA, & FILL EXTENSION AREA PRIOR TO FILL PLACEMENT, THEN BLEND FIRST 6" LIFT OF FILL INTO EXISTING SOIL SURFACE TO PROMOTE MIXING

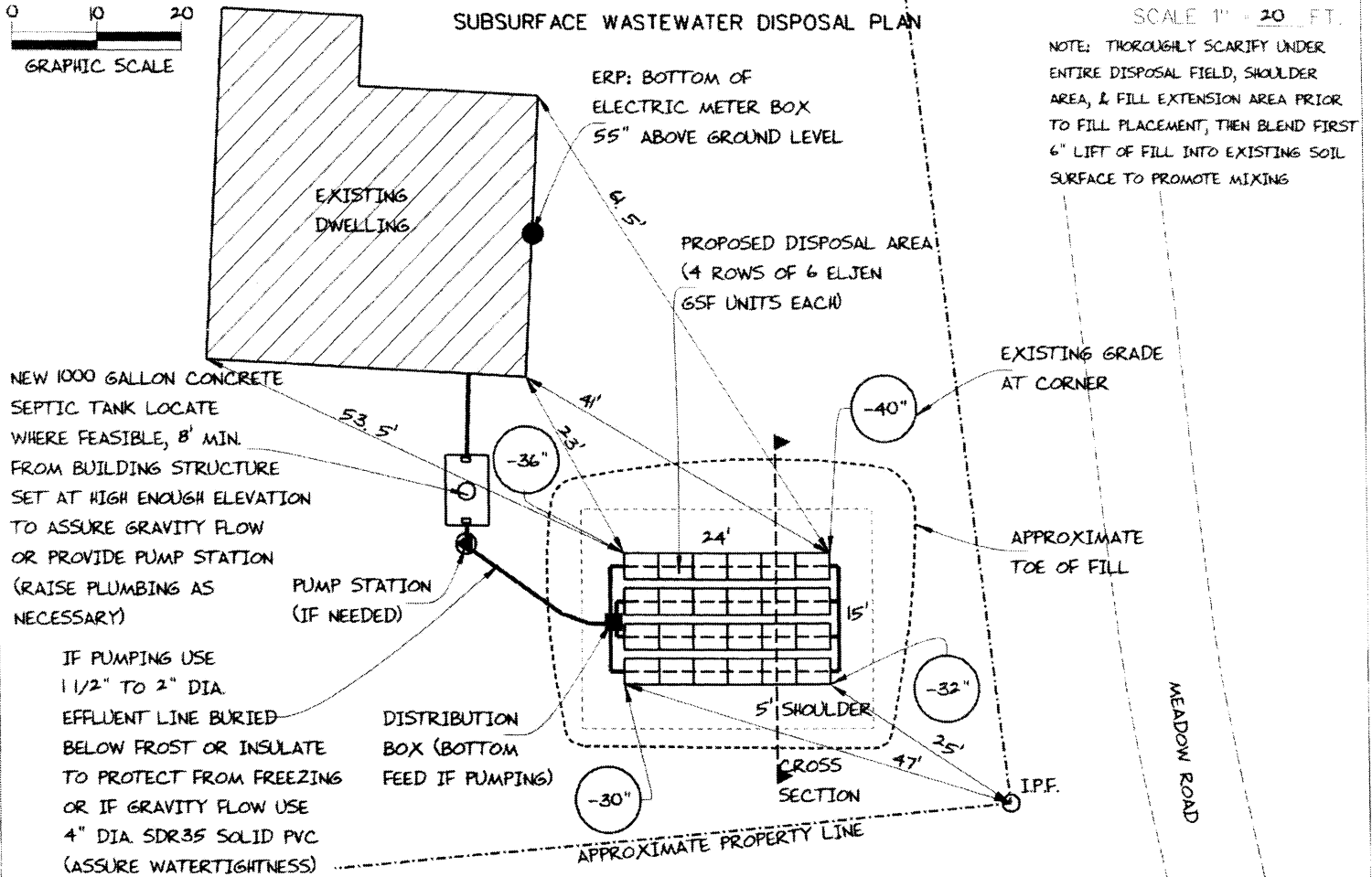

FILL REQUIREMENTS

Depth of Fill (Upslope) : 5" - 7"
 Depth of Fill (Downslope) : 11" - 15"
 DEPTHS AT CROSS-SECTION (shown below)

CONSTRUCTION ELEVATIONS

Finished Grade Elevation
 Top of Distribution Pipe or Proprietary Device
 Bottom of Disposal Area

ELEVATION REFERENCE POINT

SEE DETAIL BELOW
 Location & Description BOTTOM OF ELECTRIC METER BOX, 55" ABOVE GRADE
 Reference Elevation is: 0.0" or -----

SCALE:
 VERTICAL: 1" = 5 FT
 HORIZONTAL: 1" = 10 FT

DISPOSAL AREA CROSS SECTION

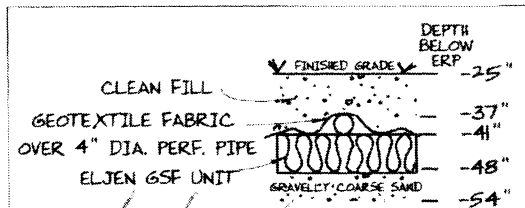
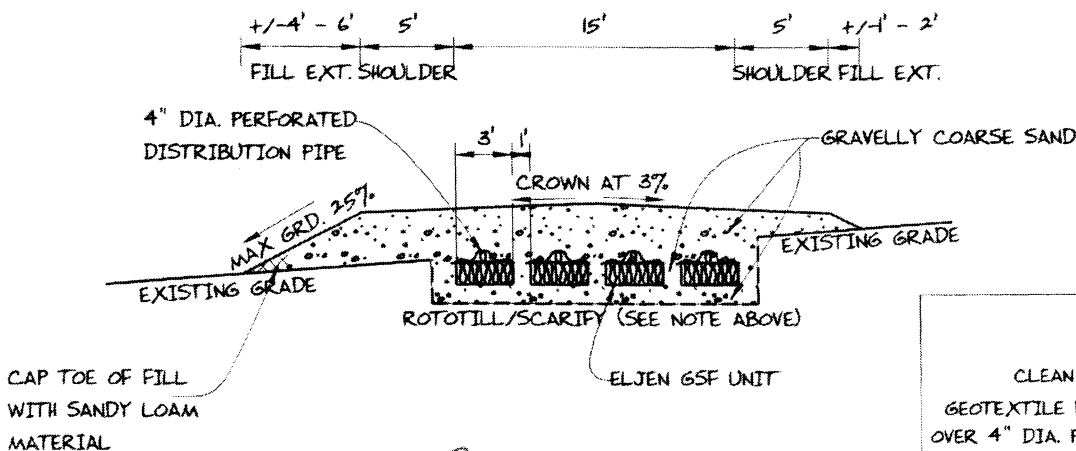

Albert Frick
 Site Evaluator Signature

163
 SE *

9/25/2014
 Date