

City of Portland, Maine - Building or Use Permit Application

389 Congress Street, 04101 Tel: (207) 874-8703, Fax: (207) 874-8716

Permit No: 06-0913	Issue Date:	CBL: 082 D012001
-----------------------	-------------	---------------------

Location of Construction: 19 ST GEORGE ST	Owner Name: FREEMAN ANNA J	Owner Address: 19 ST GEORGE ST	Phone: 9852300
Business Name:	Contractor Name: MWS, Inc.	Contractor Address: 71 Portland Rd. Kennebunk	Phone: 9852300
Lessee/Buyer's Name	Phone:	Permit Type: Additions - Dwellings	Zone: R-5

PERMIT ISSUED
AUG 14 2009
CITY OF PORTLAND

Past Use: Single Family	Proposed Use: Single Family Prefab Patio room and new deck	Permit Fee: \$237.00	Cost of Work: \$24,000.00	CEO District: 3	Zone: R-5
----------------------------	---	-------------------------	------------------------------	--------------------	--------------

FIRE DEPT: <input type="checkbox"/> Approved <input checked="" type="checkbox"/> Denied <i>N/A</i>	INSPECTION: Use Group: R-3 Type: SB IRC 2003 <i>[Signature]</i>
Signature:	Signature:

Proposed Project Description:
Prefab Patio room and new deck

PEDESTRIAN ACTIVITIES DISTRICT (P.A.D.)

Action: Approved Approved w/Conditions Denied

Signature: _____ Date: _____

Permit Taken By: dmartin	Date Applied For: 06/19/2006	Zoning Approval
-----------------------------	---------------------------------	------------------------

<p>1. This permit application does not preclude the Applicant(s) from meeting applicable State and Federal Rules.</p> <p>2. Building permits do not include plumbing, septic or electrical work.</p> <p>3. Building permits are void if work is not started within six (6) months of the date of issuance. False information may invalidate a building permit and stop all work..</p>	<p>Special Zone or Reviews</p> <p><input type="checkbox"/> Shoreland</p> <p><input type="checkbox"/> Wetland</p> <p><input type="checkbox"/> Flood Zone</p> <p><input type="checkbox"/> Subdivision</p> <p><input type="checkbox"/> Site Plan</p> <p>Maj <input type="checkbox"/> Minor <input type="checkbox"/> MM <input type="checkbox"/></p> <p><i>ok with conditions</i> Date: <i>9/7/10/06</i></p>	<p>Zoning Appeal</p> <p><input type="checkbox"/> Variance</p> <p><input type="checkbox"/> Miscellaneous</p> <p><input type="checkbox"/> Conditional Use</p> <p><input type="checkbox"/> Interpretation</p> <p><input type="checkbox"/> Approved</p> <p><input type="checkbox"/> Denied</p> <p>Date: _____</p>	<p>Historic Preservation</p> <p><input checked="" type="checkbox"/> Not in District or Landmark</p> <p><input type="checkbox"/> Does Not Require Review</p> <p><input type="checkbox"/> Requires Review</p> <p><input type="checkbox"/> Approved</p> <p><input type="checkbox"/> Approved w/Conditions</p> <p><input type="checkbox"/> Denied</p> <p>Date: <i>[Signature]</i></p>
---	---	--	--

CERTIFICATION

I hereby certify that I am the owner of record of the named property, or that the proposed work is authorized by the owner of record and that I have been authorized by the owner to make this application as his authorized agent and I agree to conform to all applicable laws of this jurisdiction. In addition, if a permit for work described in the application is issued, I certify that the code official's authorized representative shall have the authority to enter all areas covered by such permit at any reasonable hour to enforce the provision of the code(s) applicable to such permit.

8-16-08 + Sonar tube holes dug at least 48" measured preplacement, tubes at 12" IN from front dimension. Conversation with contractor that tubes must be poured at the 12" ^{Center} distance from outside dimension. Asked contractor to correct tube location right front: it minimum 12" ^{Center} from outside rim 651-7741. If went back and told contractor that tubes must be centered over the posts ~~posts~~. No ~~check~~ rcheck. Called Conroy 286-8041 to let them know - No to SMH

8.24. Checked Set back - question regarding if ^{5'11"} sonar tube required on 23 foot size.

Checked span tables - will need The 2-2x10 Beam on both ends of 21' Bldg width or middle sona tubes on both. - called Sara @ MWS to inform JMB

10/2/06 Met Rick - steps & rails ok

- 2-2x10 ~~at~~ Rear needs solid blocking @ 16" OC for Roof Load

- need to add 2-2x8 to driveway end Roof load for a total of (4) at deck level. JMB

Also check about screen porch Guard protection

* Screen not required to be protected - This is 1st a window That meets tempered glazing - Not to be viewed as a guard. JMB

DISPLAY THIS CARD ON PRINCIPAL FRONTAGE OF WORK

CITY OF PORTLAND

Please Read
Application And
Notes, If Any,
Attached

BUILDING INSPECTION

PERMIT

Permit Number: 060913

This is to certify that FREEMAN ANNA J / MWS c.has permission to Prefab Patio room and newAT 49 ST GEORGE ST

082 D012001

provided that the person or persons firm or person accepting this permit shall comply with all of the provisions of the Statutes of Maine and of the Ordinances of the City of Portland regulating the construction, maintenance and use of buildings and structures, and of the application of the in this department.

PERMIT ISSUED

AUG 14 2006

CITY OF PORTLAND

Apply to Public Works for street line and grade if nature of work requires such information.

ification of inspection must be
en and when permission proce
ore this building or part there
ed or require closed-in
OUR NOTICE REQUIRED.

A certificate of occupancy must be procured by owner before this building or part thereof is occupied.

OTHER REQUIRED APPROVALS

Fire Dept. _____

Health Dept. _____

Appeal Board _____

Other _____

Department Name

 Director Building & Inspection Services
 8/11/06

PENALTY FOR REMOVING THIS CARD

City of Portland, Maine - Building or Use Permit

389 Congress Street, 04101 Tel: (207) 874-8703, Fax: (207) 874-8716

Permit No: 06-0913	Date Applied For: 06/19/2006	CBL: 082 D012001
-----------------------	---------------------------------	---------------------

Location of Construction: 19 ST GEORGE ST	Owner Name: FREEMAN ANNA J	Owner Address: 19 ST GEORGE ST	Phone:
Business Name:	Contractor Name: MWS, Inc.	Contractor Address: 71 Portland Rd. Kennebunk	Phone (207) 985-2300
Lessee/Buyer's Name	Phone:	Permit Type: Additions - Dwellings	

Proposed Use: Single Family Prefab Patio room and new deck	Proposed Project Description: Prefab Patio room and new deck
---	---

Dept: Zoning Status: Approved with Conditions Reviewer: Marge Schmuckal Approval Date: 07/10/2006

Note: Ok to Issue:

- 1) This permit is being approved on the basis of plans submitted. Any deviations shall require a separate approval before starting that work.
- 2) This property shall remain a single family dwelling. Any change of use shall require a separate permit application for review and approval.
- 3) Separate permits shall be required for future decks, sheds, pools, and/or garages.
- 4) This is NOT an approval for an additional dwelling unit. You SHALL NOT add any additional kitchen equipment including, but not limited to items such as stoves, microwaves, refrigerators, or kitchen sinks, etc. Without special approvals.

Dept: Building Status: Approved Reviewer: Tammy Munson Approval Date: 08/11/2006

Note: Ok to Issue:

Comments:

8/7/06-tmm: need detail on side landing and stairs, is the existing deck structurally adequate?, need copy of product info for which room is going in. left message w/MWS.

8/11/06-tmm: ok to issue - rec'd info



Delete Schedule Add Find Print Permit Print C of O Print Insp Invoicing Taxes Due Close

Prmt Text93 11956 Constr Type New Num1 60913

Permit Nbr 06-0913 Location of Construction 19 ST GEORGE ST Appl. Date 06/19/2006
Status Hold Permit Type Additions - Dwellings Issue Date
CBL 082 D012001 District Nbr 3 Estimated Cost \$24,000.00 Date Closed

Comment Date	Comment	Add	Delet	Save	Print
08/07/200	need detail on side landing and stairs, is the existing deck structurally adequate?, need copy of product info for which room is going in. left message w/MWS.				
	Name tmm		Follow Up Date		Completed <input type="checkbox"/>

CreatedBy dmartin CreateDate 06/22/2006 ModBy tmm ModDate 08/07/2006
Time 9:55 AM Time 10:23 AM

Portland, ME

All Purpose Building Permit Application

If you or the property owner owes real estate or personal property taxes or user charges on any property within the City, payment arrangements must be made before permits of any kind are accepted.

Location/Address of Construction: <u>19 St. George Street</u>		
Total Square Footage of Proposed Structure		Square Footage of Lot
Tax Assessor's Chart, Block & Lot Chart# Block# Lot# <u>82</u> <u>D</u> <u>012</u>	Owner: <u>Anna Freeman</u>	Telephone: <u>774-8902</u>
Lessee/Buyer's Name (If Applicable)	Applicant name, address & telephone: <u>Maine Window + Sunroom</u> <u>91 Industrial Park Rd.</u> <u>Saco, ME 04072</u>	Cost Of Work: \$ <u>24,000.00</u> Fee: \$ <u>237.00</u>
Current use: <u>Single family</u> tel: <u>985-2300 x214</u>		
If the location is currently vacant, what was prior use: _____		
Approximately how long has it been vacant: _____		
Proposed use: <u>Single family w/ Patio Room Addition</u>		
Project description: <u>Addition of 316 sq. ft. patio room on a new PT deck measuring 121 sq. ft and a new open deck measuring 2 x 3.</u>		
Contractor's name, address & telephone: <u>Maine Window + Sunroom</u> <u>91 Industrial Park Rd, Saco, ME 04072</u> tel: <u>985-2300 x214</u>		
Who should we contact when the permit is ready: <u>Joyce Dancause</u>		
Mailing address: <u>91 Industrial Park Rd, Saco, ME 04072</u>		
We will contact you by phone when the permit is ready. You must come in and pick up the permit and review the requirements before starting any work, with a Plan Reviewer. A stop work order will be issued and a \$100.00 fee if any work starts before the permit is picked up. PHONE: <u>985-2300 x214</u>		

IF THE REQUIRED INFORMATION IS NOT INCLUDED IN THE SUBMISSIONS THE PERMIT WILL BE AUTOMATICALLY DENIED AT THE DISCRETION OF THE BUILDING/PLANNING DEPARTMENT, WE MAY REQUIRE ADDITIONAL INFORMATION IN ORDER TO APPROVE THIS PERMIT.

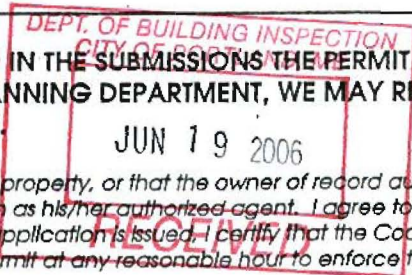

I hereby certify that I am the Owner of record of the named property, or that the owner of record authorizes the proposed work and that I have been authorized by the owner to make this application as his/her authorized agent. I agree to conform to all applicable laws of this jurisdiction. In addition, if a permit for work described in this application is issued, I certify that the Code Official's authorized representative shall have the authority to enter all areas covered by this permit at any reasonable hour to enforce the provisions of the codes applicable to this permit.

Signature of applicant: <u>Joyce Dancause, MWS, Inc</u>	Date: <u>6/12/06</u>
---	----------------------

This is NOT a permit, you may not commence ANY work until the permit is issued. If you are in a Historic District you may be subject to additional permitting and fees with the Planning Department on the 4th floor of City Hall

Plan View

Anna Freeman
19 St. George St.
Portland, ME

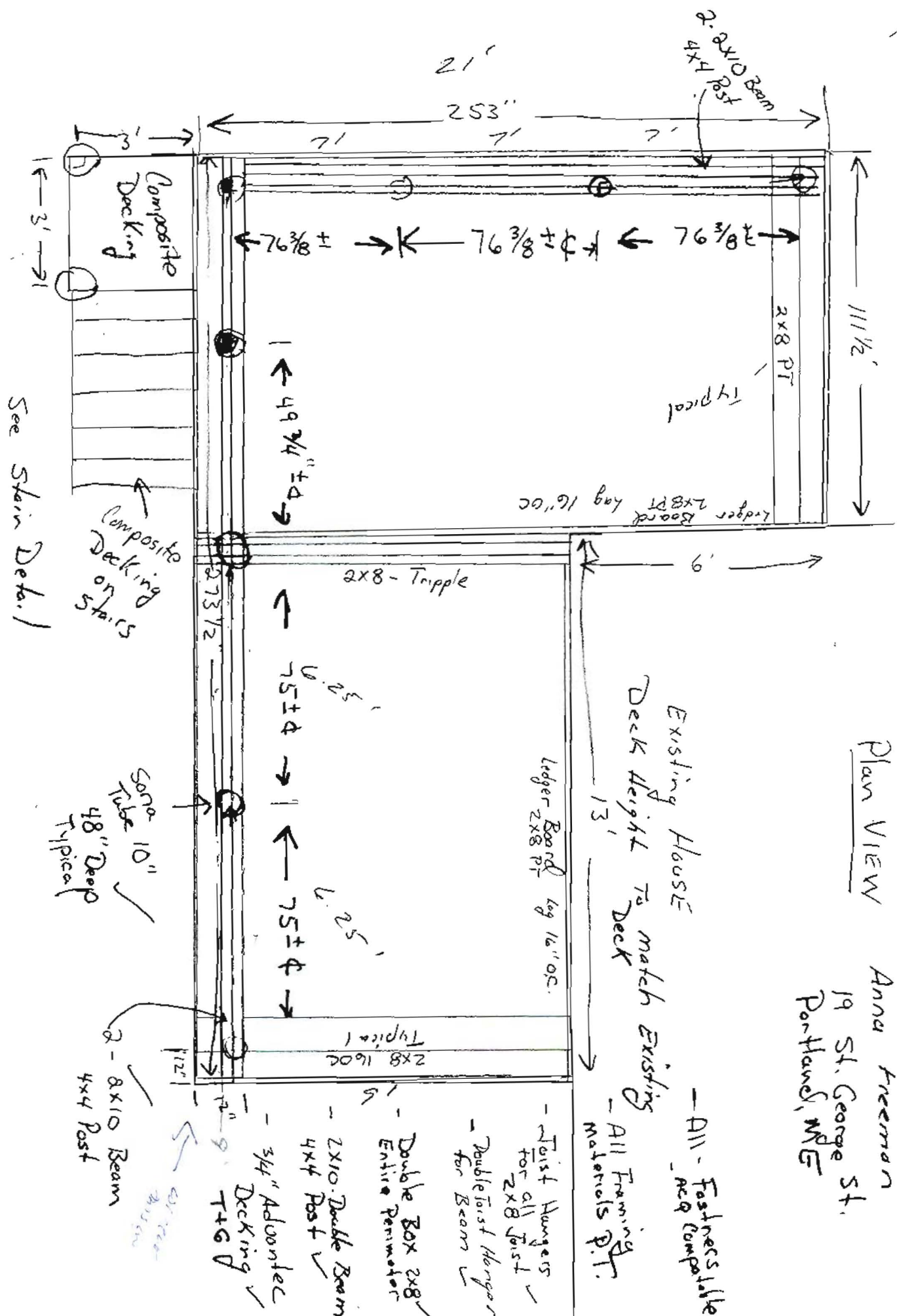



August 9, 2006

Ms. Tammy Munson
Code Enforcement Officer, Plan Reviewer
Planning & Development Department
Inspections Division
City of Portland
389 Congress St.
Portland, Maine 04101

Dear Ms. Munson,

The following packet contains the additional information you requested. I believe all the details you need are there. However, if I have omitted anything please call me and I will get it to you immediately.

I know you are extremely busy but any assistance you could give me on expediting this permit would be greatly appreciated. I have one irate customer on my hands.

Respectfully,

Don Hathorn
Installation Manager



Anna Freeman
19 St. George St.
Portland, ME

Installation Training Manual

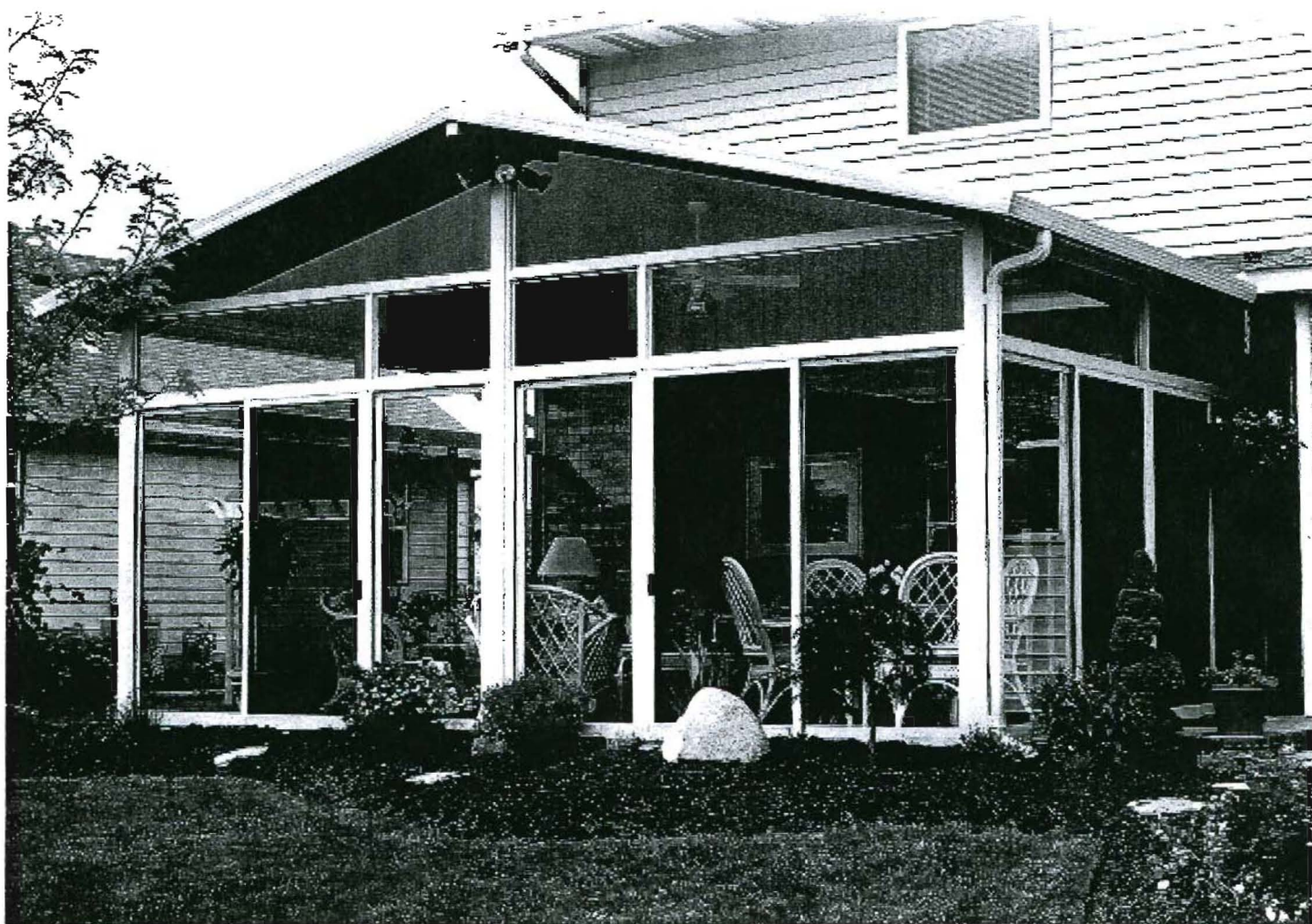

Craft-Bilt Manufacturing Company

Anna Freeman
 19 St. George St
 Portland, ME



Betterliving[®]
 PATIO ROOMS

WORKSHEET

- CUST. WANTS TO ATTEND REMEASURE: ALL MEASUREMENTS ARE APPROXIMATE
- GABLE GLASS:
- FAN WIRE IN BEAM:

A-FRAME ROOM

- D
GABLE HEIGHT
- A

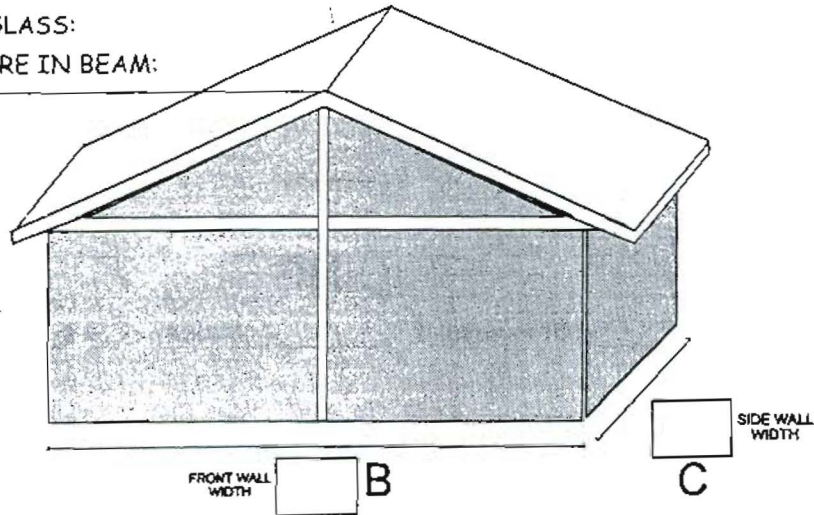

- CUST. WANTS TO ATTEND REMEASURE: ALL MEASUREMENTS ARE APPROXIMATE
- WING GLASS
- FAN MOUNT

STUDIO ROOM

- FRONT WALL HEIGHT
A

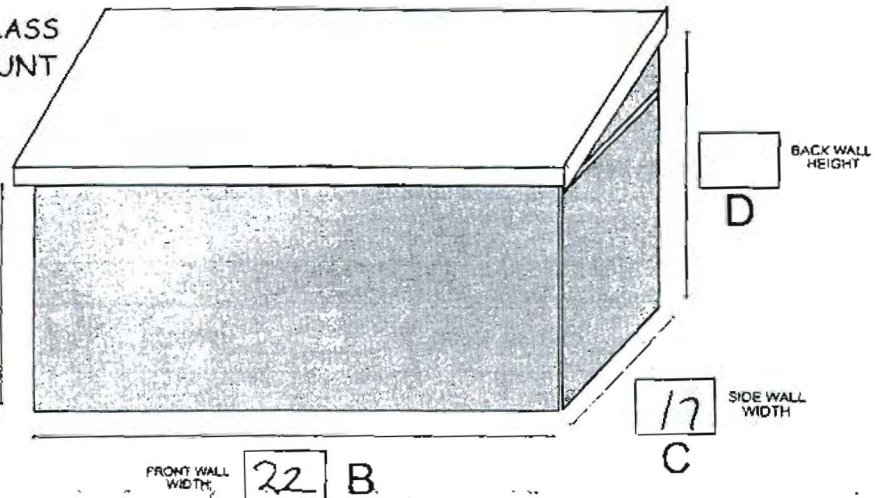

ANNA FREEMAN
19 St. George St.
Portland, ME

STAIR
Detail

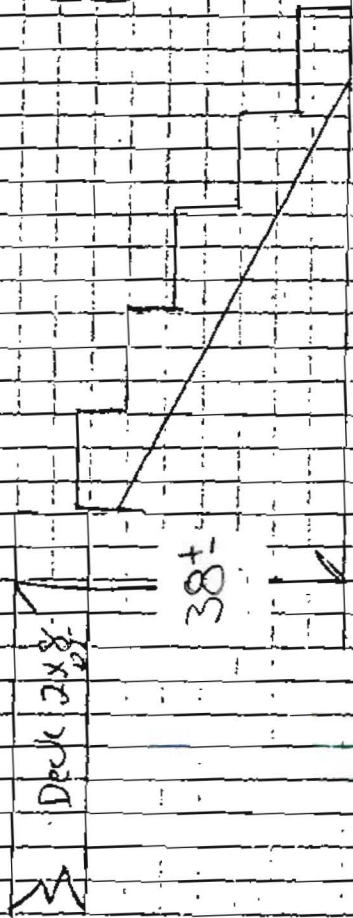

Not
Drawn
to
Scale

Risers = 7 1/2"

Treads = 11"

Stringer cut out of 2x12 pt

Risers will be covered with 1x8 pt

Treads will be 1 5/8" x 6" Decking Boards

6 Foot Railing Section Information

7/8" X 1 1/2" Spindle size

3' High Rail Section

3 1/2" Spindle Spacing

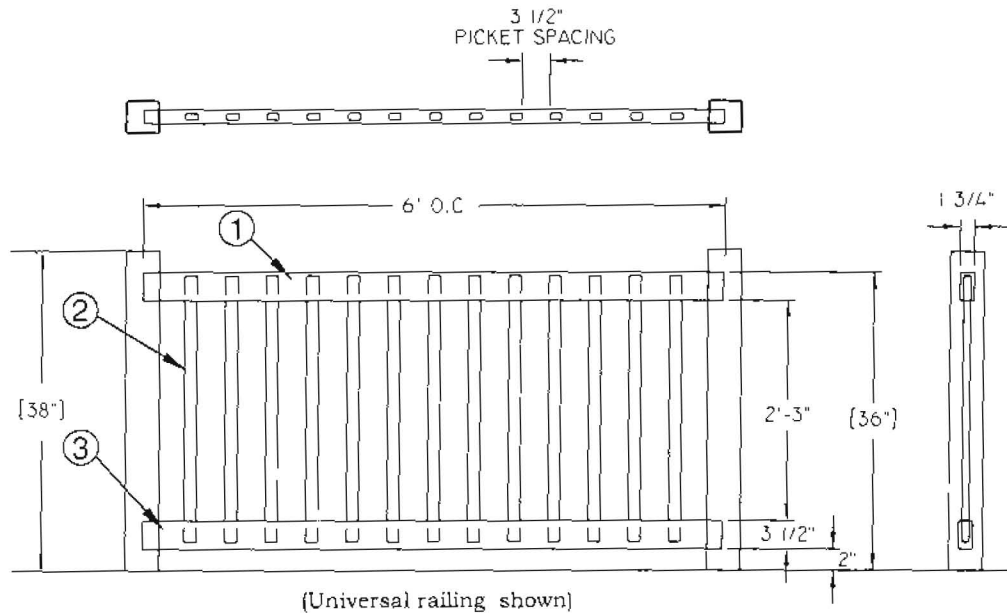

TYPICAL 6 FOOT RAIL SECTION:

- ① (1) TOP RAIL OPTIONS
 * Routed at 3 1/2" spacing
 6 ft routed Universal Rail (Part# 26-RPL6-01)
 6 ft routed Universal Rail (Part# 26-RPL6-V5)
- ② (13) 7/8"x 1 1/2" SPINDLE OPTIONS
 31" Rectangular Spindle (Part# 26-0025-01)
 31" Rectangular Spindle (Part# 26-0025-V5)
 33" Rectangular Spindle (Part# 26-0026-01)
 33" Rectangular Spindle (Part# 26-0026-V5)
- ③ (1) BOTTOM RAIL OPTIONS
 * Routed at 3 1/2" spacing
 6 ft routed Universal Rail (Part# 26-RPL6-01)
 6 ft routed Universal Rail (Part# 26-RPL6-V5)

POST OPTIONS

- 3 ft. Turned Post (26-5210-01 or -V5)
- 3 ft. Routed Line Post (Part # varies by rail style)
- 3 ft. Routed End Post (Part # varies by rail style)
- 3 ft. Routed Corner Post (Part # varies by rail style)
- 3 ft. Blank Post (Part# 26-PD90-01 or -V5)

POST MOUNTING OPTIONS

- 30" Stainless Steel Post Mount (Part# 26-0043-00)
- Stainless Steel Turned Post Mount (Part# 26-5220-00)

RAIL MOUNTING OPTIONS

- External Mounting Bracket, Universal Rail (Part #26-0550-01)
- Alum. Internal Mounting Bracket, Universal Rail (Part #26-0530-00)

ADDITIONAL ACCESSORIES

- Alignment Pins (4 per bag) (Part # 23-PIN4-01)
- Dome Post Cap (Part # 23-9081-01)
- Flat Post Cap (Part # 23-9046-01)
- Gothic Post Cap (Part # 23-9041-01)
- New England Post Cap (Part # 23-9064-01)

OPTIONAL RAIL REINFORCEMENT CHANNELS

- Aluminum Rail Support, Universal Railing (Part# 23-AHR6-00)
- Aluminum Rail Support, Colonial and Contemporary Railing (Part# 26-ARR1-00)

NOTE:

Length of spindle varies with number of aluminum reinforcements used. With no reinforcements use 33" spindles. With top and/or bottom reinforcement use 31" spindle.

6 Foot Stair Railing Section Information

7/8" X 1 1/2" Spindle size

3' High Stair Rail Section

3 1/2" Picket Spacing

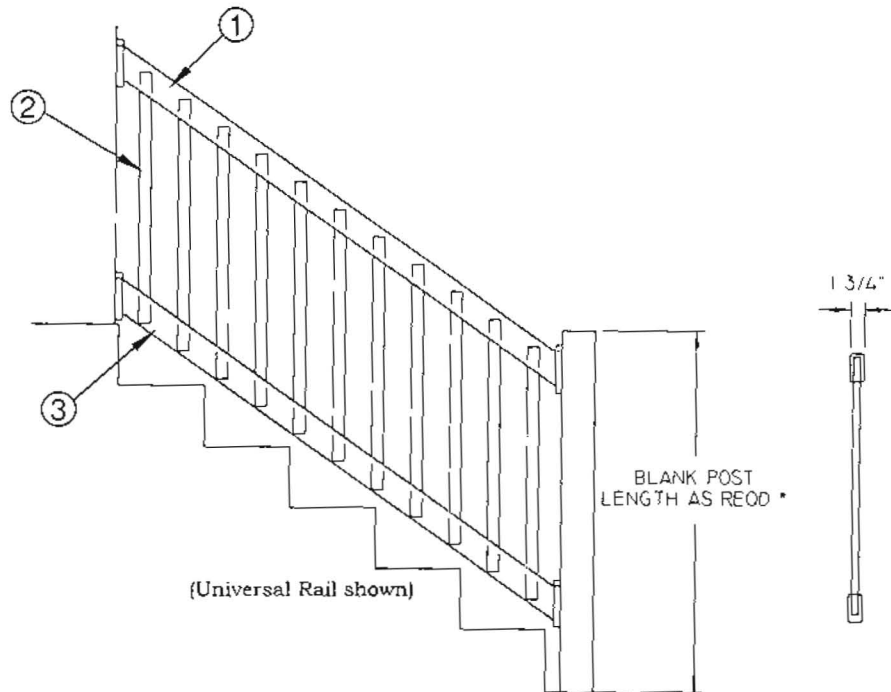

TYPICAL 6 FOOT STAIR RAIL SECTION:

- ① (1) TOP RAIL OPTIONS
 * Routed at 3 1/2" spacing
 6 ft routed Universal Stair Rail (Part# 26-RPL5-01)
 6 ft routed Universal Stair Rail (Part# 26-RPL5-V5)
- ② (11) 7/8"x 1 1/2" SPINDLE OPTIONS
 31" Universal Spindle (Part# 26-0025-01)
 31" Universal Spindle (Part# 26-0025-V5)
 33" Universal Spindle (Part# 26-0026-01)
 33" Universal Spindle (Part# 26-0026-V5)
- ③ (1) BOTTOM RAIL OPTIONS
 * Routed at 3 1/2" spacing
 6 ft routed Universal Stair Rail (Part# 26-RPL5-01)
 6 ft routed Universal Stair Rail (Part# 26-RPL5-V5)

POST OPTIONS

- 3 ft. Turned Post (26-5210-01) & (26-5210-V5)
 4.5 ft. Turned Post (26-5215-01) & (26-5215-V5)
 3 ft. Routed Line Post (Part # varies by rail style)
 3 ft. Routed End Post (Part # varies by rail style)
 3 ft. Routed Corner Post (Part # varies by rail style)
 3 ft. Blank Post (Part# 26-PD90-01) & (26-PD90-V5)
 * longer post may be required for bottom

POST MOUNTING OPTIONS

- 30" Stainless Steel Post Mount (Part# 26-0043-00)
 Stainless Steel Turned Post Mount (Part# 26-5220-00)

RAIL MOUNTING OPTIONS

- External Mounting Bracket, Stair, Universal Rail (#26-0552-01 or -V5)
 Alum. Internal Mounting Bracket, Stair, Univ. Rail (Part #26-0531-00)

ADDITIONAL ACCESSORIES

- Alignment Pins (4 per bag) (Part # 23-PIN4-01 or -V5)
 Dome Post Cap (Part # 23-9081-01 or -V5)
 Flat Post Cap (Part # 23-9046-01 or -V5)
 Gothic Post Cap (Part # 23-9041-01 or -V5)
 New England Post Cap (Part # 23-9064-01 or -V5)

OPTIONAL RAIL REINFORCEMENT CHANNELS

- Aluminum Rail Support, Universal rail (Part# 23-AHR6-00)

NOTE:

Length of spindle varies with number of aluminum reinforcements used. With no reinforcements use 33" spindles. With top and/or bottom reinforcement use 31" spindle.



CITY OF PORTLAND, MAINE

Department of Building Inspections

June 19 2006

Received from MWS

Location of Work 19 St George St

Cost of Construction \$ 24,000

Permit Fee \$ 237.00

Building (IL) Plumbing (I5) Electrical (I2) Site Plan (U2)

Other _____

CBL: 82 N012

Check #: 1844

Total Collected \$ 237.

THIS IS NOT A PERMIT

No work is to be started until PERMIT CARD is actually posted upon the premises. Acceptance of fee is no guarantee that permit will be granted. PRESERVE THIS RECEIPT. In case permit cannot be granted the amount of the fee will be refunded upon return of the receipt less \$10.00 or 10% whichever is greater.

Denna
WHITE - Applicant's Copy
YELLOW - Office Copy
PINK - Permit Copy

R-5 Zone



Rear: 20' min - 60' shown

Side: 8' min - 15' shown

Front: N/A

lot cov.

"We Treat Your Home Like Our Own."

Anna Freeman
19 St. George St.
Portland, ME 04103

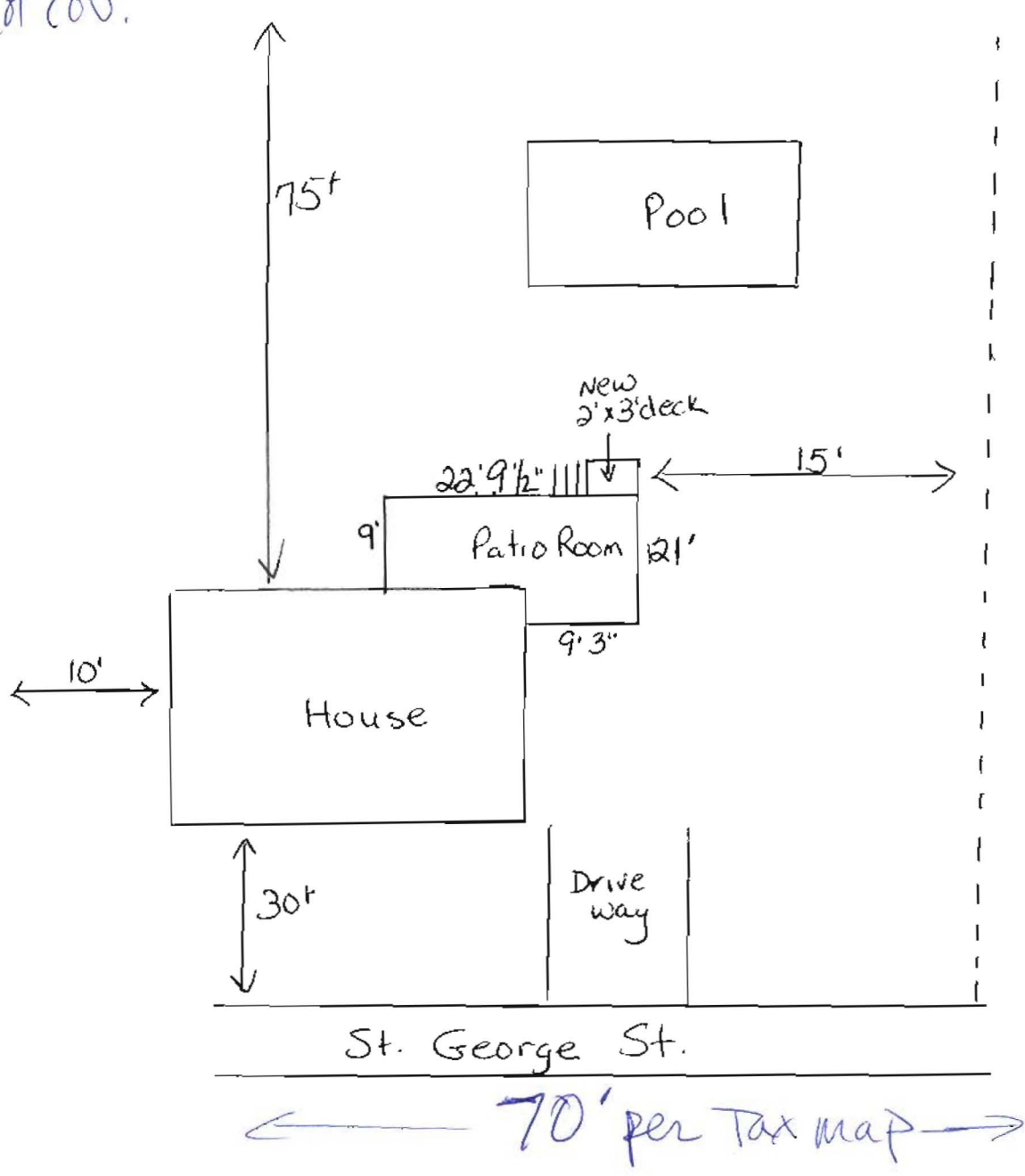

Established 1989

Anna Freeman
JOB NAME

19 St. George Street
JOB ADDRESS

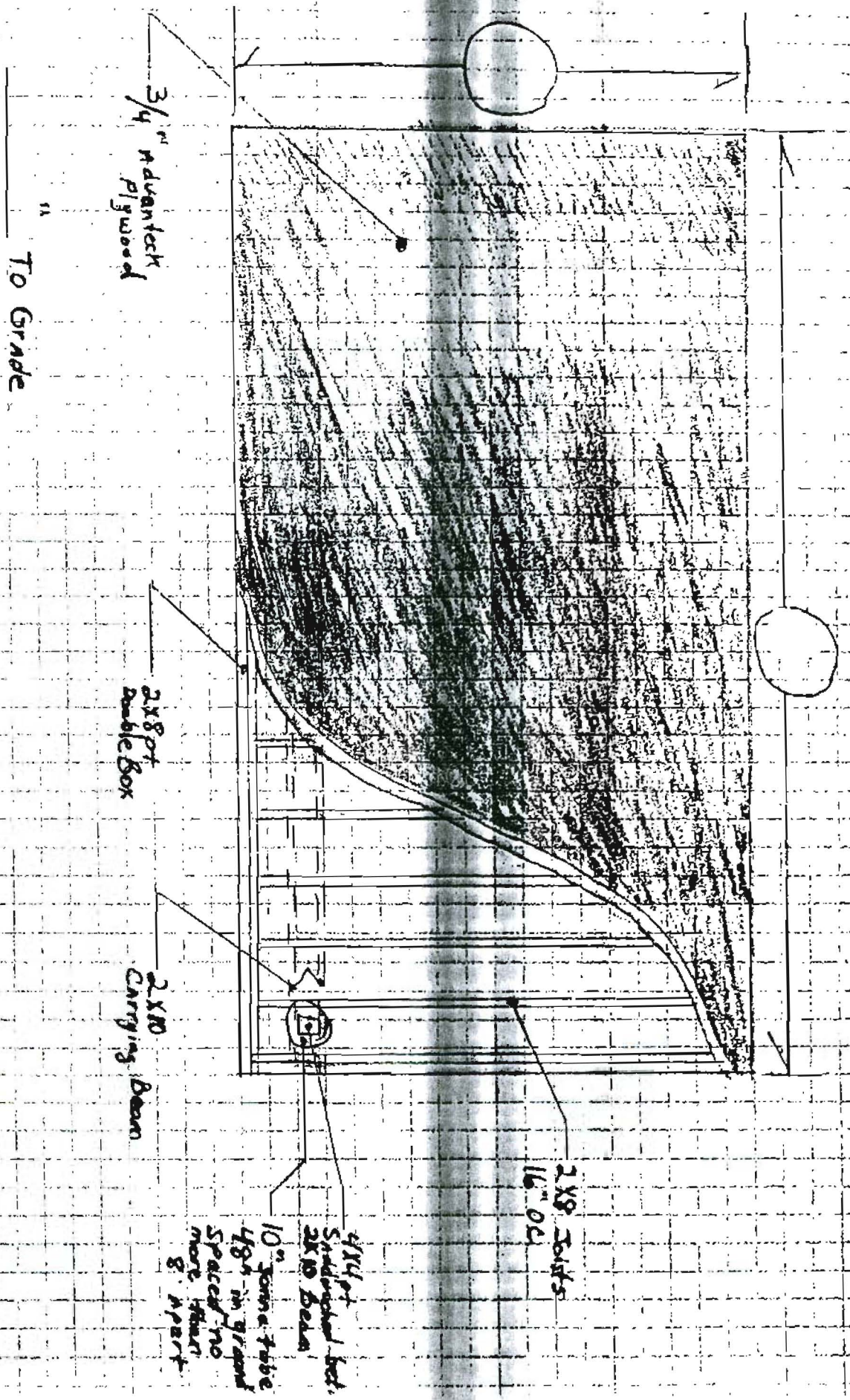
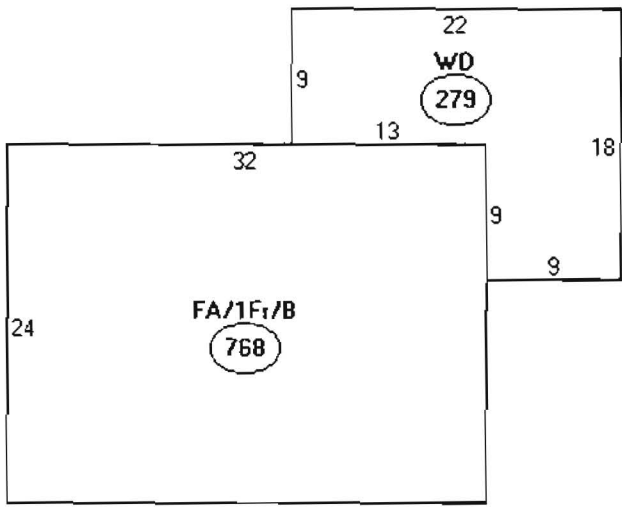

TABLE 1: LOAD/SPAN TABLE FOR HONEYCOMB CORE PANELS

PANEL SPAN (ft)	PANEL CONFIG.	ALLOWABLE LIVE ROOF LOADS FOR HONEYCOMB (H/C) PANELS								
		20 psf	25 psf	30 psf	35 psf	40 psf	45 psf	50 psf	55 psf	60 psf
8	3" HC	*	*	*	*	*	*	*	*	*
8	3" HC + H	*	*	*	*	*	*	*	*	*
8	4.5" HC	*	*	*	*	*	*	*	*	*
8	4.5" HC + H	*	*	*	*	*	*	*	*	*
8	6" HC	*	*	*	*	*	*	*	*	*
8	6" HC + H	*	*	*	*	*	*	*	*	*
9	3" HC	*	*	*	*	*	*	*	*	*
9	3" HC + H	*	*	*	*	*	*	*	*	*
9	4.5" HC	*	*	*	*	*	*	*	*	*
9	4.5" HC + H	*	*	*	*	*	*	*	*	*
9	6" HC	*	*	*	*	*	*	*	*	*
9	6" HC + H	*	*	*	*	*	*	*	*	*
10	3" HC	*	*	*	*	*	*	*	*	*
10	3" HC + H + SKY	*	*	*	*	*	*	*	*	*
10	3" HC + H	*	*	*	*	*	*	*	*	*
10	4.5" HC	*	*	*	*	*	*	*	*	*
10	4.5" HC + H	*	*	*	*	*	*	*	*	*
10	6" HC	*	*	*	*	*	*	*	*	*
10	6" HC + H	*	*	*	*	*	*	*	*	*
11	3" HC	*	*	*	*	*	*	*	*	*
11	3" HC + H + SKY	*	*	*	*	*	*	*	*	*
11	3" HC + H	*	*	*	*	*	*	*	*	*
11	4.5" HC	*	*	*	*	*	*	*	*	*
11	4.5" HC + H	*	*	*	*	*	*	*	*	*
11	6" HC	*	*	*	*	*	*	*	*	*
11	6" HC + H	*	*	*	*	*	*	*	*	*
12	3" HC	*	*	*	*	*	*	*	*	*
12	3" HC + H + SKY	*	*	*	*	*	*	*	*	*
12	3" HC + H	*	*	*	*	*	*	*	*	*
12	4.5" HC	*	*	*	*	*	*	*	*	*
12	4.5" HC + H + SKY	*	*	*	*	*	*	*	*	*
12	4.5" HC + H	*	*	*	*	*	*	*	*	*
12	6" HC	*	*	*	*	*	*	*	*	*
12	6" HC + H	*	*	*	*	*	*	*	*	*
13	3" HC	*	*	*	*	*	*	*	*	*
13	3" HC + H + SKY	*	*	*	*	*	*	*	*	*
13	3" HC + H	*	*	*	*	*	*	*	*	*
13	4.5" HC	*	*	*	*	*	*	*	*	*
13	4.5" HC + H + SKY	*	*	*	*	*	*	*	*	*
13	4.5" HC + H	*	*	*	*	*	*	*	*	*
13	6" HC	*	*	*	*	*	*	*	*	*
13	6" HC + H	*	*	*	*	*	*	*	*	*

60 psf



Descriptor/Area

A: FA/1Fr/B
768 sqft

B: WD
279 sqft

768 #

279 #

Deck stairs
2x3 stairs

1.2 #

1059 #

OK

9800 # x 40% = 3920 # MAX COVERAGE



"We Treat Your Home Like Our Own."

21'

DATE: 4-18-06

JOB NAME & ADDRESS:

Anna Freeman
19 Saint George St
Portland Me

I, Anna Freeman, hereby authorize Maine Window & Sunroom to act as my agent to acquire a building permit for my home improvement project.

Anna J Freeman
Signature

Established 1989

BUILDING PERMIT INSPECTION PROCEDURES

Please call 874-8703 or 874-8693 to schedule your inspections as agreed upon

Permits expire in 6 months, if the project is not started or ceases for 6 months.

The Owner or their designee is required to notify the inspections office for the following inspections and provide adequate notice. Notice must be called in 48-72 hours in advance in order to schedule an inspection:

By initializing at each inspection time, you are agreeing that you understand the inspection procedure and additional fees from a "Stop Work Order" and "Stop Work Order Release" will be incurred if the procedure is not followed as stated below.

A Pre-construction Meeting will take place upon receipt of your building permit.

- Footing/Building Location Inspection: Prior to pouring concrete
- N/A Re-Bar Schedule Inspection: Prior to pouring concrete
- N/A Foundation Inspection: Prior to placing ANY backfill
- Framing/Rough Plumbing/Electrical: Prior to any insulating or drywalling
- ~~Final/Certificate of Occupancy~~: Prior to any occupancy of the structure or use. NOTE: There is a \$75.00 fee per inspection at this point.

Certificate of Occupancy is not required for certain projects. Your inspector can advise you if your project requires a Certificate of Occupancy. All projects DO require a final inspection

~~✓~~ If any of the inspections do not occur, the project cannot go on to the next phase, REGARDLESS OF THE NOTICE OR CIRCUMSTANCES.

N/A CERTIFICATE OF OCCUPANCIES MUST BE ISSUED AND PAID FOR, BEFORE THE SPACE MAY BE OCCUPIED

[Signature]
Signature of Applicant/Designee,
Dennis Martin Admin
Signature of Inspections Official

8/14/06
Date
8-14-06
Date

CBL: 02 D 012 Building Permit #: 060913