

EXT. SHEATHING
ZIP BOARD, TAPED
TYVEK WRAP - WALLS
GRADE I & W - ROOF

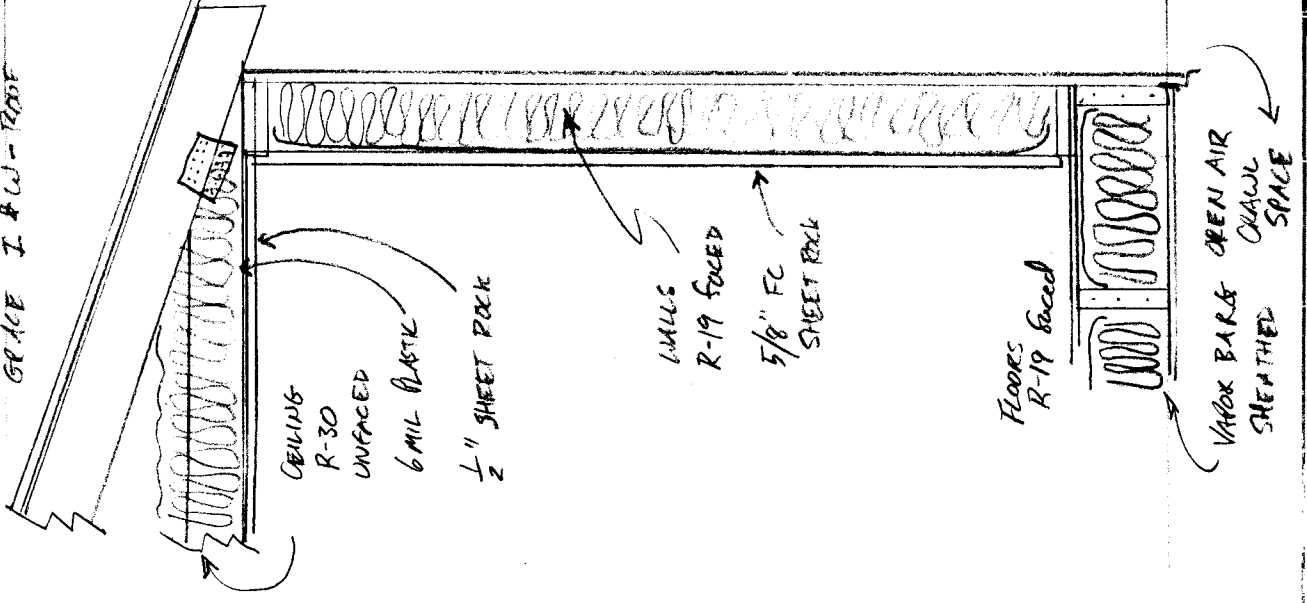

CEILING
R-30
UNFACED
6 MIL PLASTIC
1/2" SHEET ROCK

WALLS
R-19 FACED
5/8" FC
SHEET ROCK

FLOORS
R-19 Faced

VARIOUS BARS & OPEN AIR
SHEATHED CRAWL SPACE

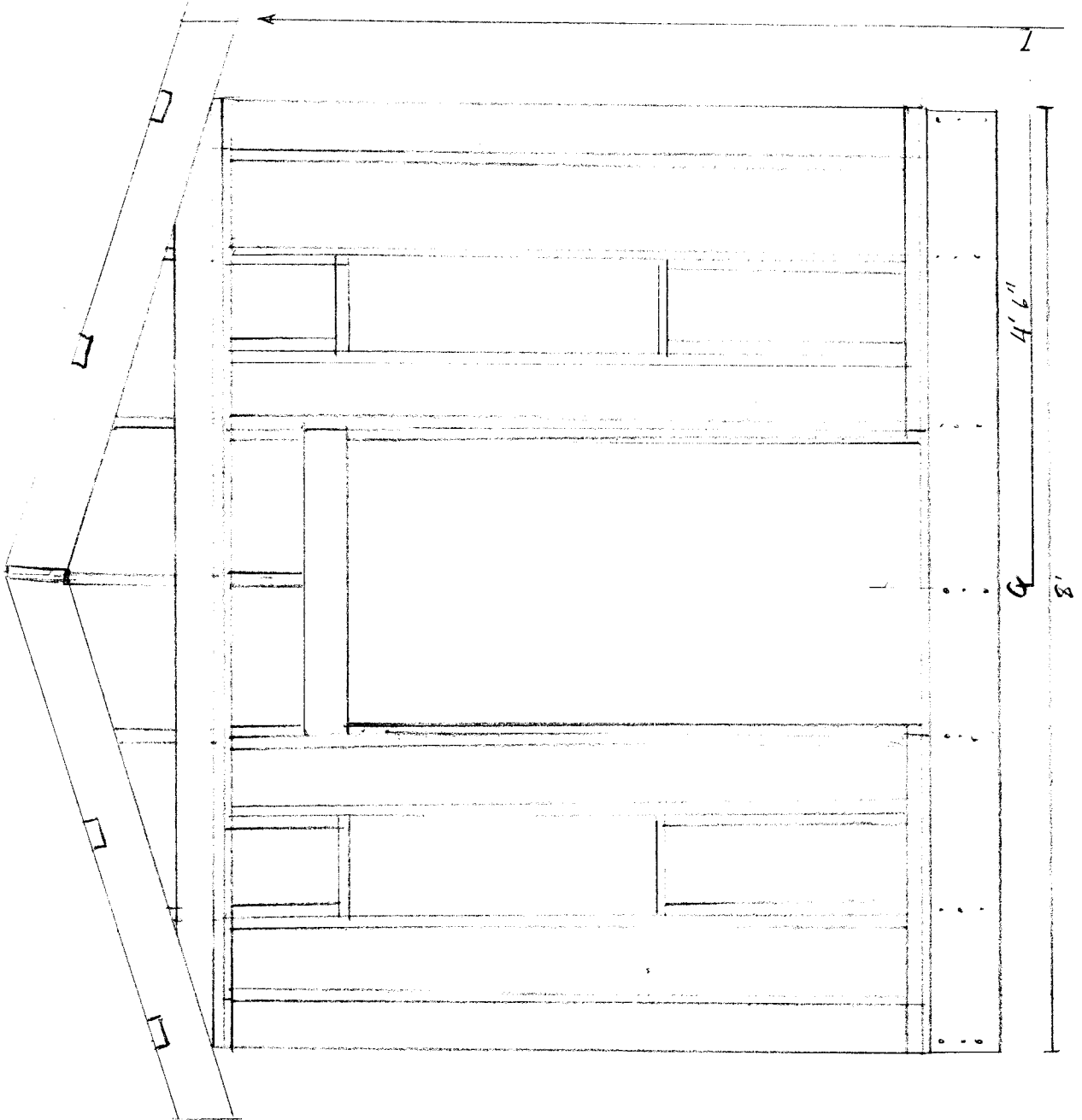

4'6"

8'