



PERMIT TO INSTALL PLUMBING

Address 31 Woodmont Ave. PERMIT NUMBER 1979

Installation For one family

Owner of Bldg Nixon Anderson

Owner's Address same

Plumber Rudi the Plumber Date 11-2-79

~~1731 Forest Ave.~~

~~SINKS~~

LAVATORIES

TOILETS 1 2.00

BATH TUBS 1 2.00

SHOWERS

DRAINS FLOOR SURFACE

HOT WATER TANKS

TANKLESS WATER HEATERS

GARBAGE DISPOSALS

SEPTIC TANKS

HOUSE SEWERS base fee 3.00

ROOF LEADERS

AUTOMATIC WASHERS

DISHWASHERS

OTHER

TOTAL 3.00

Date Issued 11-2-79  
Portland Plumbing Inspector  
By ERNOLD R GOODWIN

App. First Insp.

Date By

App. Final Insp.

Date By

Type of Bldg.

- Commercial
- Residential
- Single
- Multi Family
- New Construction
- Remodeling

ERNOLD R. GOODWIN  
PLUMBING INSPECTOR

Building and Inspection Services Dept: Plumbing Inspection

**PERMIT TO INSTALL PLUMBING**

PERMIT NUMBER **891**

Date Issued **10-4-71**  
 Portland Plumbing Inspector  
 By **ERNOLD R. GOODWIN**

Address **31 Woodmont St.**  
 Installation For: **Single**  
 Owner of Bldg: **A. Nixon Anderson**  
 Owner's Address: **Same**  
 Plumber **Alan Rich**  
 205 Ludlow St.

App. First Insp.  
 Date **10/4/71**  
 By **ERNOLD R. GOODWIN**

App. Final Insp.  
 Date **10/4/71**  
 By **ERNOLD R. GOODWIN**

- Type of Bldg.
- Commercial
  - Residential
  - Single
  - Multi Family
  - New Construction
  - Remodeling

NEW	REPL		Date	NO	FEE	
		SINKS	10-4-71			
		LAVATORIES				
		TOILETS				
		BATH TUBS				
		SHOWERS				
		DRAINS				
		FLOOR SURFACE				
		HOT WATER TANKS				
		TANKLESS WATER HEATERS				
		GARBAGE DISPOSALS				
		SEPTIC TANKS				
	1	HOUSE SEWERS				
		ROOF LEADERS				
		AUTOMATIC WASHERS			2.00	
		DISHWASHERS				
		OTHER				
TOTAL					1	2.00

Building and Inspection Services Dept., Plumbing Inspection



# APPLICATION FOR PERMIT

Class of Building or Type of Structure Third Class  
Portland, Maine, September 29, 1954

PERMIT ISSUED  
01632  
SEP 30 1954  
CITY OF PORTLAND

To the INSPECTOR OF BUILDINGS, PORTLAND, MAINE

The undersigned hereby applies for a permit to erect ~~or reconstruct~~ the following building structure equipment in accordance with the Laws of the State of Maine, the Building Code and Zoning Ordinance of the City of Portland, plans and specifications, if any, submitted herewith and the following specifications:

Location 31 Woodmont Street Within Fire Limits? no Dist. No. \_\_\_\_\_  
Owner's name and address Nixon A. Andersen, 31 Woodmont Street Telephone \_\_\_\_\_  
Lessee's name and address \_\_\_\_\_ Telephone \_\_\_\_\_  
Contractor's name and address Gordon Evans, 27 Hastings Street Telephone \_\_\_\_\_  
Architect \_\_\_\_\_ Telephone \_\_\_\_\_  
Proposed use of building \_\_\_\_\_ Specifications \_\_\_\_\_ Plans yes No. of sheets 1  
Last use \_\_\_\_\_ No. families \_\_\_\_\_  
Material frame No. stories 1 Heat \_\_\_\_\_ Style of roof \_\_\_\_\_ No. families \_\_\_\_\_  
Other buildings on same lot dwelling Roofing \_\_\_\_\_  
Estimated cost \$ 1000. Fee \$ 4.00

### General Description of New Work

To demolish existing 1-car frame garage 14'x20'  
To construct 16'x22' 1-car frame garage

CERTIFICATE OF OCCUPANCY  
REQUIREMENT IS WAIVED

It is understood that this permit does not include installation of heating apparatus which is to be taken out separately by and in the name of the heating contractor. **PERMIT TO BE ISSUED TO** Gordon Evans

### Details of New Work

Is any plumbing involved in this work? \_\_\_\_\_ Is any electrical work involved in this work? \_\_\_\_\_  
Height average grade to top of plate \_\_\_\_\_ Height average grade to highest point of roof \_\_\_\_\_  
Size, front \_\_\_\_\_ depth \_\_\_\_\_ No. stories 1 solid or filled land? solid earth or rock? earth  
Material of foundation concrete slab Thickness, top \_\_\_\_\_ bottom \_\_\_\_\_ cellar \_\_\_\_\_  
Material of underpinning \_\_\_\_\_ Height \_\_\_\_\_ Thickness \_\_\_\_\_  
Kind of roof hip Rise per foot 6" Roof covering asphalt roofing Class C Und. Lab.  
No. of chimneys \_\_\_\_\_ Material of chimneys \_\_\_\_\_ of lining \_\_\_\_\_ Kind of heat \_\_\_\_\_ fuel \_\_\_\_\_  
Framing lumber—Kind second-hand and hemlock Dressed or full size? dressed  
Corner posts 4x6 Sills 2x6 bolted Girt or ledger board? \_\_\_\_\_  
Girders \_\_\_\_\_ Size \_\_\_\_\_ Columns under girders \_\_\_\_\_ Size \_\_\_\_\_ Max. on centers \_\_\_\_\_  
Studs (outside walls and car-ying partitions) 2x4-16" O. C. Bridging in every floor and flat roof span over 8 feet.  
Joists and rafters: 1st floor concrete, 2nd \_\_\_\_\_, 3rd \_\_\_\_\_, roof 2x6  
On centers: 1st floor \_\_\_\_\_, 2nd \_\_\_\_\_, 3rd \_\_\_\_\_, roof 20"  
Maximum span: 1st floor \_\_\_\_\_, 2nd \_\_\_\_\_, 3rd \_\_\_\_\_, roof 8'  
If one story building with masonry walls, thickness of walls? \_\_\_\_\_ height? \_\_\_\_\_

### If a Garage

No. cars now accommodated on same lot \_\_\_\_\_, to be accommodated 1 number commercial cars to be accommodated none  
Will automobile repairs be done other than minor repairs to cars habitually stored in the proposed building? no

### Miscellaneous

Will work require disturbing of any tree on a public street? no  
Will there be in charge of the above work a person competent to see that the State and City requirements pertaining thereto are observed? yes

APPROVED:  
O.R. - 9/30/54 - O.R.

Nixon Andersen

INSPECTION COPY

Signature of owner By Gordon Evans PH

Permit No. 54/1632  
Location 31 Woodmont St.  
Owner Nixon A. Anderson  
Date of permit 9/30/54  
Notif. closing-in \_\_\_\_\_  
Inspn. closing-in \_\_\_\_\_  
Final Notif. \_\_\_\_\_  
Final Inspn \_\_\_\_\_  
Cert. of Occupancy issued \_\_\_\_\_

NOTES

9-30-54 Strike out of AP  
11-2-54 Job completed  
Well done. AP

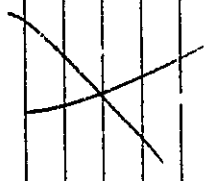

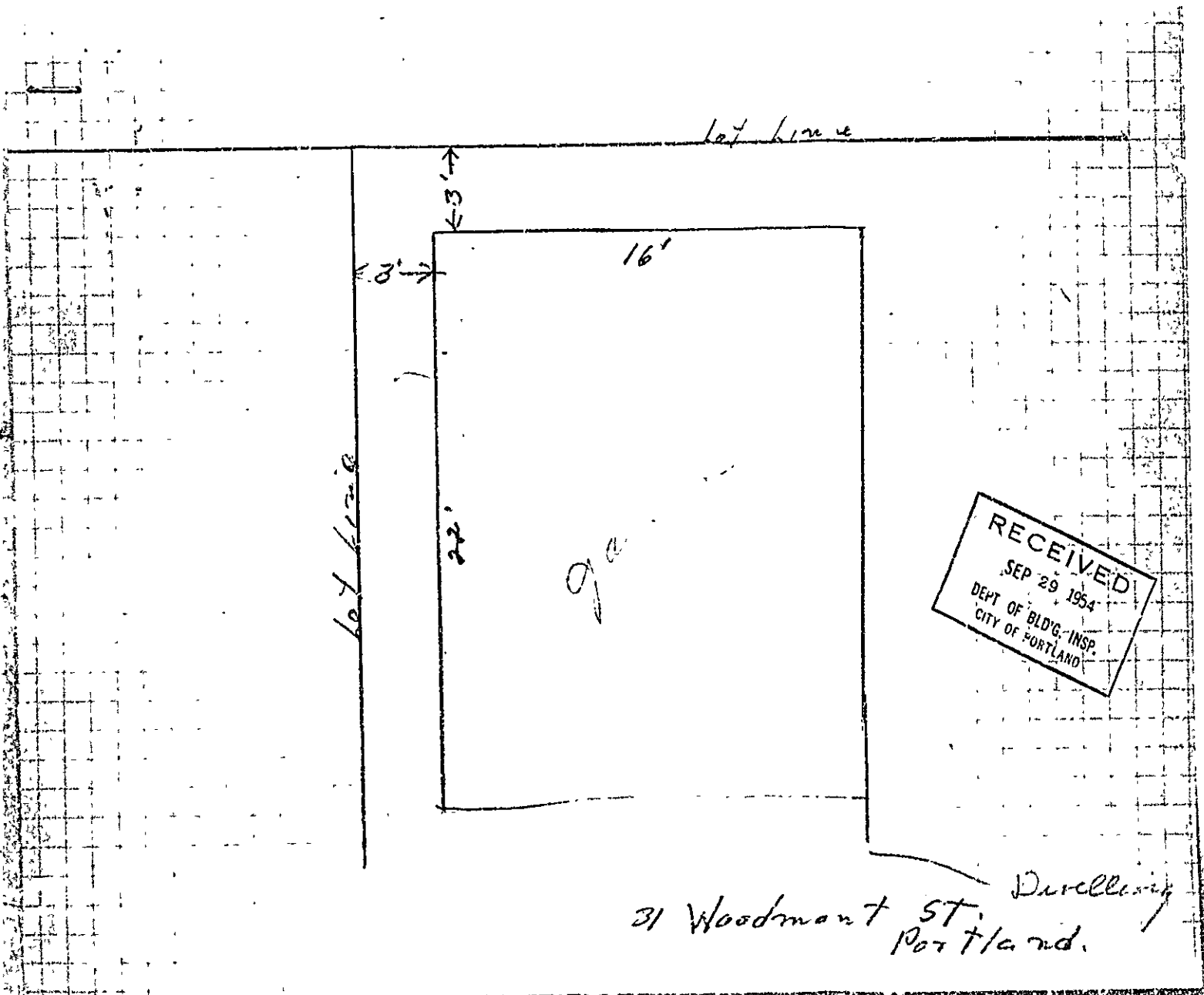

RECEIVED  
SEP 29 1954  
DEPT OF BLDG. INSP.  
CITY OF PORTLAND

31 Woodmont ST. Drexler  
Portland.

STATEMENT ACCOMPANYING APPLICATION FOR BUILDING PERMIT

for 1 car garage  
at 31 Woodmont Street Date 9/29/54

1. In whose name is the title of the property now recorded? Nixon Andersen
2. Are the boundaries of the property in the vicinity of the proposed work shown clearly on the ground, and how? stakes
3. Is the outline of the proposed work now staked out upon the ground? yes - Thurs.  
If not, will you notify the Inspection Office when the work is staked out and before any of the work is commenced? \_\_\_\_\_
4. What is to be maximum projection or overhang of eaves or drip? 8"
5. Do you assume full responsibility for the correctness of the location plan or statement of location filed with this application, and does it show the complete outline of the proposed work on the ground, including bay windows, porches and other projections? yes
6. Do you assume full responsibility for the correctness of all statements in the application concerning the sizes, design and use of the proposed building? yes
7. Do you understand that in case changes are proposed in the location of the work or in any of the details specified in the application that a revised plan and application must be submitted to this office before the changes are made? yes

Richard Andersen



FILL IN COMPLETELY AND SIGN WITH INK

RECEIVED  
DEPT. OF BLDG. DEP.  
CITY OF PORTLAND  
PORTLAND, ME.

APPLICATION FOR PERMIT FOR HEATING, COOKING OR POWER EQUIPMENT

Permit No. PERMIT ISSUED  
SEP 23 1931

To the INSPECTOR OF BUILDINGS, Portland, Maine, September 23, 1931

The undersigned hereby applies for a permit to install the following heating, cooking or power equipment in accordance with the Laws of Maine, the Building Code of the City of Portland, and the following specifications:

Location 31 Woodmont Street Use of Building Residence

Name and address of owner Mr. Joseph Little Ward 7

Contractor's name and address Ballard Oil & Equipment Co. of Maine Telephone 86223  
124 High Street, Portland, Maine

General Description of Work

To install Oil burning equipment PC sent 9/25/31

IF HEATER, POWER BOILER OR COOKING DEVICE

Is heater or source of heat to be in cellar? Yes If not, which story \_\_\_\_\_ Kind of Fuel Oil

Material of supports of heater or equipment (concrete floor or what kind) Concrete

Minimum distance to wood or combustible material, from top of boiler or casing top of furnace, \_\_\_\_\_  
from top of smoke pipe, \_\_\_\_\_, from front of heater, \_\_\_\_\_ from sides or back of heater, \_\_\_\_\_

IF OIL BURNER

Name and type of burner #4 Quiet Ballard Jr Labeled and approved by Underwriters' Laboratories? Yes Labeled

Will operator be always in attendance? No Type of oil feed (gravity or pressure) Pressure

Location oil storage Basement Outside No. and capacity of tanks 1 - 275 gallons

Will all tanks be more than seven feet from any flame? Yes How many tanks fireproofed? None

Amount of fee enclosed? \$1.00 (\$1.00 for one heater, etc., 50 cents additional for each additional heater, etc., in same building at same time.)

INSPECTION COPY

Signature of contractor J.P. Tucker OF MAINE

GALLARD OIL & EQUIPMENT CO.  
TREASURER 5974

NOTIFICATION BEFORE LATHING OR CLOSING-IN IS WAIVED. CERTIFICATE OF OCCUPANCY REQUIREMENT IS WAIVED.



Ward 7 Permit No. 31/1857

Location 31 Warden St

Owner Joseph Little

Date of permit 9/24/31

Notif. closing-in \_\_\_\_\_

Inspn. closing-in \_\_\_\_\_

Final Notif. 10/6/31

Final Inspn. 10/7/31

Cert. of Occupancy issued None

NOTES

9/30/31 - Being undisturbed

10/6/31 - Inspection 14:25 AM

10/7/31 - Unable to get in  
in AM - O.G.S.

10/7/31 - Installation  
O.R. and certificate  
of inspection left O.G.S.





Location, ownership and detail must be correct, complete and legible. Separate application required for every building. Plans must be filed with this application.

## APPLICATION FOR PERMIT TO BUILD (3rd CLASS BUILDING)

Portland, Me., October 8, 1924

TO THE  
INSPECTOR OF BUILDINGS

The undersigned hereby applies for a permit to build, according to the following Specifications:—

Plans must be submitted in duplicate, one set to be filed with the Department and the duplicate set thereof (bearing the approval of the Inspector of Buildings) shall be kept on the work and exhibited on demand

PERMIT MUST BE RECEIVED BEFORE BEGINNING WORK

Location 60 Woodmont Street Ward 9 Fire Limits? no  
 Name of owner is? E F Ginn Address 97 Pitt Street  
 Name of mechanic is? owner Address \_\_\_\_\_  
 Name of architect is? \_\_\_\_\_ Address \_\_\_\_\_  
 Proposed occupancy of building (purpose)? dwelling  
 If a dwelling or tenement house, for how many families? 1  
 Are there to be stores in the lower story? \_\_\_\_\_  
 Size of lot, No. of feet front? \_\_\_\_\_; No. of feet rear? \_\_\_\_\_; No. of feet deep? \_\_\_\_\_  
 Size of building, No. of feet front? 25ft; No. of feet rear? 25ft; No. of feet deep? 28ft  
 No. of stories, front? 2; rear? \_\_\_\_\_  
 No. of feet in height from the mean grade of street to the highest part of the roof? 28ft  
 Distance from lot lines, front? \_\_\_\_\_ feet; side? \_\_\_\_\_ feet; rear? \_\_\_\_\_ feet  
 Firestop to be used? yes  
 Will the building be erected on solid or filled land? solid  
 Will the foundation be laid on earth, rock or piles? \_\_\_\_\_  
 If on piles, No. of rows? \_\_\_\_\_ distance on centers? \_\_\_\_\_ length of? \_\_\_\_\_  
 Diameter, top of? \_\_\_\_\_ diameter, bottom of? \_\_\_\_\_  
 Size of posts, 4x6 Studding 2x4 16 O. C. Sills 4x8 Roof Rafters 2x6 24 O. C. Girders 6x8  
 Size of girts 4x4  
 Size of floor joists? 1st floor 2x8, 2d 2x8, 3d \_\_\_\_\_, 4th \_\_\_\_\_  
 O. C. " " " " 16, 2d 16, 3d \_\_\_\_\_, 4th \_\_\_\_\_  
 Span " " " not over 16ft, 2d not over 16ft, 3d \_\_\_\_\_, 4th \_\_\_\_\_  
 Will the building be properly braced? yes Bridging in every floor span over 8ft  
 Building, how framed? \_\_\_\_\_  
 Material of foundation? concrete thickness of? 12in laid with mortar? \_\_\_\_\_  
 Underpinning, material of? brick height of? 2ft thickness of? 8in  
 Will the roof be flat, pitch, mansard or hip? pitch Material of roofing? asphalt  
 Will the building be heated by steam, furnaces, stoves or grates? steam Will the flues be lined? yes  
 Will the building conform to the requirements of the law? yes  
 Means of egress? \_\_\_\_\_

If the building is to be occupied as a Tenement House, give the following particulars

What is the height of cellar or basement? \_\_\_\_\_  
 What will be the clear height of first story? \_\_\_\_\_ second? \_\_\_\_\_ third? \_\_\_\_\_  
 State what means of egress is to be provided \_\_\_\_\_

Estimated Cost, \_\_\_\_\_  
 \$ 8,000. Signature of owner or authorized representative, E. F. Ginn  
 Address, 97 Pitt St.  
 Plans submitted? \_\_\_\_\_ Received by? \_\_\_\_\_

150

206

29 31  
60 Woodmont  
Oct 8, 1924

RECEIVED  
OFFICE OF THE DIRECTOR OF BUREAU OF LANDS  
WASHINGTON, D. C.

RECEIVED  
OFFICE OF THE DIRECTOR OF BUREAU OF LANDS  
WASHINGTON, D. C.

RECEIVED  
OFFICE OF THE DIRECTOR OF BUREAU OF LANDS  
WASHINGTON, D. C.

APPROVED BY THE DIRECTOR OF BUREAU OF LANDS  
WASHINGTON, D. C.

RECEIVED BY THE DIRECTOR OF BUREAU OF LANDS  
WASHINGTON, D. C.

29-33 Woodmont Street

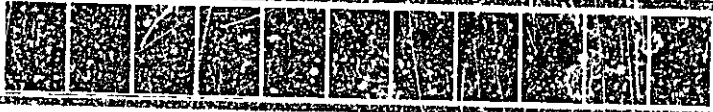



**APPLICATION FOR PERMIT**  
**DEPARTMENT OF BUILDING INSPECTIONS SERVICES**  
**ELECTRICAL INSTALLATIONS**

Date July 5, 1983  
 Receipt and Permit number B 06934

To the CHIEF ELECTRICAL INSPECTOR, Portland, Maine:

The undersigned hereby applies for a permit to make electrical installations in accordance with the laws of Maine, the Portland Electrical Ordinance, the National Electrical Code and the following specifications:

LOCATION OF WORK: 31 Woodmont Street

OWNER'S NAME: A. Nixon Anderson ADDRESS: lives there

FEE\$

**OUTLETS:**

Receptacles \_\_\_\_\_ Switches \_\_\_\_\_ Plugmold \_\_\_\_\_ ft TOTAL \_\_\_\_\_

**FIXTURES (number of)**

Incandescent \_\_\_\_\_ Fluorescent \_\_\_\_\_ (not strip) TOTAL \_\_\_\_\_

Strip Fluorescent \_\_\_\_\_ ft \_\_\_\_\_

**SERVICES:**

Overhead \_\_\_\_\_ Underground \_\_\_\_\_ Temporary \_\_\_\_\_ TOTAL amperes \_\_\_\_\_

METERS: (number of) 1 \_\_\_\_\_ .50

**MOTORS: (number of)**

Fractional \_\_\_\_\_

1 HP or over \_\_\_\_\_

**RESIDENTIAL HEATING:**

Oil or Gas (number of units) \_\_\_\_\_

Electric (number of rooms) \_\_\_\_\_

**COMMERCIAL OR INDUSTRIAL HEATING:**

Oil or Gas (by a main boiler) \_\_\_\_\_

Oil or Gas (by separate units) \_\_\_\_\_

Electric Under 20 kws \_\_\_\_\_ Over 20 kws \_\_\_\_\_

**APPLIANCES: (number of)**

Ranges \_\_\_\_\_ Water Heaters \_\_\_\_\_

Cook Tops \_\_\_\_\_ Disposals \_\_\_\_\_

Wall Ovens \_\_\_\_\_ Dishwashers \_\_\_\_\_

Dryers \_\_\_\_\_ Compactors \_\_\_\_\_

Fans \_\_\_\_\_ Others (denote) \_\_\_\_\_

TOTAL \_\_\_\_\_

**MISCELLANEOUS: (number of)**

Branch Panels \_\_\_\_\_

Transformers \_\_\_\_\_

Air Conditioners Central Unit \_\_\_\_\_

Separate Units (windows) \_\_\_\_\_

Signs 20 sq. ft. and under \_\_\_\_\_

Over 20 sq. ft. \_\_\_\_\_

Swimming Pools Above Ground \_\_\_\_\_

In Ground \_\_\_\_\_

Fire/Burglar Alarms Residential \_\_\_\_\_

Commercial \_\_\_\_\_

Heavy Duty Outlets, 220 Volt (such as welders) 30 amps and under \_\_\_\_\_

over 30 amps \_\_\_\_\_

Circus, Fairs, etc. \_\_\_\_\_

Alterations to wires \_\_\_\_\_

Repairs after fire \_\_\_\_\_

Emergency Light Battery \_\_\_\_\_

Emergency Generators \_\_\_\_\_

INSTALLATION FEE DUE:

FOR ADDITIONAL WORK NOT ON ORIGINAL PERMIT ..... DOUBLE FEE DUE:

FOR REMOVAL OF A "STOP ORDER" (304-16.b) .....

TOTAL AMOUNT DUE: 750

min 5.00

**INSPECTION:**

Will be ready on ready, 1983; or Will Call \_\_\_\_\_

CONTRACTOR'S NAME: R & D Electric

ADDRESS: 94 Allen Avenue

TEL: \_\_\_\_\_

MASTER LICENSE NO.: 2812 SIGNATURE OF CONTRACTOR:

LIMITED LICENSE NO.: \_\_\_\_\_ *Robert D. Wilson*

INSPECTOR'S COPY -- WHITE

OFFICE COPY -- CANARY

CONTRACTOR'S COPY -- GREEN

ELECTRICAL INSTALLATIONS -

Permit Number 06934  
Location 31 Woodmont St.  
Owner A.N. Anderson  
Date of Permit 7-5-83  
Final Inspection 7-12-83  
By Inspector Hibby  
Permit Application Register Page No 152

INSPECTIONS: Service by  
Servicer called in OK 7-12-83  
Closing-in \_\_\_\_\_ by \_\_\_\_\_

PROGRESS INSPECTIONS.

_____	_____	_____
_____	_____	_____
_____	_____	_____
_____	_____	_____
_____	_____	_____
_____	_____	_____
_____	_____	_____

CODE  
COMPLIANCE  
COMPLETED  
DATE 7-12-83

DATE: \_\_\_\_\_  
REMARKS: \_\_\_\_\_  
\_\_\_\_\_  
\_\_\_\_\_  
\_\_\_\_\_  
\_\_\_\_\_  
\_\_\_\_\_  
\_\_\_\_\_  
\_\_\_\_\_  
\_\_\_\_\_  
\_\_\_\_\_



**APPLICATION FOR PERMIT**  
**DEPARTMENT OF BUILDING INSPECTIONS SERVICES**  
**ELECTRICAL INSTALLATIONS**

Date July 22, 19 85  
 Receipt and Permit number D 04926

To the CHIEF ELECTRICAL INSPECTOR, Portland, Maine:  
 The undersigned hereby applies for a permit to make electrical installations in accordance with the laws of Maine, the Portland Electrical Ordinance, the National Electrical Code and the following specifications:

LOCATION OF WORK: 31 Woodmont St.  
 OWNER'S NAME: Nixon A. Anderson ADDRESS: lives there

	FEES
<b>OUTLETS:</b>	
Receptacles _____ Switches _____ Plugmold _____ ft. TOTAL _____	
<b>FIXTURES: (number of)</b>	
Incandescent _____ Fluorescent _____ (not strip) TOTAL _____	
Strip Fluorescent _____ ft. _____	
<b>SERVICES:</b>	
Overhead <input checked="" type="checkbox"/> Underground _____ Temporary _____ TOTAL amperes <u>100</u>	<u>3.00</u>
<b>METERS: (number of)</b> <u>1</u>	<u>.50</u>
<b>MOTORS: (number of)</b>	
Fractional _____	
1 HP or over _____	
<b>RESIDENTIAL HEATING:</b>	
Oil or Gas (number of units) _____	
Electric (number of rooms) _____	
<b>COMMERCIAL OR INDUSTRIAL HEATING:</b>	
Oil or Gas (by a main boiler) _____	
Oil or Gas (by separate units) _____	
Electric Under 20 kws _____ Over 20 kws _____	
<b>APPLIANCES: (number of)</b>	
Ranges _____	Water Heaters _____
Cook Tops _____	Disposals _____
Wall Ovens _____	Dishwashers _____
Dryers _____	Compactors _____
Fans _____	Others (denote) _____
<b>TOTAL</b> _____	
<b>MISCELLANEOUS: (number of)</b>	
Branch Panels _____	
Transformers _____	
Air Conditioners Central Unit _____	
Separate Units (windows) _____	
Signs 20 sq. ft. and unde. _____	
Over 20 sq. ft. _____	
Swimming Pools Above Ground _____	
In Ground _____	
Fire/Burglar Alarms Residential _____	
Commercial _____	
Heavy Duty Outlets, 220 Volt (such as welders) 30 amps and under _____	
over 30 amp. _____	
Circus, Fairs, etc. _____	
Alterations to wires _____	
Repairs after fire _____	
Emergency Lights, battery _____	
Emergency Generators _____	
	INSTALLATION FEE DUE: _____
FOR ADDITIONAL WORK NOT ON ORIGINAL PERMIT ..... DOUBLE FEE DUE: _____	
FOR REMOVAL OF A "STOP ORDER" (304-16.b) .....	
	TOTAL AMOUNT DUE: <u>3.50</u>
	min <u>5.00</u>

**INSPECTION:**  
 Will be ready on \_\_\_\_\_, 19\_\_; or Will Call xx  
**CONTRACTOR'S NAME:** R & D Electric  
**ADDRESS:** 94 Allen Avenue  
**TEL.:** 797-6195  
**MASTER LICENSE NO.:** 3812  
**LIMITED LICENSE NO.:** \_\_\_\_\_

SIGNATURE OF CONTRACTOR:  
*Robert D. DeLoren*

INSPECTOR'S COPY — WHITE  
 OFFICE COPY — CANARY  
 CONTRACTOR'S COPY — GREEN

