



General Building Permit Application

If you or the property owner owes real estate or personal property taxes or user charges on any property within the City, payment arrangements must be made before permits of any kind are accepted.

Location/Address of Construction: <u>104 Brighton Ave. Portland, ME 04102</u>		
Total Square Footage of Proposed Structure/Area	Square Footage of Lot	Number of Stories
Tax Assessor's Chart, Block & Lot Chart# Block# Lot#	Applicant: (must be owner, lessee or buyer) Name <u>Susan McParthian</u> Address <u>104 Brighton Ave.</u> City, State & Zip <u>Portland, ME 04102</u>	Telephone: <u>207-245-4372</u>
Lessee/DBA	Owner: (if different from applicant) Name Address City, State & Zip	Cost of Work: \$ <u>18,000</u> C of O Fee: \$ _____ Historic Review: \$ _____ Planning Amin.: \$ <u>-</u> Total Fee: \$ <u>200.00</u>
Current legal use (i.e. single family) <u>Single Family</u> Number of Residential Units <u>1</u> If vacant, what was the previous use? _____ Proposed Specific use: _____ Is property part of a subdivision? <u>NO</u> If yes, please name _____ Project description: <u>Renovate Kitchen & Bath</u>		
Contractor's name: <u>Roger Howes</u> Email: _____		
Address: <u>6 Sullivan Ln</u>		
City, State & Zip: <u>SACO, ME 04072</u> Telephone: _____		
Who should we contact when the permit is ready: <u>Susan McParthian</u> Telephone: <u>245-4372</u>		
Mailing address: <u>104 Brighton Ave. Portland ME 04102</u>		

Please submit all of the information outlined on the applicable checklist. Failure to do so will result in the automatic denial of your permit.

In order to be sure the City fully understands the full scope of the project, the Planning and Development Department may request additional information prior to the issuance of a permit. For further information or to download copies of this form and other applications visit the Inspections Division on-line at www.portlandmaine.gov, or stop by the Inspections Division office, room 315 City Hall or call 874-8703.

and I hereby certify that I am the Owner of record of the named property, or that the owner of record authorizes the proposed work and that I have been authorized by the owner to make this application as his/her authorized agent. I agree to conform to all applicable laws of this jurisdiction. In addition, if a permit for work described in this application is issued, I certify that the Code Official's authorized representative shall have the authority to enter all areas covered by this permit at any reasonable hour to enforce the provisions of the codes applicable to this permit.

Signature: S. McParthian Date: 3/7/13

This is not a permit; you may not commence ANY work until the permit is issued

S. McPartlan

Kitchen and Bath renovation:

Remove Bathroom area from kitchen

Remove wall and door separating Kitchen and Dining Room

 Add support beam

Move exterior door to end of Kitchen

Extend wall from storage room into Living Room

 Add support beam

Add 1/2 bath in extended storage area

S. McPartlan - After.

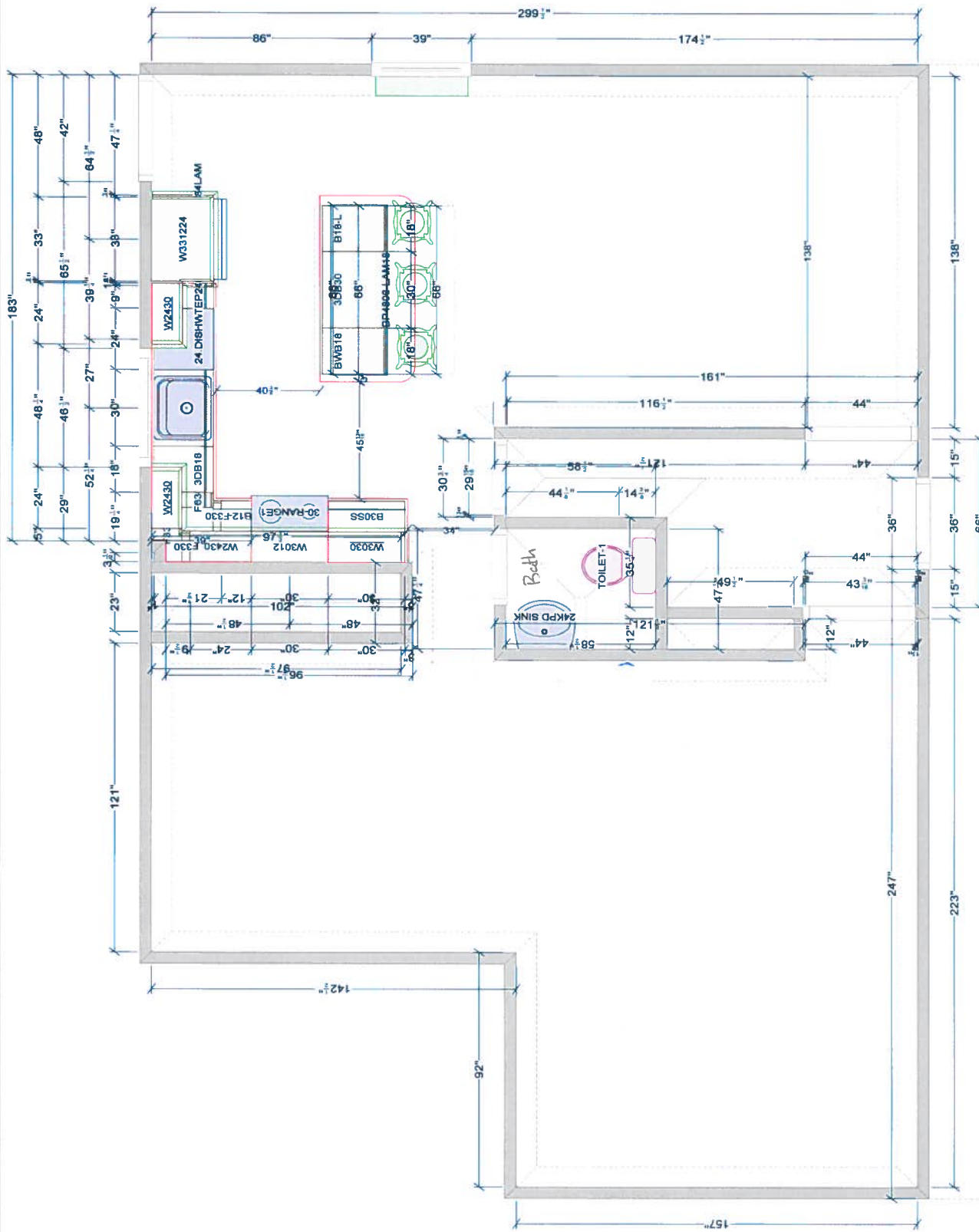

Designed: 3/6/2013
 Printed: 3/6/2013

This is an original design and must not be released or copied unless applicable fee has been paid or job order placed.

MICHAEL LINCOURT
 DESIGNER DONNA B.

All dimensions .size designations given are subject to verification on job site and adjustment to fit job conditions.

Drawing #: 1 No Scale.

All

All

3060008c