

City of Portland, Maine - Building or Use Permit Application

389 Congress Street, 04101 Tel: (207) 874-8703, Fax: (207) 874-8716

| | | |
|-----------------------|------------------------------------|-------------------------|
| Permit No: 05-1674 | Issued On: PERMIT ISSUED | Phone: 0811 D004-001 |
|-----------------------|------------------------------------|-------------------------|

| | | | |
|--|---------------------------------|-----------------------------------|-----------------------|
| Location of Construction: 133 FALMOUTH ST | Owner Name: Davis, Donnabeth | Owner Address: 133 FALMOUTH ST | Phone: NOV 29 2005 |
| Business Name: | Contractor Name: | Contractor Address: | Phone: |
| Lessee/Buyer's Name | Phone: | Permit Type: Sheds | Zone: R5 |

CITY OF PORTLAND

| | | | | |
|---------------------------------|--|------------------------|-----------------------------|--------------------|
| Past Use: Single Family Home | Proposed Use: Single Family Home/ install a 8' x 12' Shed | Permit Fee: \$39.00 | Cost of Work: \$1,968.00 | CEO District: 3 |
|---------------------------------|--|------------------------|-----------------------------|--------------------|

| | |
|--|---|
| FIRE DEPT: <input type="checkbox"/> Approved <input type="checkbox"/> Denied | INSPECTION: Use Group: R3 Type: SB IRC 2003 Signature: 11/18/05 Jm |
|--|---|

Proposed Project Description:
install a 8' x 12' Shed

PEDESTRIAN ACTIVITIES DISTRICT (P.A.D.)
Action: Approved Approved w/Conditions Denied
Signature: _____ Date: _____

| | | |
|-----------------------------|---------------------------------|------------------------|
| Permit Taken By: Idobson | Date Applied For: 11/14/2005 | Zoning Approval |
|-----------------------------|---------------------------------|------------------------|

| | | | |
|---|---|---|--|
| <p>1. This permit application does not preclude the Applicant(s) from meeting applicable State and Federal Rules.</p> <p>2. Building permits do not include plumbing, septic or electrical work.</p> <p>3. Building permits are void if work is not started within six (6) months of the date of issuance. False information may invalidate a building permit and stop all work..</p> | <p>Special Zone or Reviews</p> <input type="checkbox"/> Shoreland <input type="checkbox"/> Wetland <input type="checkbox"/> Flood Zone <input type="checkbox"/> Subdivision <input type="checkbox"/> Site Plan Maj <input type="checkbox"/> Minor <input type="checkbox"/> MM <input type="checkbox"/> Date: 11/18/05 Jm | <p>Zoning Appeal</p> <input type="checkbox"/> Variance <input type="checkbox"/> Miscellaneous <input type="checkbox"/> Conditional Use <input type="checkbox"/> Interpretation <input type="checkbox"/> Approved <input type="checkbox"/> Denied Date: _____ | <p>Historic Preservation</p> <input checked="" type="checkbox"/> Not in District or Landmark <input type="checkbox"/> Does Not Require Review <input type="checkbox"/> Requires Review <input type="checkbox"/> Approved <input type="checkbox"/> Approved w/Conditions <input type="checkbox"/> Denied Date: 11/18/05 Jm |
| | OK | | |

CERTIFICATION

I hereby certify that I am the owner of record of the named property, or that the proposed work is authorized by the owner of record and that I have been authorized by the owner to make this application as his authorized agent and I agree to conform to all applicable laws of this jurisdiction. In addition, if a permit for work described in the application is issued, I certify that the code official's authorized representative shall have the authority to enter all areas covered by such permit at any reasonable hour to enforce the provision of the code(s) applicable to such permit.

| | | | |
|---|---------|------|-------|
| SIGNATURE OF APPLICANT | ADDRESS | DATE | PHONE |
| RESPONSIBLE PERSON IN CHARGE OF WORK, TITLE | | DATE | PHONE |

12-22nd Reported OK to Close
in

DISPLAY THIS CARD ON PRINCIPAL FRONTAGE OF WORK CITY OF PORTLAND

Please Read
Application And
Notes, If Any,
Attached

BUILDING INSPECTION

PERMIT

PERMIT ISSUED

Permit Number: 051674

NOV 29 2005

CITY OF PORTLAND

This is to certify that Davis, Donnabeth

has permission to install a 8' x 12' Shed

AT 133 FALMOUTH ST

081 D004001

provided that the person or persons who apply for or accept this permit shall comply with all of the provisions of the Statutes of the State and of the Ordinances of the City of Portland regulating the construction, maintenance and use of buildings and structures, and of the application on file in this department.

Apply to Public Works for street line and grade if nature of work requires such information.

Notification of inspection must be given and when permission procedure is complete this building or part thereof is closed or sealed as required. **FOUR NOTICES REQUIRED.**

A certificate of occupancy must be procured by owner before this building or part thereof is occupied.

OTHER REQUIRED APPROVALS

Fire Dept. _____

Health Dept. _____

Appeal Board _____

Other _____

Department Name

Thomas M. Mully 11/18/05
Director - Building & Inspection Services

PENALTY FOR REMOVING THIS CARD

City of Portland, Maine - Building or Use Permit

389 Congress Street, 04101 Tel: (207) 874-8703, Fax: (207) 874-8716

| | | |
|------------------------------|--|----------------------------|
| Permit No: 05-1674 | Date Applied For: 11/14/2005 | CBL: 081 D004001 |
|------------------------------|--|----------------------------|

| | | | |
|---|--|--|---------------|
| Location of Construction: 133 FALMOUTH ST | Owner Name: Davis, Donnabeth | Owner Address: 133 FALMOUTH ST | Phone: |
| Business Name: | Contractor Name: | Contractor Address: | Phone: |
| Lessee/Buyer's Name | Phone: | Permit Type: Sheds | |

| | |
|---|---|
| Proposed Use: Single Family Home/ install a 8' x 12' Shed | Proposed Project Description: install a 8' x 12' Shed |
|---|---|

| | | | |
|---------------------|-------------------------|------------------------------|---|
| Dept: Zoning | Status: Approved | Reviewer: Tom Markley | Approval Date: 11/18/2005 |
| Note: | | | Ok to Issue: <input checked="" type="checkbox"/> |

| | | | |
|-----------------------|-------------------------|------------------------------|---|
| Dept: Building | Status: Approved | Reviewer: Tom Markley | Approval Date: 11/18/2005 |
| Note: | | | Ok to Issue: <input checked="" type="checkbox"/> |



General Building Permit Application

If you or the property owner owes real estate or personal property taxes or user charges on any property within the City, payment arrangements must be made before permits of any kind are accepted.

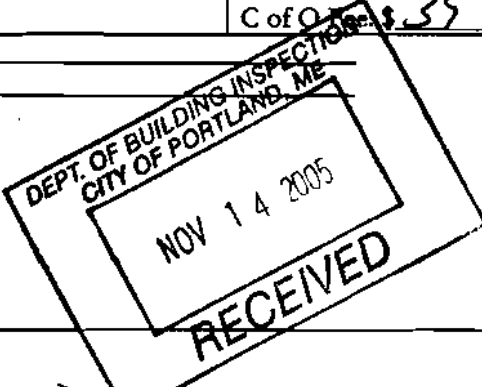
| | | |
|---|--|--|
| Location/Address of Construction: <u>133 Falmouth St.</u> | | |
| Total Square Footage of Proposed Structure <u>96</u> | Square Footage of Lot | |
| Tax Assessor's Chart, Block & Lot Chart# <u>81</u> Block# <u>D</u> Lot# <u>4</u> | Owner: <u>Donnabeth Davis</u> | Telephone: <u>774-4094</u> |
| Lessee/Buyer's Name (If Applicable) | Applicant name, address & telephone: <u>Donnabeth Davis</u> <u>133 Falmouth St.</u> <u>774-4094</u> | Cost Of Work: <u>\$1968⁰⁰</u> Fee: \$ _____ C of O: <u>\$35⁰⁰/sq</u> |
| Current Specific use: _____ Proposed Specific use: <u>Single family Home</u> |  | |
| Project description: <u>8x12 shed</u> | | |
| Contractor's name, address & telephone: | | |
| Who should we contact when the permit is ready: <u>Donnabeth Davis</u> Mailing address: <u>133 Falmouth St</u> Phone: <u>774-4094</u> <u>Portland, ME 04102</u> | | |

Please submit all of the information outlined in the Commercial Application Checklist. Failure to do so will result in the automatic denial of your permit.

In order to be sure the City fully understands the full scope of the project, the Planning and Development Department may request additional information prior to the issuance of a permit. For further information visit us on-line at www.portlandmaine.gov, stop by the Building Inspections office, room 315 City Hall or call 874-8703.

I hereby certify that I am the Owner of record of the named property, or that the owner of record authorizes the proposed work and that I have been authorized by the owner to make this application as his/her authorized agent. I agree to conform to all applicable laws of this jurisdiction. In addition, if a permit for work described in this application is issued, I certify that the Code Official's authorized representative shall have the authority to enter all areas covered by this permit at any reasonable hour to enforce the provisions of the codes applicable to this permit.

| | |
|--|-----------------------|
| Signature of applicant: <u>Donnabeth Davis</u> | Date: <u>11.14.05</u> |
|--|-----------------------|

This is not a permit; you may not commence ANY work until the permit is issued.

FRONT
DAVIS WOODWORKING

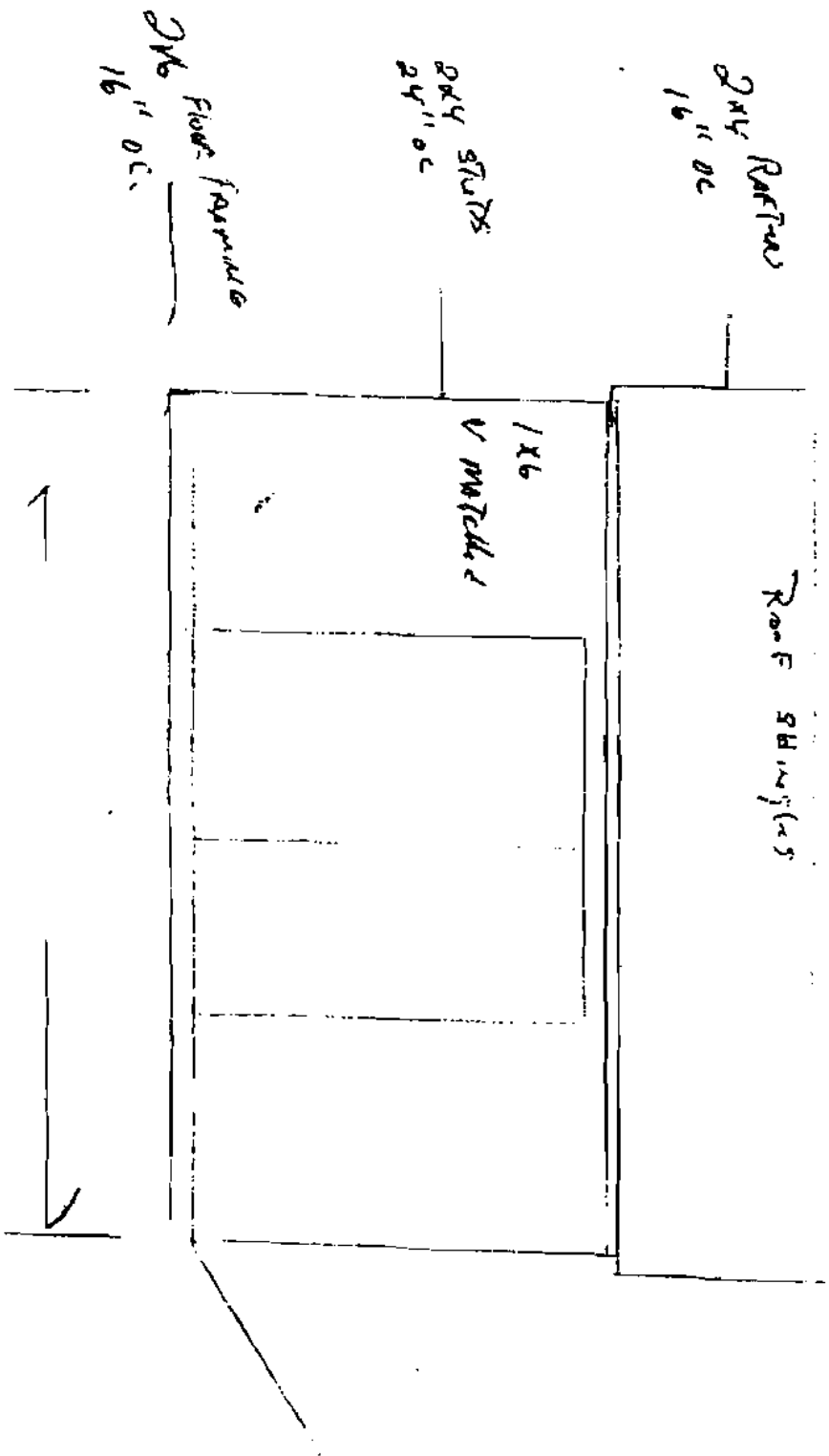

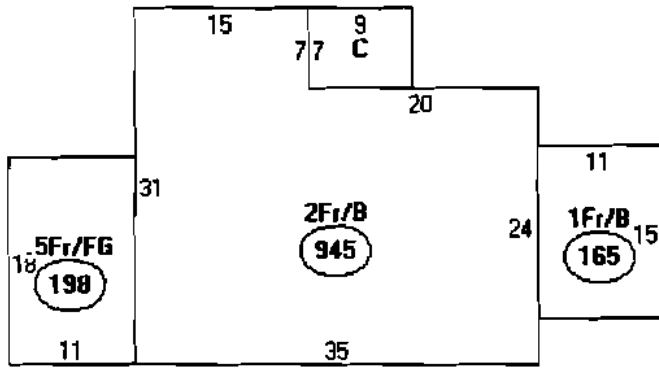

Descriptor/Area

- A: 2Fr/B
945 sqft
- B: 5Fr/FG
198 sqft
- C: EP
63 sqft
- D: 1Fr/B
165 sqft

1371

dot 90 OK 79

This page contains a detailed description of the Parcel ID you selected. Press the **New Search** button at the bottom of the screen to submit a new query.

Current Owner Information

| | |
|----------------------|---|
| Card Number | 1 of 1 |
| Parcel ID | 081 D004001 |
| Location | 133 FALMOUTH ST |
| Land Use | SINGLE FAMILY |
| | |
| Owner Address | DAVIS DONNABETH 133 FALMOUTH ST PORTLAND ME 04102 |
| | |
| Book/Page | 23062/086 |
| Legal | 81-D-4 FALMOUTH ST 133 BRIGHTON AVE 6850 SF |

Current Assessed Valuation For Fiscal Year 2006

| | | |
|-------------|-----------------|--------------|
| Land | Building | Total |
| \$59,900 | \$129,470 | \$189,370 |

Estimated Assessed Valuation For Fiscal Year 2007*

| | | |
|-------------|-----------------|--------------|
| Land | Building | Total |
| \$68,300 | \$172,300 | \$260,600 |

* Value subject to change based upon review of property status as of 4/1/06. The tax rate will be determined by City Council in May 2006.

Property Information

| | | | | | | |
|---------------------------|---------------------------|--------------------------|-------------------------|-----------------------------|-------------------------|--|
| Year Built 1910 | Style Old Style | Story Height 2 | Sq. Ft. 2204 | Total Acres 0.157 | | |
| Bedrooms 3 | Full Baths 1 | Half Baths 1 | Total Rooms 6 | Attic None | Basement Full | |

Outbuildings

| | | | | | |
|-------------|-----------------|-------------------|-------------|--------------|------------------|
| Type | Quantity | Year Built | Size | Grade | Condition |
|-------------|-----------------|-------------------|-------------|--------------|------------------|

Sales Information

| | | | |
|-------------|---------------|--------------|------------------|
| Date | Type | Price | Book/Page |
| 08/23/2005 | LAND + BLDING | \$329,900 | 23062-86 |
| 08/01/1995 | LAND + BLDING | \$105,000 | 12064-245 |

Picture and Sketch

[Picture](#) [Sketch](#) [Tax Map](#)

[Click here to view Tax Roll Information.](#)



CITY OF PORTLAND, MAINE
Department of Building Inspections

11-17 2005

Received from Robert Smith & the Davis

Location of Work 133 Felton St S-

Cost of Construction \$ _____

Permit Fee \$ 380.00

Building (IL) ___ Plumbing (I5) ___ Electrical (I2) ___ Site Plan (U2) ___

Other 100

CBL: 204

Check #: 1361

Total Collected \$ 380.00

THIS IS NOT A PERMIT

No work is to be started until PERMIT CARD is actually posted upon the premises. Acceptance of fee is no guarantee that permit will be granted. PRESERVE THIS RECEIPT. In case permit cannot be granted the amount of the fee will be refunded upon return of the receipt less \$10.00 or 10% whichever is greater.

WHITE - Applicant's Copy
YELLOW - Office Copy
PINK - Permit Copy





Applicant:

Date:

Address:

C-B-I:

CHECK-LIST AGAINST ZONING ORDINANCE

Date -

Zone Location -

RS

Interior or corner lot -

Proposed Use/Work -

Sevage Disposal -

Lot Street Frontage -

Front Yard -

20 FT Required - 38 shown

Rear Yard -

5 FT Required - 5 FT shown

Side Yard -

8 FT Required - 8 FT shown

Projections -

Width of Lot -

Height -

2 STORY

Lot Area -

6850 sq FT

Lot Coverage/ Impervious Surface -

Area per Family -

Off-street Parking -

Loading Bays -

Site Plan -

Shoreland Zoning/ Stream Protection -

Flood Plains -