



# SUBSURFACE WASTEWATER DISPOSAL SYSTEM APPLICATION

Department of Health & Human Services  
Division of Environmental Health  
(207) 287-5672 Fax: (207) 287-  
Date: 03/21/18

Town, City, Plantation

Street, Road, Subdivision

Owner's Name

Portland

St. James Street

Delta Facility

## SUBSURFACE WASTEWATER DISPOSAL PLAN

0  
SCALE: 1" = 10' FT.

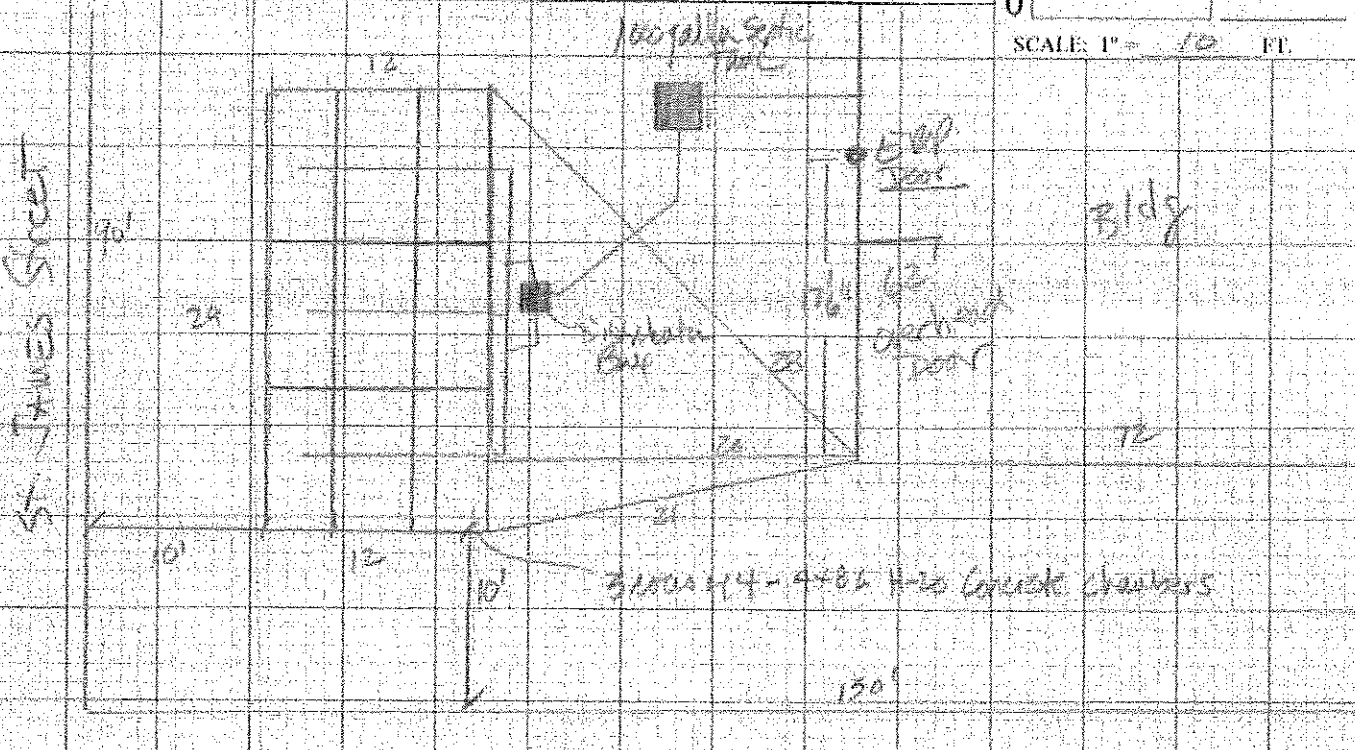

### FILL REQUIREMENTS

### CONSTRUCTION ELEVATIONS

### ELEVATION REFERENCE POINT

Depth of Fill (Upslope) 0  
Depth of Fill (Downslope) 0

Finished Grade Elevation 36  
Top of Distribution Pipe or Proprietary Device -12  
Bottom of Disposal Area -91

Location & Description: Finish Floor  
TAXI RAIL BUILDING 0 110' from street  
Reference Elevation: 0

Note: Materials and installation shall be in accordance with Maine Subsurface Wastewater Disposal Rules dated 08/15 as amended.

### DISPOSAL AREA CROSS SECTION

Scale

Horizontal 1" = 3' ft.  
Vertical 1" = 3' ft.

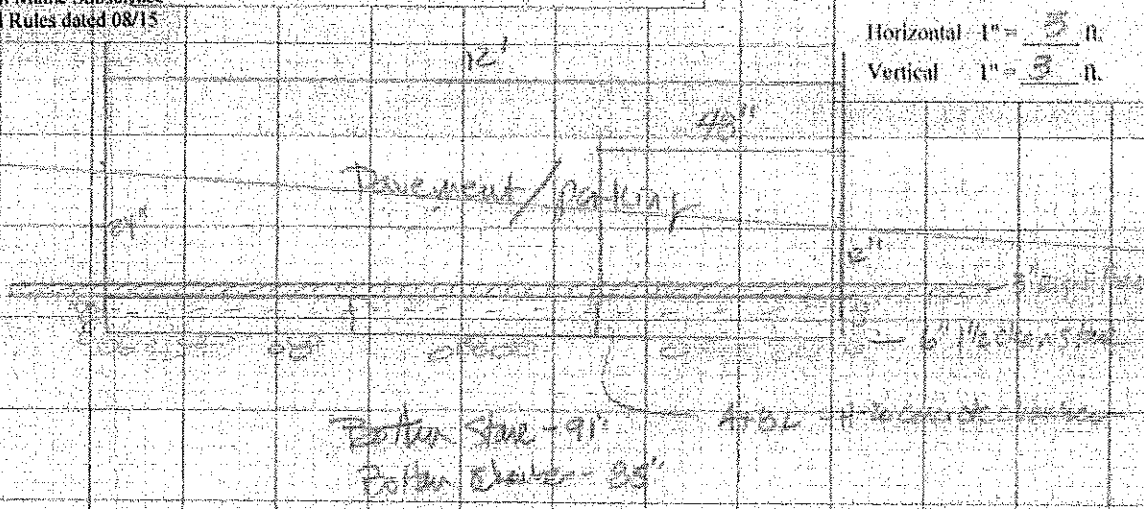

NOTE: All grad to be filled must be scarified

*[Signature]*  
Site Evaluator Signature

203  
SE #

2/20/18  
Date