

106 Douglass St

June 30, 2014

Drawn by Steve Koeniger

22' to property line

13' 6"

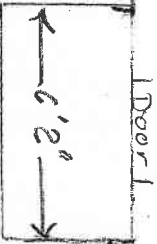

14'

24' 4"

Existing House

18' 6"

18' to property line



Proposed Area of Work

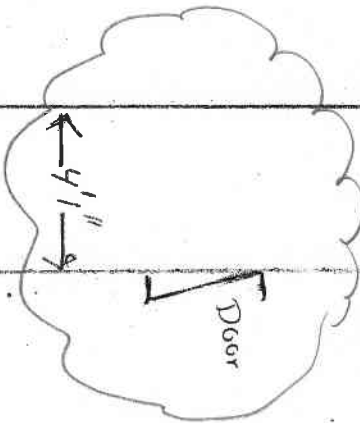

9' 6"



1' 2"

1'

42-381 50 SHEETS 5 SQUARE  
 42-382 100 SHEETS 3 SQUARE  
 42-389 200 SHEETS 3 SQUARE  
 NATIONAL