

City of Portland, Maine - Building or Use Permit Application
 389 Congress Street, 04101 Tel: (207) 874-8703, Fax: (207) 874-8716

Permit No: 10-0227	Issue Date:	CBL: 079 A004001
-----------------------	-------------	---------------------

Location of Construction: 138 DOUGLASS ST	Owner Name: NAPPI MIRIAM	Owner Address: 138 DOUGLASS ST	Phone:
Business Name:	Contractor Name: Down East Energy	Contractor Address: 172 Main Street South Portland	Phone 2077995585
Lessee/Buyer's Name	Phone:	Permit Type: HVAC	Zone: R-6

Past Use: Single Family	Proposed Use: Single Family with Empire space heater and 120 gal LP tank	Permit Fee: \$40.00	Cost of Work: \$1,500.00	CEO District: 3
		FIRE DEPT: <input type="checkbox"/> Approved <input type="checkbox"/> Denied	INSPECTION: Use Group: R3 Type: HVAC IRC-2003 NTPA 58 Signature: JMB 3/9/10	

Proposed Project Description:
 Empire space heater and 120 gal LP tank

Signature: _____
 PEDESTRIAN ACTIVITIES DISTRICT (P.A.D.)
 Action: Approved Approved w/Conditions Denied
 Signature: _____ Date: _____

Permit Taken By: jmb	Date Applied For: 03/09/2010	Zoning Approval		
-------------------------	---------------------------------	------------------------	--	--

- This permit application does not preclude the Applicant(s) from meeting applicable State and Federal Rules.
- Building permits do not include plumbing, septic or electrical work.
- Building permits are void if work is not started within six (6) months of the date of issuance. False information may invalidate a building permit and stop all work..

Special Zone or Reviews

Shoreland
 Wetland
 Flood Zone
 Subdivision
 Site Plan *OK*
 Maj Minor MM
 Date: *JMB 3/9/10*

Zoning Appeal

Variance
 Miscellaneous
 Conditional Use
 Interpretation
 Approved
 Denied
 Date: _____

Historic Preservation

Not in District or Landmark
 Does Not Require Review
 Requires Review
 Approved
 Approved w/Conditions
 Denied
 Date: _____

PERMIT ISSUED

MAR - 9 2010

City of Portland

CERTIFICATION

I hereby certify that I am the owner of record of the named property, or that the proposed work is authorized by the owner of record and that I have been authorized by the owner to make this application as his authorized agent and I agree to conform to all applicable laws of this jurisdiction. In addition, if a permit for work described in the application is issued, I certify that the code official's authorized representative shall have the authority to enter all areas covered by such permit at any reasonable hour to enforce the provision of the code(s) applicable to such permit.

SIGNATURE OF APPLICANT	ADDRESS	DATE	PHONE
RESPONSIBLE PERSON IN CHARGE OF WORK, TITLE		DATE	PHONE

BUILDING PERMIT INSPECTION PROCEDURES

**Please call 874-8703 or 874-8693 (ONLY)
or email: buildinginspections@portlandmaine.gov**

With the issuance of this permit, the owner, builder or their designee is required to provide adequate notice to the City of Portland Inspection Services for the following inspections. Appointments must be requested 48 to 72 hours in advance of the required inspection. The inspection date will need to be confirmed by this office.

- **Please read the conditions of approval that is attached to this permit!! Contact this office if you have any questions.**
- **Permits expire in 6 months, if the project is not started or ceases for 6 months.**
- **If the inspection requirements are not followed as stated below additional fees may be incurred due to the issuance of a “Stop Work Order” and subsequent release to continue with construction.**

 X **Final inspection required at completion of work.**

The project cannot move to the next phase prior to the required inspection and approval to continue, REGARDLESS OF THE NOTICE OR CIRCUMSTANCES.

IF THE PERMIT REQUIRES A CERTIFICATE OF OCCUPANCY, IT MUST BE PAID FOR AND ISSUED TO THE OWNER OR DESIGNEE BEFORE THE SPACE MAY BE OCCUPIED.



FILL IN AND SIGN WITH INK

RECEIVED

MAR - 9 2010

APPLICATION FOR PERMIT HEATING OR POWER EQUIPMENT

079-A-004 Dept. of Building Inspections
City of Portland Maine

To the INSPECTOR OF BUILDINGS, PORTLAND, ME.

The undersigned hereby applies for a permit to install the following heating, cooking or power equipment in accordance with the Laws of Maine, the Building Code of the City of Portland, and the following specifications:

Location / CBL 138 Douglas Use of Building Private Date 3/4/2010
Name and address of owner of appliance Miriam Napp 138 Douglas ST
Portland
Installer's name and address Days East Energy 172 Main ST
South Portland 04106 Telephone 799-5585

Location of appliance:

- Basement
- Floor
- Attic
- Roof

Type of Fuel:

- Gas
- Oil
- Solid

Appliance Name: Empire DV-25

U.L. Approved Yes No

Will appliance be installed in accordance with the manufacture's installation instructions? Yes No

IF NO Explain: _____

The Type of License of Installer:

- Master Plumber # _____
- Solid Fuel # _____
- Oil # _____
- Gas # PNT 1445
- Other _____

Type of Chimney:

- Masonry Lined
Factory built _____
- Metal
Factory Built U.L. Listing # _____
- Direct Vent
Type 4" 6" UL# _____
Concentric vent

Type of Fuel Tank

- Oil
- Gas

Size of Tank 120

Number of Tanks 1

Distance from Tank to Center of Flame _____ feet.

Cost of Work: \$ 1,500.00

Permit Fee: \$ _____

PERMIT ISSUED
Approved

Approved with Conditions

Fire: _____
MAR - 9 2010

Ele.: _____

Bldg.: JMB
City of Portland

See attached letter or requirement

Inspector's Signature

Date Approved

Signature of Installer [Signature]

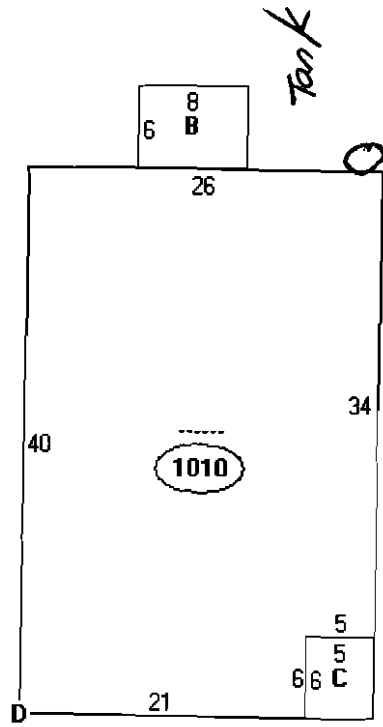
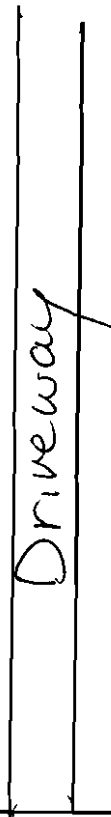

Tank



Douglas