

THIS IS NOT A BOUNDARY SURVEY

This copyrighted document expires 10-10-07. Reproduction and/or dissemination after this date is unauthorized.

MORTGAGE INSPECTION OF: DEED BOOK 7578 PAGE 41 COUNTY Cumberland
 PLAN BOOK --- PAGE --- LOT ---

ADDRESS: 75 Douglass Street, Portland, Maine

Job Number: 600-68

Inspection Date: 07-10-07

Scale: 1" = 20'

Buyer: Jonathan Bradstreet

Client File #: 0207-00481

Seller: Estate of Daniel S. Campbell

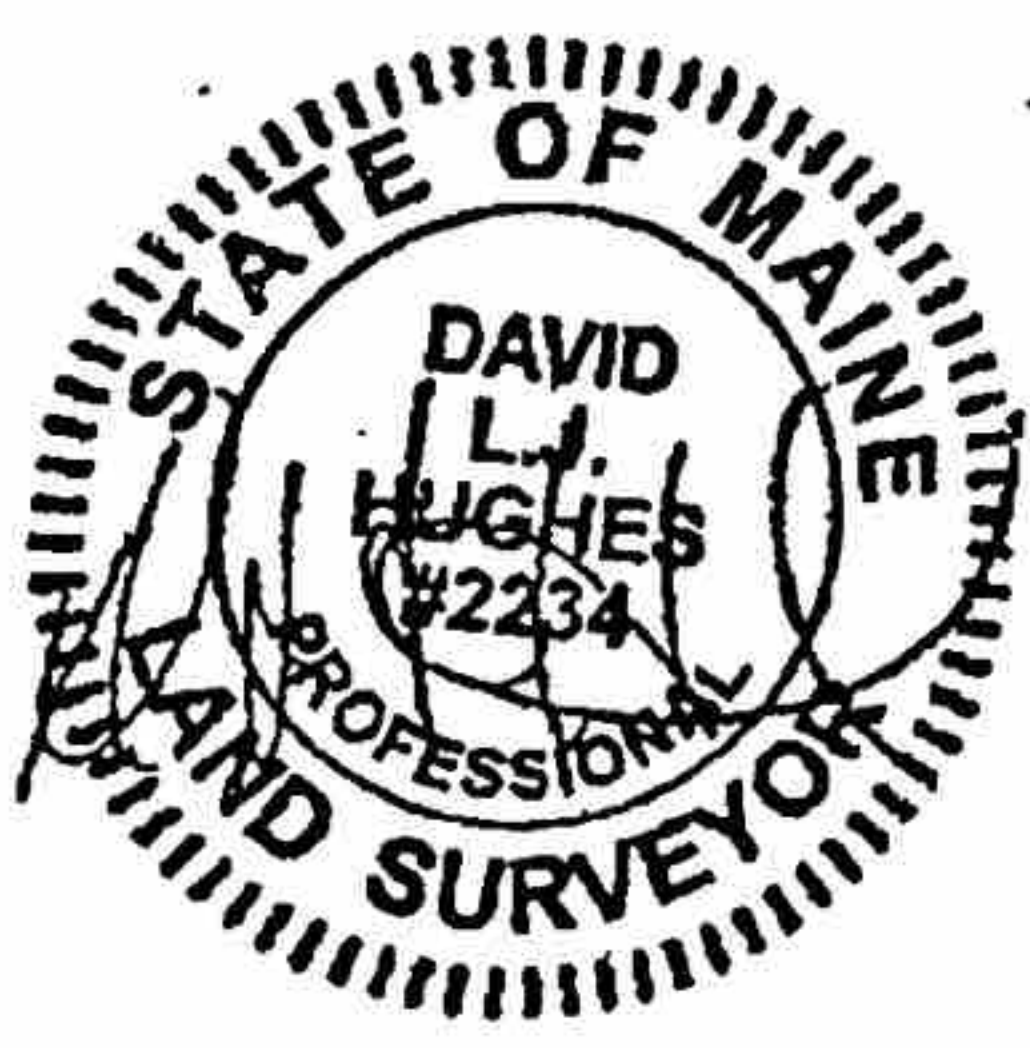
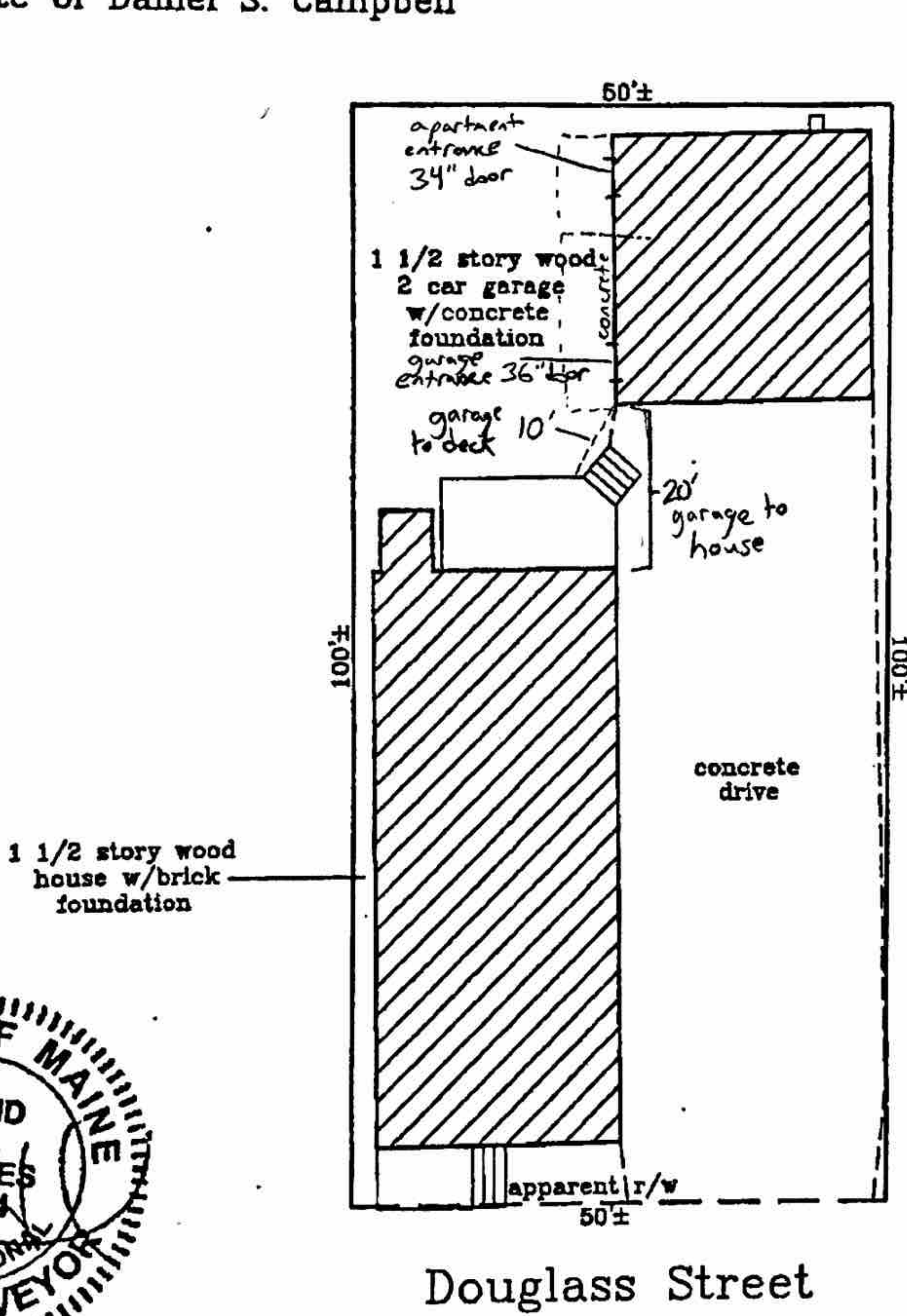

I HEREBY CERTIFY TO: Market Street Settlement Group, LLC, NE Moves Mortgage, LLC & its title insurer.

- Monuments found did not conflict with the deed description.
- The dwelling setbacks do not violate town zoning requirements.
- The dwelling setbacks do not violate the Federal Emergency Management Agency Community Panel:
- The structure does not fall within the special flood hazard zone.
- The land does not fall within the special flood hazard zone.
- A wetlands study has not been performed.

APPARENT EASEMENTS AND RIGHTS OF WAY ARE SHOWN. OTHER ENCUMBRANCES, RECORDED OR NOT, MAY EXIST. THIS SKETCH WILL NOT REVEAL ABUTTING DEED CONFLICTS, IF ANY.

Livingston-Hughes
 Professional Land Surveyors
 88 Guinea Road
 Kennebunkport, Maine 04048
 207-967-9761 phone 207-967-4831 fax
 www.livingstonhughes.com