

THIS IS NOT A BOUNDARY SURVEY

This copyrighted document expires 10-10-07. Reproduction and/or dissemination after this date is unauthorized.

MORTGAGE INSPECTION OF: DEED BOOK 7579 PAGE 41 COUNTY Cumberland
PLAN BOOK --- PAGE --- LOT ---

ADDRESS: 75 Douglass Street, Portland, Maine

Job Number: 600-68

Inspection Date: 07-10-07

Scale: 1" = 20'

Buyer: Jonathan Bradstreet

Client File #: 0207-00481

Seller: Estate of Daniel S. Campbell

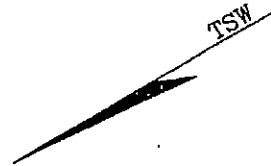
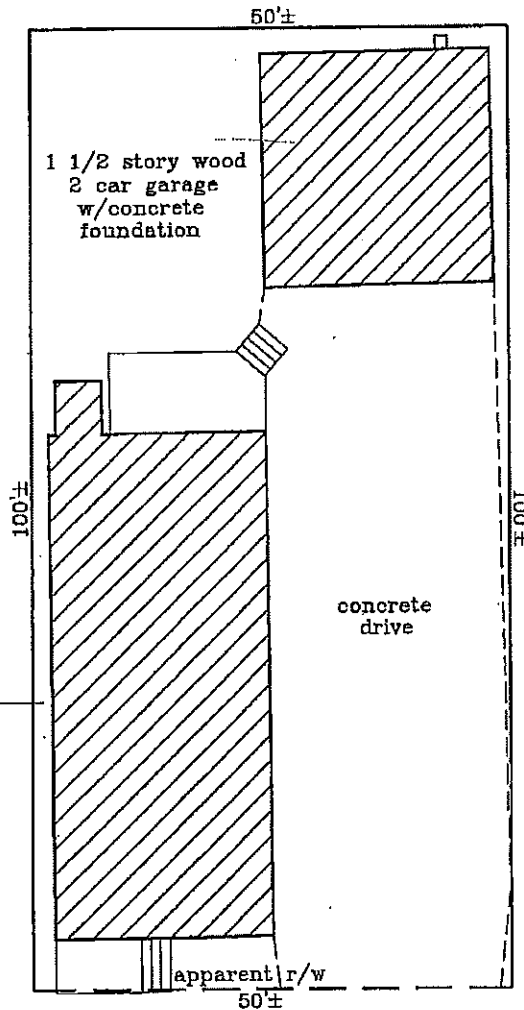

Douglass Street



I HEREBY CERTIFY TO: Market Street Settlement Group, LLC, NE Moves Mortgage, LLC & its title insurer.

Monuments found did not conflict with the deed description.

The dwelling setbacks do not violate town zoning requirements.

The structure does not fall within the special flood hazard zone.
The land does not fall within the special flood hazard zone.

A wetlands study has not been performed.

APPARENT EASEMENTS AND RIGHTS OF WAY ARE SHOWN. OTHER ENCUMBRANCES, RECORDED OR NOT, MAY EXIST. THIS SKETCH WILL NOT REVEAL ABUTTING DEED CONFLICTS, IF ANY.

copyright

Livingston-Hughes

Professional Land Surveyors

88 Guinea Road

Kennebunkport, Maine 04046

207-967-9761 phone

207-967-4831 fax

www.livingstonhughes.com

THIS SKETCH IS FOR MORTGAGE PURPOSES ONLY