

**GENERAL NOTES:**

1. THE EXISTING INSIDE FACE OF EXTERIOR WALLS WILL REMAIN EXPOSED BRICK.
2. THE EXISTING SPRINKLER SYSTEM WILL REMAIN.
3. THE EXISTING ROOF WILL REMAIN.
4. THE EXISTING EXTERIOR FACE WILL REMAIN.
5. THE WORK AREA WILL BE CLEARED OF HAZARDOUS MATERIALS PRIOR TO THE START OF WORK.
6. REFER TO STRUCTURAL DRAWINGS FOR ADDITIONAL INFORMATION.
7. CUT AREAS OF SLAB REMOVAL SQUARELY AND NEATLY.
8. THE GENERAL CONTRACTOR SHALL SALVAGE EQUIPMENT/ FIXTURES AS DIRECTED.
9. THE OWNER WILL SALVAGE EQUIPMENT FOR RE-USE PRIOR TO BEGINNING OF CONTRACTOR DEMOLITION.
10. SORT ALL CONSTRUCTION WASTE.
11. ASBESTOS REMOVAL TO BE COMPLETE PRIOR TO GC STARTING WORK.

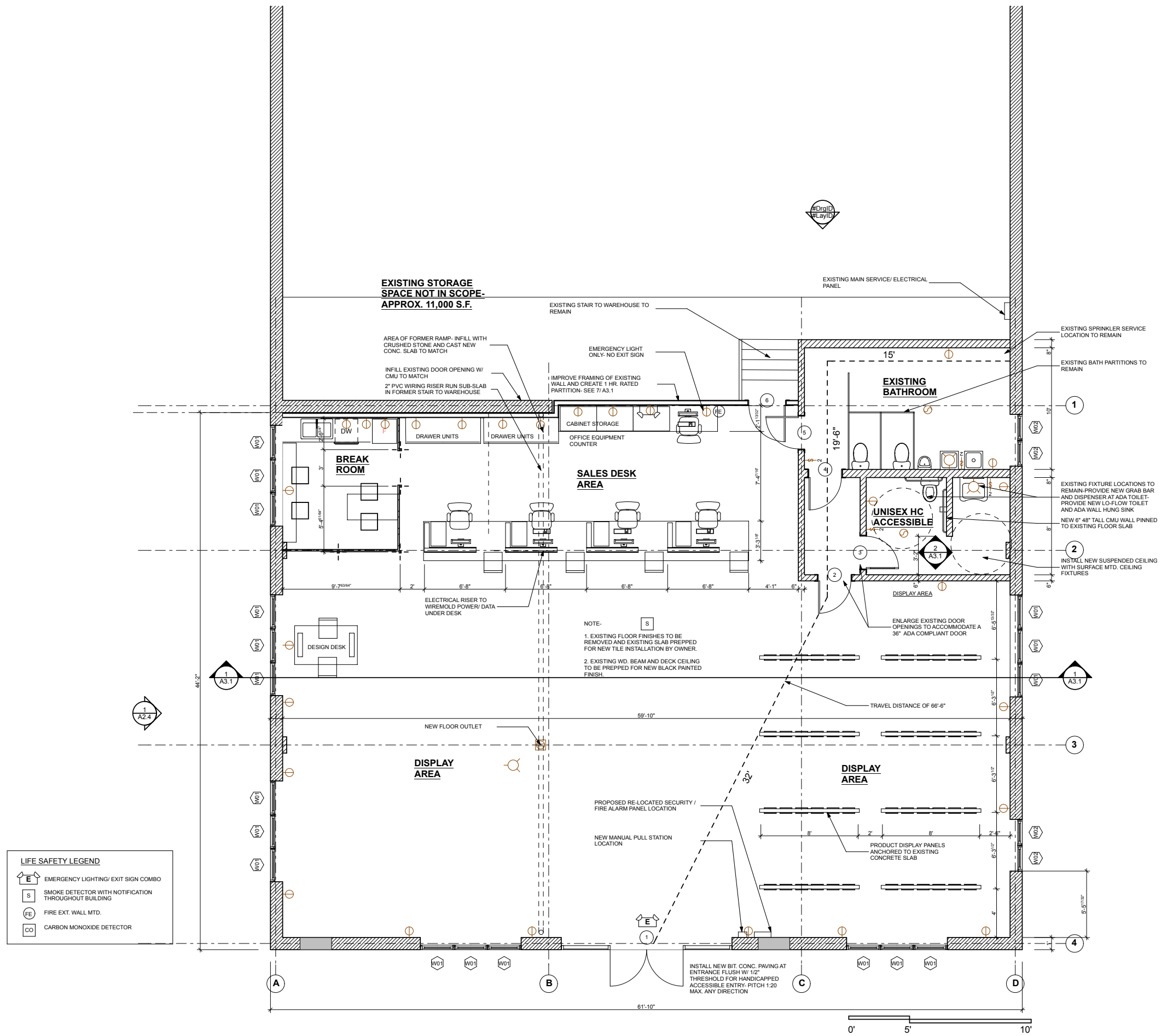

**LIFE SAFETY LEGEND**

- EMERGENCY LIGHTING/ EXIT SIGN COMBO
- SMOKE DETECTOR WITH NOTIFICATION THROUGHOUT BUILDING
- FIRE EXT. WALL MTD.
- CARBON MONOXIDE DETECTOR

**NOTE:**

1. EXISTING FLOOR FINISHES TO BE REMOVED AND EXISTING SLAB PREPPED FOR NEW TILE INSTALLATION BY OWNER.
2. EXISTING WD. BEAM AND DECK CEILING TO BE PREPPED FOR NEW BLACK PAINTED FINISH.

**1 GROUND FLOOR PLAN**  
SCALE: 1/4" = 1'-0"

THIS DRAWING IS AN INSTRUMENT OF SERVICE AND SHALL REMAIN THE PROPERTY OF WHIPPLE CALLENDER ARCHITECTS. IT SHALL NOT BE USED FOR ANY OTHER PURPOSE THAT FOR WHICH IT IS SPECIFICALLY FURNISHED.

**ALBERT F. FITZGERALD INC.**  
12 WESTFIELD ST.  
PORTLAND, MAINE

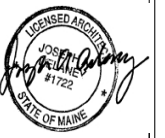

**WHIPPLE CALLENDER ARCHITECTS**

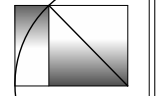

136 PLEASANT AVE.  
PORTLAND, ME 04103  
P 207.775.2696  
F 207.775.3631  
www.whipplecallender.com

MARK	DATE	DESCRIPTION

DATE: PERMIT 7.25.16  
CHECKED BY: JD  
DRAWN BY: JD/CC  
JOB: FITZ-2016  
SHEET TITLE:

**FLOOR PLAN**

**A1.1**