

City of Portland, Maine - Building or Use Permit Application

389 Congress Street, 04101 Tel: (207) 874-8703, Fax: (207) 874-8716

Permit No: 05-0815	PERMIT ISSUED JUN - 6 2005	BL: 016 A005001
-----------------------	-------------------------------	--------------------

Location of Construction: 52 Frederic St	Owner Name: Yc Portland Lp	Owner Address: 307 Cumberland Ave	Phone: 800-339-6516
Business Name:	Contractor Name: Blackbear Signworks	Contractor Address: 19 Industrial Park Road	Phone:
Lessee/Buyer's Name	Phone:	Permit Type: Signs - Permanent	Zone: C-31

Past Use: multifamily residence	Proposed Use: multifamily residence with 16"x47" sign (6 sq ft)	Permit Fee: \$42.00	Cost of Work: \$0.00	CEO District: 3
Proposed Project Description: erect freestanding 16"x47" sign at mutifamily residence		FIRE DEPT: <input type="checkbox"/> Approved <input type="checkbox"/> Denied	INSPECTION: Use Group: R2/B Type: SIGN IBC-2003 Signature: JMB 7/6/05	

PEDESTRIAN ACTIVITIES DISTRICT (P.A.D.)	
Action: <input type="checkbox"/> Approved <input type="checkbox"/> Approved w/Conditions <input type="checkbox"/> Denied	Signature: _____ Date: _____

Permit Taken By: jharris	Date Applied For: 06/20/2005	Zoning Approval	
-----------------------------	---------------------------------	------------------------	--

<p>1. This permit application does not preclude the Applicant(s) from meeting applicable State and Federal Rules.</p> <p>2. Building permits do not include plumbing, septic or electrical work.</p> <p>3. Building permits are void if work is not started within six (6) months of the date of issuance. False information may invalidate a building permit and stop all work..</p>	<p>Special Zone or Reviews</p> <input type="checkbox"/> Shoreland <input type="checkbox"/> Wetland <input type="checkbox"/> Flood Zone <input type="checkbox"/> Subdivision <input type="checkbox"/> Site Plan Maj. <input type="checkbox"/> Minor <input type="checkbox"/> MMS <input type="checkbox"/>	<p>Zoning Appeal</p> <input type="checkbox"/> Variance <input type="checkbox"/> Miscellaneous <input type="checkbox"/> Conditional Use <input type="checkbox"/> Interpretation <input type="checkbox"/> Approved <input type="checkbox"/> Denied	<p>Historic Preservation</p> <input checked="" type="checkbox"/> Not in District or Landmark <input type="checkbox"/> Does Not Require Review <input type="checkbox"/> Requires Review <input type="checkbox"/> Approved <input type="checkbox"/> Approved w/Conditions <input type="checkbox"/> Denied
	Date: <i>OK 6/30/05</i>	Date: <i>Southwarding</i>	Date: <i>[Signature]</i>

CERTIFICATION

I hereby certify that I am the owner of record of the named property, or that the proposed work is authorized by the owner of record and that I have been authorized by the owner to make this application as his authorized agent and I agree to conform to all applicable laws of this jurisdiction. In addition, if a permit for work described in the application is issued, I certify that the code official's authorized representative shall have the authority to enter all areas covered by such permit at any reasonable hour to enforce the provision of the code(s) applicable to such permit.

SIGNATURE OF APPLICANT	ADDRESS	DATE	PHONE
------------------------	---------	------	-------

RESPONSIBLE PERSON IN CHARGE OF WORK, TITLE	DATE	PHONE
---	------	-------

Signage/Awning Permit Application

If you or the property owner owes real estate or personal property taxes or user charges on any property within the City, payment arrangements must be made before permits of any kind are accepted.

Location/Address of Construction: <u>52 FREDERICK ST. PORTLAND, ME</u>		
Total Square Footage of Proposed Structure <u>656 FT</u>	Square Footage of Lot	
Tax Assessor's Chart, Block & Lot Chart# <u>076</u> Block# <u>A</u> Lot# <u>005</u>	Owner: <u>AVESTA HOOSING</u> <u>307 CUMBERLAND AVE. PORT.</u>	Telephone: <u>1-800-339-6516</u>
Lessee/Buyer's Name (if Applicable)	Applicant name, address & telephone: <u>BLACKBEAR SIGNWORKS</u> <u>19 INDUSTRIAL PARK ROAD</u> <u>SACO, ME 04072</u> <u>207-286-8004</u>	Total s.f. of signage x \$1.00 per s.f. plus \$30.00 = Total Fee: <u>656 SF</u> Awning Fee = Cost Of Work: \$ Total Fee: \$ <u>42.00</u>
Current use: <u>HOUSING / Commercial</u>	<div style="border: 1px solid black; padding: 5px; text-align: center;"> DEPT. OF BUILDING INSPECTION CITY OF PORTLAND, ME <div style="border: 1px solid black; padding: 5px; display: inline-block;"> JUN 2 2005 </div> RECEIVED </div>	
If the location is currently vacant, what was prior use: _____		
Approximately how long has it been vacant: _____		
Proposed use: _____		
Project description: <u>LOGANS PLACE SIGN 16" X 47"</u> <u>1.33 x 3.916 = 4.81 #</u>		
Contractor's name, address & telephone: <u>BLACKBEAR SIGNWORKS</u> <u>286-8004</u>		
Who should we contact when the permit is ready: <u>BO LAVEAULT</u>		
Mailing address: _____		
We will contact you by phone when the permit is ready. You must come in and pick up the permit and review the requirements before starting any work, with a Plan Reviewer. A stop work order will be issued and a \$100.00 fee if any work starts before the permit is picked up. PHONE: _____		

IF THE REQUIRED INFORMATION IS NOT INCLUDED IN THE SUBMISSIONS THE PERMIT WILL BE AUTOMATICALLY DENIED AT THE DISCRETION OF THE BUILDING/PLANNING DEPARTMENT. WE MAY REQUIRE ADDITIONAL INFORMATION IN ORDER TO APPROVE THIS PERMIT.

I hereby certify that I am the Owner of record of the named property, or that the owner of record authorizes the proposed work and that I have been authorized by the owner to make this application as his/her authorized agent. I agree to conform to all applicable laws of this jurisdiction. In addition, if a permit for work described in this application is issued, I certify that the Code Official's authorized representative shall have the authority to enter all areas covered by this permit at any reasonable hour to enforce the provisions of the codes applicable to this permit.

Signature of applicant: [Signature]

Date: 6/8/05

This is NOT a permit, you may not commence ANY work until the permit is issued.

DISPLAY THIS CARD ON PRINCIPAL FRONTAGE OF WORK CITY OF PORTLAND

Please Read Application And Notes, If Any, Attached

ENGINEERING SECTION

PERMIT

PERMIT ISSUED
Permit Number: 050815
JUN - 6 2005
CITY OF PORTLAND

This is to certify that Yc Portland Lp /Blackbear S works
has permission to erect freestanding 16"x47" sign at multifamily residence
AT 52 Frederic St 076 A005001

provided that the person or persons, firm or corporation accepting this permit shall comply with all of the provisions of the Statutes of Maine and of the ordinances of the City of Portland regulating the construction, maintenance and use of buildings and structures, and of the application on file in this department.

Apply to Public Works for street line and grade if nature of work requires such information.

Notification of inspection must be given and work on permit in progress before this building or part thereof is occupied or closed-in.
48 HOUR NOTICE IS REQUIRED.

A certificate of occupancy must be procured by owner before this building or part thereof is occupied.

OTHER REQUIRED APPROVALS

Fire Dept. _____
Health Dept. _____
Appeal Board _____
Other _____
Department Name _____

Jeanie Burke 7/6/05
Director - Building & Inspection Services

PENALTY FOR REMOVING THIS CARD

ACORD. CERTIFICATE OF LIABILITY INSURANCE

DATE
06/08/2005

PRODUCER
SOUTHERN MAINE INSURANCE
432 US RTE 1
P.O. Box 6803
SCARBOROUGH ME 04070-6803

THIS CERTIFICATE IS ISSUED AS A MATTER OF INFORMATION ONLY AND CONFERS NO RIGHTS UPON THE CERTIFICATE HOLDER. THIS CERTIFICATE DOES NOT AMEND, EXTEND OR ALTER THE COVERAGE AFFORDED BY THE POLICIES BELOW.

INSURERS AFFORDING COVERAGE

INSURED
BLACK BEAR SIGNWORKS
19 INDUSTRIAL PARK ROAD
SACO ME 04072-

INSURER A ZURICH
INSURER B HARTFORD
INSURER C
INSURER D
INSURER E

COVERAGES

THE POLICIES OF INSURANCE LISTED BELOW HAVE BEEN ISSUED TO THE INSURED NAMED ABOVE FOR THE POLICY PERIOD INDICATED NOTWITHSTANDING ANY REQUIREMENT, TERM OR CONDITION OF ANY CONTRACT OR OTHER DOCUMENT WITH RESPECT TO WHICH THIS CERTIFICATE MAY BE ISSUED OR MAY PERTAIN. THE INSURANCE AFFORDED BY THE POLICIES DESCRIBED HEREIN IS SUBJECT TO ALL THE TERMS, EXCLUSIONS AND CONDITIONS OF SUCH POLICIES AS AGGREGATE LIMITS SHOWN MAY HAVE BEEN REDUCED BY PAID CLAIMS.

INSR LTR	TYPE OF INSURANCE	POLICY NUMBER	POLICY EFFECTIVE DATE (MM/DD/YYYY)	POLICY EXPIRATION DATE (MM/DD/YYYY)	LIMITS
A	GENERAL LIABILITY	PPS34634130	03/15/2005	03/15/2006	EACH OCCURRENCE \$ 1,000,000
	<input checked="" type="checkbox"/> COMMERCIAL GENERAL LIABILITY				FIRE DAMAGE (Any one fire) \$ 1,000,000
	<input type="checkbox"/> CLAIMS MADE <input checked="" type="checkbox"/> OCCUR				REQ EXP (Any one person) \$ 10,000
	GEN'L AGGREGATE LIMIT APPLIES PER: <input type="checkbox"/> POLICY <input type="checkbox"/> PRO. <input type="checkbox"/> LOC				PERSONAL & ADY INJURY \$ 1,000,000
					GENERAL AGGREGATE \$ 2,000,000
					PRODUCTS - COM/PROP AGG \$ 2,000,000
B	AUTOMOBILE LIABILITY	04UBCOX4488	03/15/2005	03/15/2006	COMBINED SINGLE LIMIT (Per accident) \$ 300,000
	<input type="checkbox"/> ANY AUTO				BODILY INJURY (Per person) \$
	<input type="checkbox"/> ALL OWNED AUTOS				BODILY INJURY (Per accident) \$
	<input checked="" type="checkbox"/> SCHEDULED AUTOS				PROPERTY DAMAGE (Per accident) \$
	<input type="checkbox"/> HIRED AUTOS				AUTO ONLY - EA ACCIDENT \$
	<input type="checkbox"/> NON-OWNED AUTOS				OTHER THAN EA ACC \$
					AUTO ONLY: AGG \$
	GARAGE LIABILITY				EACH OCCURRENCE \$
	<input type="checkbox"/> ANY AUTO				AGGREGATE \$
					\$
					\$
	EXCESS LIABILITY				\$
	<input type="checkbox"/> OCCUR <input type="checkbox"/> CLAIMS MADE				\$
	<input type="checkbox"/> DEDUCTIBLE				\$
	<input type="checkbox"/> RETENTION \$				\$
B	WORKERS COMPENSATION AND EMPLOYERS LIABILITY	04WCCGU8077	03/15/2005	03/15/2006	<input checked="" type="checkbox"/> W.C. STAT. <input type="checkbox"/> D.W. FR.
					E.L. EACH ACCIDENT \$ 100,000
					E.L. DISEASE - EA EMPLOYEE \$ 100,000
					E.L. DISEASE - POLICY LIMIT \$ 500,000
	OTHER				

DESCRIPTION OF OPERATOR, LOCATION, VEHICLES, EXCLUSIONS ADDED BY ENDORSEMENTS/SPECIAL PROVISIONS

CERTIFICATE HOLDER	ADDITIONAL INSURED, INSURER LETTER:	CANCELLATION
CITY OF PORTLAND		SHOULD ANY OF THE ABOVE DESCRIBED POLICIES BE CANCELLED BEFORE THE EXPIRATION DATE THEREOF, THE ISSUING INSURER WILL ENDEAVOR TO MAIL 10 DAYS WRITTEN NOTICE TO THE CERTIFICATE HOLDER NAMED TO THE LEFT, BUT FAILURE TO DO SO SHALL IMPOSE NO OBLIGATION OR LIABILITY OF ANY KIND UPON THE INSURER, ITS AGENTS OR REPRESENTATIVES.
PORTLAND ME 04101-		AUTHORIZED REPRESENTATIVE <i>Barbara J. Welch</i>

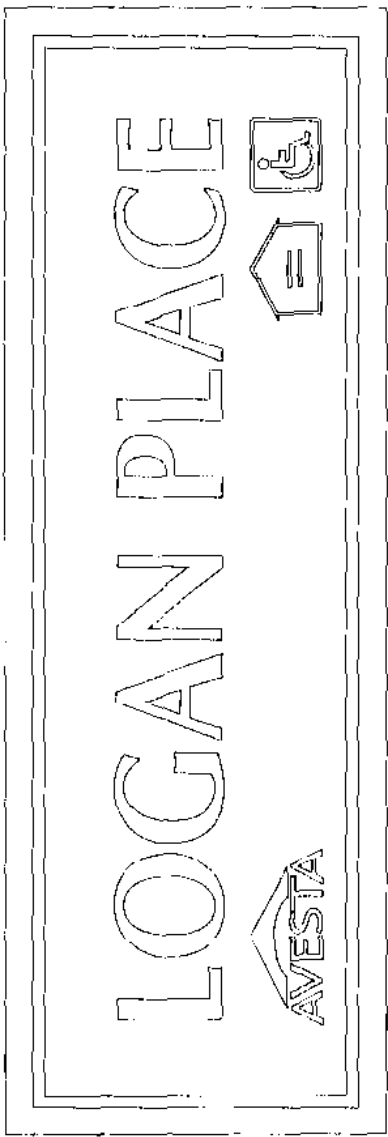

"91

47"

5' ±
from grade
to top of
sign -
per BO
on 6/30/05

per BO 7/6/05
↓

Free standing on 2" ^{in ground} off pole

↓
Per BO on 6/30/05 he is just digging
holes in the dirt & putting the poles
in them & backfilling - NO concrete

LOGAN PLACE

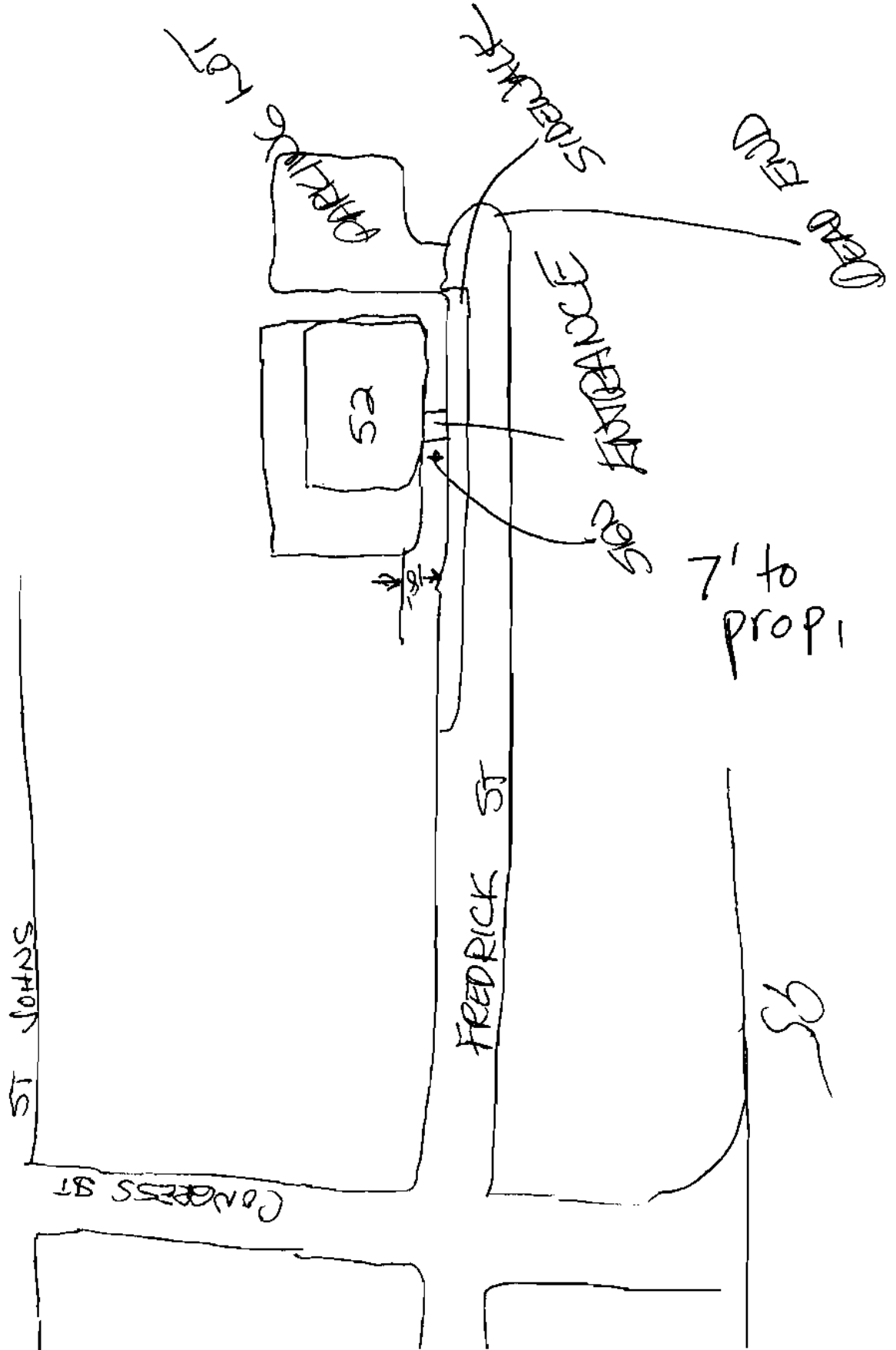

Table 2.2

Institutional Uses in Residential Zones

(Regulations apply to institutions permitted as conditional uses in residential zoning districts. Such uses may include, but are not necessarily limited to, churches, schools, private clubs, fraternal organizations and hospitals.)

↓ showing 4.81 ft - 5' high
7' setback from property line

Freestanding

	Street Frontage < 100'	Street Frontage 100' to 250'	Street Frontage > 250'
- Area	15 sq. ft.	25 sq. ft.	50 sq. ft.
- Height	6 ft.	8 ft.	8 ft.
- Setback	5 ft.	5 ft.	5 ft.
- # Freestanding signs per lot	1/st. frontage (a)(b)	1/st. frontage (a)(b)	1/st. frontage (a)(b)

(a) Lots fronting on two or more streets are allowed one freestanding sign for each frontage. However, the area of each sign shall correspond to the length of the applicable frontage. Freestanding signs shall be positioned such that they are not readily concurrently visible.

(b) Where one lot contains more than one affiliated use, each use shall be allowed one sign per street frontage.

Note: Pertinent directional information shall, to the extent possible, be included on the principal freestanding sign. Additional directional signs shall be allowed only in the event that necessary information cannot fit reasonably within the permitted sign area. The size of additional signs shall be the minimum necessary to achieve the informational objective.

Building Signs (a)

- Maximum permitted sign area	na
- % of wall area on which sign is to be placed	5%
- # building signs permitted per lot	1/bldg. face (b)

(a) Building signs shall be reviewed for compliance with sign standard(s) included in site plan ordinance and shall under no circumstances be internally illuminated.

(b) One sign is allowed per building face provided such signs are not readily concurrently visible.



CITY OF PORTLAND, MAINE
 Department of Building Inspections

June 20 2005

Received from Black Bear Signworks

Location of Work 52 FREDERIC

Cost of Construction \$ _____

Permit Fee \$ 42.00

Building (IL) Plumbing (IS) _____ Electrical (I2) _____ Site Plan (U2) _____

Other Sign

CEL: 76-A-005

Check # 0783

Total Collected \$ 42.00

THIS IS NOT A PERMIT

No work is to be started until PERMIT CARD is actually posted upon the premises. Acceptance of fee is no guarantee that permit will be granted. PRESERVE THIS RECEIPT. In case permit cannot be granted the amount of the fee will be refunded upon return of the receipt less \$10.00 or 10% whichever is greater.

Yerrin
 HITE - Applicant's Copy
 ELLOW - Office Copy
 BK - Permit Copy

City of Portland, Maine - Building or Use Permit

389 Congress Street, 04101 Tel: (207) 874-8703, Fax: (207) 874-8716

Permit No: 05-0815	Date Applied For: 06/20/2005	CBL: 076 A005001
-----------------------	---------------------------------	---------------------

Location of Construction: 52 Frederic St	Owner Name: Yc Portland Lp	Owner Address: 307 Cumberland Ave	Phone: 800-339-6516
Business Name:	Contractor Name: Blackbear Signworks	Contractor Address: 19 Industrial Park Road Saco	Phone:
Lessee/Buyer's Name	Phone:	Permit Type: Signs - Permanent	

Proposed Use: multifamily residence with 16"x47" sign (6 sq ft)	Proposed Project Description: erect freestanding 16"x47" sign at multifamily residence
--	---

Dept: Zoning Status: Approved with Conditions Reviewer: Marge Schrumckal Approval Date: 06/30/2005

Note: 6/30/05 talked to Bo to get the information that is required with a submittal

Ok to Issue:

- 1) This permit is based upon verbal information given by Bo Laveault at the sign company which was not properly submitted at the time of application.

Dept: Building Status: Approved with Conditions Reviewer: Jeanine Bourke Approval Date: 07/06/2005

Note: 7/6 verified w/Bo the poles & depth, ok to issue

Ok to Issue:

- 1) Signage Installation to comply with Chapter 31 of the IBC 2003 building code.