

1 HANDICAP PARKING SIGNAGE
NOT TO SCALE

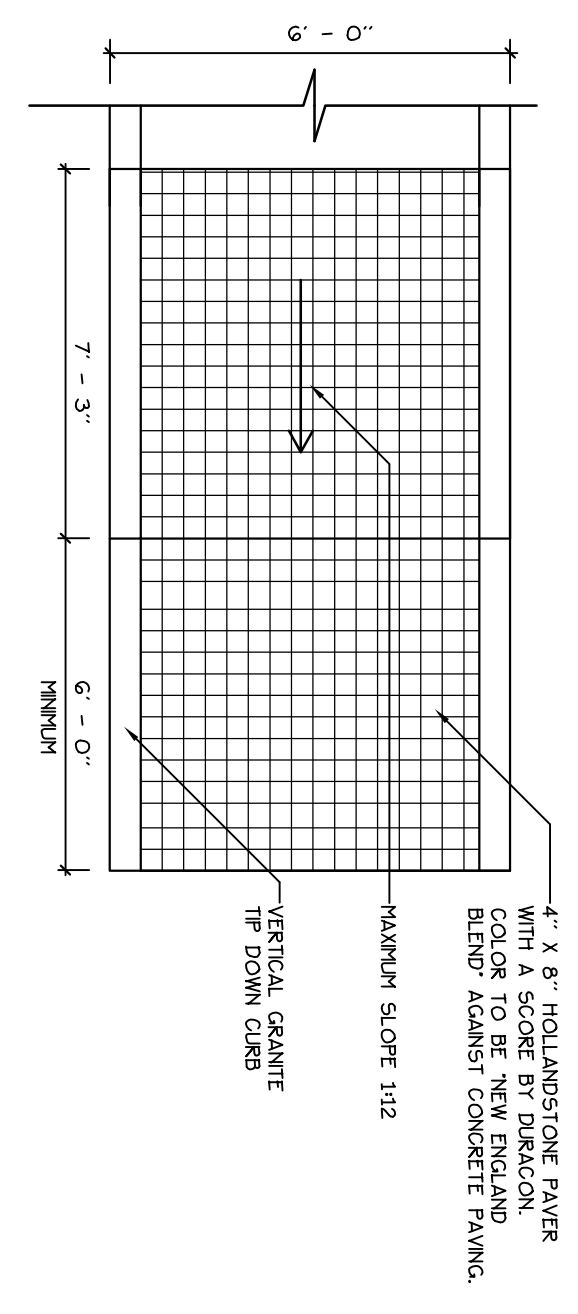

2 HANDICAP RAMP TYPE A
NOT TO SCALE

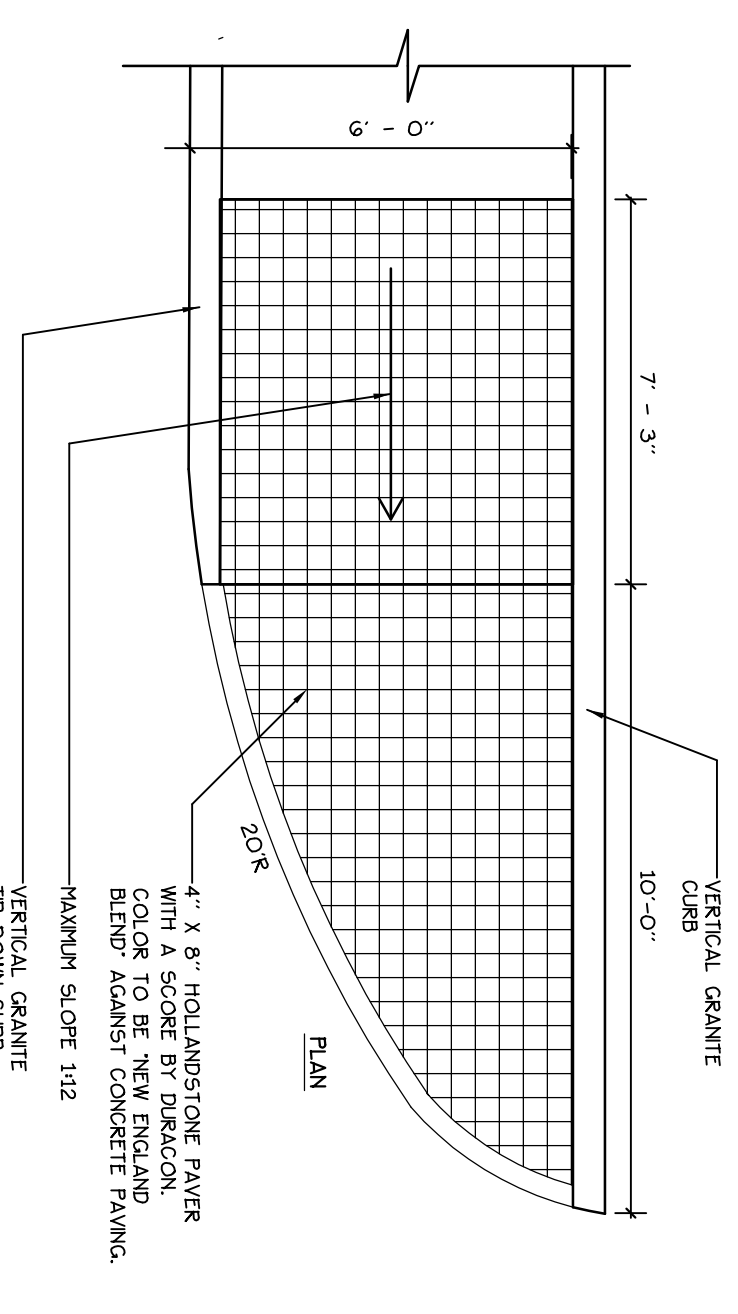

3 HANDICAP RAMP TYPE B
NOT TO SCALE

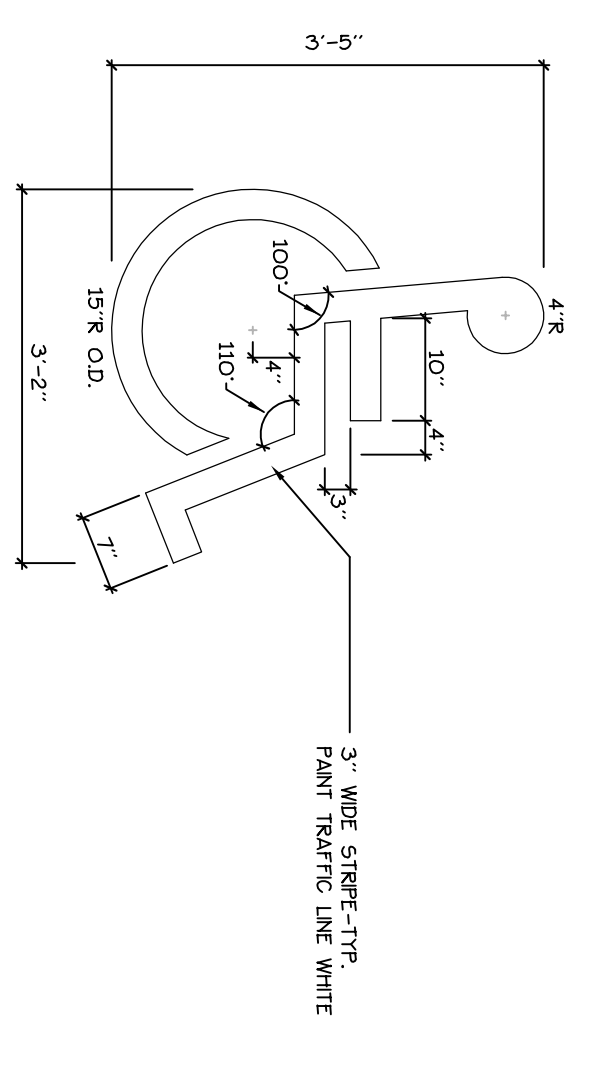

4 HANDICAP SPACE MARKINGS
NOT TO SCALE

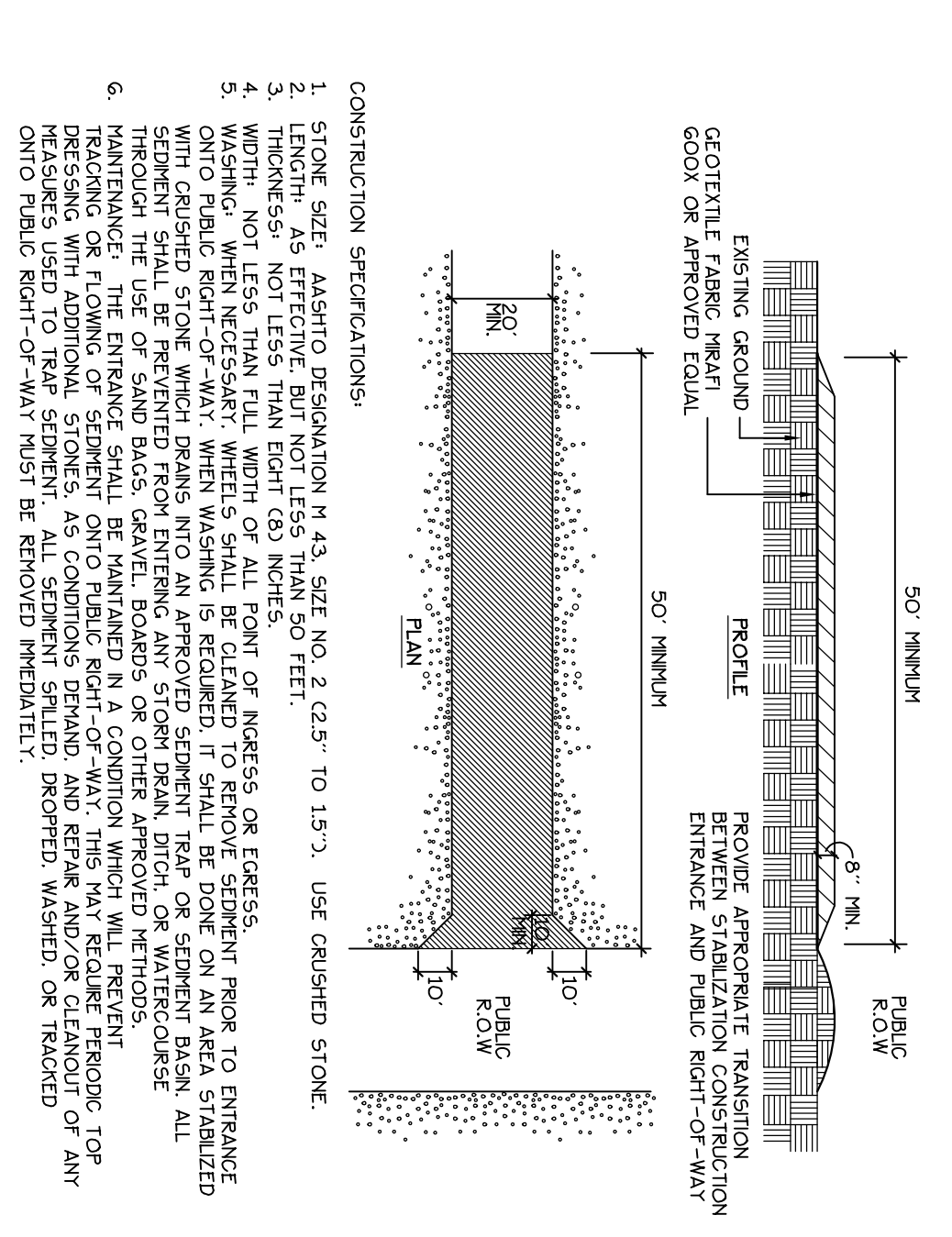

5 STABILIZED CONSTRUCTION ENTRANCE
NOT TO SCALE

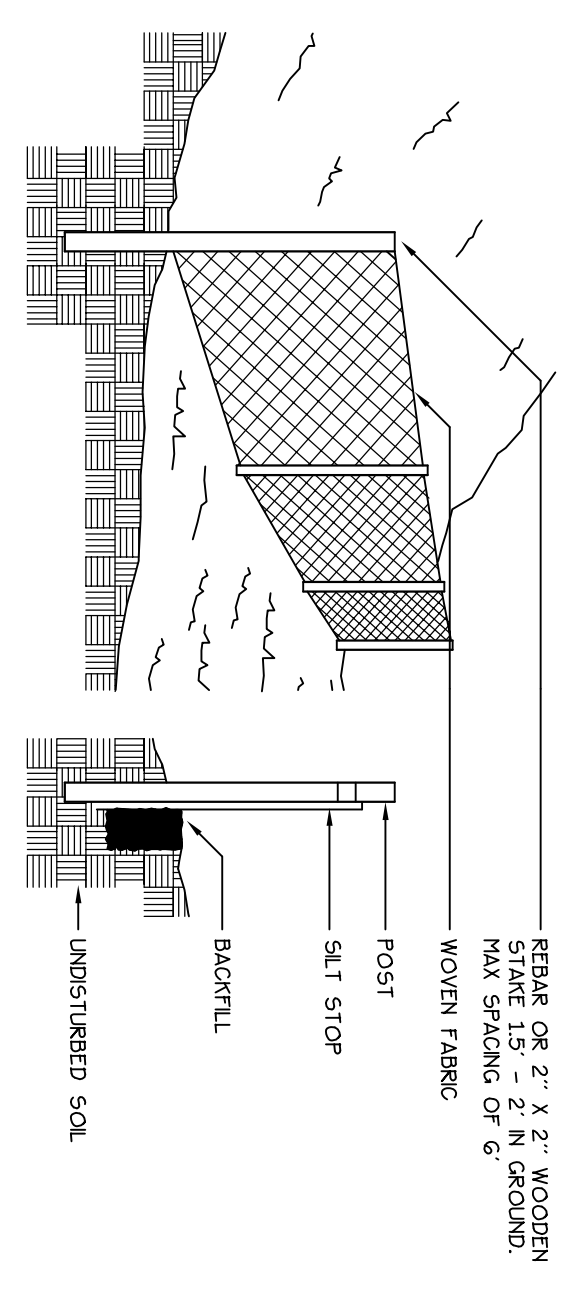

6 END POST OVERLAP DETAIL
NOT TO SCALE

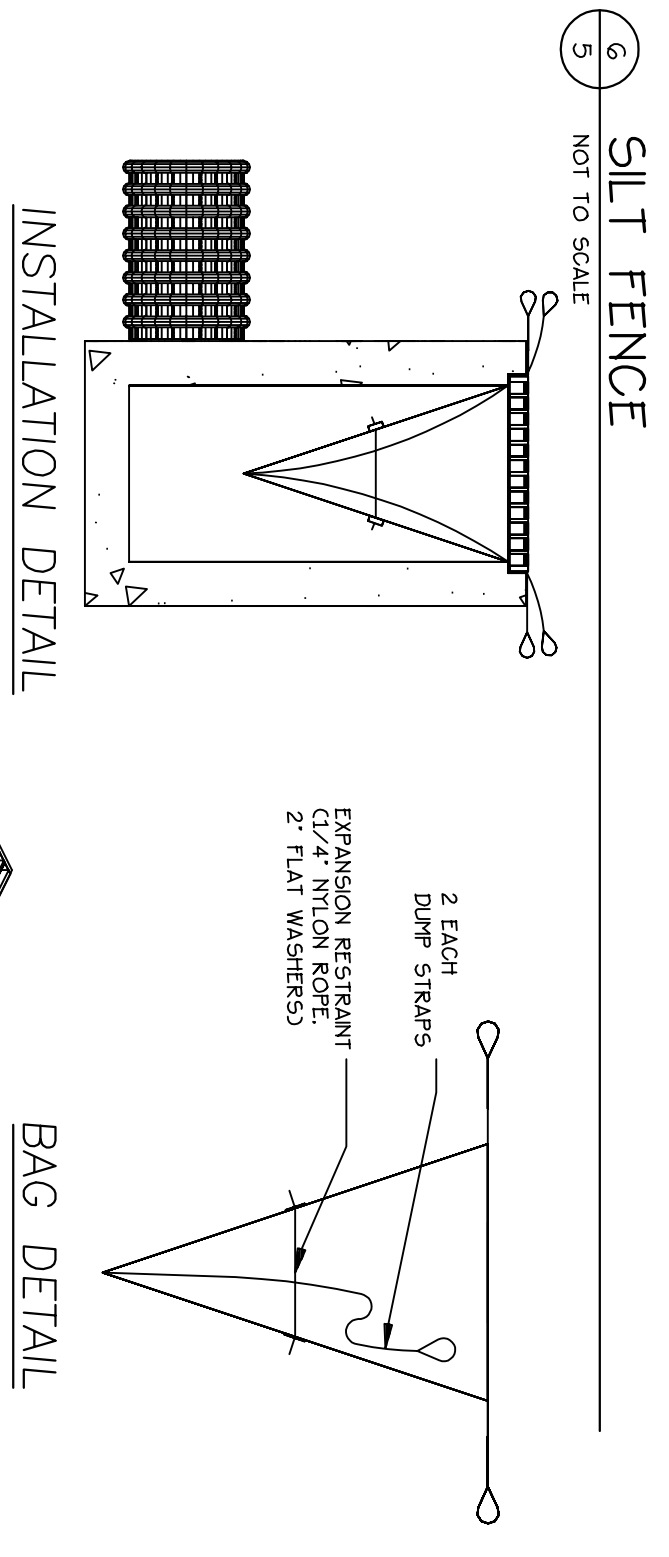

7 INLET SEDIMENT CONTROL DEVICE
NOT TO SCALE

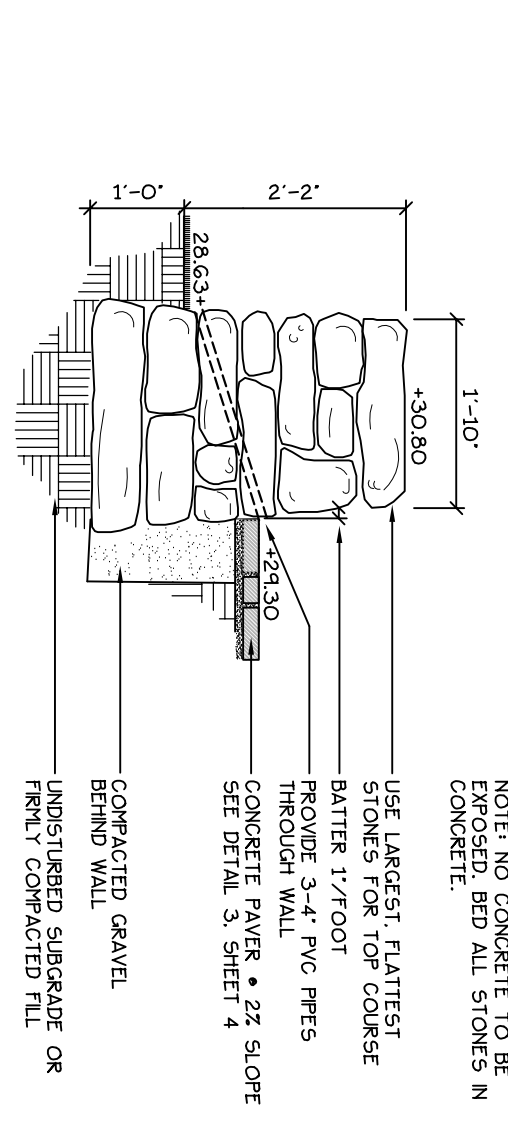

8 STONE WALL AT ENTRANCE
NOT TO SCALE

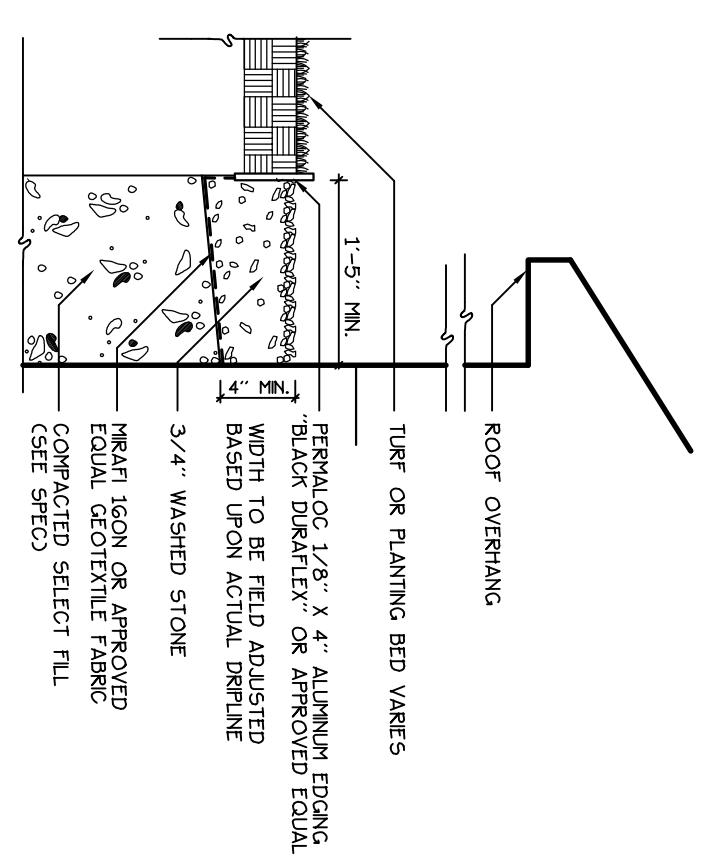

9 DRIFT STRIP DETAIL
NOT TO SCALE

EROSION AND SEDIMENTATION CONTROL PLAN

THIS PLAN HAS BEEN DEVELOPED AS A STRATEGY TO CONTROL SOIL EROSION AND SEDIMENTATION DURING AND AFTER THE CONSTRUCTION OF LOGAN PLACE PHASE 1 LOCATED AT 52 FREDERIC STREET, PORTLAND, MAINE. THIS PLAN IS BASED ON THE MAINE EROSION AND SEDIMENTATION CONTROL HANDBOOK FOR CONSTRUCTION BEST MANAGEMENT PRACTICES, MARCH, 1991.

A. PROPOSED DEVELOPMENT

THE PROJECT CONSISTS OF THE CONSTRUCTION OF A PROPOSED 30 UNIT SINGLE ROOM OCCUPANCY BUILDING, THE BUILDING AND PARKING WITH THEIR ASSOCIATED GRADING, DRAINAGE, THE LIMITS OF PROPOSED EARTH MOVEMENT FOR THE DEVELOPMENT, THE HORIZONTAL AND VERTICAL ALIGNMENT OF THE PROPOSED DRIVEWAY, AND THE CONSTRUCTION OF THE DRIVEWAY AND DRIVEWAY APPROACHES AVAILABLE.

B. EROSION CONTROL PRACTICES/TEMPORARY MEASURES

THE FOLLOWING TEMPORARY MEASURES TO CONTROL EROSION AND SEDIMENTATION SHALL BE UTILIZED:
EACH GROUND AREA OPENED OR EXPOSED WHETHER DIRECTLY OR INDIRECTLY DUE TO THE DEVELOPMENT, SHALL BE MINIMIZED AND SHALL BE STABILIZED WITHIN 15 DAYS OF INITIAL DISTURBANCE OF SOIL AND SHALL BE PERMANENTLY STABILIZED WITHIN SEVEN DAYS OF FINAL GRADING. THIS STABILMENT APPLIES TO DISTURBED AREAS BEYOND THE LIMITS OF THE PROPOSED BUILDING. EXPOSED AREAS SHALL BE STABILIZED FROM TOP TO BOTTOM AND SHALL BE EITHER BY TEMPORARY MULCHING, TEMPORARY SEEDING, PERMANENT BASE GRAVEL, OR ASPHALT BINDER COURSE AS FOLLOWS:
TEMPORARY SEEDING: SEED SHALL BE ARBORESCENT RYE APPLIED AT 2.0G#/1000 SF. LIME SHALL BE AGRICULTURAL GROUND LIMESTONE APPLIED AT 13.8#/#1000 SF. FERTILIZER SHALL BE 10-10-10 CLASSIFICATION APPLIED AT 13.8#/#1000 SF. MULCH SHALL CONSIST OF HAY AND STRAW MULCH AND SPREAD MADE BETWEEN APRIL 15 AND OCTOBER 1, AND SHALL NOT BE PLACED OVER SNOW.
TEMPORARY MULCHING: MULCH SHALL CONSIST OF CHOPPED HAY OR STRAW MULCH AND SPREAD BY MECHANICAL BLOWER EVENLY AT A RATE OF 15G-20G#/1000 SF. TEMPORARY MULCH SHALL BE REMOVED PRIOR TO PERMANENT SOIL STABILIZATION. MULCH MUST NOT BE PLACED OVER SNOW, SNOW REMOVAL MUST BE COMPLETED UNDER THE FOLLOWING CONDITIONS:
a) TEMPORARY SOIL STABILIZATION UNDER THE FOLLOWING CONDITIONS:
1) GRAVEL SHALL MEET THE SPECIFICATIONS FOR BASE OR SUBBASE GRAVEL FOR THE PROPOSED COMPLETED PAVEMENT.
2) ASPHALT BINDER COURSE: ASPHALT BINDER SHALL MEET THE SPECIFICATIONS FOR THE ASPHALT BINDER COURSE FOR THE PROPOSED COMPLETED PAVEMENT.

C. EROSION CONTROL PRACTICES/PERMANENT MEASURES

THE FOLLOWING PERMANENT MEASURES TO CONTROL EROSION AND SEDIMENTATION SHALL BE UTILIZED:
1. PERMANENT SEEDING SHALL BE PERFORMED DURING CONSTRUCTION OPERATIONS TO PROTECT EXPOSED AREAS FROM EROSION AND FRESH GRADE. PERMANENT SEEDING SHALL BE PERFORMED WITHIN SEVEN DAYS OF FRESH GRADE. KILLING FROST, DORMANT SEEDING, AND MULCH SHALL BE USED AT TWO TIMES THE PERMANENT SEEDING, AND MULCHING RATE SHOWN BELOW FOR BOTH LAWN AS WELL AS ERMARKMENTS. SEED LOAD: LIME, FERTILIZER AND MULCH ARE TO BE AS FOLLOWS:
SEED: THE SEED MIXTURE SHALL CONSIST OF SEED PROPORTIONED BY WEIGHT. ALL SEED SHALL BE FRESH, CLEAN, NEW CROP, SEED, HARNESS NEET MATTER AND WEED SEEDS SHALL BE PERMITTED UP TO ONE PERCENT OF THE GROSS WEIGHT OF EACH VARIETY OF SEED. ALL SEED SUPPLIED SHALL BE PACKED IN APPROVED CONTAINERS BEARING THE MANUFACTURER'S NAME AND ANALYSIS OF CONTENTS. THE FOLLOWING MATERIALS AND APPLICATION RATES SHALL BE REQUIRED FOR PERMANENT SEEDING:
LAWN SEEDING: RED ESCALPEL, 0.63#/#1000 SF
KENTUCKY BLUEGRASS, 0.57#/#1000 SF
PERENNIAL RITEGRASS, 0.42#/#1000 SF
FERTIOP, 0.12#/#1000 SF
TOTAL: 1.64#/#1000 SF

F. SITE INSPECTION + MAINTENANCE

WENTY INSPECTIONS, AS WELL AS ROUTINE INSPECTIONS FOLLOWING RAINFALLS OF 1.2" OVER A CONSECUTIVE 24-HOUR PERIOD, SHALL BE CONDUCTED BY THE SITE CONTRACTOR OF ALL TEMPORARY AND PERMANENT EROSION CONTROL DEVICES UNTIL FINAL ACCEPTANCE OF THE PROJECT. NECESSARY REPAIRS SHALL BE MADE TO CORRECT UNDERMINING OR DETRIORATION. FINAL ACCEPTANCE SHALL INCLUDE SITE INSPECTION TO VERIFY THE STABILITY OF ALL DISTURBED AREAS AND TO VERIFY THAT ALL EXPOSED AREAS HAVE BEEN STABILIZED AND SLOPED TO PREVENT EROSION. REPAIRS SHALL IMMEDIATELY BE CLEANED AND REPAIRED BY THE SITE CONTRACTOR AFTER STOREY EVENTS. DISPOSAL OF ALL TEMPORARY EROSION CONTROL DEVICES SHALL BE THE RESPONSIBILITY OF THE SITE CONTRACTOR. CONTINUED TEMPORARY MAINTENANCE AND LONG TERM PROVISIONS FOR PERMANENT MAINTENANCE OF ALL EROSION AND SEDIMENTATION CONTROL FACILITIES AFTER ACCEPTANCE OF THE PROJECT SHALL BE THE RESPONSIBILITY OF THE PORTLAND, LP.

Prepared For:
YC Portland, LP
307 Cumberland Avenue
Portland, Maine 04101
Tel: (207) 553-7777

Prepared By:
MITCHELL & ASSOCIATES
100 State Street
Portland, Maine 04101
Tel: (207) 774-4277

LOGAN PLACE

52 Frederic Street
Portland, Maine

Date:
JANUARY 14, 2004

Revisions:

Representation of nature of this document without the expressed written consent of Mitchell & Associates is prohibited.

Scale:

THE SITE DETAILS AND EROSION & SEDIMENTATION CONTROL PLAN

North:

Sheet No.:

5

North: