

**Francis
Caufman
Foley
Hoffmann**

Francis Cauffman 2120 Arch Street
Portland, ME 04103
Architects Ltd. 215-588-8250

**STRUCTURAL ENGINEER
FRANCIS CAUFFMAN
AND ASSOCIATES**
SUITE 175 141 BROAD
PORTLAND, ME 04103
P (603) 644-8570
F (603) 644-8572

**M/E/P ENGINEER
FRANCIS CAUFFMAN
AND ASSOCIATES**
1500 WALKER STREET, SUITE 1400
PHILADELPHIA, PA 19102
P 215-252-2106
F 215-252-2108

Revisions
11-20-06
CONSTRUCTION DOCUMENTS ISSUED

Sheet
WALL SECTION

Project Title
Landmark Healthcare
Facilities LLC

Fore River Medical
Pavilion
Portland, Maine

Date
NOVEMBER 20, 2006

Project Number
F06-5103

Drawing Number

A3.01

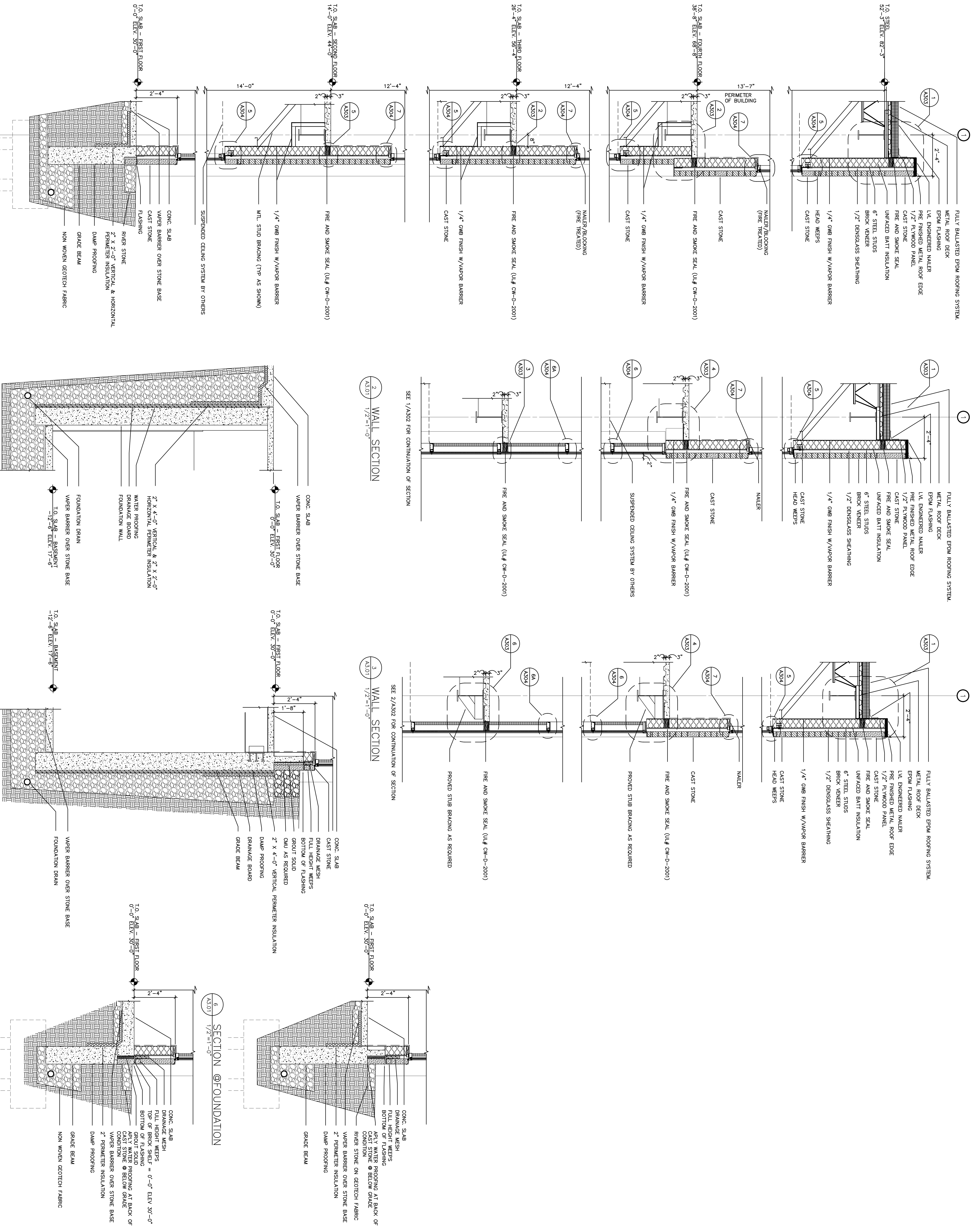

1 WALL SECTION
1/2"=1'-0"

4 WALL SECTION @ BASEMENT
1/2"=1'-0"

5 WALL SECTION @ BASEMENT
1/2"=1'-0"

7 SECTION @ FOUNDATION
1/2"=1'-0"