

A DAILY SPECIAL COUNTER ITEM #90

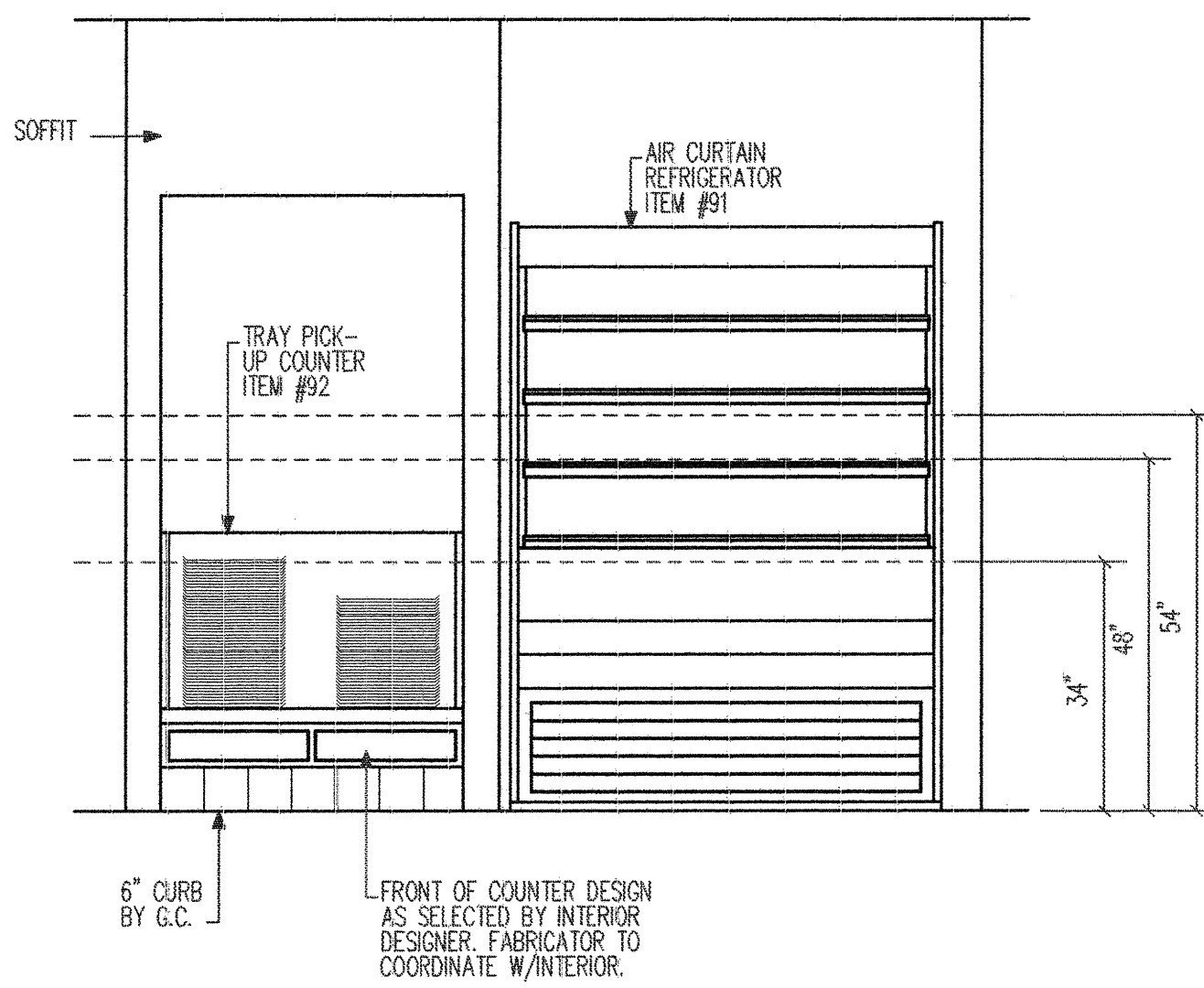

B TRAY PICK-UP COUNTER ITEM #92

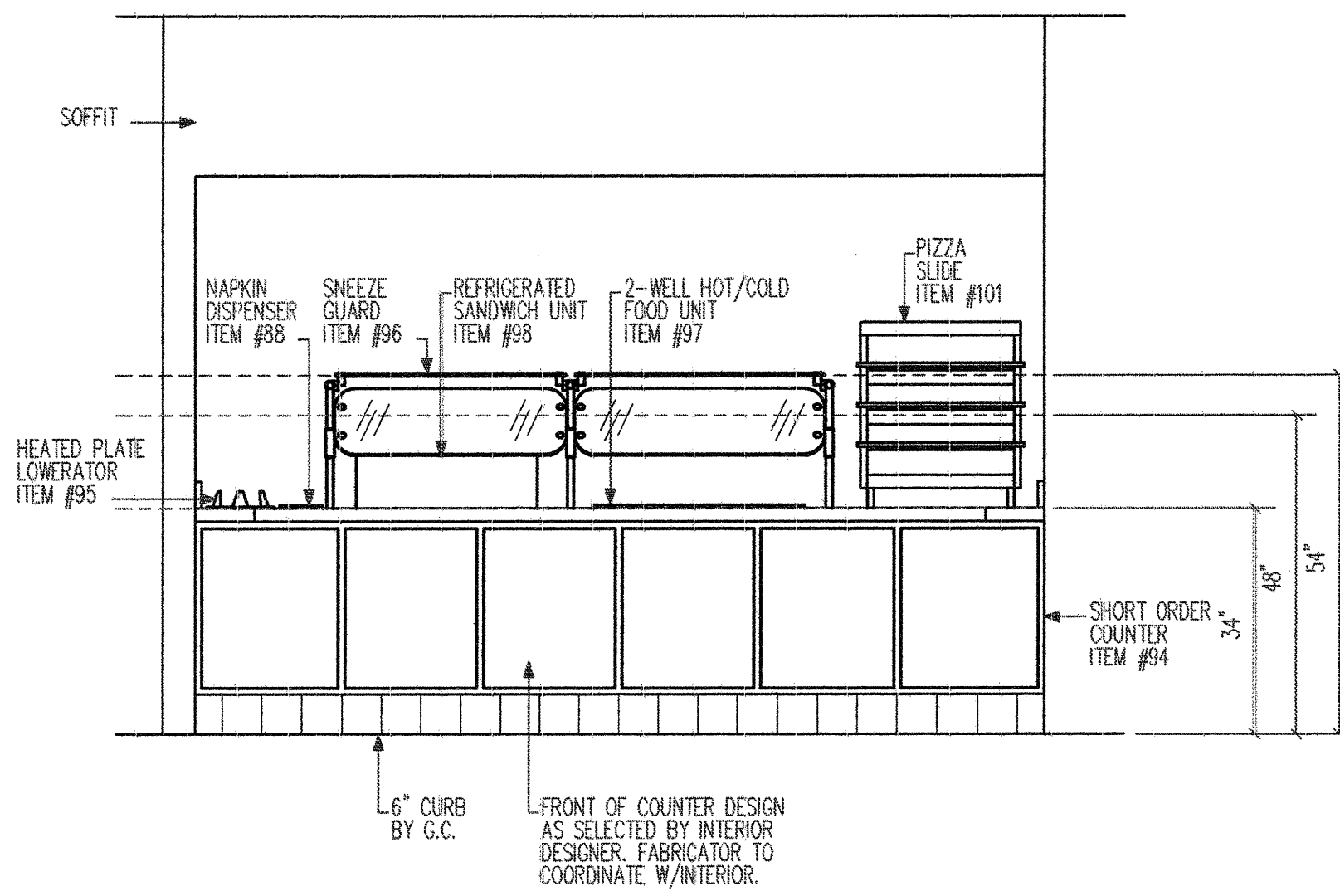

C SHORT ORDER COUNTER ITEM #94

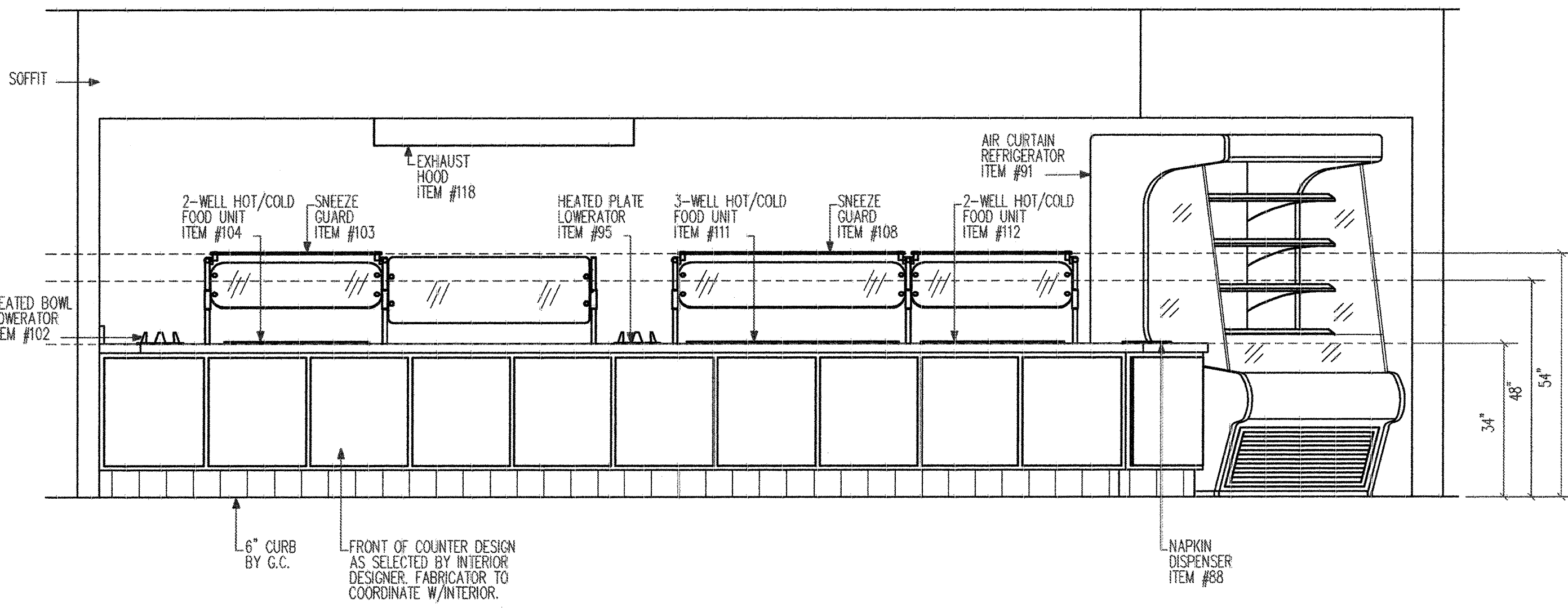

D ENTREE COUNTER ITEM #113

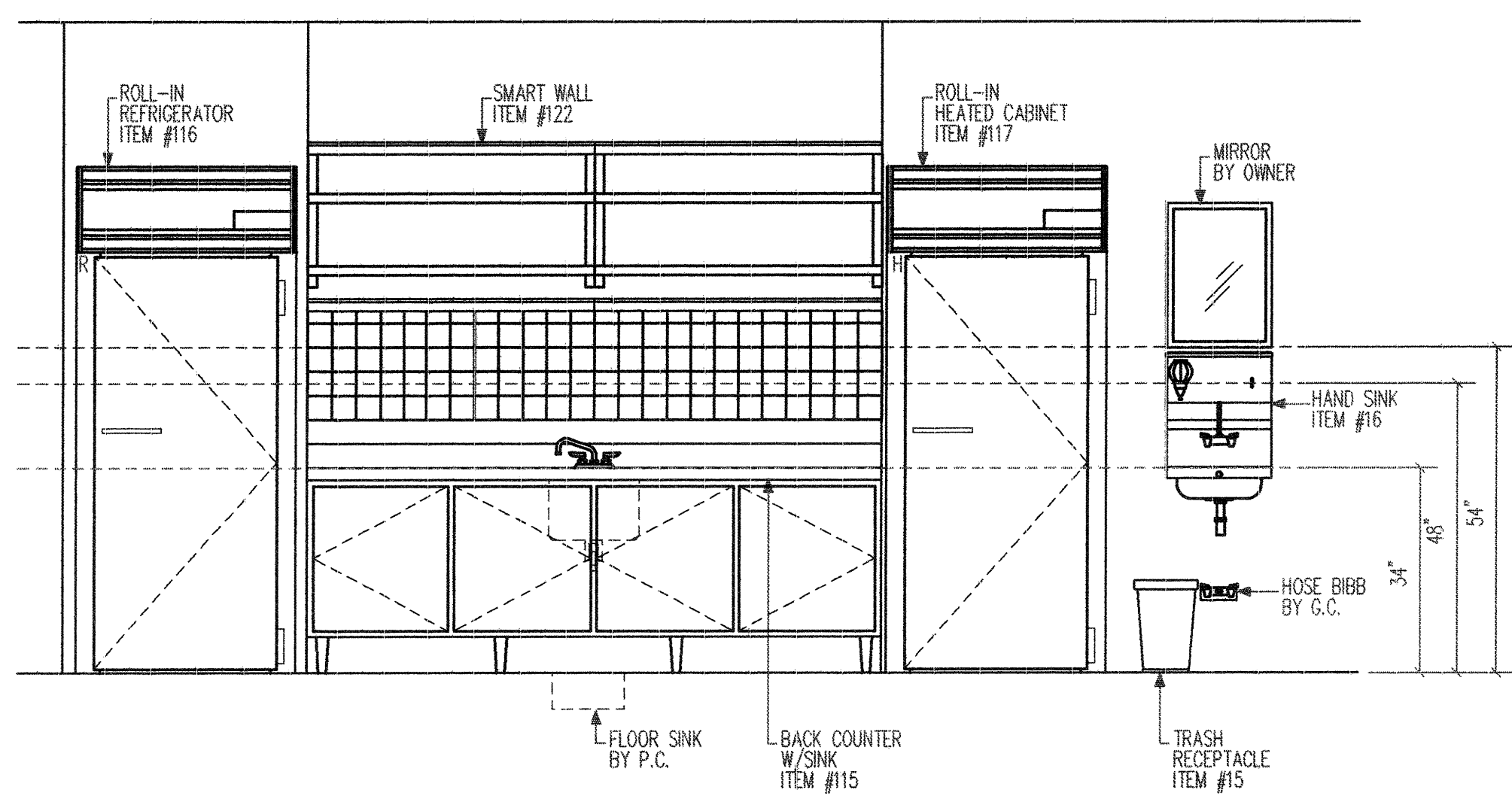

E BACK COUNTER W/SINK ITEM #115

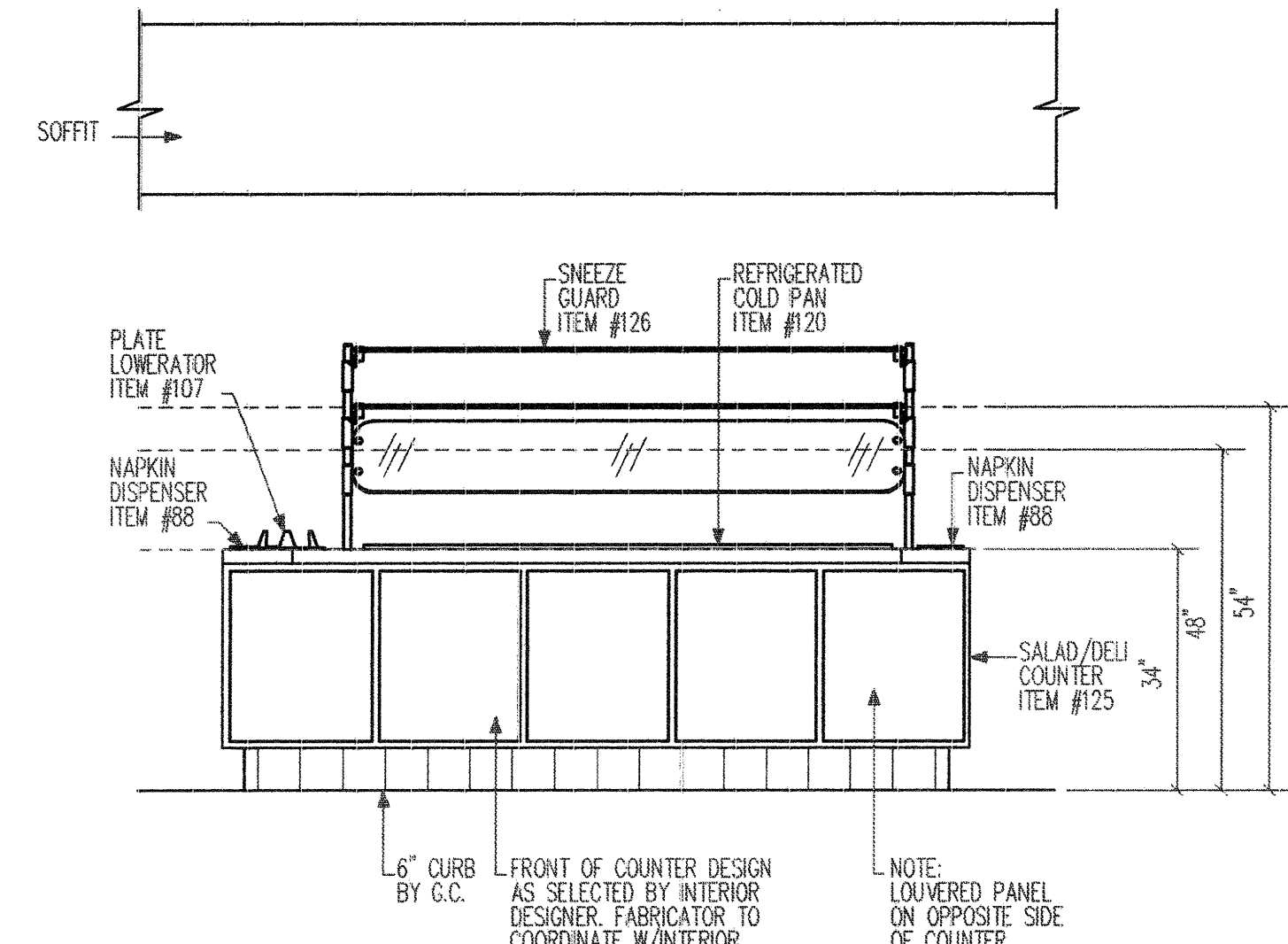

F SALAD/DELI COUNTER ITEM #125

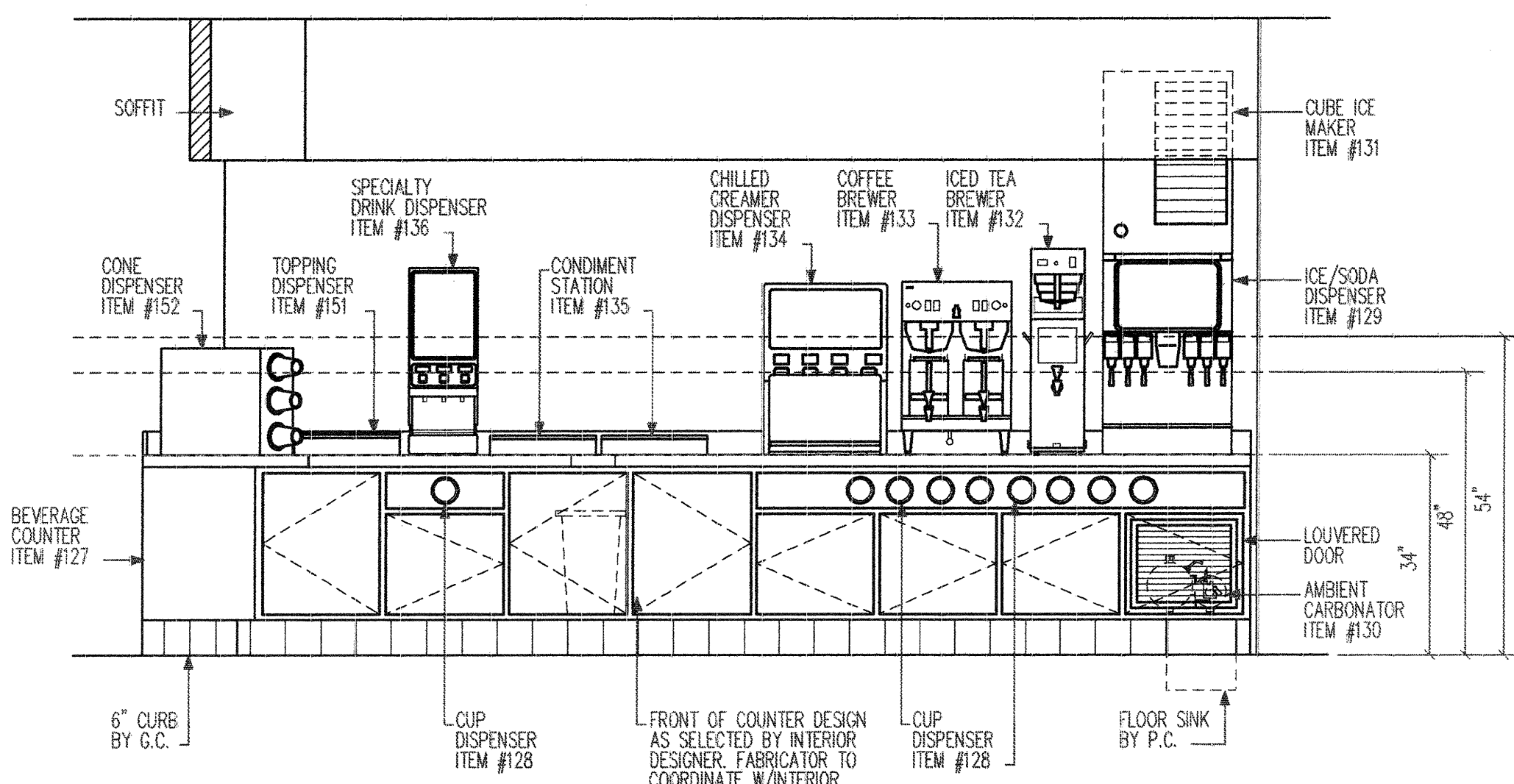

G BEVERAGE COUNTER ITEM #127

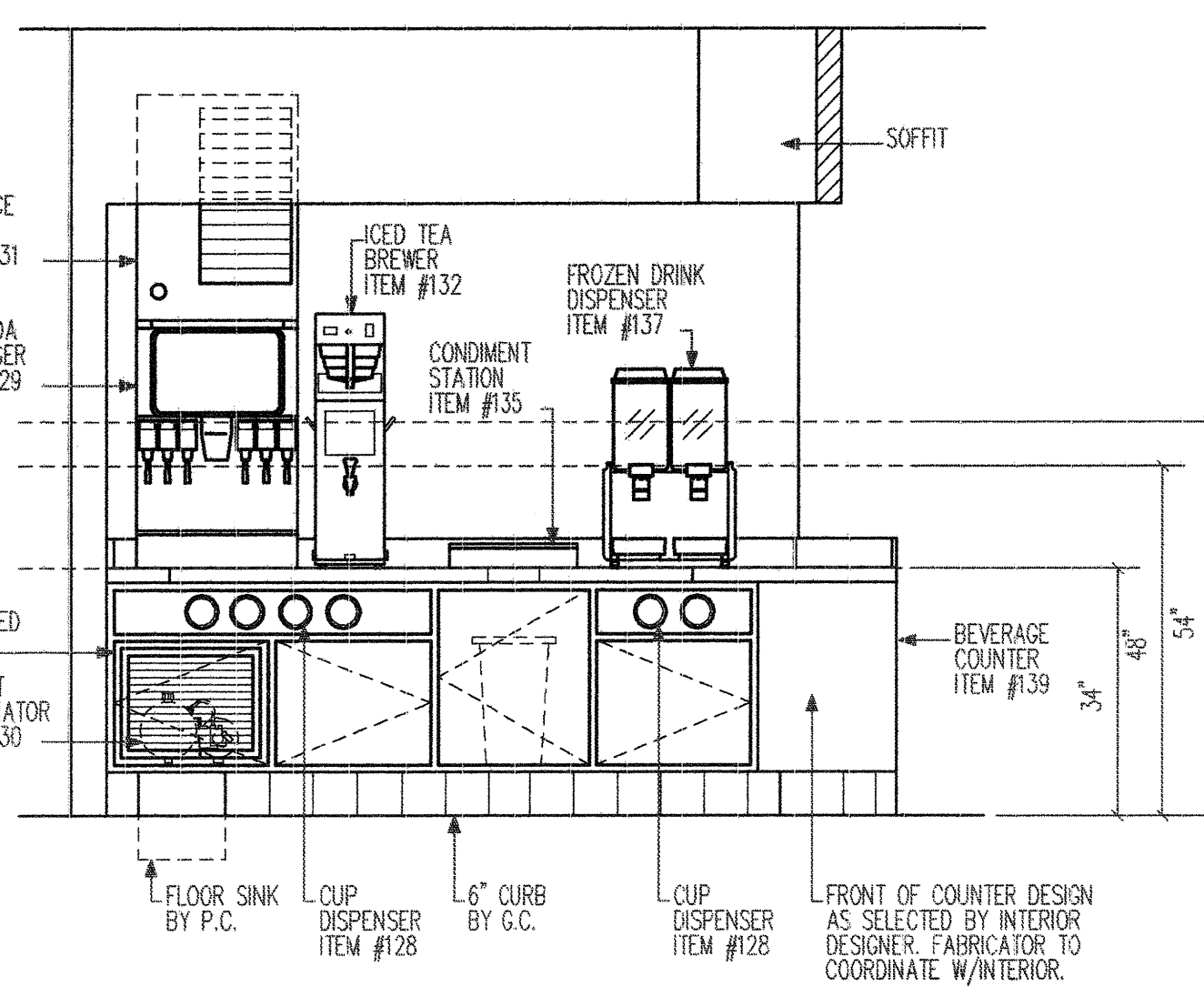

H BEVERAGE COUNTER ITEM #139

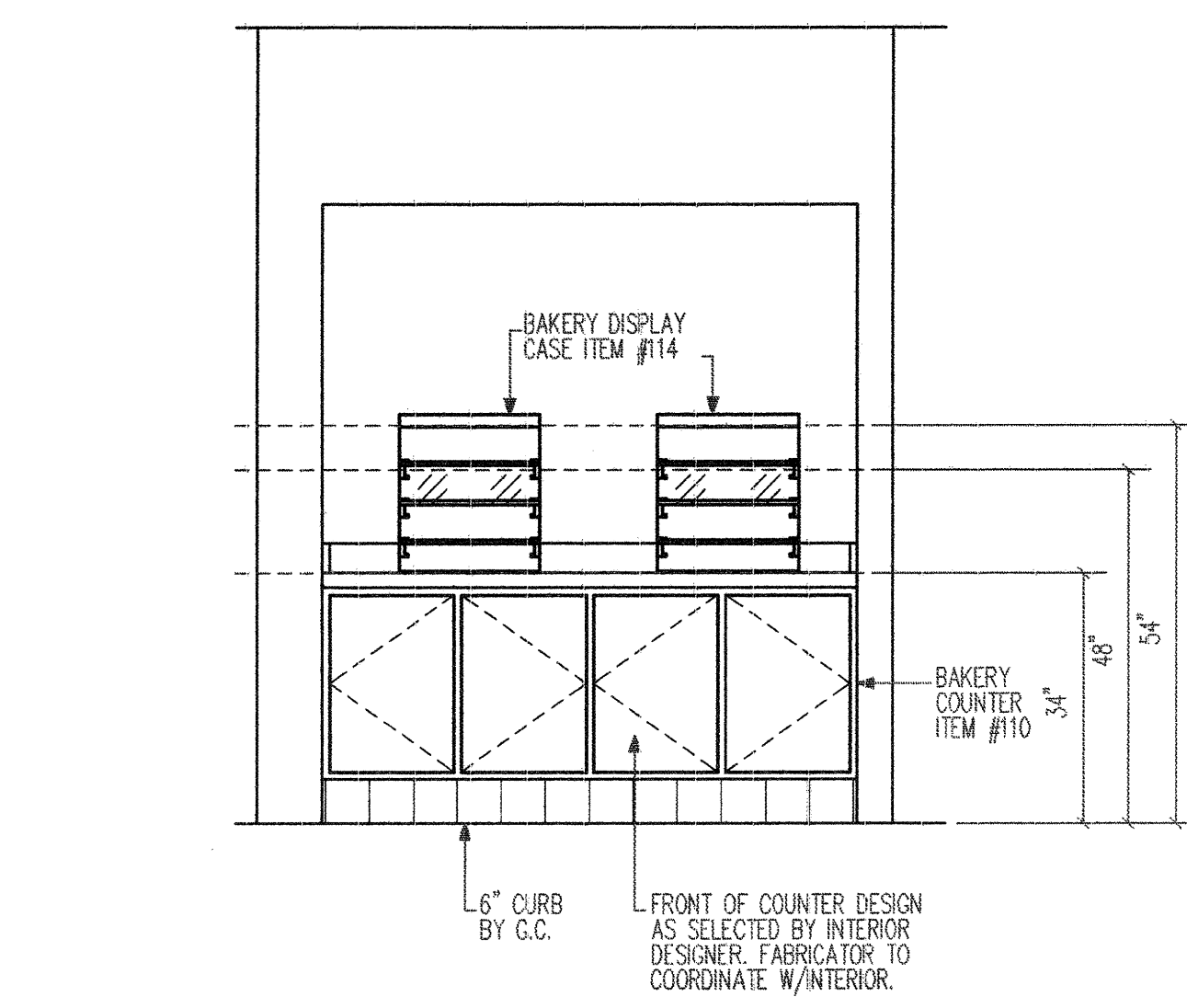

J BAKERY COUNTER ITEM #110

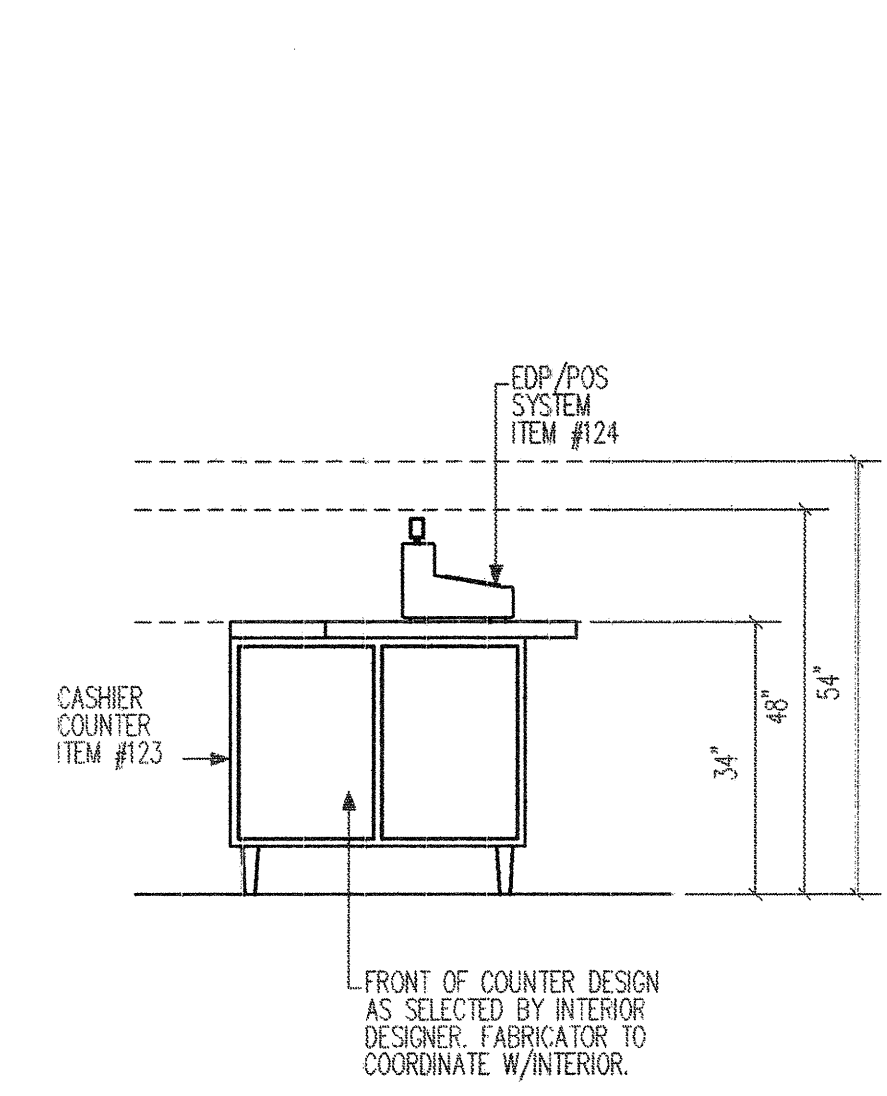

K CASHIER COUNTER ITEM #123

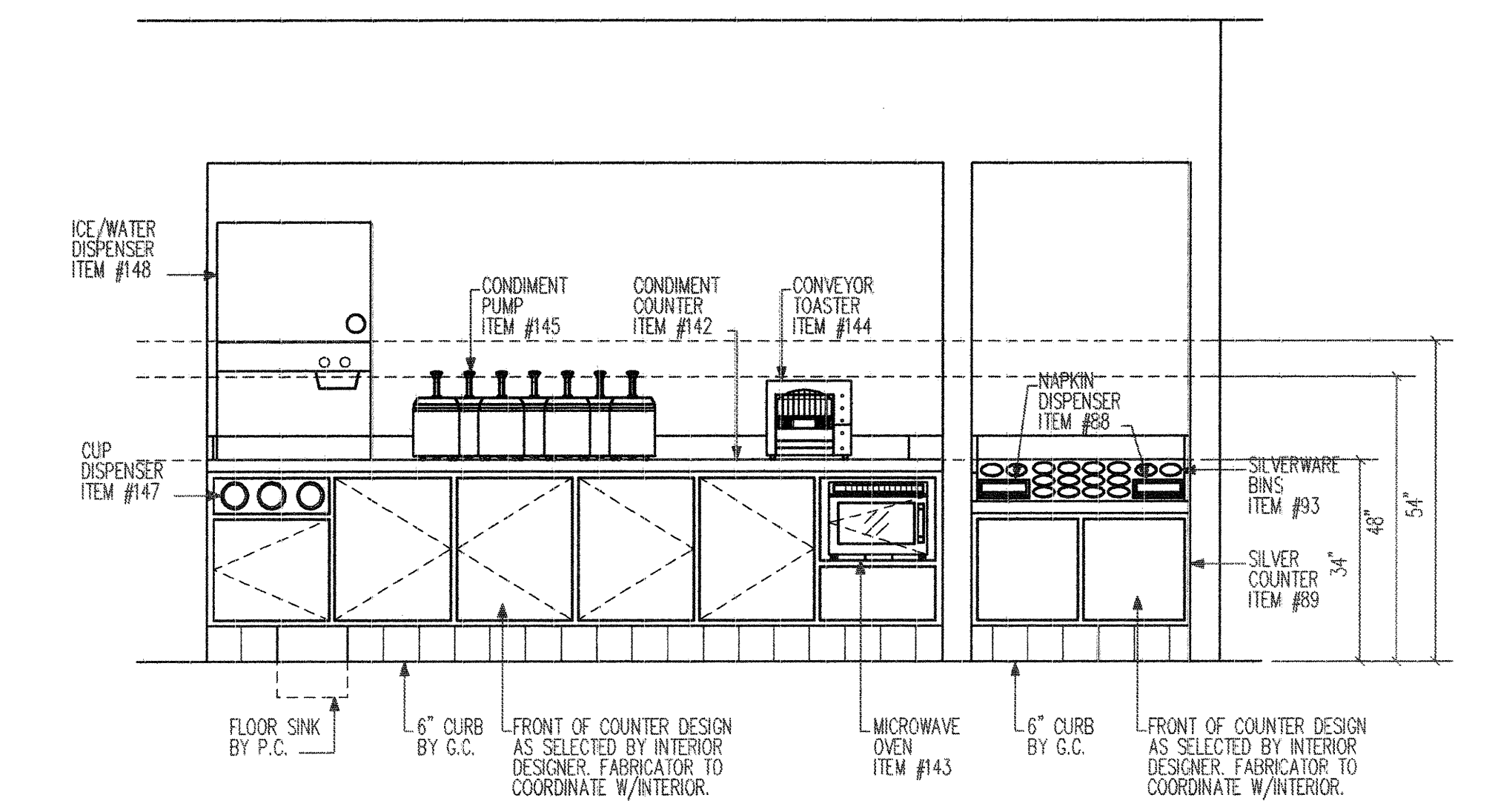

L CONDIMENT COUNTER ITEM #142

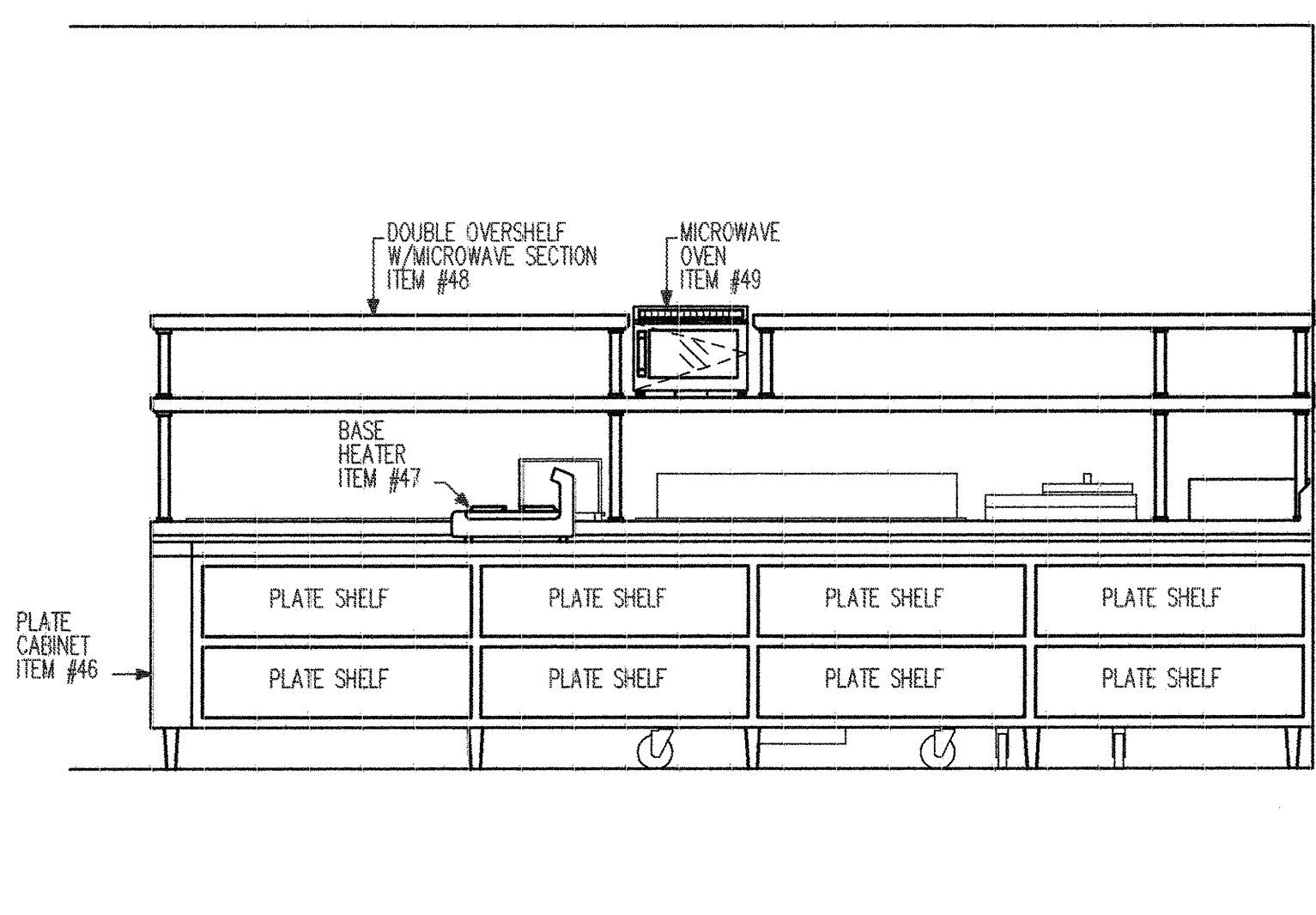

M PLATE CABINET ITEM #46

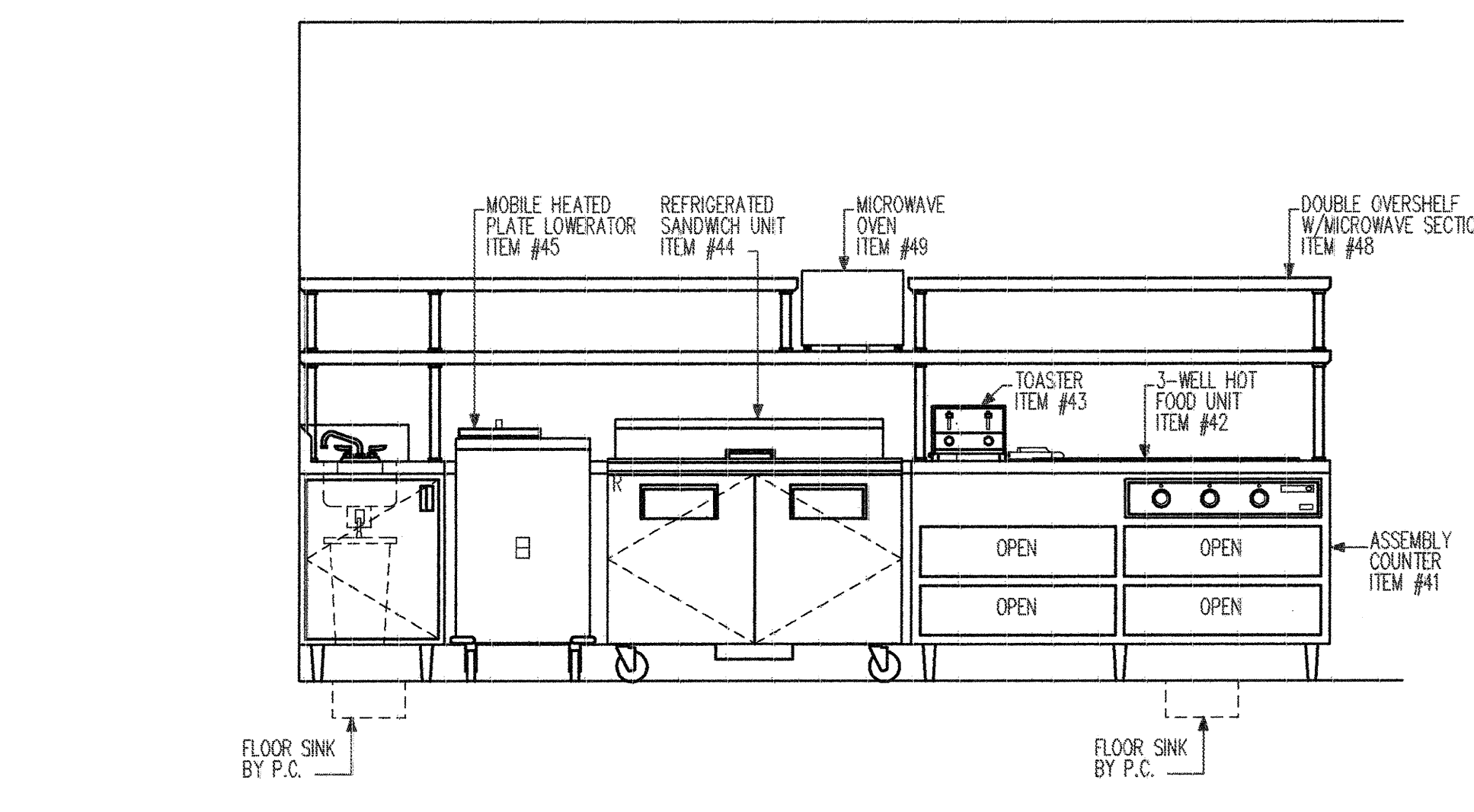

N ASSEMBLY COUNTER ITEM #41

NOTE: THIS DRAWING INDICATES THE GENERAL EXTENT OF THE WORK AND IS NOT INTENDED TO INDICATE OR DESCRIBE ANY AND ALL WORK REQUIRED FOR THE FULL PERFORMANCE AND COMPLETION OF THE REQUIREMENTS OF THE CONTRACT DOCUMENTS.

FINAL - ISSUED FOR CONSTRUCTION

Inman Foodservices Group, LLC
 MIAMI
 1335 S.W. 31st St.
 Suite 310
 Miami, Florida 33145
 (305) 899-2025

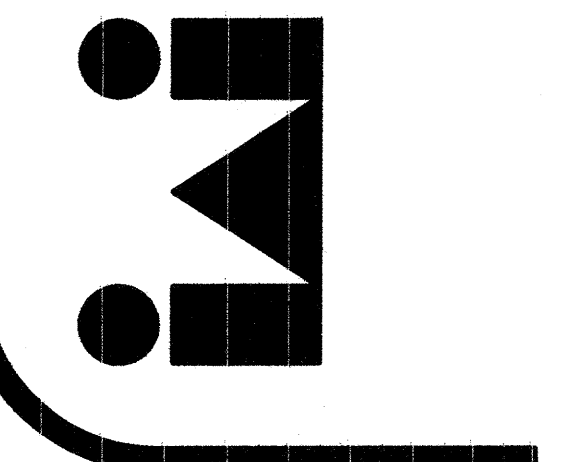

EMR
 Phone (606) 364-2886
 Fax (606) 364-5100
 PO Box 213 (Wallington)
 4140 HWY 30 West
 Annville, KY 40402
 Web Address: emrinc.com

Project: **MERCY HEALTH SYSTEM OF MAINE**
PORTLAND, MAINE

Revisions:

Job Number: 04166
 Date: 03-19-2007
 Drawn By: STAFF
 Checked By: STAFF
 SCALE: 1/4" = 1'-0"

ELEVATIONS
 Sheet **FS-1.9**