

SCALE: 1/4" = 1'-0"

EQUIPMENT LAYOUT

RECOMMENDED CEILING HEIGHT = 9'-0"

GE EQUIPMENT LISTING

ITEM NO.	QUANTITY ORDERED	REFER TO SHEET "D"	ITEM DESCRIPTION (* = EXISTING/REINSTALL)	WEIGHT	HEAT OUTPUT (PER HOUR)	DETAIL NO.	STRC PLAN	ELEC PLAN	EQUIPMENT CROSS REFERENCE CHART	
									P = PREAPPROVAL	C = CALCULATIONS/PENDING APPROVAL
1	1		STORAGE CABINET							
2	1		REAR CABLE COVER							
3	1		ADVANTAGE WORKSTATION WITH TWO LCD MONITORS	81 lbs	1109 btu	M1013A				S
4	1		UPS SYSTEM	959 lbs	2802 btu	B7864PF		UPS		
5	1		POWER DISTRIBUTION UNIT	701 lbs	3402 btu	B7858D		PM		S
6	1		OPERATOR'S CONSOLE / COMPUTER	493 lbs	8826 btu	B7858A		DC		S
7	1		OPERATOR'S CHAIR							
8	1		CT LightSpeed VCT	4100 lbs	43003 btu	B7864D B7864E B7864A B7864B B7864C B7864E		CTT		C
9	1		ST2000 PATIENT TABLE WITH EXTENDED TABLE TOP	1250 lbs	703 btu	B7920				

THE FOLLOWING ITEMS, WHICH HAVE BEEN ORDERED FROM GE HEALTHCARE, ARE TO BE INSTALLED BY THE CUSTOMER OR HIS CONTRACTOR.

50	1		MAIN DISCONNECT CONTROL	132 lbs		E4502AE		A1		C
----	---	--	-------------------------	---------	--	---------	--	----	--	---

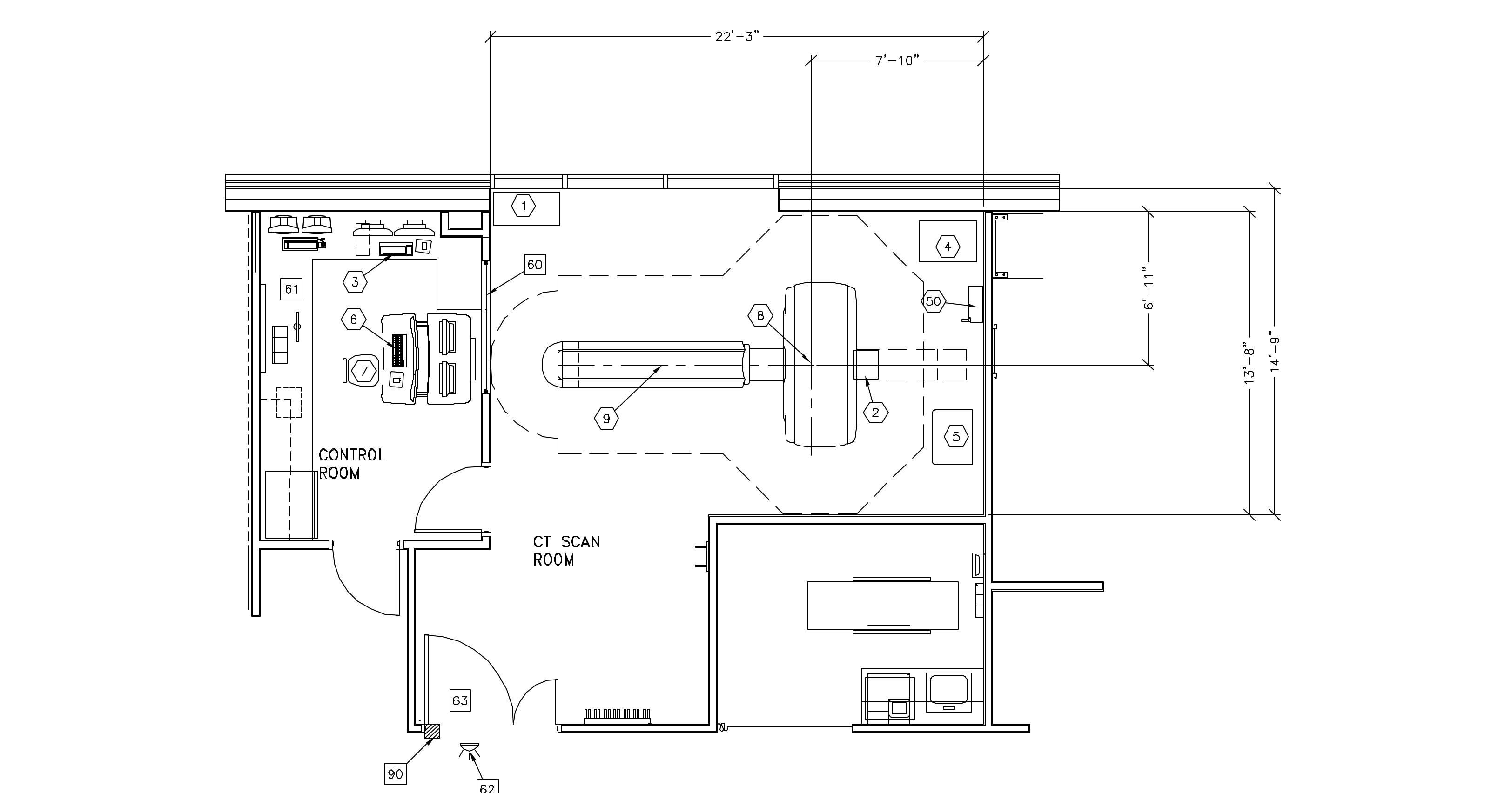

Drawn by: Angela Sterr Octel no.: 3204508  
 GE Installation  
 Project Manager: JIM DOMBROSKI  
 Telephone no.: 603-934-3739

ANCILLARY ITEMS	
CUSTOMER/CONTRACTOR SUPPLIED AND INSTALLED ITEMS	
ITEM NO.	ITEM DESCRIPTION (* INDICATES EXISTING)
60	LEAD GLASS WINDOW COUNTER TOP FOR EQUIPMENT- PROVIDE GROMMETED OPENINGS AS REQUIRED TO ROUTE INTERCONNECT CABLES TO REARWAY BELOW COUNTERTOP.
62	X-RAY ON WARNING LIGHT - AVAILABLE FROM GE SUPPLY CALL: 800-200-9760 GE CAT. NO. WX1A3VV-DF-X1U
63	MINIMUM DOOR OPENING FOR EQUIPMENT DELIVERY IS 44 IN. W X 83 IN. H (1118mm X 2108mm), CONTINGENT ON A 96 IN. (2438mm) CORRIDOR WIDTH
90	X-RAY ROOM WARNING LIGHT CONTROL PANEL REFERENCE JUNCTION POINT - ALSO ON SHEET 'E1' FOR DETAILED DESCRIPTION - 8:4500AM FOR WARNING LIGHT CONTROL ONLY.

THE FOLLOWING ITEMS ARE AVAILABLE FROM GE HEALTHCARE TECHNOLOGIES. CONTACT YOUR LOCAL GE HEALTHCARE SERVICE REPRESENTATIVE FOR PRICING AND AVAILABILITY.

- GENERAL SPECIFICATIONS**
- THE REQUIRED CEILING HEIGHT INDICATED ON THESE PLANS IS TO ENSURE EQUIPMENT FUNCTION IS NOT INHIBITED. CONSULT WITH YOUR LOCAL GEHC INSTALLATION SPECIALIST REGARDING ACCEPTABILITY OF OTHER CEILING HEIGHTS.
  - CHECK ALL DOOR OPENINGS AND HALLWAYS FROM DELIVERY LOCATION TO WHERE EQUIPMENT IS TO BE INSTALLED TO ENSURE THE ROUTE PHYSICALLY AND STRUCTURALLY WILL ACCOMMODATE THE EQUIPMENT AS SHIPPED.
  - RADIATION PROTECTION REQUIREMENTS ARE NOT INDICATED ON THIS PLAN. WHERE NEEDED PER NATIONAL OR LOCAL CODE THEY SHALL BE SPECIFIED BY A QUALIFIED RADIOLOGICAL PHYSICIST.
  - THE DEVELOPMENT OF THE EQUIPMENT LAYOUT, ROOM DIMENSIONS, MECHANICAL AND ELECTRICAL SUGGESTIONS IS PREDICATED UPON THE BEST INFORMATION OBTAINABLE FROM THE SITE, COUPLED WITH THE CUSTOMER'S KNOWN DESIRES. ARCHITECTURAL OR ELECTRICAL CHANGES INCLUDING THE RELOCATION OF EQUIPMENT ILLUSTRATED ON THIS DRAWING IS ALLOWED ONLY WITH NOTIFICATION, IN WRITING, AND REVIEW BY GEHC SERVICE DEPARTMENT. EQUIPMENT OPERATION, SERVICEABILITY, AND RESTRICTING CABLE LENGTHS, ETC., MAKE THIS ESSENTIAL FOR A PROPER INSTALLATION. GEHC RESERVES THE RIGHT TO MAKE ON THE JOB CHANGES BECAUSE OF CUSTOMER REQUIREMENTS AND/OR OBSTACLES IN CONSTRUCTION, ETC..
  - ALL WORK TO BE IN COMPLIANCE WITH NATIONAL AND LOCAL BUILDING SAFETY CODES.
  - DIMENSIONS ARE TO FINISHED SURFACES OF ROOM

- SITE ENVIRONMENT SPECIFICATIONS**
- AMBIENT OPERATING TEMPERATURE:  
 SCAN ROOM: TEMPERATURE RANGE 70°-75° F (21°-24° C)  
 CONTROL ROOM: MAINTAIN TEMPERATURE AT 72° F (22° C)  
 EQUIPMENT ROOM (IF SEPARATE): TEMPERATURE RANGE 60°-75° F (15°-24° C)
  - MAXIMUM TEMPERATURE RATE OF CHANGE OF 5° F (3° C)/HOUR.
  - HUMIDITY: 30 TO 60 PERCENT NON-CONDENSING DURING OPERATION (ALL AREAS)
  - MAXIMUM RELATIVE HUMIDITY RATE OF CHANGE IS 5 PER CENT RH/HOUR.
  - ALTITUDE: NOT TO EXCEED 10,000 FT. (3050M) ABOVE SEA LEVEL.
  - THE ENVIRONMENT FOR THE ELECTRONICS CABINET MUST BE CONTROLLED SO THE ABOVE RESTRICTIONS ARE NOT EXCEEDED.
  - DO NOT RESTRICT THE AIR INTAKE OR AIR EXHAUST OF THE SYSTEM COMPONENTS.
  - ENVIRONMENTAL CONDITIONS LISTED ABOVE MUST BE MAINTAINED AT ALL TIMES INCLUDING FOR EXAMPLE OVERNIGHT, WEEKENDS, AND HOLIDAYS.

- MAGNETIC INTERFERENCE SPECIFICATIONS**
- CT GANTRY MUST BE LOCATED IN AMBIENT STATIC MAGNETIC FIELDS OF LESS THAN ONE GAUSS TO GUARANTEE SPECIFIED IMAGING PERFORMANCE. AMBIENT AC MAGNETIC FIELDS MUST BE BELOW 0.01 GAUSS PEAK.
  - CT COMPUTER EQUIPMENT MUST BE LOCATED IN AMBIENT STATIC MAGNETIC FIELDS OF LESS THAN TEN GAUSS TO GUARANTEE DATA INTEGRITY.
  - CT CONTROL EQUIPMENT MUST BE LOCATED IN AMBIENT STATIC MAGNETIC FIELDS OF LESS THAN LISTED BELOW TO OBTAIN SPECIFIED GEOMETRIC LINEARITY.
- |                  |          |
|------------------|----------|
| CONSOLE/COMPUTER | 10 GAUSS |
| DRT MONITOR      | 1 GAUSS  |
| LCD MONITOR      | 50 GAUSS |

**GE Healthcare Technologies**  
 Installation Services Design Center  
 Milwaukee, Wisconsin

SHEET TITLE: EQUIPMENT LAYOUT  
 MODALITY TYPE: LIGHTSPEED VCT

THIS PLAN IS SUBMITTED TO SUGGEST LOCATION OF GE HEALTHCARE EQUIPMENT AND ASSOCIATED APPARATUS, ELECTRICAL WIRING DETAILS AND ROOM ARRANGEMENTS. THE CUSTOMER'S RESPONSIBILITY IS TO VERIFY THAT THE EQUIPMENT IS TO BE USED FOR ACTUAL CONSTRUCTION PURPOSES. HOWEVER, AND THE COMPANY CANNOT ACCEPT RESPONSIBILITY FOR ANY DAMAGES RESULTING THEREFROM.

PROJECT TITLE:  
**MERCY HOSPITAL  
 FORE RIVER  
 PORTLAND, MAINE**

PROJECT	REVISION
065779	00
DATE:	09-22-06
DRAWN BY:	AJS
CHECKED BY:	REK
QUOTE NO:	KX1CB6
QT. DATE:	09-07-06

REVISION HISTORY:

SHEET  
**A1**