

GE EQUIPMENT LISTING

ITEM NO.	QUANTITY ORDERED	REFER TO SHEET "D"	ITEM DESCRIPTION (* = EXISTING/REINSTALL)	WEIGHT	HEAT OUTPUT (PER HOUR)	DETAIL NO.	STRC PLAN	ELEC PLAN	EQUIPMENT CROSS REFERENCE CHART	
									P = PREAPPROVAL	C = CALCULATIONS/PENDING APPROVAL
1	1		XT RADIOGRAPHIC SUSPENSION WITH INBOARD MOUNTING.	628 lbs	501 btu	B2004	B20041	XTS1	C	
2	1		LONGITUDINAL STATIONARY RAIL FOR XT SUSPENSION	68 lbs			B20041		C	
3	1		DETECTOR SUPPORT ASSEMBLY	97 lbs		B0557D	---	DSA	-	
4	1		DIGITAL ELEVATING TABLE	954 lbs	1102 btu	B0557A	---	RT	S	
5	1		SYSTEMS CABINET	679 lbs	1098 btu	B0558E	---	SKL	S	
6	1		OPERATORS CONSOLE	72 lbs	1221 btu			WBC1	-	
7	1		GRID HOLDER	35 lbs		B0557G	B0557H		S	
8	1		DIGITAL CHEST UNIT WITH EXTENDED RECEPTOR	595 lbs	822 btu	B0557J	B0557F	WLS	C	

THE FOLLOWING ITEMS, WHICH HAVE BEEN ORDERED FROM GE HEALTHCARE, ARE TO BE INSTALLED BY THE CUSTOMER OR HIS CONTRACTOR.

ITEM NO.	QUANTITY ORDERED	REFER TO SHEET "D"	ITEM DESCRIPTION (* = EXISTING/REINSTALL)	WEIGHT	HEAT OUTPUT (PER HOUR)	DETAIL NO.	STRC PLAN	ELEC PLAN
60			CABLE DRAPE RAIL					
61			X-RAY ON WARNING LIGHT - AVAILABLE FROM GE SUPPLY CALL 800-200-9760 GE CAT. NO. WX1ABW-OF-XIU					
62			DOOR LIMIT SWITCH					
63			CONTROL WALL TO CEILING WITH LEAD GLASS VIEWING WINDOW.					
64			COUNTER TOP FOR EQUIPMENT - PROVIDE GROMMETED OPENINGS AS REQUIRED TO ROUTE DISCONNECT CABLES TO RACEWAY BELOW COUNTERTOP.					
65			MINIMUM DOOR OPENING FOR EQUIPMENT DELIVERY IS 44 IN. W X 82 IN. H (118mm X 2108mm), CONTINGENT ON A 96 IN. (2438mm) CORRIDOR WIDTH					
66			COUNTER TOP WITH SINK, BASE AND WALL CABINETS					

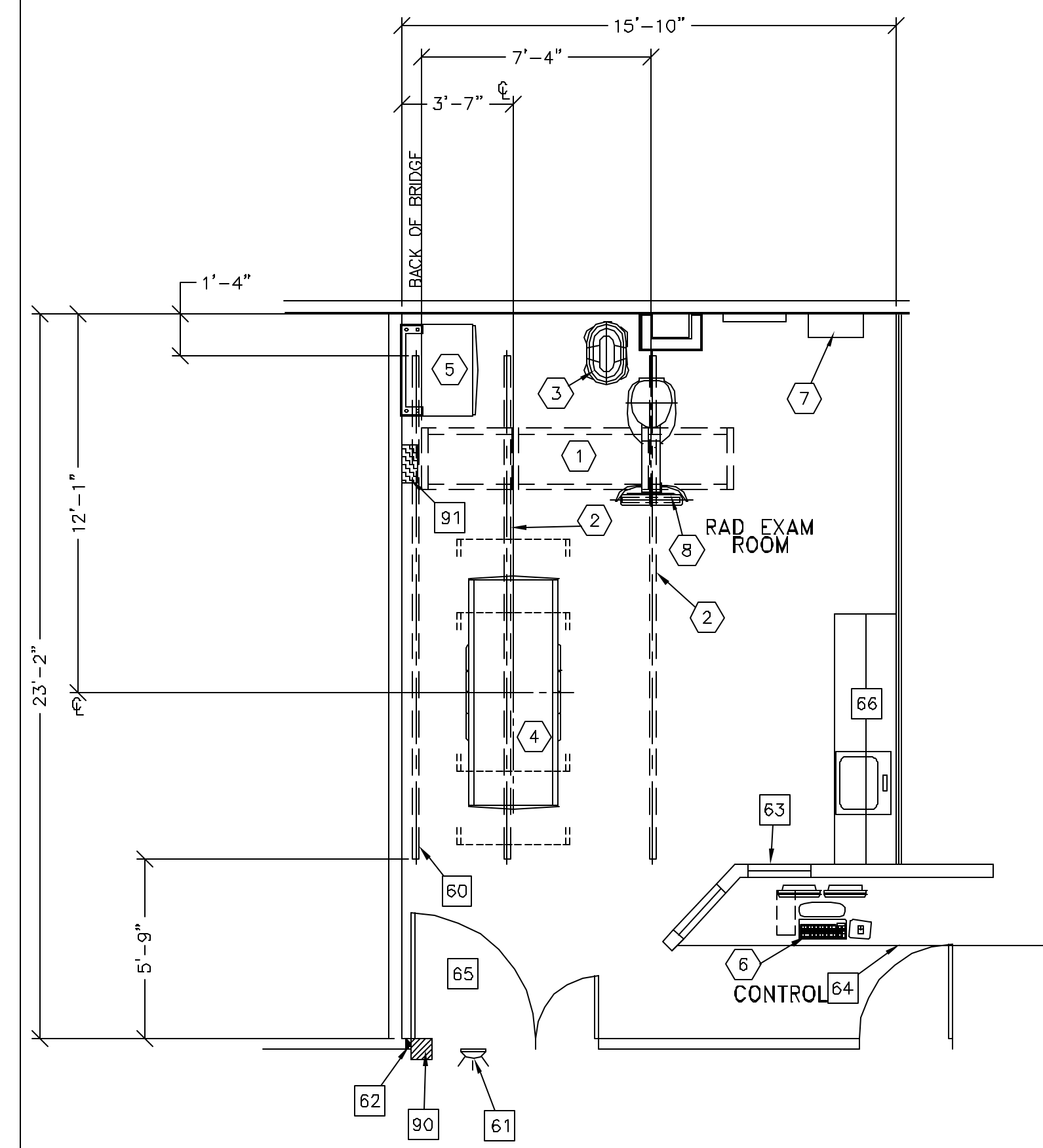

CAUTION:
SEE PRE-INSTALLATION MANUAL #5137435-100 FOR REQUIRED CLEARANCE AREA OF THE DEFINIUM OTS LONGITUDINAL DRIVE BELT ASSEMBLY.

THE FOLLOWING TOMO & IMAGE PASTING APPLICATIONS ARE POSSIBLE WITH THE LAYOUT AS SHOWN IN THESE DRAWINGS

	YES	NO
WALLSTAND TOMO & IMAGE PASTING	X	
CROSS TABLE TOMO (TO WALLSTAND)		X
ENSIFERA TOMO (EXTENDED WALLSTAND)	X	
TABLE TOMO	X	

NOTE: NOT ALL TOMO/IMAGE PASTING OPTIONS MAY BE INCLUDED IN YOUR EQUIPMENT ORDER. PLEASE CONSULT YOUR EQUIPMENT ORDER OR QUOTE FOR VALIDATION.

Drawn by: Paja Girley Octel no.: 3202043
GE Installation
Project Manager: JIM DOMBROSKI
Telephone no.: 603-934-3739

ANCILLARY ITEMS

CUSTOMER/CONTRACTOR SUPPLIED AND INSTALLED ITEMS

ITEM NO.	ITEM DESCRIPTION (* INDICATES EXISTING)
60	CABLE DRAPE RAIL
61	X-RAY ON WARNING LIGHT - AVAILABLE FROM GE SUPPLY CALL 800-200-9760 GE CAT. NO. WX1ABW-OF-XIU
62	DOOR LIMIT SWITCH
63	CONTROL WALL TO CEILING WITH LEAD GLASS VIEWING WINDOW.
64	COUNTER TOP FOR EQUIPMENT - PROVIDE GROMMETED OPENINGS AS REQUIRED TO ROUTE DISCONNECT CABLES TO RACEWAY BELOW COUNTERTOP.
65	MINIMUM DOOR OPENING FOR EQUIPMENT DELIVERY IS 44 IN. W X 82 IN. H (118mm X 2108mm), CONTINGENT ON A 96 IN. (2438mm) CORRIDOR WIDTH
66	COUNTER TOP WITH SINK, BASE AND WALL CABINETS

THE FOLLOWING ITEMS ARE AVAILABLE FROM GE HEALTHCARE TECHNOLOGIES. CONTACT YOUR LOCAL GE HEALTHCARE SERVICE REPRESENTATIVE FOR PRICING AND AVAILABILITY.

90	X-RAY ROOM WARNING LIGHT CONTROL PANEL REFERENCE JUNCTION POINT 'XRLS' ON SHEET 'E1' FOR DETAILED DESCRIPTION -E4500AM FOR WARNING LIGHT CONTROL ONLY.
91	MAIN DISCONNECT REFERENCE JUNCTION POINT 'A' ON SHEET 'E1' FOR DETAILED DESCRIPTION. CAT. NO. E4502JD OR WITH AUTO RESTART E4502KJ. (14.5" W X 24" H X 5.75" D)

GENERAL SPECIFICATIONS

- o THE REQUIRED CEILING HEIGHT INDICATED ON THESE PLANS IS TO ENSURE EQUIPMENT FUNCTION IS NOT INHIBITED. CONSULT WITH YOUR LOCAL GEHC INSTALLATION SPECIALIST REGARDING ACCEPTABILITY OF OTHER CEILING HEIGHTS.
- o CHECK ALL DOOR OPENINGS AND HALLWAYS FROM DELIVERY LOCATION TO WHERE EQUIPMENT IS TO BE INSTALLED TO ENSURE THE ROUTE PHYSICALLY AND STRUCTURALLY WILL ACCOMMODATE THE EQUIPMENT AS SHIPPED.
- o RADIATION PROTECTION REQUIREMENTS ARE NOT INDICATED ON THIS PLAN. WHERE NEEDED PER NATIONAL OR LOCAL CODE THEY SHALL BE SPECIFIED BY A QUALIFIED RADIOLOGICAL PHYSICIST.
- o THE DEVELOPMENT OF THE EQUIPMENT LAYOUT, ROOM DIMENSIONS, MECHANICAL AND ELECTRICAL SUGGESTIONS IS PREDICATED UPON THE BEST INFORMATION OBTAINABLE FROM THE SITE, COUPLED WITH THE CUSTOMER'S KNOWN DESIRES. ARCHITECTURAL OR ELECTRICAL CHANGES INCLUDING RELOCATION OF EQUIPMENT ILLUSTRATED ON THIS DRAWING IS ALLOWED ONLY WITH NOTIFICATION, IN WRITING, AND REVIEW BY GEHC SERVICE DEPARTMENT. EQUIPMENT OPERATION, SERVICEABILITY, AND RESTRICTING CABLE LENGTHS, ETC., MAKE THIS ESSENTIAL FOR A PROPER INSTALLATION. GEHC RESERVES THE RIGHT TO MAKE ON THE JOB CHANGES BECAUSE OF CUSTOMER REQUIREMENTS AND/OR OBSTACLES IN CONSTRUCTION, ETC..
- o ALL WORK TO BE IN COMPLIANCE WITH NATIONAL AND LOCAL BUILDING SAFETY CODES.
- o DIMENSIONS ARE TO FINISHED SURFACES OF ROOM

SITE ENVIRONMENT SPECIFICATIONS

- o AMBIENT OPERATING TEMPERATURE: 59 TO 75 DEGREES (F). MAXIMUM ALLOWABLE TEMPERATURE CHANGE OF 15 DEGREES (F)/HOUR.
- o HUMIDITY: REFER TO PREINSTALLATION MANUAL FOR THE EQUIPMENT ILLUSTRATED ON THIS DRAWING.
- o ALTITUDE: NOT TO EXCEED 8,000 FT. ABOVE SEA LEVEL.
- o THE ENVIRONMENT FOR THE ELECTRONICS CABINET MUST BE CONTROLLED SO THE ABOVE RESTRICTIONS ARE NOT EXCEEDED.
- o DO NOT RESTRICT THE AIR INTAKE AT THE LOWER FRONT OR AIR EXHAUST AT THE TOP OF THE ELECTRONICS CABINETS.

MAGNETIC INTERFERENCE SPECIFICATIONS

IMAGE INTENSIFIERS MUST BE LOCATED IN AMBIENT STATIC MAGNETIC FIELDS OF LESS THAN 1 GAUSS TO GUARANTEE SPECIFIED IMAGING PERFORMANCE.

X-RAY TUBES MUST BE LOCATED IN AMBIENT STATIC MAGNETIC FIELDS OF LESS THAN 10 GAUSS TO GUARANTEE SPECIFIED PERFORMANCE.

SYSTEM ELECTRONICS MUST BE LOCATED IN AMBIENT STATIC MAGNETIC FIELDS OF LESS THAN 10 GAUSS TO GUARANTEE DATA INTEGRITY.

OPERATORS CONSOLE EQUIPMENT MUST BE LOCATED IN AMBIENT STATIC MAGNETIC FIELDS OF LESS THAN 10 GAUSS TO OBTAIN SPECIFIED GEOMETRIC LINEARITY.

GE Healthcare Technologies
Installation Services Design Center
Milwaukee, Wisconsin

SHEET TITLE: EQUIPMENT LAYOUT
MODALITY TYPE: DEFINIUM 8000

THIS PLAN IS SUBMITTED TO SUGGEST LOCATION OF GE HEALTHCARE EQUIPMENT AND ASSOCIATED APPARATUS, ELECTRICAL WIRING, DETAILS AND ROOM ARRANGEMENTS. THE CUSTOMER'S LOCAL GEHC SERVICE REPRESENTATIVE SHALL BE USED FOR ACTUAL EQUIPMENT PLACEMENT. GEHC DOES NOT GUARANTEE THE ACCURACY OF THIS PLAN FOR ACTUAL CONSTRUCTION PURPOSES. HOWEVER, AND THE COMPANY CANNOT ACCEPT RESPONSIBILITY FOR ANY DAMAGES RESULTING THEREFROM.

PROJECT TITLE:
**MERCY HOSPITAL
FORE RIVER
PORTLAND, MAINE**

PROJECT	REVISION
065693	00
DATE:	09-15-06
DRAWN BY:	PG
CHECKED BY:	TST
QUOTE NO.:	attached
QT. DATE:	09-07-06

REVISION HISTORY:

SHEET
A1